



Fire Wing™

INSTRUCTIONS



Check to make sure contents are complete:

- 1 Air Hogs® RC Fire Wing™ Plane
- 1 Charger/Flight Controller
- 1 Instruction Sheet

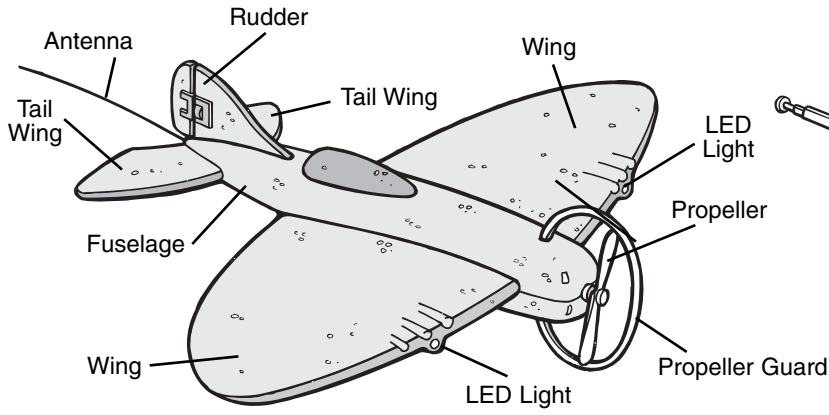

Fire Wing™ Plane

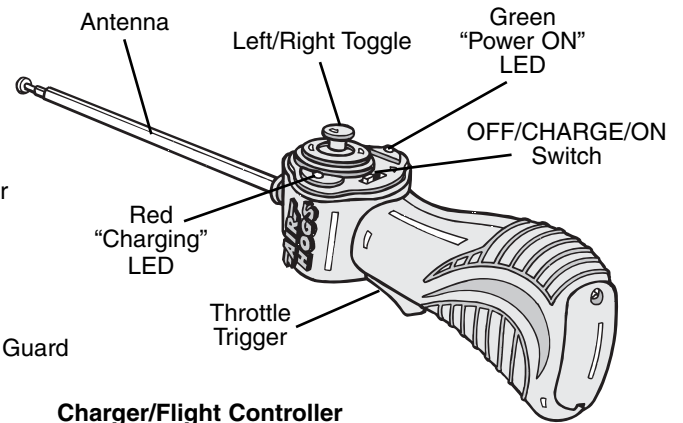

Charger/Flight Controller

Experience Radio Controlled flight with the Air Hogs® RC Fire Wing™. The Fire Wing™ makes flying fun & easy! Just choose the direction you want to fly and squeeze the throttle trigger. The bright LED lights will allow you to easily maneuver in any lighting! The Fire Wing™ is ultra light and features aerodynamic directional control and damage-resistant high density foam. The Fire Wing™ also includes an integrated Charger/Flight Controller unit for convenient portability and easy handling in the field.

BATTERY INSTALLATION

1. Use a Phillips screwdriver to loosen the battery compartment door on the Charger/Flight Controller.
2. Open the battery door and install **4 AA 1.5-V alkaline batteries** (not included). Be careful to align the positive (+) and negative (-) polarities with the corresponding markings inside the battery compartment as shown.
3. Close the battery compartment door and re-tighten the hold down screw.

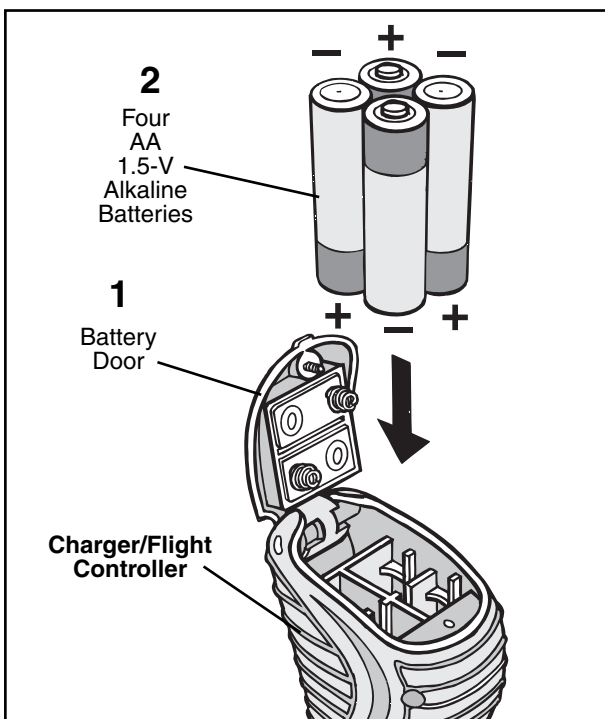

IMPORTANT TIPS:

TURN YOUR CHARGER-FLIGHT CONTROLLER ON AND SQUEEZE THE THROTTLE OR MOVE THE DIRECTION TOGGLE TO TEST THE GREEN LED GLOW. TO ENSURE THAT THE BATTERIES ARE INSTALLED PROPERLY.



WHEN THE SWITCH IS IN THE MIDDLE CHARGE POSITION AND CONNECTED TO THE PLANE, THE RED LED SHOULD BLINK TO PRESENT CHARGING IN PROGRESS.

After each flight, store the plane in the package to prevent damage.

REPAIRS

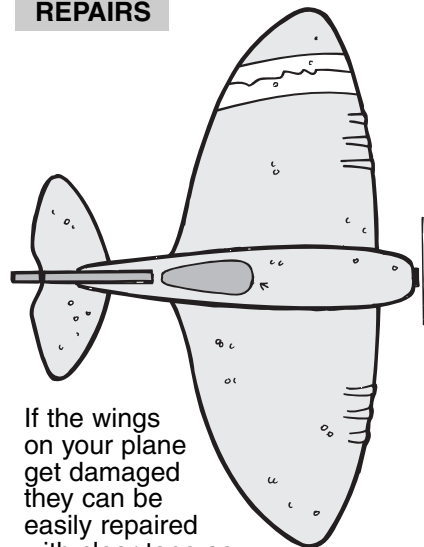

If the wings on your plane get damaged they can be easily repaired with clear tape as shown.

Your Fire Wing™ Plane has pre-installed rechargeable batteries in the plane's fuselage.

Because the Flight Controller's AA batteries are used for 2 functions – charging and controlling, they will need to be replaced after every 20 to 25 flights.

CHARGING YOUR PLANE

Important Charging Information:

- Before taking your initial flight, charge the plane for a complete charge cycle on your charger.
 - Depending upon the length of future play, you will not need to complete a full charge before each flight.
- NOTE:** A shortened charge results in a shorter play time (may take up to 1/2 hour to fully charge).

1. Push the plane's ON/OFF switch up to turn the plane OFF.

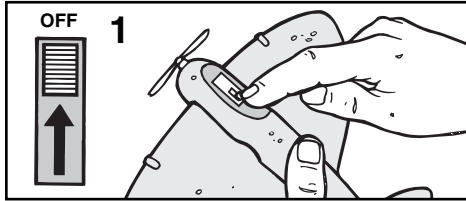

2. Flip the charge door open to reveal the charge nozzle.

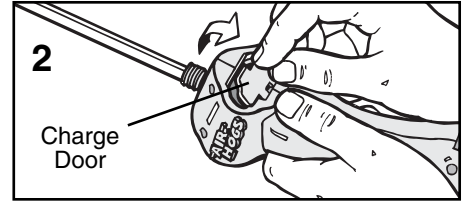

3. Push the charge nozzle all the way into the plane's charger port located on the bottom of the plane.

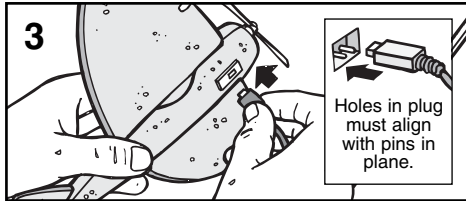

4. Set the charger/flight controller switch to the middle CHARGE position.

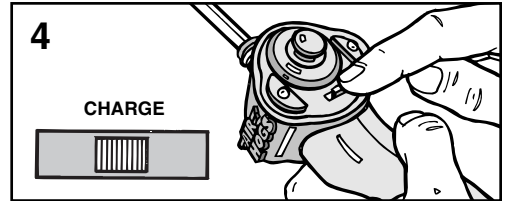

5. During the charging process, the red LED will blink. When the Fire Wing™ is fully charged the light will switch to off.

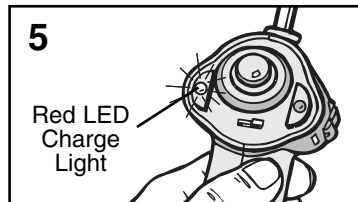

6. Remove charge nozzle gently from the plane's charge port. Store charge nozzle and close the charge door.

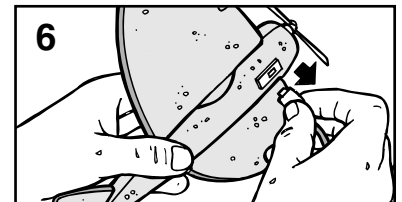

PRE-FLIGHT ENVIRONMENT CHECK

- 1. Location** – Fly in a large wide open, grassy location that is free of buildings, trees, overhead wires, and other obstructions. Do not fly near people or animals.
- 2. Weather** – Fly on mild, sunny days. Do not fly in electrical storms, rain, sleet, snow or other adverse weather conditions. Do not fly if the temperature is below 45°F/7°C. In very cold temperatures, the plane will become fragile and the engine performance will decrease.
- 3. Wind Conditions** – Do not fly in wind. Winds may overpower the plane and make it difficult to control. In windy conditions, it may appear as though you have no control over the plane.

FLYING INDOORS?

NOTE: Always get a parent's permission to fly your Fire Wing™ indoors.

Location – Fly in a wide open room, far from breakable items – an empty double car garage or unfinished basement are great options. Avoid flying near vents and/or fans, as they may overpower the plane and make it difficult to control.

FLYING INSTRUCTIONS

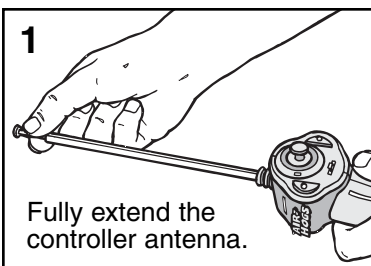

2. Push the charger/controller switch to the ON position.

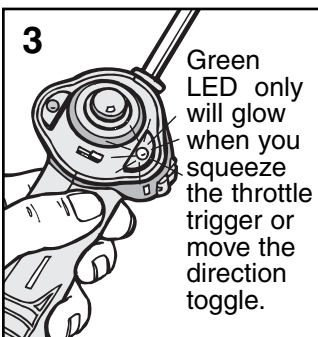

4. Pull the plane's ON/OFF switch down to the ON position to start the engine.



5

When preparing for take off, check the direction of the wind.

Launch the plane into the wind and parallel to the ground.

TIP: Always launch your plane into the wind for the best take off and flight results. The wind will blow against your face, if you are facing the correct direction.

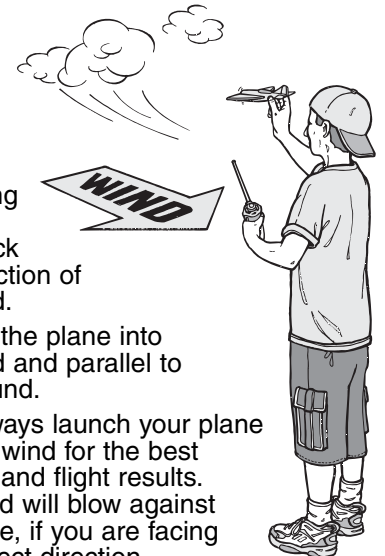

CONTROLLING PLANE FLIGHT

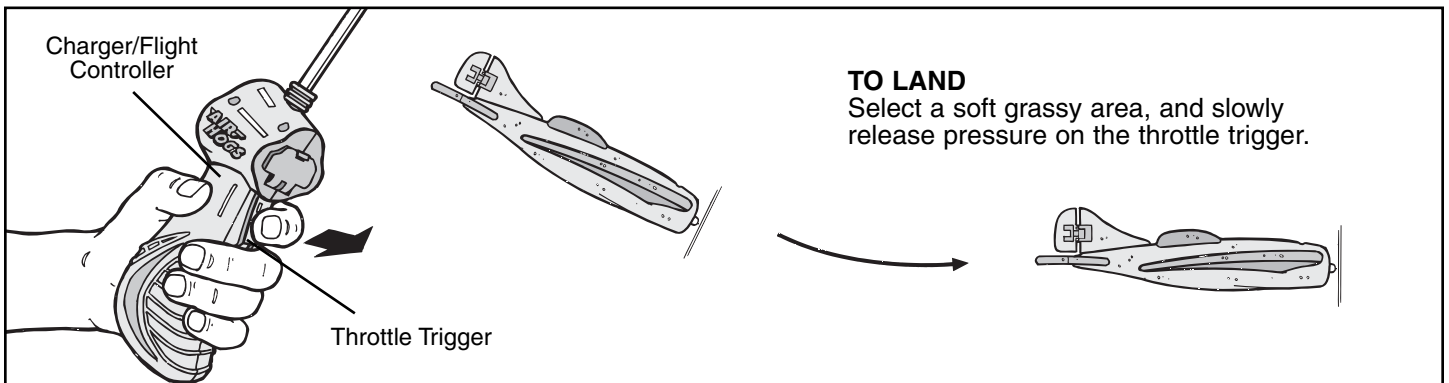
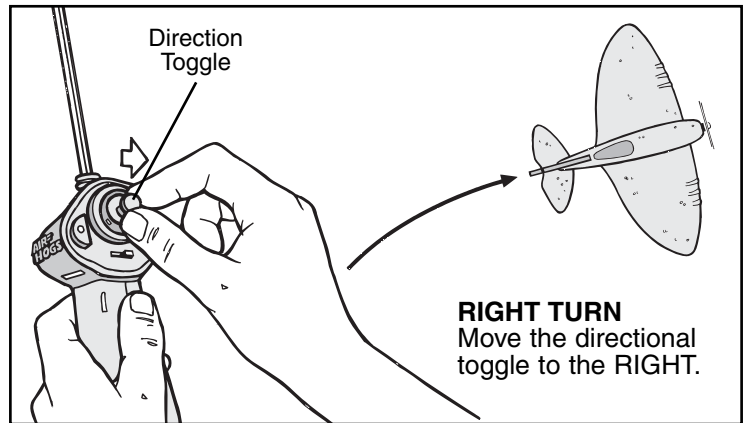
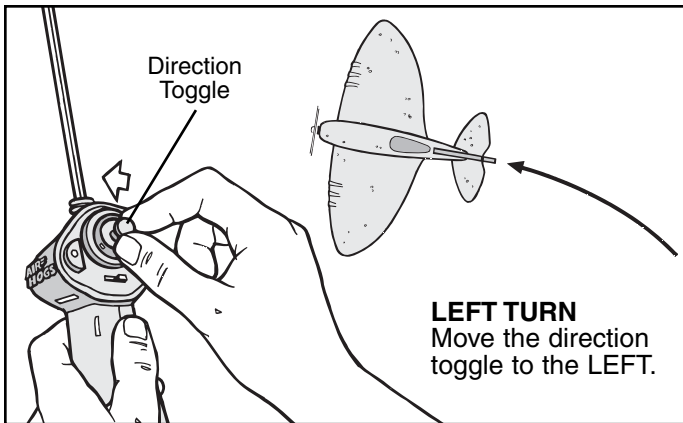
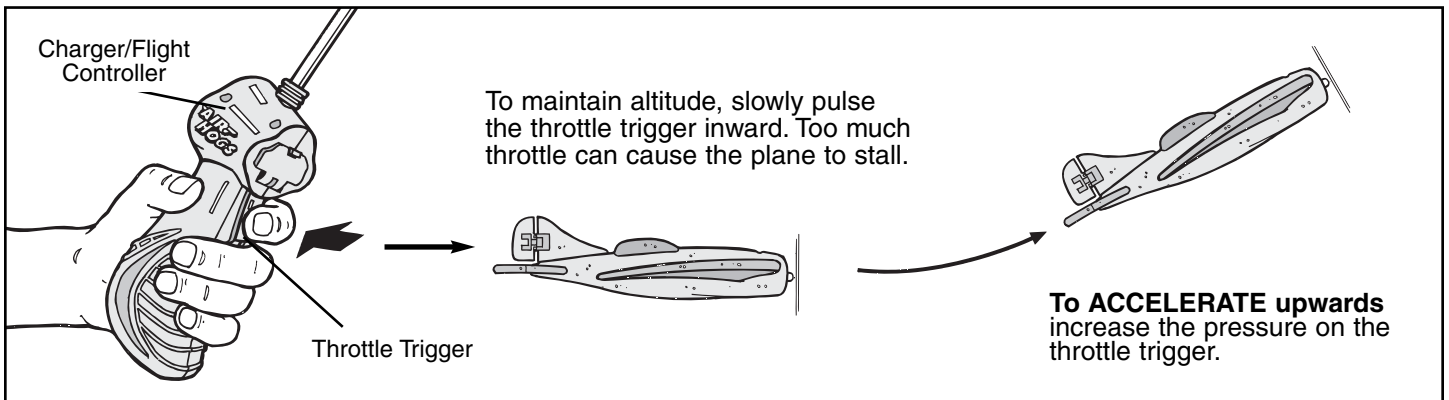

ONCE THE PLANE HAS LANDED

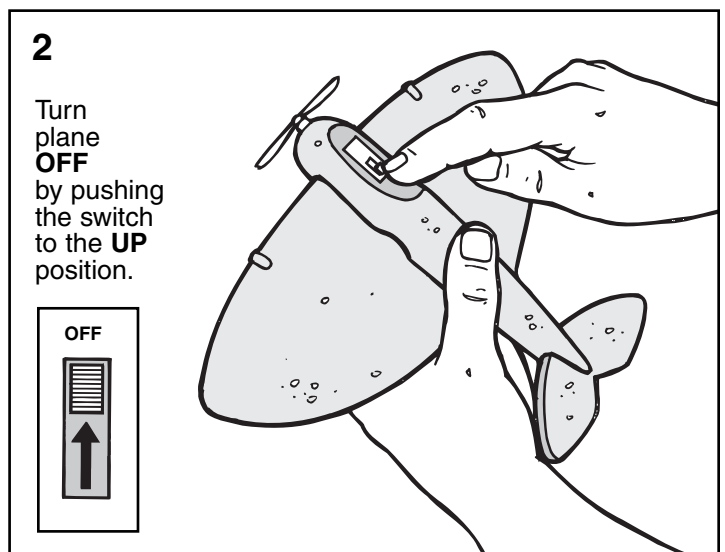
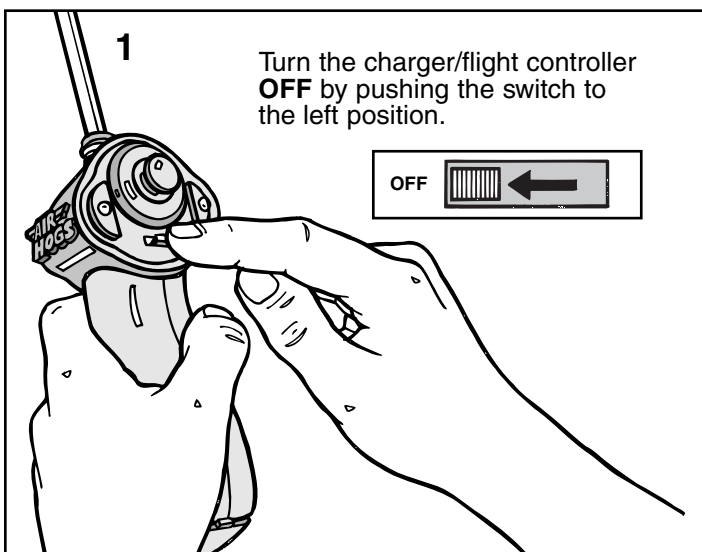

TROUBLESHOOTING GUIDE

PROBLEM	CAUSE	SOLUTION
Plane will not start or has low power.	<ol style="list-style-type: none"> 1. Plane not charged. 2. Battery power is drained. 3. Plane was not set to OFF during charging. 4. Charger/Flight Controller was not set to "Charger/Flight Controller OFF". 	<ol style="list-style-type: none"> 1. Charge plane for a complete charge cycle. 2. Replace the Charger/Flight Controller batteries after 20 flights. 3. The plane won't accept a charge in the ON position. Always set to "OFF" before charging. 4. The Charger/Flight Controller will NOT charge in the "OFF or ON" position. Always set the Charger/Flight Controller to "CHARGE" before attempting to charge.
Plane will not turn.	<ol style="list-style-type: none"> 1. Controller is not ON. 2. Controller antenna is not extended. 3. It's a windy day or you're flying by a vent/fan. 	<ol style="list-style-type: none"> 1. Set Controller to "Controller ON" 2. Fully extend Controller antenna before flying. 3. Do not fly in winds. Windy conditions will limit and prevent your ability to control the plane. If flying indoors, do not fly near a vent/fan.
Plane is flying too low.	<ol style="list-style-type: none"> 1. Needs more power. 2. The four AA batteries in the Charger/Flight Controller are drained. 	<ol style="list-style-type: none"> 1. Squeeze the Throttle Trigger. 2. Install new batteries.
Plane is flying too high.	<ol style="list-style-type: none"> 1. Need to decrease power. 	<ol style="list-style-type: none"> 1. Gently release pressure on the Throttle Trigger.

IMPORTANT BATTERY INFORMATION

REQUIRED BATTERIES: Charger/Flight Controller takes 4 AA Alkaline Batteries (**not included**).

Battery installation should be performed by an adult. Use only batteries recommended in the instruction sheet. Be careful to install the batteries with the correct polarity, as indicated.

- Do not mix old and new batteries.
- Do not mix alkaline, standard or rechargeable batteries.
- Battery installation should be done by an adult.
- Non-rechargeable batteries are not to be recharged.
- Rechargeable batteries are to be removed from the toy before being charged (if removable).
- Rechargeable batteries are only to be charged under adult supervision

(if removable).

- Only batteries of the same or equivalent type as recommended are to be used.
- Batteries are to be inserted with the correct polarity.
- Exhausted batteries are to be removed from the toy.
- The supply terminals are not to be short-circuited.
- Different types of batteries, or new and used batteries are not to be mixed.
- Exhausted batteries are to be removed, as they will adversely affect the performance.



CAUTION:

PLEASE READ BEFORE CHARGING OR USING BATTERY.

Your plane is equipped with a Lithium Polymer battery; please also pay attention to the following cautions for safe use:

- Do not dispose the battery in fire or heat.
- Do not use or leave the battery near a heat source such as fire or heater.
- Do not strike or throw the battery against hard surfaces.
- Do not immerse the battery in water. Keep the battery in a cool dry environment.

- When charging, only use the battery charger specifically for that purpose.
- Do not over-charge the battery.
- Do not connect the battery to an electrical outlet.
- Do not directly solder the battery or pierce the battery with a nail or other sharp objects.
- Do not transport or store the battery together with metal objects such as necklaces, hairpins, etc.
- Do not disassemble or alter the battery.
- Charge the battery every 6 months.
- Turn off your equipment power switch after use.
- As for a used battery, please recycle the battery by covering the terminals with insulation tape or inserting into an individual polybag.

FCC STATEMENTS:

This device complies with part 15 of the FCC rules. Operation is subject to the following two conditions:

1. This device may not cause harmful interference, and
2. This device must accept any interference received, including interference that may cause undesired operation.

NOTE: This equipment has been tested and found to comply with the limits for a Class B digital device, pursuant to Part 15 of the FCC Rules. These limits are designed to provide reasonable protection against harmful interference in a residential installation. This equipment generates, uses and can radiate radio frequency energy and, if not installed and used in accordance with the instructions, may cause harmful interference to radio communications.

However, there is no guarantee that interference will not occur in a particular installation. If this equipment does cause harmful interference to radio or television reception, which can be determined by turning the equipment off and on, the user is encouraged to try to correct the interference by one or more of the following measures:

- Reorient or relocate the receiving antenna.
- Increase the separation between the equipment and the receiver.
- Connect the equipment into an outlet on a circuit different from that to which the receiver is connected.
- Consult the dealer or an experienced radio/TV technician for help.

WARNING: Changes or modifications not expressly approved by the party responsible for compliance could void the user's authority to operate the equipment.

Spin Master Ltd., 450 Front Street West, Toronto, ON M5V 1B6 Canada
Spin Master, Inc., PMB #10053, 300 International Drive, Suite 100,
Williamsville, NY 14221, USA
Spin Master Toys Far East Limited, Rm #1113, 11/F,
Chinachem Golden Plaza, 77 Mody Rd., Tsimshatsui E., Kowloon, HK

Air Hogs® is a registered trademark and Fire Wing™ is a trademark of Spin Master Ltd.
© 2007 Spin Master Ltd. All rights reserved.
Manufactured for and distributed by Spin Master Ltd.
Conforms to safety standards ASTM F963-03,
Regulatory Requirements. Products and colors
may vary. Please retain this information for future reference.
MADE IN CHINA.

Contains Lithium Polymer battery. Battery must be recycled or disposed of properly.



North American Consumer Information
Phone: 1-800-622-8339
www.spinmaster.com

#20010470, #20010471 NEN REV 0
T44308_0001_20010471_NEN_IS_R1

