

A3060

Bluetooth Mini Speaker
Quick Start Guide(A1)

Bluetooth-Mini-Lautsprecher
Schnellstartanleitung

Mini haut-parleur Bluetooth
Démarrage rapide

Mini altavoz Bluetooth
Guía de inicio rápido

Mini altifalante Bluetooth
Guia de consulta rápida

Миниатюрная акустическая
Bluetooth-система

Краткое руководство по использованию

Шагын Bluetooth динамик
Пайдалануу тунани кыскасы муркудук



rapoo

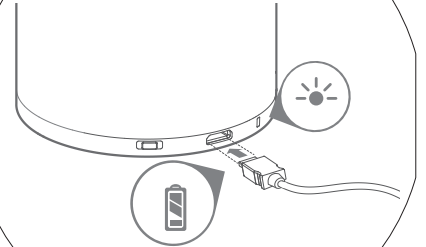
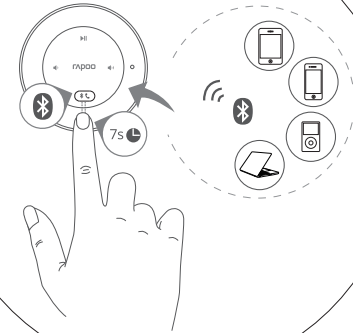
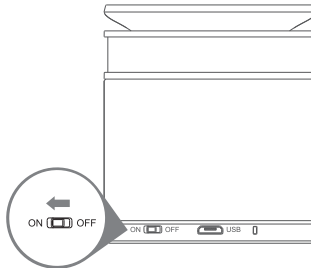

Declaration of Conformity

We, the manufacturer
Shenzhen Rapoo Technology Ltd., Co.
Rise 4th Floor, 4088B B553
Dixie Ave, the product
Product Name: Bluetooth Mini Speaker
Model No: A3060
Complies with the EMC norms of:

IEC 62594-1:2005/EN 55094/A1:2009
EN 62594-2:2009/A1:2010/A12:2011
EN 62311:2008
EN 301 486-1 V19.2:2014 (29)
EN 301 486-2 V19.1:1 (2009-09)
EN 300 328 V1.7.1 (2009-03)

This product is in compliance with the essential requirements of
Council Directives 2004/108/EC and 1999/5/EC, and the RoHS European directives
2002/95/EC dated on January 27th, 2003 amended by directive 2005/618/EC dated on
August 18th, 2005.

Manufacturer/Authorized representative
Charles Tsou, Manager
R&D Department, Date of Issue: January 28, 2013

Charles Tsou

FCC Statement

This equipment has been tested and found to comply with the limits for a Class B digital device, pursuant to part 15 of the FCC rules. These limits are designed to provide reasonable protection against harmful interference in a residential installation. This equipment generates, uses and can radiate radio frequency energy and, if not installed and used in accordance with the instructions, may cause harmful interference to radio communications. However, there is no guarantee that interference will not occur in a particular installation. If this equipment does cause harmful interference to radio or television reception, which can be determined by turning the equipment off and on, the user is encouraged to try to correct the interference by one or more of the following measures:

Reorient or relocate the receiving antenna.
Increase the separation between the equipment and receiver.
Connect the equipment into an outlet on a circuit different from that to which the receiver is connected.

Consult the dealer or an experienced radio/TV technician for help.
To assure continued compliance, any changes or modifications not expressly approved by the party responsible for compliance could void the user's authority to operate this equipment. (Example: use only shielded interface cables when connecting to computer or peripheral devices)

For more information, refer to the manual at www.rapoo.com

IC Statement

This device complies with Industry Canada RSS-410. Operation is subject to the following two conditions: (1) This device may not cause interference, and (2) This device must accept any interference, including interference that may cause undesired operation of the device.

Le présent appareil est conforme aux CNR d'Industrie Canada applicables aux appareils radio RSS-410. L'utilisation est autorisée aux conditions suivantes: (1) l'appareil ne doit pas produire de brouillage, et (2) l'utilisateur de l'appareil doit accepter tout brouillage radioélectrique subi, même si le brouillage est susceptible d'en compromettre le fonctionnement.

The device meets the exemption from the routine evaluation limits in section 2.5 of RSS-102 and compliance with RSS-102 RF exposure. Users can obtain Canadian information on RF exposure and compliance.

Le dispositif rencontre l'exemption des limites courantes d'évaluation dans la section 2.5 de RSS-102 et il est conforme à l'exposition de RSS-102 RF. L'utilisateur peut obtenir l'information canadienne sur l'exposition et la conformité.

For France only

Pour la présente, le fabricant « SANGHA » déclare que l'appareil (Mini haut-parleur Bluetooth) est conforme aux exigences énoncées dans les autres dispositions pertinentes de la directive 1999/5/CE.

Pour vous procurer une copie de la déclaration de conformité il faut adresser un courrier à l'adresse suivante en précisant le titre du produit dans votre adresse e-mail.

Les produits dont vous désirez obtenir les déclarations de conformité:

SANGHA France 219 Avenue de Provence 13730 Saint Victoret.

FCC Radiation Exposure Statement

This equipment complies with FCC RF radiation exposure limits set forth for an uncontrolled environment. This transmitter must not be co-located or operating in conjunction with any other antenna or transmitter. This equipment complies with Part 15 of the FCC Rules. Operation is subject to the following two conditions: (1) This device may not cause harmful interference, and (2) This device must accept any interference received, including interference that may cause undesired operation.

Any changes or modifications not expressly approved by the party responsible for compliance could void the user's authority to operate the equipment.

Caution!

The manufacturer is not responsible for any radio or TV interference caused by unauthorized modifications to this equipment. Such modifications could void the user authority to operate the equipment.

Warranty

The device is provided with two-year limited hardware warranty from the purchase date. Please see www.rapoo.com for more information.

Garantie

L'appareil est fourni avec deux ans de garantie matérielle limitée à compter du jour d'achat. Merci de consulter www.rapoo.com pour plus d'informations.

It is forbidden to reproduce any part of this quick start guide without the permission of Rapoo Technology Co., Ltd. 5/08-01105-222



www.rapoo.com