

# 1620

Wireless Optical Mouse  
Quick Start Guide

The ultimate wireless  
**rapoo**

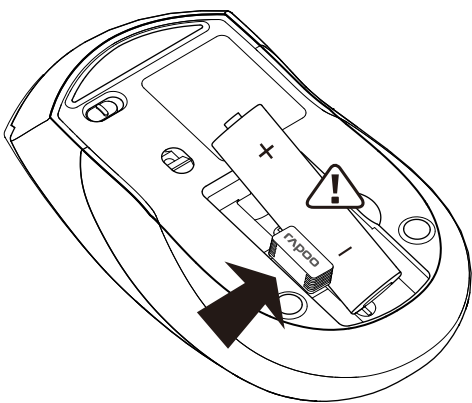
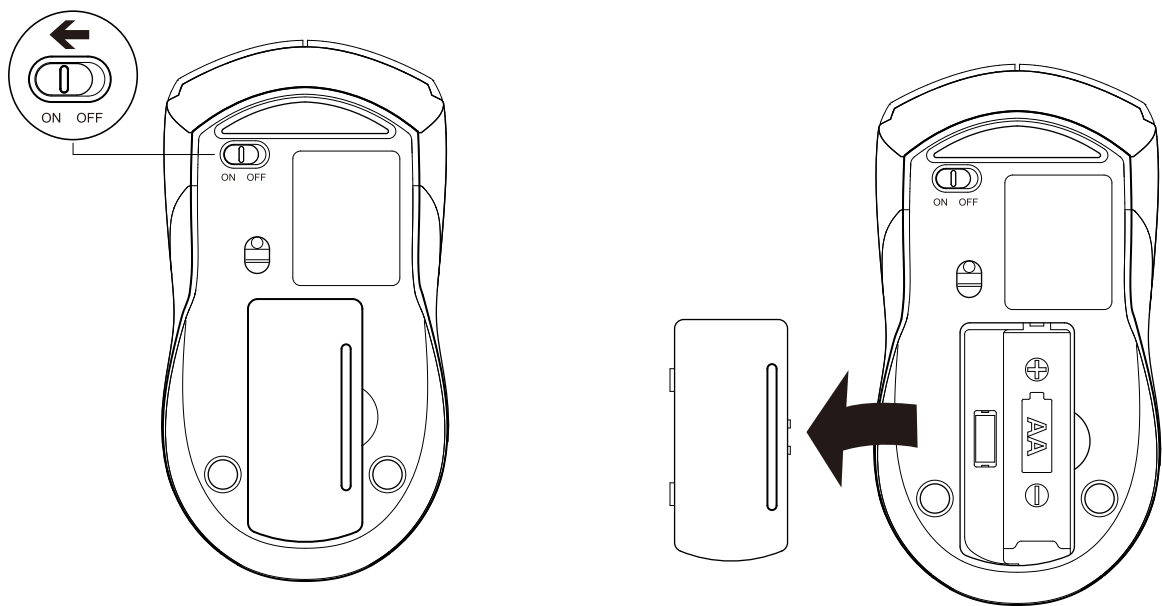

Plug the receiver into the usb port. The receiver will pair with the mouse/keyboard automatically.

### Troubleshooting

See [www.rapoo.com](http://www.rapoo.com) for latest FAQs, drivers and quick start guide. For extensive service, register at [www.rapoo.com](http://www.rapoo.com).

### Copyright

It is forbidden to reproduce any part of this quick start guide without the permission of Rapoo Technology Co., Ltd.

### Safety instructions

Do not open or repair this device. Do not use the device in a damp environment. Clean the device with a dry cloth.

### Warranty

The device is provided with one-year limited hardware warranty from the purchase day. Please see [www.rapoo.com](http://www.rapoo.com) for more information.

### 문제 해결

[www.rapoo.com](http://www.rapoo.com)에 가시면 드라이버 및 최근 FAQ, 퀵스타트 가이드를 참조하실 수 있습니다. 더욱 폭넓은 서비스를 받고 싶다면 [www.rapoo.com](http://www.rapoo.com)에 가입하시기 바랍니다.

### 저작권

Rapoo Technology Co., Ltd.의 허가 없이 본 퀵스타트 가이드의 수정 및 배포를 금지합니다.

### 안전 지침

이 기기를 직접 분해하거나 수리하지 마십시오. 기기를 습한 환경에서 사용하지 마십시오. 기기를 마른 걸레로 닦아주십시오.

### 보증

이 기기는 구매일로부터 1년간의 하드웨어 보증이 제공됩니다. 더욱 자세한 내용은 [www.rapoo.com](http://www.rapoo.com)을 참조하십시오.

### Agent Information

Country (or area)	Information	Description
Hongkong	Company name Address Tel#	Vim Yield Company 香港九龍官塘成業街20號怡生工業大廈2字樓全層 852-31522789
Malaysia	Company name Address Tel#	AV FUTURE LINK SDN BHD NO.23A, JALAN 5/152, TAMAN PERINDUSTRIAN OUG, PUCHONG, 58200 KUALA LUMPUR, MALAYSIA (+0060)377830011
Việt Nam	Tên công ty địa chỉ điện thoại	CÔNG TY CỔ PHẦN KỸ THUẬT CÔNG NGHỆ NAM THÀNH Số 7, lô 14A, khu đô thị mới Trung Yên, đường Trung Hòa, quận Cầu Giấy, Hà Nội, Việt Nam 0084-4-37834530
대한민국	회사명 주소 전화번호	(주)로이제 서울시 용산구 원효로2가 92-8 리온빌딩 14층 02-701-2181 / 고객센터 02-711-0077

From the mouth of poisonous and harmful substances or elements name and content  
According to China's "electronic information product pollution control management method"

The mouse						
Poisonous and harmful substances or elements						
Part name	(Pb)	(Hg)	(Cd)	(Cr (VI))	(PBB)	(PBDE)
Cable	○	○	○	○	○	○
PWAs	○	○	○	○	○	○
Plastic parts	○	○	○	○	○	○
Metal parts	○	○	○	○	○	○
Rubber parts	○	○	○	○	○	○

○= Said the toxic and harmful substances in the parts of content in all homogeneous materials  
In SJ/T 11363-2006 standard of set limit to request the following.  
Note: the environmental protection use period of the reference standard depends on the  
normal product Work, such as temperature and humidity conditions.

Any Changes or modifications not expressly approved by the party responsible for compliance could void the user's authority to operate the equipment.

This device complies with part 15 of the FCC Rules. Operation is subject to the following two conditions: (1) This device may not cause harmful interference, and (2) this device must accept any interference received, including interference that may cause undesired operation.

### FCC Radiation Exposure Statement:

This equipment complies with FCC radiation exposure limits set forth for an uncontrolled environment. This transmitter must not be co-located or operating in conjunction with any other antenna or transmitter.

Note: This equipment has been tested and found to comply with the limits for a Class B digital device, pursuant to part 15 of the FCC Rules. These limits are designed to provide reasonable protection against harmful interference in a residential installation. This equipment generates uses and can radiate radio frequency energy and, if not installed and used in accordance with the instructions, may cause harmful interference to radio communications. However, there is no guarantee that interference will not occur in a particular installation. If this equipment does cause harmful interference to radio or television reception, which can be determined by turning the equipment off and on, the user is encouraged to try to correct the interference by one or more of the following measures:

- Reorient or relocate the receiving antenna.
- Increase the separation between the equipment and receiver.
- Connect the equipment into an outlet on a circuit different from that to which the receiver is connected.
- Consult the dealer or an experienced radio/TV technician for help.

### IC RSS warning

This device complies with Industry Canada licence-exempt RSS standard (s). Operation is subject to the following two conditions: (1) this device may not cause interference, and (2) this device must accept any interference, including interference that may cause undesired operation of the device.

Le présent appareil est conforme aux CNR d'Industrie Canada applicables aux appareils radio exempts de licence. L'exploitation est autorisée aux deux conditions suivantes:

- (1) l'appareil ne doit pas produire de brouillage, et
- (2) l'utilisateur de l'appareil doit accepter tout brouillage radioélectrique subi, même si le brouillage est susceptible d'en compromettre le fonctionnement.

### IC Radiation Exposure Statement:

This equipment complies with IC RF radiation exposure limits set forth for an uncontrolled environment. This transmitter must not be co-located or operating in conjunction with any other antenna or transmitter.

Any Changes or modifications not expressly approved by the party responsible for compliance could void the user's authority to operate the equipment.