

F70XFR_0300_41_41_R118

Planar combination antenna F70XFR

Roof Mount, ECE-R 118 - Thread length 14 mm - polycarbonate

WLAN 2400 MHz and 5300 MHz + WLAN 2400 MHz and 5300 MHz



- all roof-mounted antennas are watertight (IP69K compliant) when installed
- optional, please specify if required: water-tight cast cable input
- optional, please specify if required: housing material flame-retardant according to ECE-R 118
- all cables used are flame-retardant according to ECE-R 118



WLAN

Frequency range:

2408 MHz to 2480 MHz (802.11b/g/n)

5150 MHz to 5850 MHz (802.11.a/h/j/n/ac)

VSWR*: <2.0 typically

Peak Gain*:

+3 dBi type (2400 MHz)

+1 dBi type (5300 MHz)

Power max.: 10 W

Frequency range:

2408 MHz to 2480 MHz (802.11b/g/n)

5150 MHz to 5850 MHz (802.11.a/h/j/n/ac)

VSWR*: <2.0 typically

Peak Gain*:

+3 dBi type (2400 MHz)

+1 dBi type (5300 MHz)

Power max.: 10 W

Plug: SMA (m) (gold), SMA (m) (gold)

* measured with 0.6 m cable on a ground plane of 300 mm x 300 mm

Mechanical data

Dimension (Ø x H): approx. 76 mm x 21 mm

Temperature range: -40 °C to +85 °C

Cables:

RG 174 super low loss for wireless, LTE

RG 174 standard for other functions

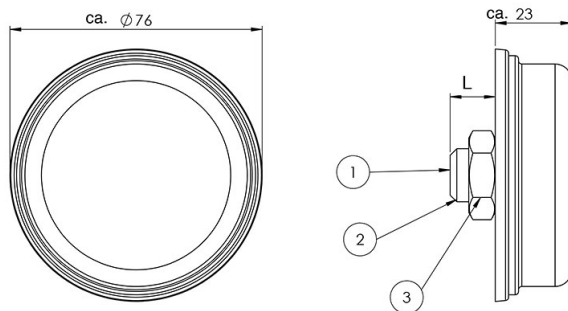

Art Gewindeboden	Bezeichnung	Länge L
Kunststoffboden	XX	13,6 mm ± 0,25
Aludruckguß	AW / AL	13,6 mm ± 0,25
Aludruckguß	AW17 / AL17	15,6 mm ± 0,25
Aludruckguß	AW40 / AL40	38,6 mm ± 0,25

POS-NR.	BENENNUNG
1	Kabeleingang
2	Mutter M16 x 1,5
3	Gewinde M16 x 1,5

* measured with 0.6 m cable on a ground plane of 300 mm x 300 mm

Radiation diagram

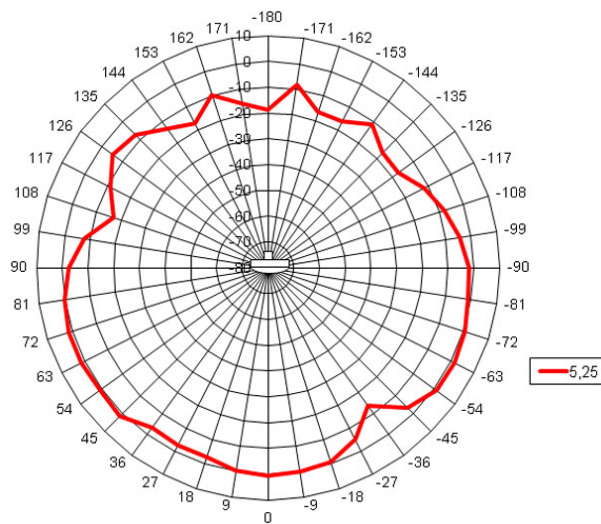
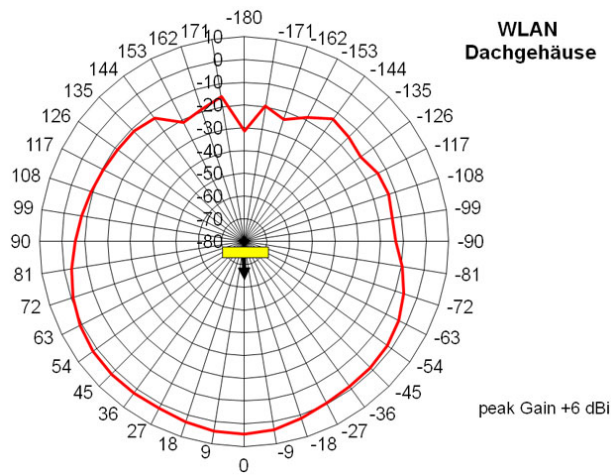

* measured with 0.6 m cable on a ground plane of 300 mm x 300 mm

Radiation diagram

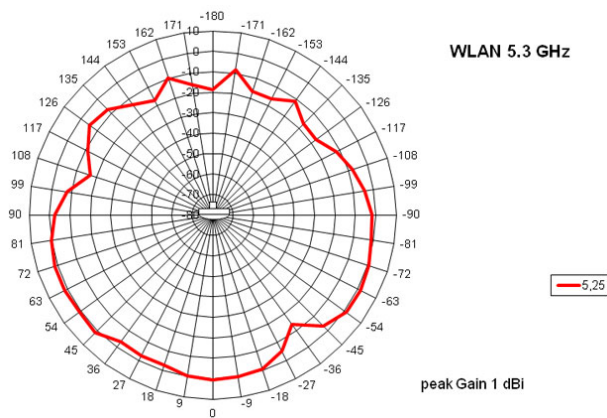
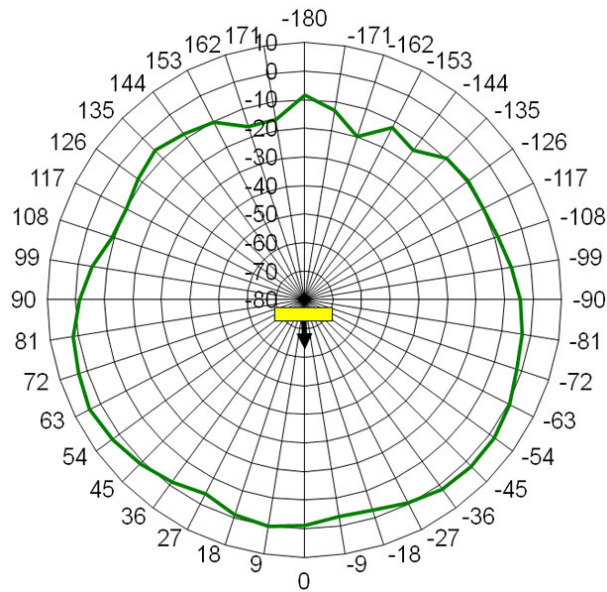

* measured with 0.6 m cable on a ground plane of 300 mm x 300 mm

Installation instructions

Installation instructions for roof mount antennas, ROOFMOUNT

Important: Please observe the maximum tightening torque of the M16x1.5 mounting nut

- housing 70 with plastic base PC: min. 4 Nm to max. 6 Nm
 - housing 70 with aluminum die-cast base: min. 12 Nm to max. 15 Nm
- (all seals on the antenna side, see illustration)

- housing 98 with plastic base PS/ABS: min. 6 Nm to max. 8 Nm
- no additional ground plane required, the antenna has an internal ground plane.

The radiation patterns have been measured on a ground plane of 300 mm × 300 mm, with a cable length of 60 cm.

- can be mounted on all clean, rust-free surfaces.
- the cable input can be optionally cast so the antenna can be mounted on an external carrier (PW, AW)
- antenna 70 is watertight when mounted: IP69K compliant; optional IP69K compliant cast cable input
- mounting hole for all ROOFMOUNT antennas: 16.2 mm diameter (+ 2mm, -0mm)
- antenna 98 is basically watertight from ultrasonic welding, with an optional cast cable input, IP69K compliant.

Conclusion

This data sheet was created with a pre-programmed configuration. We have compiled the data for it to the best of our knowledge. However, due to the volume of data, we are unable to pre-test all possibilities, nor assign a customer-specific description. Therefore we would ask you to send us a copy for approval.