

TWO-WAY RADIO



TWO-WAY RADIO

14x12.5cm

To customers

Thank you very much for using our two-way radios. This product has a newly developed function menu and humanism operation design, making it easy to use. It will meet your requirement by the compact size and reasonable price.

Welcome to use our two-way radio

Professional FM Transceiver

Main functions

TOT

Scan

CTCSS/DCS

Chinese and English voice prompt

Battery Saving function

Low battery alert

Narrow band selectable

VOX

Programming protect

Busy lock function

Squelch level selectable

Scrambler

ANI function (Active Noise Cancelling)



CONTENTS

- 01 Unpacking and checking equipment
- 02 Charging the Battery
- 02 Using the battery
- 05 Installing and uninstalling of the accessories
- 07 Getting acquainted
- 10 Basic operations
- 15 Specification
- 17 Trouble shooting guide
- 18 Warranty card

Unpacking and checking equipment
Charging the battery
Using the battery

Professional FM Transceiver

Unpacking and checking equipment

Welcome to use our two-way radio. Carefully unpack the radio. We recommend you check the items listed in the following table before discarding the package. If any item is missing, please contact local dealer immediately.

Supplied Accessories

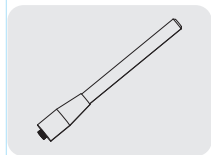

Antenna



Li-ion Battery



Belt Clip



User's Manual

Optional Accessories

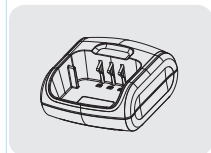

Charge



Charger Adapter

Charging the Battery

please use the designated battery charger to charge battery, and follow the steps:

- Insert DC jack of power adapter into DC jack behind the charging kit.
- Insert power adapter into AC power supply socket, now the charging red and green indicator lights, successfully connect the power supply.
- Insert the battery to radio equipped with battery into the charging kit. Red indicator keeps lighting means radio is under charging. Red indicator flashes means battery not be used for long time and over-discharged. And will Turn to normal charge when red indicator keeps lighting.
- Confirm the battery is fully charged, when red indicator goes out.
- Please take off the adaptor and battery.

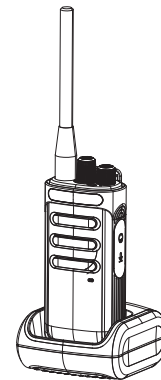

Using the battery

The battery is not completely charged at the factory, please charge it before using.

After purchase or extended storage (more than two months), the first time to charge battery cannot make battery reach its normal operating capacity. After repeating charge /discharge it two or three times, the operating capacity will increase to its normal capacity.

Notice: After fully charge the battery, please do not charge it again and should take it off from

Note:

- The temperature for charging should be from 5°C to 40°C. Battery can not be over fully charged out of this temperature range. Please prepare a spare battery for the cooler weather and do not discard the defect battery. Because it may be used under the normal temperature.
- Please clean the battery terminal when it covers with some dust or dirty.
- To make sure the battery can be normal use and charge.
- Please turn off the radio power before charging.
- Do not charge the battery before radio or the battery being wet.
- Please change another new battery if battery can not be recover normal capacity after fully charged.

Battery Type

Please use the assigned battery to charge. It maybe explode and harm to human body if use other batteries.

Safety Tips

- Do not discard the battery into fire.
- Do not unfold the battery case by yourself.

Battery Storage

- 1) Please fully charged battery first to store before long time no use it. To avoid the battery self over discharge and being damage.
- 2) To avoid short the battery capacity, please fully charged the battery after long time no use. Recommend charge the battery again after six months.
- 3) Please take care of the battery when store and use.

Installing and uninstalling of the accessories Getting Acquainted

Professional FM Transceiver

Installing and uninstalling of the accessories

Installing / Removing the Battery

To install the battery into the battery positioning hole of radio bottom, then press the battery, make the button completely to lock battery. To remove the battery, please turn off the radio, and then push up the battery button of radio top, finally take off the battery.

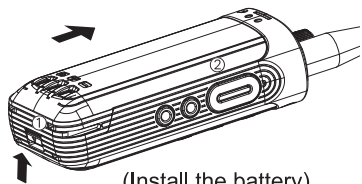

(Install the battery)

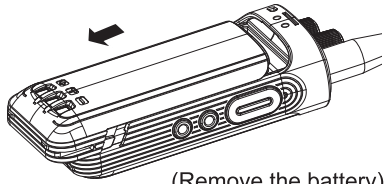

(Remove the battery)

Installing/Removing the Antenna

Screw the antenna into the connector on the top of the radio by holding the antenna at its base and turning it clockwise until secure.

To turn the antenna counter-clockwise until you can remove it.

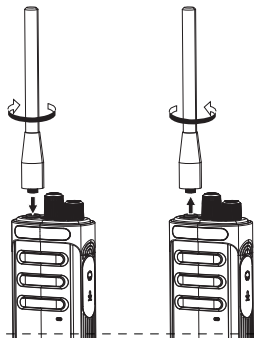

Installing Earphone /Programming Jack

Uncover earphone lid, directly insert earphones into earphone holes (earphones need to be additionally purchased)

You can use computer programming software to operate (consult with local dealers about computer programming software)

Note: If your radio developed with VOX function, you should re-turn on radio power once to active VOX function.

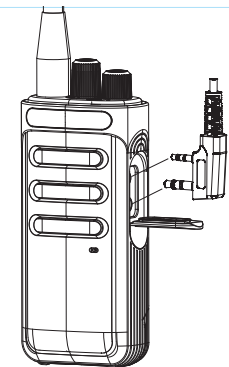

Installing the belt clip

If necessary, attach the belt clip to the back of battery with the screws supplied carry conveniently.

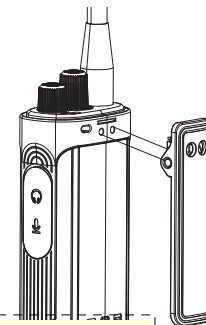

Getting Acquainted

