

PLEASE READ THE INSTRUCTION CAREFULLY BEFORE USE.

Model: FD-384UM

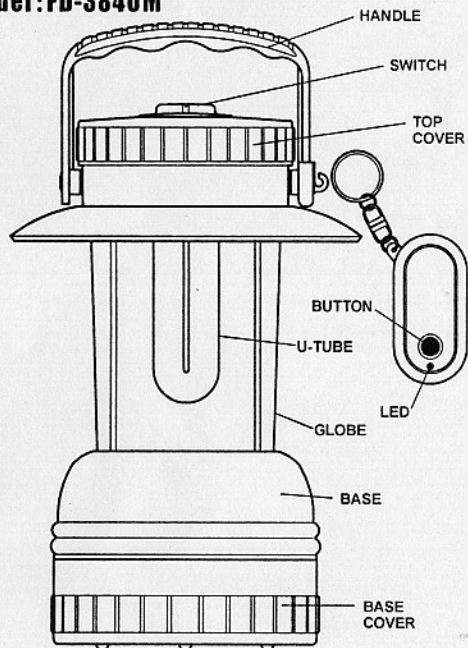

## IMPORTANT!

**WARNING:** Changes or modifications to this unit not expressly approved by the party responsible for compliance could void the user's authority to operate the equipment.

**NOTE:** This equipment has been tested and found to comply with the limits for a class B digital device, pursuant to Part 15 of the FCC Rules. These limits are designed to provide reasonable protection against harmful interference in a residential installation. This equipment generates, uses and can radiate radio frequency energy and, if not installed and used in accordance with the instructions, may cause harmful interference to radio communications.

However, there is no guarantee that interference will not occur in a particular installation. If this equipment does cause harmful interference to radio or television reception, which can be determined by turning the equipment off and on, the user is encouraged to try to correct the interference by one or more of the following measures:

- Reorient or relocate the receiving antenna.
- Increase the separation between the equipment and receiver.
- Connect the equipment into an outlet on a circuit different from that to which the receiver is needed.
- Consult the dealer or an experienced radio/TV technician for help.

## 1 BATTERIES INSTALLATION

THIS LANTERN IS POWERED BY 6 PCS. "D" SIZE BATTERIES.

- Switch lantern to "OFF" position
- Turn lantern upside down and turn base cover counter clockwise and lift off. (Fig. 1)
- Press tab and open battery cover.
- Insert with new 6 pcs. "D" size batteries (not included). (Fig. 2) Close battery cover and snap shut.
- Replace base cover and turn clockwise to close. Check to see that base is completely screwed on.

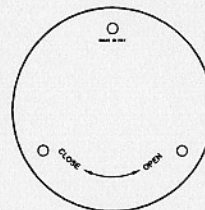

FIG. 1

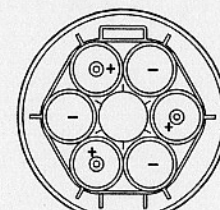

FIG. 2

THIS REMOTE CONTROLLER IS POWERED BY A "CR-2032" 3V LITHIUM BUTTON SIZE BATTERY.

- Turn the remote controller back and pull the battery holder out. (Fig. 3)
- Replace the battery with a new "CR-2032" 3V lithium button size battery.
- Make sure the battery installed in right position according to mark on the body. (Fig. 3)
- Reassemble the battery holder by insert into remote controller body. (Fig. 3)

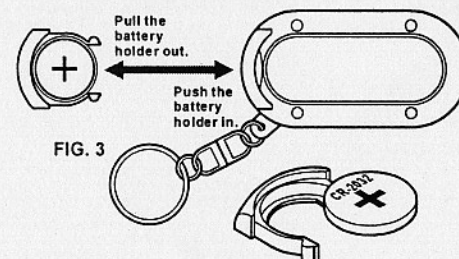

FIG. 3

**IMPORTANT: DO NOT MIX OLD AND NEW BATTERY. DO NOT MIX ALKALINE, STANDARD (CARBON-ZINC), OR RECHARGEABLE BATTERIES.**

## 2 OPERATION

- Your Lantern has a three position switch, ON, OFF, and REMOTE.
- Turn switch to (ON), the lantern is "ON". Or turn switch to (REMOTE) turn on "REMOTE" control function. Turn switch to (OFF) to turn "OFF" the lantern.

**WARNING: BE SURE TO TURN LANTERN "OFF" WHEN NOT IN USE. (Fig. 6)**

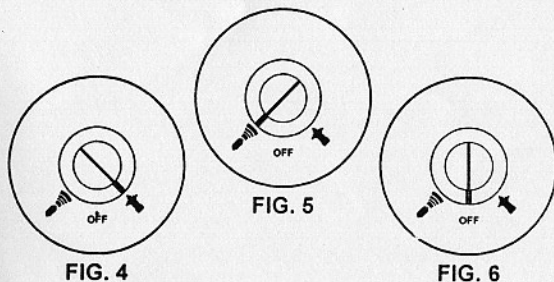

### REMOTE CONTROL

- Turn switch to (REMOTE) turn on "REMOTE" control function. (Fig. 5)
- Press button of REMOTE CONTROLLER to turn "ON" and "OFF" the lantern.
- The LED of REMOTE CONTROLLER lite when you press remote control switch. If the LED dim or doesn't lite, Replace the battery of REMOTE CONTROLLER according to the instruction.
- When the power of batteries lower than 4V, replace new batteries is must. Otherwise, the Remote Control may not function. (Fig. 1 and Fig. 2)

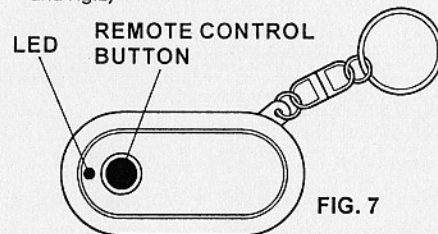

## 3 TUBE REPLACEMENT

THIS LANTERN USES A 7W "U" SHAPE LAMP TUBE.

- Switch lantern to "OFF" position. (Fig. 6)
- Twist the top cover counter-clockwise and life up to open it. (Fig. 8)
- Turn the top cover upside down and remove U-tube from holder by pull it upward with care. (Fig. 9)
- Replace tube with new 7W "U" shape lamp tube by insert into socket. (Fig. 9)
- Reassemble the top cover and twist it clockwise to secure it.

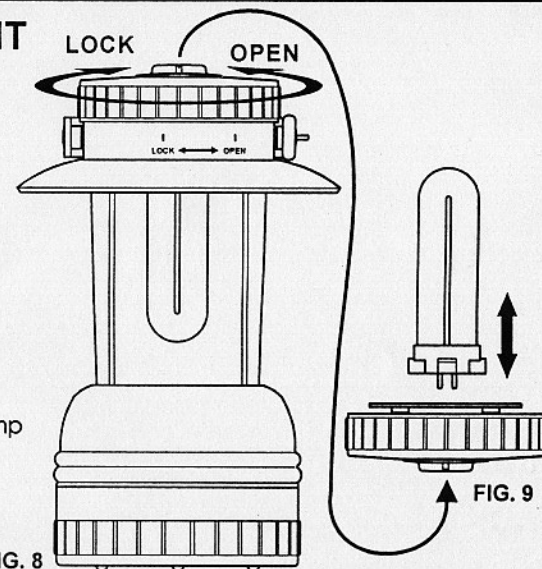

FIG. 8

FIG. 9

**NOTE: THE MANUFACTURER IS NOT RESPONSIBLE FOR ANY RADIO OR TV INTERFERENCE CAUSED BY UNAUTHORIZED MODIFICATIONS TO THIS EQUIPMENT. SUCH MODIFICATIONS COULD VOID THE USER'S AUTHORITY TO OPERATE THE EQUIPMENT.**