

2.4GHz

Wireless Digital Audio

Users Manual

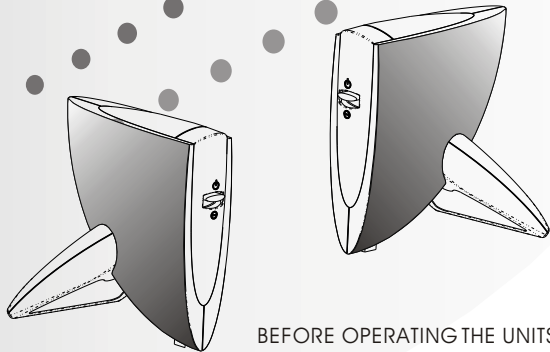

1. INTRODUCTION	1
2. PACKAGE CONTENTS	3
3. CONTROLS	3
4. SYSTEM INSTALLATION	4
5. OPERATIONS	4
6. TROUBLE SHOOTING	5

BEFORE OPERATING THE UNITS, PLEASE READ THIS MANUAL THOROUGHLY

GENERAL SAFETY SUMMARY



CAUTION
**RISK OF ELECTRONIC
SHOCK DO NOT OPEN**



CAUTION:
DO NOT REMOVE THE COVER FOR REDUCING THE RISK OF ELECTRIC SHOCK.
NO USER-SERVICEABLE PARTS INSIDE REFER SERVICING TO QUALIFIED SERVICE PERSONNEL.

WARNING

To prevent fire or shock hazard, do not expose the unit to rain or moisture.

IMPORTANT SAFETY INSTRUCTIONS

1. All the safety and operating instructions should be read before the product is operated.
2. The safety and operating instructions should be retained for future reference.
3. All warnings on the product and in the operating instructions should be adhered to.
4. All operating and use instructions should be followed.
5. Unplug this products from the wall outlet before cleaning. Do not use liquid cleaners or aerosol cleaners. Use a damp cloth for the cleaning.
6. Do not use attachments not recommended by the products manufacturer if they may cause hazards.
7. Do not use this product near water - for example, near a bath tub, wash bowl, kitchen sink, or laundry tub, in a wet basement, or near a swimming pool; and the like.
8. Any mounting of the product should follow the manufacturer's instructions, and should use a mounting accessory recommended by the manufacturer.
9. This product should be operated only from the type of power source indicated on the marking label. If you are not sure of the type or power supply to your home, consult your product dealer or local Power Company. For products intended to operate from battery power, or other sources, refer to the operating instruction.

10. Power supply cord should be routed so that they are not likely to be walked on or pinched by items placed upon or against them, paying particular attention to cords at plugs, or other sources, refer to the operating instructions.
11. For added protection for this product during a lightning storm, or it is left unattended and unused for long periods of time, unplug it from the wall outlet and disconnect cable system. This will prevent damage to the product due to lightning and powerline surges.
12. Never push objects of any kind into this product through openings as they may touch dangerous voltage points or short-out parts that could result in a fire or electronic shock. Never spill liquid of any kind on the product.
13. Do not overload wall outlets, extension cords, or integral convenience receptacles as this can result in a risk of fire or electric shock.
14. Unplug this product from the wall outlet and refer servicing to qualified service personnel under the following conditions.
 - When the power- supply cord or plug is damaged.
 - If liquid have been spilled, or objects have fallen into the products
 - If the product does not operate normally by following the operating instructions, adjust only those controls that are covered by the operating instructions as an improper adjustment of other control may result in damage and will often require extensive work by a qualified technician to restore this product to its normal operation.
 - When the product exhibits a distinct change in performance - this indicates a need for service.
 - If the products has been dropped or damaged in any way.
15. When replacement parts are required, be sure the service technician has used replacement parts specified by the manufacturer or that have the same characteristics as the original part. Unauthorized substitutions may result in fire, electric shock, or other hazards.
16. Upon completion of any service or repair to this product ask the service technician to perform safety checks to determine that the product is in proper operating condition.
17. The product should be situated away from heat sources such as radiators, heat registers, stoves, or other products including amplifiers that produce heat.

INTRODUCTION

Overview

The 2.4 GHz Wireless Digital Audio uses the latest wireless technology to transmit crystal-clear audio in a digital format. It makes you enjoy the true CD quality by eliminating the hassle of wire, and allows you to experience your favorite music where it belongs - on your stereo.

Main Features

- Digital Transmission higher sound quality
- 20 Hz ~ 20KHz (-1 dB) Audio Frequency Response
- +10 dBm Transmit Power.
- 92 dB Dynamic Range
- Audio Input Level : 4Vpp (Max).
- - 85 dBm Receive Sensitivity
- Range up to 50 metre (LOS)
- Avoid reception errors by employing forward error correction
- Auto mute Function
- Frequency 2400 ~ 2483.5 MHz
- 8 channels Auto Scan
- Embedded Antenna
- Antenna Diversity

Application

- Wireless home theatre systems for two rear speakers
- Wireless hi-fi stereo speaker systems
- Short-range Audio Broadcasting

Specification

Characteristic	Specification	
	Digital Audio Transmitter	Digital Audio Receiver
Description		
Power supply	9VDC	9VDC
Current consumption	93 mA (Max.)	65 mA (Max.)
Operating temperature	-10°C ~ +60°C	
Frequency band	2400 ~ 2483.5 MHz	
Modulation	FSK, Mod. Index = 0.5	
Channel number	8	
Channel spacing	9 MHz	
Channel frequency	2410, 2419, 2428, ~ 2473 MHz	
Frequency stability	+/- 100KHz	
Input impedance	> 10K Ohm	
Input level	4Vpp (Max)	
TX Power	EIRP + 10 dBm	
RX Sensitivity	-85 dBm (Typical)	
Output impedance	< 1K Ohm	
Output level	4 Vpp (Max.)	
Response	20 ~ 20 K Hz , -1 dB	
Dynamic range	92 dB (Typ.)	
Separation	80 dB (Typ.)	
SN ratio	87 dB (Typ.)	
THD	0.1 % (Typ.)	

PACKAGE CONTENTS

Check all of the components shown as below are included in box before using.

- | | |
|------------------------|-----|
| 1. Transmitter | X 1 |
| 2. Receiver | X 1 |
| 3. RCA Cable | X 2 |
| 4. 9V DC Power Adaptor | X 2 |
| 5. Users Manual | X 1 |



Transmitter



Receiver



Adaptor



RCA Cable

CONTROLS

1. Power Switch
2. Channel Selector (Transmitter Only)
3. RCA Jack
4. Adaptor Jack

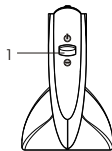

Front View

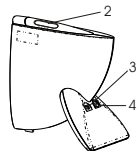

Side View

SYSTEM INSTALLATION

1. Connect the Transmitter to audio source with RCA cable.
2. Connect the Receiver to Speaker or Headphone with RCA cable.
3. With power adaptors plug the Transmitter and Receiver into standard electrical outlets.

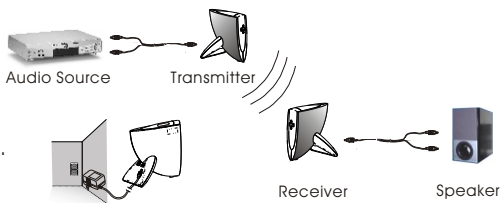

OPERATIONS

1. Turn on the Transmitter and Receiver.
2. Turn on audio source and speaker.
3. Adjust the channel selector on top of the Transmitter to find a best channel (8 channel selectable). Receiver will auto scan the channel to catch the audio signal. Make sure you clearly listen to the music through speakers if Receiver gets the channel.

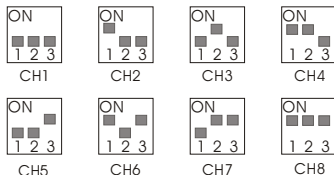

TROUBLE SHOOTING

Please read this users manual carefully before using the Wireless Audio Product. If you still have difficulties to use the product, consult the following syndrome, which will guide you to solve most common problems.

● No Sound

1. Check the adaptor rightly connected.
2. Power On/Off switch is in right position.
3. Check all the cables well and rightly connected.
4. Check Transmitter and Receiver at the same channel.

● Having Interference

1. Move Transmitter and Receiver slowly to find a best reception position for your audio system.
2. Shorten the distance between Transmitter and Receiver.
3. Check if there is any interference of 2.4GHz radio frequency sources or electrical appliances, such as microwave oven, 2.4GHz cordless phone, WLAN or Bluetooth headset, near the Receiver source.
4. If there is any interference radio frequency source near Receiver, try to switch the channel to get a best performance.
5. Check Transmitter and Receiver at the same channel.

Federal Communication Commission Interference Statement:

This equipment has been tested and found to comply with the limits for a Class B digital device, pursuant to Part 15 of the FCC Rules. These limits are designed to provide reasonable protection against harmful interference in a residential installation.

This equipment generates, uses, and can radiate radio frequency energy and, if not installed and used in accordance with the instructions, may cause harmful interference to radio communications. However, there is no guarantee that interference will not occur in a particular installation. If this equipment does cause harmful interference to radio or television reception, which can be determined by turning the equipment off and on, the user is encouraged to try to correct the interference by one of the following measures:

- Reorient or relocate the receiving antenna.
- Increase the separation between the equipment and receiver.
- Connect the equipment into an outlet on a circuit different from that to which the receiver is connected.
- Consult the dealer or an experienced radio/TV technician for help.

FCC Caution:

To assure continued compliance, any changes or modifications not expressly approved by the party responsible for compliance could void the user's authority to operate this equipment. (Example - use only shielded interface cables when connecting to computer or peripheral devices).

FCC Radiation Exposure Statement:

This equipment complies with FCC RF radiation exposure limits set forth for an uncontrolled environment. This equipment should be installed and operated with a minimum distance of 20 centimeters between the radiator and your body.

This device complies with Part 15 of the FCC Rules. Operation is subject to the following two conditions: (1) This device may not cause harmful interference, and (2) This device must accept any interference received, including interference that may cause undesired operation.

2.4GHz

Wireless Digital Audio

