

## **2.4GHz Wireless Digital Audio**

### **POCKET RECEIVER USB & LINE-IN 2 IN 1 TRANSMITTER**



## **Users Manual**

Before operating the units, please read this manual thoroughly.

## GENERAL SAFETY SUMMARY



### WARNING

To prevent fire or shock hazard, do not expose the unit to rain or moisture.

### IMPORTANT SAFETY INSTRUCTIONS

1. All the safety and operating instructions should be read before the product is operated.
2. The safety and operating instructions should be retained for future reference.
3. All warnings on the product and in the operating instructions should be adhered to.
4. All operating and use instructions should be followed.
5. Do not use liquid cleaners or aerosol cleaners. Use a damp cloth for the cleaning.
6. Do not use attachments not recommended by the products manufacturer if they may cause hazards.
7. Do not use this product near water - for example, near a bath tub, wash bowl, kitchen sink, or laundry tub, in a wet basement, or near a swimming pool; and the like.
8. Never push objects of any kind into this product through openings as they may touch dangerous voltage points or short-out parts that could result in a fire or electronic shock. Never spill liquid of any kind on the product.

9. Unplug the USB transmitter from the computer and refer servicing to qualified service personnel under the following conditions.
  - When the computer or USB transmitter is damaged.
  - If liquid have been spilled, or objects have fallen into the computer.
  - If the product does not operate normally by following the operating instructions, adjust only those controls that are covered by the operating instructions as an improper adjustment of other control, may result in damage and will often require extensive work by a qualified technician to restore this product to its normal operation.
  - When the product exhibits a distinct change in performance - this indicates a need for service.
  - If the products has been dropped or damaged in any way.
10. When replacement parts are required, be sure the service technician has used replacement parts specified by the manufacturer or that have the same characteristics as the original part. Unauthorized substitutions may result in fire, electric shock, or other hazards.
11. Upon completion of any service or repair to this product ask the service technician to perform safety checks to determine that the product is in proper operating condition.
12. The product should be situated away from heat sources such as radiators, heat registers, stoves, or other products including amplifiers that produce heat.

## **Table of Contents**

<b>Overview</b> .....	1
<b>Features</b> .....	1
<b>Package Contents</b> .....	2
<b>Names of parts</b> .....	2
<b>Getting Started</b> .....	3
<b>Operation</b> .....	4
<b>Trouble Shooting</b> .....	5
<b>Specification</b> .....	6



## Overview

The 2.4GHz Wireless Digital Audio uses the latest wireless technology to transmit crystal-clear audio in a digital format. The pocket size receiver is easy to carry and the transmitter has two way to decide Audio source. It makes you enjoy the true CD quality by eliminating the hassle of wire, and allows you to experience your favorite music where it belongs - on your stereo.



## Features

- Transmitter supporting both of USB Audio in and Line-in connecting
- Transmit wirelessly music from any audio source such as PC (Notebook), DVD and CD player
- Non-compression for high sound quality with delay time 0.5 ms
- Audio Frequency response: 20Hz ~20KHz (-3dB)
- Operating at 2.4 GHz ISM band with digital signal
- With 8 selectable channels / Auto-scan channel selected on RX side
- Stylish Pocket size RX with two AAA battery; 3.5mmφ Earphone jack for Stereo Line Out
- Transmitter power from DC adaptor or USB
- Transmit range 30m (Open field)
- Antenna for TX and RX embedded  
Signals penetrate through walls
- Easily install plug-in need only
- Low power consumption
- Digital transmission at CD quality

## Package Contents

Check the package before you enjoy the product.

- Pocket receiver (X1)
- USB / Line in Transmitter (X1)
- 1.5V AAA battery (X2)
- 9V DC adaptor (X1)
- Earphone (X1)
- USB cable (X1)
- RCA cable (X1)
- RCA plug jack(X1)
- Users Manual(X1)

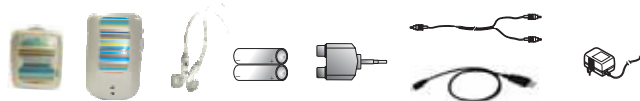

## Names of parts

### Transmitter

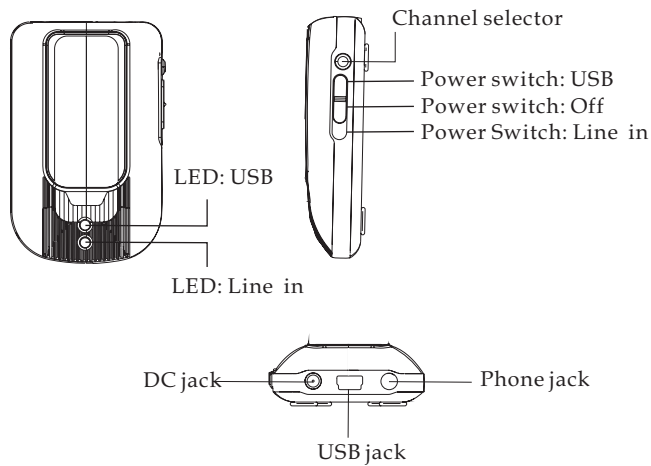

## Receiver

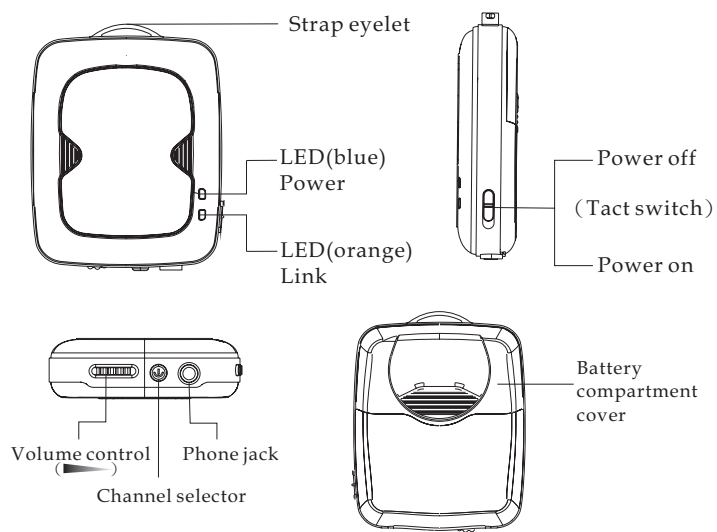

## Getting Start

1. Open the battery compartment cover of receiver.
2. Insert 2X AAA batteries into battery compartment. Make sure the plus and minus poles of battery was correctly touched their contains.
3. Close the battery compartment cover.



#### 4. Installation of earphone and Receiver

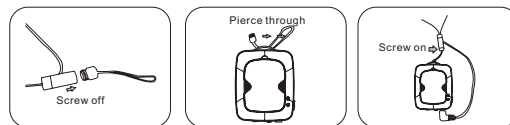

#### 4. Audio source to transmitter

4.1 Audio source(PC or Notebook):Connect the transmitter to audio source with USB cable.



4.2 Audio source( DVD,VCD,CD,DAB Mp3):Connect the transmitter to audio source with RCA cable.

5. With power adaptor plug the transmitter into standard electric outlet.(If Audio source is from PC or Notebook, you don't need to plug with power adaptor.)

## Operations

1. Turn on the Transmitter and Receiver.
2. Turn on the audio source.
3. Adjust the channel selector to the same channel between Transmitter and Receiver.





## Trouble Shooting

Please read this users manual carefully before using the Wireless Audio Product. If you still have difficulties to use the product, consult the following syndrome, which will guide you to solve most common problems.

### ● No Sound

1. Check the adaptor rightly connected.
2. Check the batteries are in full electric power.
3. Power On/Off switch is in right position.
4. Check all the cables well and rightly connected.
5. Check Transmitter and Receiver at the same channel.

### ● Having Interference

1. Move Transmitter and Receiver slowly to find a best reception position for your audio system.
2. Shorten the distance between Transmitter and Receiver.
3. Check if there is any interference of 2.4GHz radio frequency sources or electrical appliances, such as microwave oven, 2.4GHz cordless phone, WLAN or Bluetooth headset, near the Receiver source.
4. Please turn off the interference source or change the channel.
5. If there is any interference radio frequency source near Receiver, try to switch the channel to get a best performance.
6. Check Transmitter and Receiver at the same channel.



## Specification

Item	Specification	
Description	Transmitter	Receiver
Supply voltage	USB power or 9VDC	1.2 or 1.5V AAA battery x2
Current consumption	100 mA (Typical.)	120 mA @2.4VDC (Typical)
Operating temperature	-10°C ~ +60°C	
Frequency range	2400 ~ 2483.5 MHz	
Modulation	FSK (Modulation Index 0.5)	
Channel number	8	
Channel spacing	9 MHz	
Channel frequency	2410, 2419 ~ 2473 MHz	
Frequency stability	±100 KHz	
TX Power	EIRP +10 dBm	
RX Sensitivity		-85 dBm (Typical)
Response	20 ~ 20 KHz, -3dB	
Dynamic range	83dB (Typical)	
Separation	75dB (Typical)	
SN ratio	83dB (Typical)	
THD	-73dB (Typical)	

### ***Federal Communication Commission Interference Statement***

This equipment has been tested and found to comply with the limits for a Class B digital device, pursuant to Part 15 of the FCC Rules. These limits are designed to provide reasonable protection against harmful interference in a residential installation.

This equipment generates, uses and can radiate radio frequency energy and, if not installed and used in accordance with the instructions, may cause harmful interference to radio communications. However, there is no guarantee that interference will not occur in a particular installation. If this equipment does cause harmful interference to radio or television reception, which can be determined by turning the equipment off and on, the user is encouraged to try to correct the interference by one of the following measures:

- Reorient or relocate the receiving antenna.
- Increase the separation between the equipment and receiver.
- Connect the equipment into an outlet on a circuit different from that to which the receiver is connected.
- Consult the dealer or an experienced radio/TV technician for help.

***FCC Caution*** :To assure continued compliance, any changes or modifications not expressly approved by the party responsible for compliance could void the user's authority to operate this equipment. (Example - use only shielded interface cables when connecting to computer or peripheral devices).

### ***FCC Radiation Exposure Statement***

This equipment complies with FCC RF radiation exposure limits set forth for an uncontrolled environment. This equipment should be installed and operated with a minimum distance of 20 centimeters between the radiator and your body.

This device complies with Part 15 of the FCC Rules. Operation is subject to the following two conditions:

(1) This device may not cause harmful interference, and (2) This device must accept any interference received, including interference that may cause undesired operation.