



safety and warranty information







Google Chromebook Pixel

GETTING STARTED

It's pretty easy to get started with your new Chromebook.

Simply...

1

Plug in your Chromebook and open the display

2

Select your preferred Wi-Fi network

3

Sign in with your Google Account
or take a minute to create one

4

Browse the Getting Started app for tips on using your new Chromebook



This manual lays out a few things you should know regarding the safe use of your Chromebook Pixel. While you're probably aware of most of these things already, it's still a good idea to read this information as a reminder, and to avoid taking chances with your safety. Plus, our lawyers worked long and hard to put this together for your enjoyment.

SAFETY NOTICES

This product contains sensitive components, so it's important that you treat it with care. To keep your Chromebook in tip top shape, it's best not to drop, disassemble or deform it. And while we're on the subject, don't bend, puncture or incinerate it either.

Do your best to avoid spilling liquids or food on your device, and avoid exposure to moisture and extreme temperatures. That means you shouldn't bring your Chromebook Pixel underwater or into outer space (unless, of course, you're in a spaceship).

Do not insert foreign objects into the device – appropriate peripherals, like a USB drive, should only be inserted into their designated ports. And of course, please keep the device and accessories away from small children as they contain small parts that may present a choking hazard.

When you perform repetitive activities such as typing or playing games on any device, you may experience occasional discomfort in your hands, wrists, arms, shoulders, neck, or other parts of your body. This is a good sign you should put your Chromebook Pixel down and take a walk, go for a jog or maybe jump around on a trampoline for a while. If you're still experiencing discomfort after your break, consider calling a physician.

When being used for prolonged periods of time, electronic devices may heat up and become uncomfortable or dangerous when in contact with your skin. Also, this device has a wireless WAN and 4G/LTE (LTE model only) which can interfere with pacemakers. If you use a pacemaker, please contact your medical device manufacturer to ensure you can safely operate this device.

The wireless WAN and 4G/LTE (LTE model only) can also interfere with the navigation systems of an aircraft so use your Chromebook Pixel in accordance with instructions provided by the airline. If you're piloting the plane, please wait until you've safely landed to use your Chromebook.





This product does not contain any user-serviceable parts. Repairs should only be made by an authorized technician. Unauthorized repairs or modifications could result in permanent damage to the device, and void your warranty and your authority to operate it under applicable regulations. And no one wants that to happen.

BATTERY

This device contains a lithium-ion battery. There is a risk of explosion, fire and burns if the battery is handled improperly. Don't puncture, incinerate, short the contacts, try to disassemble, or expose the battery to water or high temperatures (>60 degrees C/140 degrees F/333.15 degrees Kelvin).

SETTING UP YOUR CHROMEBOOK

Assembling your power adapter

Your Chromebook Pixel power adapter consists of two pieces: the power brick with a cord that connects to your Chromebook and the plug that fits into a power outlet of your home. You can choose between two plugs depending on how far you want to stray from the outlet. When swapping between the two plugs, make sure you use one that is compatible with local sockets and compliant with local standards. To swap between plugs, press the eject button and pull on the plug as shown below.

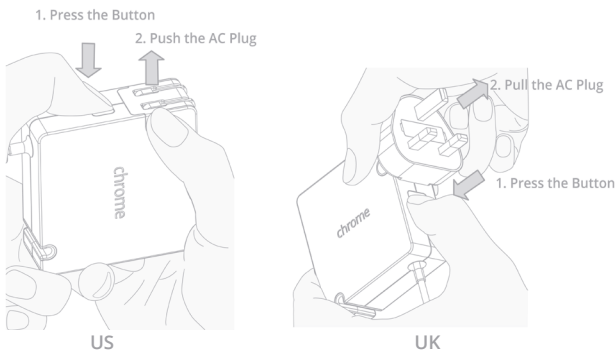



Charging your Chromebook

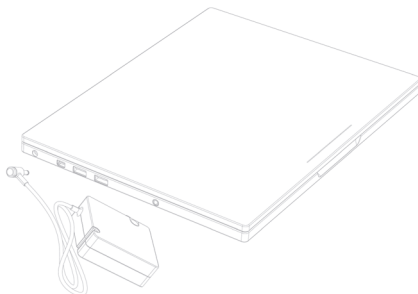

Attach the cord from the power adapter as indicated. Please do not use other, non-approved power adapters. The battery is not fully charged when your Chromebook Pixel arrives, and will charge once the power adapter is connected. You will know that charging is complete when the power input light changes from yellow to green.

To maximize the time that you can spend adventuring without your power adapter, the default settings put the display to sleep if your Chromebook is inactive for 6 minutes (or 8 minutes if it is plugged in). Similarly, the entire system goes into sleep mode after 10 minutes of inactivity (or 30 minutes if it is plugged in). To wake your Chromebook up from sleep, hit a key on the keypad, press the power button, touch the trackpad, or open the lid.

Opening the display

When opening or closing the display panel, place one hand on the palm rest to hold the device in place and use the other hand to slowly open or close the display panel. You can turn on the power by pressing the button indicated in the figure, or just by opening the display panel. Do not use excessive force when opening or closing the display panel; you are stronger than you think.

If your Chromebook Pixel behaves abnormally (e.g. becomes discolored, heats up excessively, emits a foul odor, starts requesting fancy tropical vacations), stop using it and contact us immediately.





REGULATORY NOTICES

Manufacturer Information

Google, Inc.
1600 Amphitheatre Parkway
Mountain View, California 94043

USA

FCC Compliance

This device complies with part 15 of the FCC Rules. Operation is subject to the following two conditions: (1) this device may not cause harmful interference, and (2) this device must accept any interference received, including interference that may cause undesired operation. This equipment has been tested and found to comply with the limits for a Class B digital device, pursuant to part 15 of the FCC Rules. These limits are designed to provide reasonable protection against harmful interference in a residential installation. This equipment generates, uses, and can radiate radio frequency energy and may cause harmful interference to radio communications if not installed and used in accordance with the instructions. If this equipment does cause harmful interference to radio or television reception (which can be determined by turning the equipment off and on) the user is encouraged to try to correct the interference by one of the following measures:

- A. Reorient or relocate the receiving antenna.
- B. Increase the separation between the equipment and the receiver.
- C. Connect the equipment to an outlet on a circuit different from the receiver.
- D. Consult the dealer or an experienced radio/TV technician for help.
- E. All of the above.

Changes or modifications not expressly approved by the party responsible for compliance could void the user's authority to operate the equipment.

Operations in the 5.15-5.25 GHz band are restricted to indoor usage only.

Canada

This device complies with Canadian RSS-210.

This device complies with Industry Canada license-exempt RSS standards. Operation of this device is subject to the following two conditions: 1) This device may





not cause interference and 2) This device must accept any interference, including interference that may cause undesired operation of the device.

Ce dispositif est conforme à la norme CNR-210 d'Industrie Canada applicable aux appareils radio exempts de licence. Son fonctionnement est sujet aux deux conditions suivantes: (1) le dispositif ne doit pas produire de brouillage préjudiciable, et (2) ce dispositif doit accepter tout brouillage reçu, y compris un brouillage susceptible de provoquer un fonctionnement indésirable.

Caution:

- i. The device for operation in the band 5150-5250 MHz is only for indoor use to reduce the potential for harmful interference to co-channel mobile satellite systems.
- ii. The maximum antenna gain permitted for devices in the bands 5250-5350 MHz and 5470-5725 MHz shall comply with the e.i.r.p. limit.
- iii. The maximum antenna gain permitted for devices in the band 5725-5825 MHz shall comply with the e.i.r.p. limits specified for point-to-point and non point-to-point operation as appropriate.
- iv. Users should also be advised that high-power radars are allocated as primary users (i.e. priority users) of the bands 5250-5350 MHz and 5650-5850 MHz and these radars could cause interference and/or damage to LE-LAN devices.

Avertissement:

- i. les dispositifs fonctionnant dans la bande 5 150-5 250 MHz sont réservés uniquement pour une utilisation à l'intérieur afin de réduire les risques de brouillage préjudiciable aux systèmes de satellites mobiles utilisant les mêmes canaux;
- ii. le gain maximal d'antenne permis pour les dispositifs utilisant les bandes 5 250-5 350 MHz et 5 470-5 725 MHz doit se conformer à la limite de p.i.r.e.;
- iii. le gain maximal d'antenne permis (pour les dispositifs utilisant la bande 5 725-5 825 MHz) doit se conformer à la limite de p.i.r.e. spécifiée pour l'exploitation point à point et non point à point, selon le cas.(iv) De plus, les utilisateurs devraient aussi être avisés que les utilisateurs de radars de haute puissance sont désignés utilisateurs principaux (c.-à-d., qu'ils ont la priorité) pour les bandes 5 250-5 350 MHz et 5 650-5 850 MHz et que ces radars pourraient causer du brouillage et/ou des dommages aux dispositifs LAN-EL.





European Union

CE 0560 ⚠

Products intended for sale within the European Union are marked with the Conformité Européene (CE) Marking, which indicates compliance with the applicable Directives. This device has been tested and found to comply with the following European directives:

EMC Directive 2004/108/EC
Low Voltage Directive 2006/95/EC
R&TTE Directive 1999/5/EC
Eco-design Directive 2005/32
RoHS II Directive 2011/65

This device may be operated in all member states of the EU as well as Switzerland, Norway, Iceland, Liechtenstein and Turkey.

AT	EE	HU	LU	SK	IS	RO
BE	FI	IE	MT	SI	LI	TR
CY	FR	IT*	NL	ES	NO	GB
CZ	DE	LV	PL	SE	CH	DK
GR	LT	PT	BG			

* In Italy, for private use a general authorization is required if WAS/RLAN's are used outside own premises. For public use, a general authorization is required.

You can find Google's Declaration of Conformity at www.google.com/chromebook/pixel/conformity

Radio Frequency and Specific Absorption Rate (SAR)

This device complies with the USA, Canada and European Union portable RF exposure limit set forth for an uncontrolled environment and is safe for intended operation as described in this manual. Your Chromebook is intended to be used normally at a distance of at least 20 cm. RF exposure reduction can be achieved by keeping the device as far as possible from the user's body or setting the device to lower output power if such function is available.





The Waste Electrical and Electronic Equipment (WEEE) Directive

The Waste Electrical and Electronic Equipment (WEEE) Directive requires that all Electrical and Electronic Equipment (EEE) must be marked with the symbol of the crossed-out wheeled bin:



This symbol indicates that the equipment you have purchased must not be disposed of as unsorted municipal waste. Disposing of WEEE together with normal waste may pose a risk to the environment and to human health, due to certain substances used in that equipment.

Under the WEEE Directive, each EU Member State is responsible for achieving a high level of collection of WEEE for treatment, recovery and environmentally sound disposal. Before disposing of your old equipment, think about possible ways to reduce the amount of WEEE you create. By simply extending the life of your equipment, for example by re-using or recovering it, you will have reduced waste and helped the EU achieve its objectives.

The success of this EU policy will depend on your active contribution in returning your WEEE to the appropriate facilities dedicated to the disposal of such waste.

ENERGY STAR®



By using ENERGY STAR qualified products and taking advantage of the power-management features of your computer, you can help reduce the consumption of electricity. Reduced electrical consumption can contribute to potential financial savings, a cleaner environment, and the reduction of greenhouse gas emissions. For more information about ENERGY STAR, visit the following Web site: <http://www.energystar.gov>





GOOGLE CHROMEBOOK PIXEL LIMITED WARRANTY – US

Hi, and thanks for taking a look at what most of the world ignores. Don't worry, we'll make this as fast and as enjoyable as possible.

Google warrants your Chromebook Pixel against defects in materials and workmanship under normal use in accordance with Google's published user documentation for one year from the date of original retail purchase in its original packaging by you ("Limited Warranty"). Try to avoid participating in extreme athletic events while simultaneously using your Chromebook Pixel, and you should be fine.

This Limited Warranty is only valid and enforceable in locations the Chromebook Pixel is sold and will apply only if you purchased your Chromebook Pixel from Google or its authorized resellers. This Limited Warranty also only applies to the hardware components (and not any software elements) of the Chromebook Pixel and this Limited Warranty does not apply to damage caused by normal wear and tear, accidents, misuse (including failure to follow product documentation), neglect, disassembly, alterations, servicing other than by Google authorized technicians, and external causes such as but not limited to water damage, extreme thermal or environmental conditions. Read: Don't leave it in the car during a summer trip to Death Valley.

This Limited Warranty does not guarantee that use of the Chromebook Pixel will be uninterrupted or error free. We're not perfect, but we try very, very hard.

WARRANTY REMEDY: If a defect arises and you return your Chromebook Pixel during the one year Limited Warranty period, we will at our sole discretion and to the extent permitted by law either repair your Chromebook Pixel using new or refurbished parts, replace your Chromebook Pixel with a new or refurbished Chromebook Pixel functionally at least equivalent to yours or accept the return of the Chromebook Pixel in exchange for a refund of the purchase price you paid for your device. If Google repairs or replaces your Chromebook Pixel, the repaired or replaced Chromebook Pixel will continue to be warranted for the remaining time of the original warranty period. All returned parts for which you have received a replacement will become the property of Google. Nothing in this Limited Warranty will reduce or otherwise affect your statutory rights in relation to the Chromebook Pixel.





To make a claim under the Limited Warranty, please contact:

Google Chrome OS Support
855-31-PIXEL
chromebook.com/pixel/support

You must provide your name, contact information and the serial number located on the back of your device for support. In certain situations, you may also be required to provide a purchase receipt. It is your responsibility to back up all data prior to returning the device under this Limited Warranty.

THE MAXIMUM EXTENT PERMITTED BY APPLICABLE LAW, THE LIMITED WARRANTY WRITTEN ABOVE IS THE ONLY EXPRESS WARRANTY GOOGLE PROVIDES FOR THE CHROMEBOOK PIXEL, AND THE ABOVE REMEDY IS YOUR SOLE REMEDY. GOOGLE EXPRESSLY DISCLAIMS ALL OTHER WARRANTIES AND CONDITIONS OF ANY KIND, WHETHER STATUTORY OR IMPLIED, ARISING FROM COURSE OF CONDUCT OR OTHERWISE, REGARDING THE CHROMEBOOK PIXEL, EXCEPT THAT ANY IMPLIED WARRANTIES OF MERCHANTABILITY, FITNESS FOR A PARTICULAR PURPOSE, AND NON-INFRINGEMENT ARE LIMITED IN DURATION TO THE ONE YEAR PERIOD OF THE EXPRESS WARRANTY ABOVE.

Ok. We're more than halfway done. Hang in there.

Some States do not allow limitations on how long an implied warranty lasts, so the above limitation may not apply to you.

YOU EXPRESSLY UNDERSTAND AND AGREE THAT, TO THE MAXIMUM EXTENT PERMITTED BY APPLICABLE LAW, GOOGLE AND ITS SUBSIDIARIES AND AFFILIATES (COLLECTIVELY, "GOOGLE PARTIES") SHALL NOT BE LIABLE TO YOU UNDER ANY THEORY OF LIABILITY (WHETHER CONTRACT, TORT (INCLUDING NEGLIGENCE) OR FAILURE OF ANY WARRANTY OR OTHERWISE) FOR ANY INDIRECT, INCIDENTAL, SPECIAL, CONSEQUENTIAL OR EXEMPLARY DAMAGES THAT MAY BE INCURRED BY YOU IN CONNECTION WITH THE CHROMEBOOK PIXEL OR THESE TERMS, INCLUDING ANY LOSS OF DATA, WHETHER OR NOT A GOOGLE PARTY OR ITS REPRESENTATIVES HAVE BEEN ADVISED OF OR SHOULD HAVE BEEN AWARE OF THE POSSIBILITY OF ANY SUCH LOSSES ARISING. YOU EXPRESSLY UNDERSTAND AND AGREE THAT, TO THE MAXIMUM EXTENT PERMITTED BY APPLICABLE LAW, THE GOOGLE PARTIES' TOTAL LIABILITY IN CONNECTION WITH THE CHROMEBOOK PIXEL OR THIS LIMITED WARRANTY WILL NOT EXCEED THE AMOUNT YOU ACTUALLY PAID GOOGLE FOR THE CHROMEBOOK PIXEL.





Some States do not allow the exclusion of incidental or consequential damages, so the above limitation may not apply to you.

No employee or representative of Google or its affiliates or any third party is authorized to make any modification, extension or addition to this Limited Warranty. If any term of this Limited Warranty is held to be illegal or unenforceable, the remaining terms of this Limited Warranty will remain in full force and effect.

One...more...sentence...

This Limited Warranty is given by Google Inc., whose registered address is at 1600 Amphitheatre Parkway, Mountain View, CA, USA, 94043, and it gives you specific legal rights. You may have other rights which vary from State to State.

That's it. Thanks for reading; your attention to detail has not gone unnoticed. Now go enjoy your new Chromebook.

GOOGLE CHROMEBOOK PIXEL LIMITED WARRANTY - UK

Hi there, and thanks for taking a moment to peruse the finer points of your Chromebook Pixel's warranty. We promise this won't take long.

Google warrants that the Chromebook Pixel will be free from defects in materials and workmanship under normal use for two years from the date of original purchase by you anywhere in the UK ("Limited Warranty") -- it actually isn't all that limited, when you start to think about it.

This Limited Warranty is only valid and enforceable in the UK and will apply only if you purchased your Chromebook Pixel from Google or its authorized resellers. This Limited Warranty only applies to hardware components (and not any software elements) of the Chromebook Pixel and this Limited Warranty does not apply to damage caused by normal wear and tear, accidents, misuse (including failure to follow product documentation), neglect, disassembly, alterations and external causes such as but not limited to extreme thermal or environmental conditions. So if you're having any problems with your Chromebook Pixel, give us a call at 0800 917 9009 or visit google.co.uk/chromebook/pixel/support.

We'll be more than happy to help you figure out what the issue is. Also, we're required by law to say that this Limited Warranty does not guarantee that use of the Chromebook Pixel will be uninterrupted or error free (but you should be fine).





WARRANTY REMEDY: If a defect arises and you return your Chromebook Pixel during the two year Limited Warranty period, Google will in its sole discretion either repair your Chromebook Pixel using new or refurbished parts or replace your Chromebook Pixel with a new or refurbished Chromebook Pixel functionally at least equivalent to yours. If Google repairs or replaces the Chromebook Pixel, the repaired or replaced Chromebook Pixel will continue to be warranted for the remaining time of the original warranty period. All returned parts for which you have received a replacement will become the property of Google. Nothing in this Limited Warranty will reduce or otherwise affect your statutory rights in relation to the Chromebook Pixel. For further information about your statutory rights please contact your local authority Trading Standards Department or Citizens' Advice Bureau.

Only a few more paragraphs to go. You're doing great.

To make a claim under the Limited Warranty, please contact:

Google Chrome OS Support

0800 917 9009 or

google.co.uk/chromebook/pixel/support

You must provide your name, contact information and the serial number located on the back of your Chromebook Pixel to receive support. You may also be required to provide a purchase receipt. It is your responsibility to back up all data prior to returning the device under this Limited Warranty.

No employee or representative of Google or its affiliates or any third party is authorized to make any modification, extension or addition to this Limited Warranty. If any term of this Limited Warranty is held to be illegal or unenforceable, the remaining terms of this Limited Warranty will remain in full force and effect.

This Limited Warranty is given by Google Inc., whose registered address is at 1600 Amphitheatre Parkway, Mountain View, CA, USA, 94043.

Thanks again for reading. Enough small talk — it's time to use your new Chromebook.

3369EB D50F25 EEB211 009939 ...hmm...





WHAT GOES WHERE

