

Environmental notes:



The whole product also does not belong to household waste at the end of the product life. You can return it at collection points for the recycling of electronic and electrical instruments. The symbol on the item, instruction manual, hangtag or packing is showing this clearly. Materials should be recycled according to their respective markings. Recycling of old devices or other re-use of materials contained therein represents an important contribution to environmental protection.

Please ask at your local community for the correct collection point.

Disposal of batteries

Batteries should not be disposed of in the household waste. As the consumer you are legally obliged to return batteries containing harmful substances and all other used batteries.

You can hand in your old batteries at public collection points in your area or wherever batteries are sold. You will find these chemical abbreviations along with a crossed-out refuse bin on batteries containing harmful substances:



Pb = Battery contains lead
Cd = Battery contains cadmium
Hg = Battery contains mercury

CE Declaration

Hereby, MAY CHEONG GROUP FRANCE S.A.S., declares that this equipment is in compliance with the essential requirements and other relevant provisions of directive 2014/53/EU.

Frequency: 2.4GHz
Transmitting frequency band: 2.4-2.4835GHz
Max allowed transmitting power: <10mW

The declaration of conformity may be consult at:
MAY CHEONG GROUP FRANCE S.A.S., Parc Ariane - Le Vénus, 2 rue Hélène Boucher,
78280 Guyancourt, France.

The full text of the EU declaration of conformity is available at the following internet address:
www.maycheonggroup.com.hk/declaration-of-conformity

MADE IN CHINA



24M+

BUGATTI

MY FIRST RC



2.4GHz

#16-92013

Class 1 LED product

Contents:

Vehicle x 1 Transmitter x 1 Instruction Manual x 1

Battery Requirement:

Vehicle: 3 x 1.5V "AA" LR6/R6 batteries.
Transmitter: 3 x 1.5V "AAA" LR03/R03 batteries.

Transmitter: Battery installation (Refer to Diagram 1)

1. Use screwdriver to loosen the screw on the battery cover and to open the battery cover. (Screwdriver is not included).
2. Install 3 new 1.5V "AAA" LR03/R03 batteries with correct polarity (+/-) as shown inside the battery compartment.
3. Install the battery cover and then tighten the screw on the battery cover.

Vehicle: Battery Installation (Refer to Diagram 2)

1. Switch the power OFF.
2. Use screwdriver to loosen the screw on the battery cover and to open the battery cover. (Screwdriver is not included).
3. Install 3 new 1.5V "AA" LR6/R6 batteries with correct polarity (+/-) as shown inside the battery compartment.
4. Install the battery cover and then tighten the screw on the battery cover.

How to play: (Refer to Diagram 2, 3, 4 & 5)

1. Switch ON the vehicle.
2. Press the forward button on the left side of the transmitter to drive the vehicle forward. Then the headlights on the vehicle will light up and the engine sounds will be activated on the transmitter.
3. Press the backward button on the right side of the transmitter to drive the vehicle backward. Then the taillights on the vehicle will light up.
4. Press the horn button in the middle of the transmitter to activate the horn sounds.
5. Move down the left side of the transmitter to drive the vehicle to turn left, move down the right side of the transmitter to drive the vehicle to turn right.
6. If the vehicle does not run in a straight line, adjust the wheel alignment under the chassis.
7. Remember to switch OFF the vehicle power after playing.

Cautions:

1. Do not attempt to disassemble the products.
2. Do not operate the vehicle with same frequency with other players in same location. This will interfere and cause the vehicle to lose control.
3. Make sure the batteries are installed with correct polarity (+/-) as shown inside the battery compartment.
4. Remove the package, take out all accessories and assemble the product before giving it to children to play.

WARNING! All packaging materials, such as tape, plastic sheets, wire ties and tags, are not part of this toy and should be discarded for the child's safety. Surface wash only. Clean with damp cloth. This product should be used only under the supervision of an adult. Please keep this owner's instruction manual for future reference. It contains important information. We reserve the right to improve/revise the product specifications without notice.

Diagram 1 Battery installation

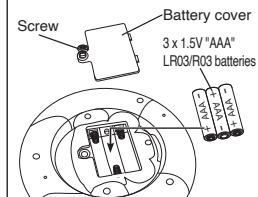

Diagram 2

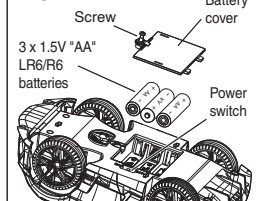

Diagram 3

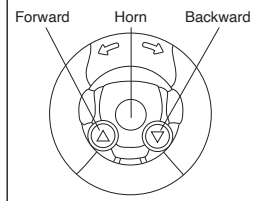

Diagram 4

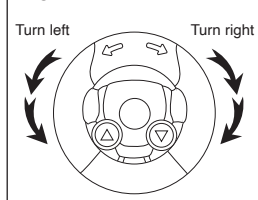
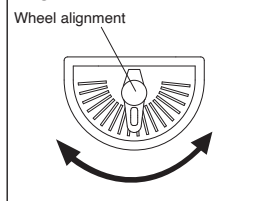

Diagram 5



Battery use

1. Alkaline batteries are recommended to use.
2. Only batteries of the same or equivalent type as recommended are to be used.
3. Do not mix alkaline, standard or rechargeable batteries.
4. Do not mix old and new batteries or different type of batteries.
5. Non-rechargeable batteries are not to be charged.
6. Rechargeable batteries are only to be charged under adult supervision.
7. Rechargeable batteries are to be removed from the product before they are charged.
8. Be sure to insert batteries with the correct polarities and always follow the battery manufacturer's instructions.
9. Remove all batteries from the vehicle and transmitter when not in use.
10. Exhausted batteries are to be removed from the product.
11. The supply terminals are not to be short-circuited.
12. Dispose of batteries properly. Do not dispose the batteries in fire — it may cause them to explode or leak causing injury or damage.
13. Battery change must be only made by adults!

FCC Label Compliance Statement:

This device complies with part 15 of the FCC rules. Operation is subject to the following two conditions:

1. This device may not cause harmful interference, and
 2. This device must accept any interference received, including interference that may cause undesired operation.
- Note : This equipment has been tested and found to comply with the limits for a Class B digital device, pursuant to Part 15 of the FCC Rules. These limits are designed to provide reasonable protection against harmful interference in a residential installation. This equipment generates, uses and can radiate radio frequency energy and, if not installed and used in accordance with the instructions, may cause harmful interference to radio communications. However, there is no guarantee that interference will not occur in a particular installation. If this equipment does cause harmful interference to radio or television reception, which can be determined by turning the equipment off and on, the user is encouraged to try to correct the interference by one or more of the following measures:
- Reorient or relocate the receiving antenna.
 - Increase the separation between the equipment and receiver.
 - Connect the equipment into an outlet on a circuit different from that to which the receiver is connected.
 - Consult the dealer or an experienced radio/TV technician for help.

Warning : Changes or modifications to this unit not expressly approved by the party responsible for compliance could void the user's authority to operate the equipment.

RSS-210 Compliance Statement:

This device contains licence-exempt transmitter(s)/receiver(s) that comply with Innovation, Science and Economic Development Canada's licence-exempt RSS(s). Operation is subject to the following two conditions:

1. This device may not cause interference.
2. This device must accept any interference, including interference that may cause undesired operation of the device.

Size: 297mm(W) x 210mm(H)

Color: 1C (Black)

材质: 韦纸

MAY CHEONG TOY PRODUCTS FTY. LTD.			DIECUT	
Job No.: BQ0228_22 Ins Eng	Finished by: liaoyili	Date: 2023-04-06	Test No.:	
Item No.: #16-92013 Most Success	Check by:	DWN Name: fanyinli	Material:	