



### FCC Label Compliance Statement:

This device complies with part 15 of the FCC rules. Operation is subject to the following two conditions:  
1. This device may not cause harmful interference, and  
2. This device must accept any interference received, including interference that may cause undesired operation.

Note: This equipment has been tested and found to comply with the limits for a Class B digital device, pursuant to Part 15 of the FCC Rules. These limits are designed to provide reasonable protection against harmful interference in a residential installation. This equipment generates, uses and can radiate radio frequency energy and, if not installed and used in accordance with the instructions, may cause harmful interference to radio communications. However, there is no guarantee that interference will not occur in a particular installation. If this equipment does cause harmful interference to radio or television reception, which can be determined by turning the equipment off and on, the user is encouraged to try to correct the interference by one or more of the following measures:

- Reorient or relocate the receiving antenna.
- Increase the separation between the equipment and receiver.
- Connect the equipment into an outlet on a circuit different from that to which the receiver is needed.
- Consult the dealer or an experienced radio/TV technician for help.

Warning: Changes or modifications to this unit not expressly approved by the party responsible for compliance could void the user's authority to operate the equipment.

### Trouble shooting

Problem	Cause	Correction
No Function	Low battery level Battery polarities are reversed	Replace with new batteries Insert the batteries with correct polarities as shown on the battery compartment
Drive Slow / Poor Turning Signal	The wheels are obstructed by foreign objects	Remove foreign objects on the vehicle / wheels
Poor distance control	Low battery level Strong interference of surroundings	Replace with new batteries Move to a better location for playing

### Warranty

All Maisto R/C vehicles have a 30 day limited warranty in function and performance. You may receive a new replacement vehicle if the defective vehicle is returned to Maisto freight prepaid and confirmed to be factory defective. We are not responsible for defects due to abusive use, or damaged for reasons other than factory defects. We also reserve the right to make the final judgment and decision. Check the FAQ section before you return the unit to Maisto.

### FAQ (Frequently Asked Questions)

**1) Why does my R/C vehicle not start?**  
Make sure the transmitter and the vehicle are turned on.  
Check to make sure the batteries are not drained.  
Make sure the batteries are installed per polarity indicators.  
Make sure all 4 wheels are not obstructed by any foreign objects.

**2) Why does my R/C vehicle make unusual noises?**  
Check to make sure the batteries are not drained.  
Check to make sure all 4 wheels are not obstructed by any foreign objects.

**3) What if I'm still having a problem?**  
Check the FAQ and make sure all attempts have been made to make the unit work.  
Check your purchase receipt date and make sure it's within the 30 days warranty period at the time you intend to send it back.  
Contact Maisto (see below), and tell us the model that you have, the problem(s) you are having, your daytime phone number, and any other information that might be helpful to us to correct the problem.  
If Maisto cannot solve your problem by mail, email or telephone, we will issue a return authorization number so you can return the unit to us for repair or replacement. **No returns will be accepted without a return authorization (RA) number issued by Maisto clearly marked on the outside of the package.** Pack the unit back in its original box or another box with sufficient protective material, include a copy of your dated store receipt and a description of the problem then send it freight prepaid to the address which we will provide once you receive your RA number.

Website: [www.maisto.com](http://www.maisto.com)  
Email: [rcsupport@maisto.com](mailto:rcsupport@maisto.com)  
Phone: (909) 357-7988  
8:30 a.m. - 5:00 p.m. / Monday-Friday / Pacific Time



[www.maisto.com](http://www.maisto.com)  
MADE IN CHINA



Eng #81192

**WARNING:**  
**CHOKING HAZARD - Small parts.**  
Not for children under 3 years.

**Warning!** Do not aim at eyes or face  
Do not use projectiles other than those supplied or recommended by the manufacturer.

### Maisto Radio Control Vehicles

The packaging and instruction manual contain important information. Please keep them for future reference.

We reserve the right to improve/amend specifications and colours without notice.

Class 1 LED Product

### Contents:

- Remote-controlled vehicle X 1
- Remote-controller X 1
- Flying Bullet X 12
- Instruction Manual X 1

### Battery

Vehicle: 6 X 1.5V "AA" LR6 alkaline batteries  
Remote-controller: 1 X 9v (6F 22) battery

### Remote-controller Battery Installation

1. Turn power switch to OFF position;
2. Open battery cover.
3. Install 1 new 9v (6F 22) battery according to the +/- instruction inside the battery box.
4. Close battery cover.

### Remote-controlled vehicle Battery Installation

1. Turn power switch to OFF position.
2. Slide open battery cover.
3. Install 6 new 1.5V "AA" LR6 alkaline batteries according to the +/- instruction inside the battery box.
4. Close battery cover.

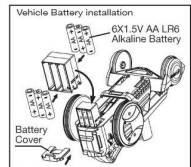

### Operation Instruction

1. Load flying bullet into bullet gripper, and insert bullet gripper into remote-controlled vehicle.

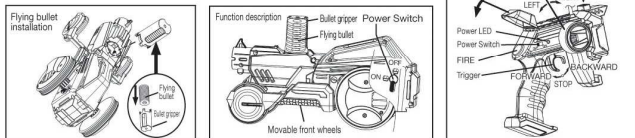

2. Turn remote-controller power switch to ON position, and power indicator (LED) is on.
3. Turn remote-controlled vehicle power switch to ON position.
4. Pull back remote-controller trigger to control vehicle to move forward, push on remote-controller trigger to control vehicle to move backward.
5. Pull back or push on remote-controller trigger while turning remote-controller steering wheel to control vehicle to turn left or turn right.

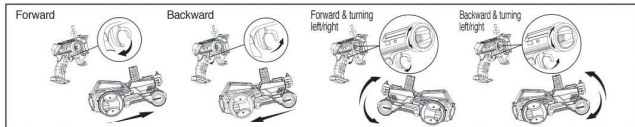

6. Adjust the vehicle head in vehicle form, open remote-controller "Fire" cover and press down "Fire" to shoot flying bullet.

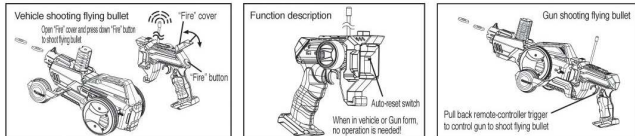

7. Transformation from vehicle to Gun: press down vehicle head and pull back front wheels, attach remote-controller onto vehicle rear for transformation to Gun. Hold Gun bottom with one hand, and hold remote-controller with another hand, pull back remote-controller trigger to shoot flying bullet

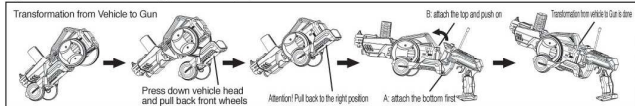

8. Transformation from Gun to vehicle: press down to release remote-controller trigger, separate trigger, and push on front wheels for transformation from gun to vehicle

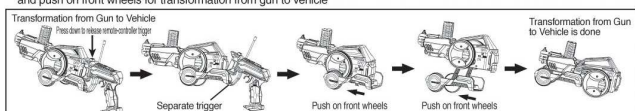

9. Press and hold "Fire" button when the vehicle is motion, to stop vehicle and shoot flying bullet; when release "Fire" button, vehicle will continue moving.
10. Turn remote-controller and vehicle power switch to "Off" position, when you don't play it.
11. You are advised to point about 15 degree upward when shooting flying bullet for better results.
12. You are advised to pull down the vehicle head and pull back front wheels when transforming from Vehicle to Gun.
13. Flying bullet can not be shot out when bullet gripper is not inserted into the vehicle or not inserted into the right position.
14. Vehicle can not be turned by turning steering wheel on remote-controller.

### Safety Instruction

1. Do not play it on the ground on which there is sand, water and grass.
2. Do not play it in the windy and rainy weather.
3. Do not hit vehicle on any hard surface.
4. Turn remote-controller and vehicle power switch to Off position, when you don't play it.
5. Do not put your finger, hair and cloth near the vehicle when it is in motion.
6. Shooting function will be highly affected or even lost if flying bullet is deformed or soaked.
7. Before shooting, please confirm bullet gripper is completely inserted into the right position.
8. Signal reception for remote-controlled vehicle is affected by:
  - a) Low battery in remote-controller.
  - b) Interference by other remote-controller or radio products.
  - c) Flying bullet shooting is affected, it-
    - a) Flying bullet is deformed;
    - b) Flying bullet is not loaded evenly;
    - c) Vehicle battery is low.
9. Vehicle can be remote controlled within the range of about 10 meters (32 feet) in open ground.
10. Shooting range is about 2 meters (6 feet).
11. Remote control distance will be affected if vehicle is manually reset.

### Battery use

1. Alkaline batteries are recommended to use.
2. Only batteries of the same or equivalent type as recommended are to be used.
3. Do not mix alkaline, standard or rechargeable batteries.
4. Do not mix old and new batteries or different type of batteries.
5. Non-rechargeable batteries are not to be charged.
6. If rechargeable batteries are used, they are only to be charged by adults!
7. Rechargeable batteries are to be removed from the product before they are charged.
8. Be sure to insert batteries with correct polarities and always follow the battery manufacturer's instructions.
9. Remove all batteries from the vehicle and transmitter when not in use.
10. Exhausted batteries are to be removed from the product.
11. The supply terminals are not to be short-circuited.
12. Dispose of batteries properly. Do not dispose the batteries in fire - it may cause them to explode or leak causing injury or damage.
13. Battery change must be only made by adults!

### Cautions

1. Do not attempt to disassemble the products.
2. Do not operate the vehicle with same frequency with other players in same location that will interfere and make the vehicle out of control.
3. Make sure the batteries are installed with correct polarity (+/-) as shown inside the battery compartment.
4. Remove the package and take out all accessories before giving product to child to play.

### Disposal of batteries

Batteries should not be disposed of in the household waste. As the consumer you are legally obliged to return batteries containing harmful substances and all other used batteries. You can hand in your old batteries at public collection points in your area or wherever batteries are sold.

You will find these chemical abbreviations along with a crossed-out refuse bin on batteries containing harmful substances:

- Pb = Battery contains lead
- Cd = Battery contains cadmium
- Hg = Battery contains mercury

Size: A4\_297mm(W) x 210mm(H)  
Color: 1C (Black)

MAY CHEONG TOY PRODUCTS FTY. LTD.				DIECUT	
Job Item: N-Art 17811 Illustration (Eng)	Finished by: Jun	Date: 22/11/2011	Test No.:		
Item No.: Maisto TECH #81192 - ARM-Lens Attack RC	Check by:	DWN Name:	Material:		