

DWG. NO. 4200-000331-XXX		SHEET 1	REV. 2	REVISONS		
REV.	DESCRIPTION	BY	DATE	D.E.	M.E.	
1	PILOT RELEASE	DT	102407			
2	ADDED P.O.D. LABEL 4401-000371-000. UPDATED ASSY TO REFLECT CHANGES MADE TO 4801-000826-000.	DT	011408			

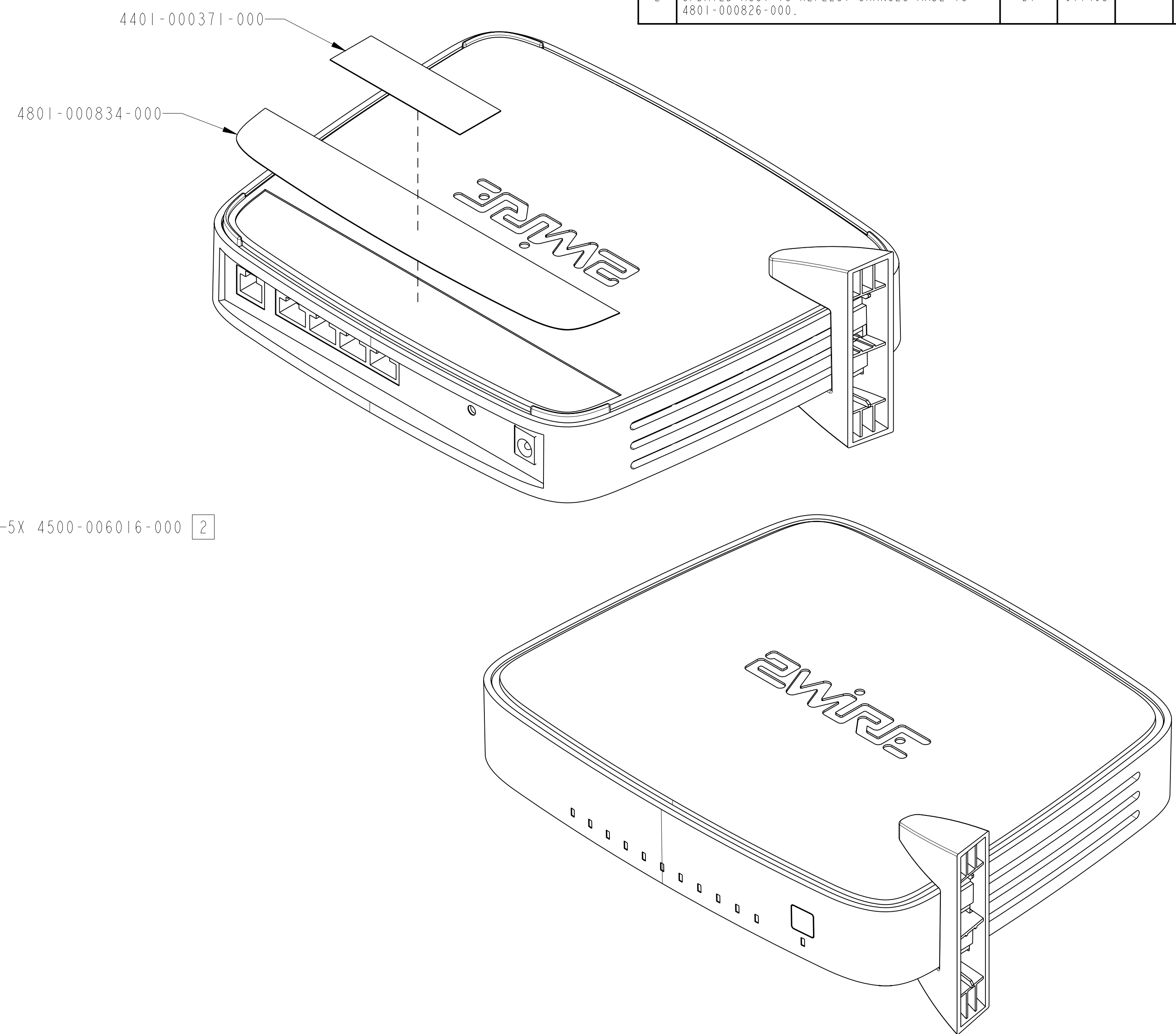
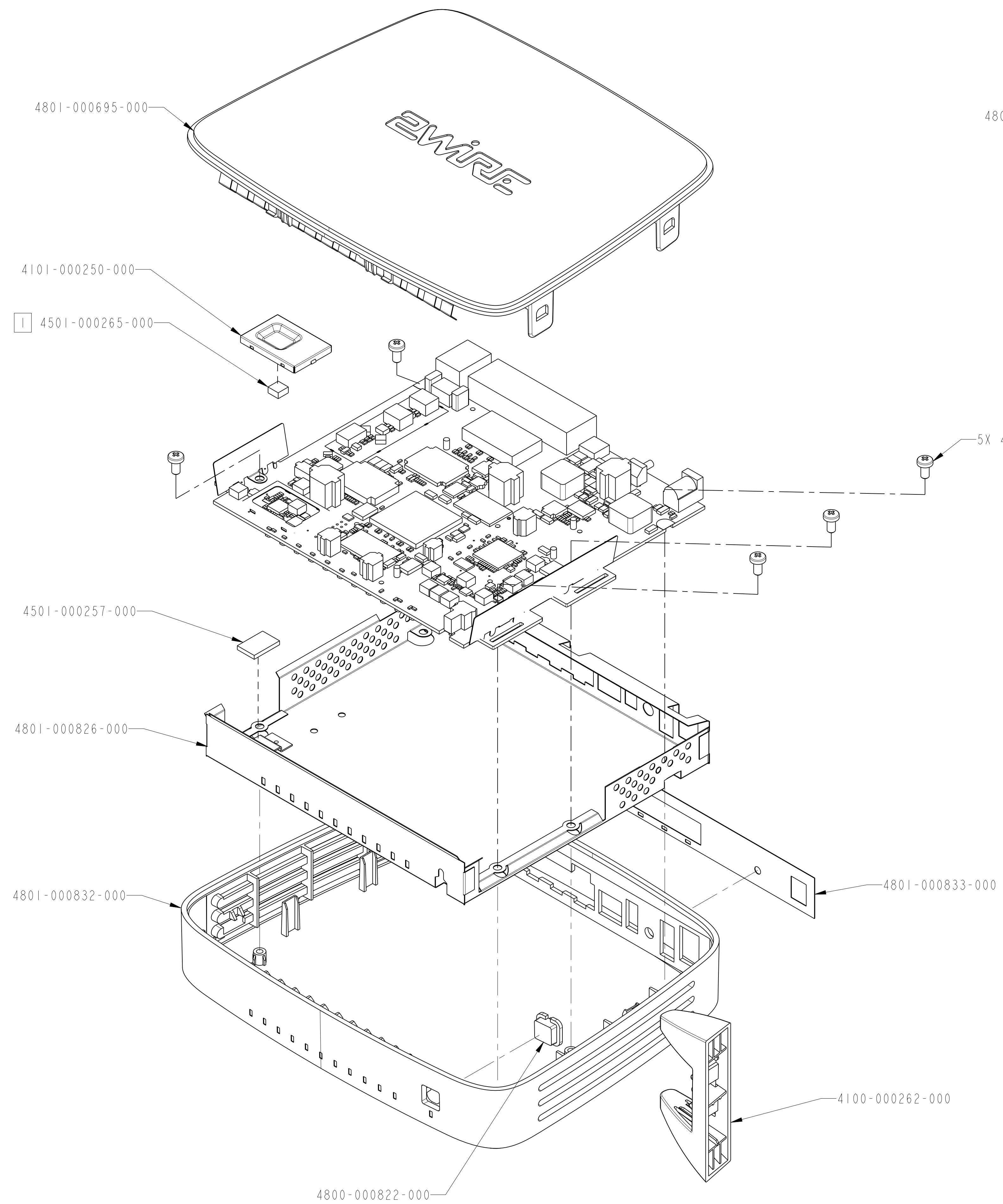

NOTES: UNLESS OTHERWISE SPECIFIED

[1] INSTALL THERMAL PAD 4501-000265-000 TO IC UNDER COVER 4101-000250-000 AS SHOWN.

[2] TIGHTEN TO 5.2 IN LB. (6 KG FCM)

QTY PER VERSION	ITEM NO.	REF. DES.	PART OR IDENTIFYING NO.	NOMENCLATURE OR DESCRIPTION	MATL/SPEC
UNLESS OTHERWISE SPECIFIED					
DIMENSIONS ARE IN MM		APPROVALS		DATE	
TOLERANCES ARE:		DRAWN BY D. TRAN		092707	
DECIMALS		DES. ENG.			
± 0.1		MFG. ENG.			
ANGLES		MATERIAL			
± 0.5°		N/A			
± 0.03		FINISH			
		N/A			
THIRD ANGLE PROJECTION		THIS DOCUMENT CONTAINS CONFIDENTIAL AND PROPRIETARY INFORMATION OF ZWIRE, INC. ("ZWIRE"). THIS INFORMATION WHICH SHALL NOT BE REPRODUCED, TRANSFERRED TO OTHER DOCUMENTS, DISCLOSED TO OTHERS, USED FOR MANUFACTURING OR ANY OTHER PURPOSE WITHOUT THE PRIOR WRITTEN PERMISSION CONSENT OF ZWIRE, INCORPORATED. COPYRIGHT (c) 1998 ZWire, Incorporated			
DO NOT SCALE DRAWING		ASSY, INID, 138HG IU, ATT, LS, W/KIT, SFF			
SCALE 1/1		DRAWING NO.		REV	
		4200-000331-XXX		2	
		SHEET 1 OF 1			