

TEST REPORT

EUT Description	WLAN and BT, 2x2 PCIe M.2 2230 adapter card
Brand Name	Intel®
Model Name	BE201NGW
FCC/IC ID	PD9BE201NG / 1000M-BE201NG
Date of Test Start/End	2023-12-08 / 2023-12-18
Features	2x2 WiFi - Bluetooth® (see section 5)

Applicant	Intel Corporation SAS
Address	425 Rue de Goa – Le Cargo B6 – 06600 Antibes, FRANCE
Contact Person	Benjamin Lavenant
Telephone/Fax/ Email	Benjamin.lavenant@intel.com

Reference Standards	FCC CFR Title 47 Part 15 C FCC CFR Title 47 Part 15 E RSS-247 issue 3, RSS-Gen issue 5 - A1 RSS-248 issue 2 (see section 1)
---------------------	---

Test Report identification	231109-05.TR05
Revision Control	Rev. 00 This test report revision replaces any previous test report revision. (see section 8)

The test results relate only to the samples tested.
Reference to accreditation shall be used only by full reproduction of test report.

Issued by _____

Reviewed by _____

Khodor RIDA
(Test Engineer Lead)

Zayd OUACHICHA
(Technical Manager)

Intel Corporation SAS – WRF Lab
425 rue de Goa – Le Cargo B6 - 06600 Antibes, France
Tel. +33493001400 / Fax +33493001401

Table of Contents

1. Standards, reference documents and applicable test methods	3
2. General conditions, competences and guarantees	3
3. Environmental Conditions	4
4. Test samples	4
5. EUT Features	5
6. Remarks and comments	6
7. Test Verdicts summary	6
8. Document Revision History	6
Annex A. Test & System Description	7
A.1 MEASUREMENT SYSTEM.....	7
A.2 TEST EQUIPMENT LIST	9
A.3 MEASUREMENT UNCERTAINTY EVALUATION	10
Annex B. Test Results	11
B.1 TEST CONDITIONS.....	11
B.2 RADIATED SPURIOUS EMISSION	12
B.2.1 DTS	12
B.2.2 BLE.....	14
B.2.3 BT.....	16
B.2.4 Test procedure	16
B.2.5 U-NII-1.....	18
B.2.6 U-NII-2A.....	20
B.2.7 U-NII-2C	22
B.2.8 U-NII-3.....	24
B.2.9 U-NII-5 to U-NII-8	26
Annex C. Photographs	29
C.1 TEST SETUP	29
C.2 TEST SAMPLE	30

1. Standards, reference documents and applicable test methods

FCC	<ol style="list-style-type: none"> 1. FCC Title 47 CFR part 15 - Subpart C – §15.247 Operation within the bands 902-928 MHz, 2400-2483.5 MHz, and 5725-5850 MHz. 2021-10-01 Edition 2. FCC Title 47 CFR part 15 – Subpart E – Unlicensed National Information Infrastructure Devices. 2021-10-01 Edition 3. FCC Title 47 CFR part 15 – Subpart C – §15.209 Radiated emission limits; general requirements. 2021-10-01 Edition 4. FCC OET KDB 558074 D01 v05r02 - Guidance for compliance measurements on digital transmission system, frequency hopping spread spectrum system, and hybrid system devices operating under section 15.247 of the FCC rules. 5. FCC OET KDB 789033 D02 v02r01 General U-NII Test Procedures New Rules – Guidelines for compliance testing of Unlicensed National Information Infrastructure (U-NII) Devices (Part 15, Subpart E). 6. FCC OET KDB 662911 D01 v02r01 - Emissions Testing of Transmitters with Multiple Outputs in the Same Band. 7. FCC OET KDB 987594 D01 U-NII 6GHz General Requirements v01r02 8. FCC OET KDB 987594 D02 U-NII 6 GHz EMC Measurement v01r01 9. FCC OET KDB 987594 D03 U-NII 6 GHz QA v01 10. ANSI C63.10-2013 American National Standard of Procedures for Compliance Testing of Unlicensed Wireless Devices.
ISED	<ol style="list-style-type: none"> 1. RSS-Gen Issue 5 Amendment 1 - General Requirements for Compliance of Radio Apparatus. 2. RSS-247 Issue 3 - Digital Transmission Systems (DTSs), Frequency Hopping Systems (FHSs) and License-Exempt Local Area Network (LE-LAN) Devices. 3. RSS-248 Issue 2 — Radio Local Area Network (RLAN) Devices Operating in the 5925-7125 MHz Band 4. FCC OET KDB 558074 D01 v05r02 - Guidance for compliance measurements on digital transmission system, frequency hopping spread spectrum system, and hybrid system devices operating under section 15.247 of the FCC rules. 5. FCC OET KDB 789033 D02 v02r01 - General U-NII Test Procedures New Rules – Guidelines for compliance testing of Unlicensed National Information Infrastructure (U-NII) Devices (Part 15, Subpart E) 6. FCC OET KDB 662911 D01 v02r01 - Emissions Testing of Transmitters with Multiple Outputs in the Same Band. 7. FCC OET KDB 987594 D01 U-NII 6GHz General Requirements v01r02 8. FCC OET KDB 987594 D02 U-NII 6 GHz EMC Measurement v01r01 9. FCC OET KDB 987594 D03 U-NII 6 GHz QA v01 10. ANSI C63.10-2013 American National Standard of Procedures for Compliance Testing of Unlicensed Wireless Devices

2. General conditions, competences and guarantees

- ✓ Tests performed under FCC standards identified in section 1 are covered by A2LA accreditation.
- ✓ Tests performed under ISED standards identified in section 1 are covered by Cofrac accreditation.
- ✓ Intel Corporation SAS Wireless RF Lab (Intel WRF Lab) is an ISO/IEC 17025:2017 laboratory accredited by the American Association for Laboratory Accreditation (A2LA) with the certificate number 3478.01.
- ✓ Intel Corporation SAS Wireless RF Lab (Intel WRF Lab) is an Accredited Test Firm recognized by the FCC, with Designation Number FR0011.
- ✓ Intel Corporation SAS Wireless RF Lab (Intel WRF Lab) is an ISO/IEC 17025:2017 testing laboratory accredited by the French Committee for Accreditation (Cofrac) with the certificate number 1-6736.
- ✓ Intel Corporation SAS Wireless RF Lab (Intel WRF Lab) is a Registered Test Site listed by ISED, with ISED company number 1000Y and CAB identifier FR0005.
- ✓ Intel WRF Lab only provides testing services and is committed to providing reliable, unbiased test results and interpretations.
- ✓ Intel WRF Lab is liable to the client for the maintenance of the confidentiality of all information related to the item under test and the results of the test.
- ✓ Intel WRF Lab has developed calibration and proficiency programs for its measurement equipment to ensure correlated and reliable results to its customers.
- ✓ This report is only referred to the item that has undergone the test.
- ✓ This report does not imply an approval of the product by the Certification Bodies or competent Authorities.

3. Environmental Conditions

- ✓ At the site where the measurements were performed the following limits were not exceeded during the tests:

Temperature	24.4°C ± 0.9°C
Humidity	32.4% ± 7.5%

4. Test samples

Sample	Control #	Description	Model	Serial #	Date of receipt	Note
#01	231109-03.S29	WiFi 7 Module	BE201NGW	A002A5B1A61B	2023-11-13	Used for Radiated Spurious Emissions tests
	220225-03.S07	Microwave Absorber	Eccosorb BSR-1	-	2022-03-14	
	231109-03.S48	Adaptor	PCB00866-00_A	124627	2023-11-24	
	200611-03.S31	Extender	ADEXELEC	-	2020-08-19	
	200504-04.S07	Laptop	Latitude 5401	BVHLK13	2020-06-02	
	200921-01.S01	Wieson Dipole Antenna	ARY121-0009-002-H0	-	2020-09-28	
	200921-01.S02	Wieson Dipole Antenna	ARY121-0009-002-H0	-	2020-09-28	
#02	231109-03.S01	WiFi 7 Module	BE201NGW	A002A5B1A620	2023-11-24	Used for Radiated Spurious Emissions tests
	220225-03.S07	Microwave Absorber	Eccosorb BSR-1	-	2022-03-14	
	231109-03.S47	Adaptor	PCB00866-00_A	124727	2023-11-24	
	220915-09.S01	Extender	ADEXELEC	-	2022-04-06	
	200611-03.S30	Laptop	Latitude 5401	6DJLK13	2020-08-19	
	200921-01.S03	Wieson Dipole Antenna	ARY121-0009-002-H0	-	2020-09-28	
	200921-01.S04	Wieson Dipole Antenna	ARY121-0009-002-H0	-	2020-09-28	

5. EUT Features

The herein information is provided by the customer.

Intel WRF Lab declines any responsibility for the accuracy of the stated customer provided information, especially if it has any impact on the correctness of test results presented in this report.

Brand Name	Intel®		
Model Name	BE201NGW		
Software Version	DRTU.05312.99.0.84		
Driver Version	99.0.84.6		
Prototype / Production	Production		
Supported Radios	802.11b/g/n/ax/be	2.4GHz (2400.0 – 2483.5 MHz)	
	802.11a/n/ac/ax/be	5.2GHz (5150.0 – 5350.0 MHz)	
		5.6GHz (5470.0 – 5725.0 MHz)	
		5.8GHz (5725.0 – 5850.0 MHz)	
	802.11ax/be	6.0GHz (5925.0 – 7125 MHz)	
	Bluetooth	2.4GHz (2400.0 – 2483.5 MHz)	
Antenna Information	Transmitter	Main(2) / Chain A	Aux(1) / Chain B
	Manufacturer	Wieson	Wieson
	Antenna type	Dipole	Dipole
	Part number	ARY121-0009-002-H0	ARY121-0009-002-H0
	Declared Antenna gain (dBi) - 2.4GHz	+2.95	+2.95
	Declared Antenna gain (dBi) – 5.2 & 5.3GHz	+4.11	+4.11
	Declared Antenna gain (dBi) – 5.6GHz	+5.15	+5.15
	Declared Antenna gain (dBi) – 5.8 GHz	+5.13	+5.13
	Declared Antenna gain (dBi) – 6.2 GHz	+5.02	+5.02
	Declared Antenna gain (dBi) – 6.5 GHz	+4.71	+4.71
	Declared Antenna gain (dBi) – 6.7 GHz	+4.49	+4.49
	Declared Antenna gain (dBi) – 6.9 GHz	+4.96	+4.96

6. Remarks and comments

The low, mid, high channels were tested for each RF chain (A, B or A+B), bandwidth, modulation, and sub-band. Only the worst case among the low, mid and high channels per sub-band has been reported.

7. Test Verdicts summary

The statement of conformity to applicable standards in the table below are based on the measured values, without taking into account the measurement uncertainties.

	FCC part	RSS part	Test name	Verdict
802.11 b/g/n/ax/be–2.4GHz	15.247 (d) 15.209	RSS-247 Clause 5.5 RSS-Gen A1 Clause 8.9	Spurious Emission (radiated)	P
BLE	15.247 (d) 15.209	RSS-247 Clause 5.5 RSS-GEN A1 Clause 8.9	Spurious Emission (radiated)	P
BT	15.247 (d) 15.209	RSS-247 Clause 5.5 RSS-GEN A1 Clause 8.9	Spurious Emission (radiated)	P
802.11 a/n/ac/ax/be – U-NII-1	15.407 (b) (1) 15.209	RSS-247 Clause 6.2.1.2 RSS-GEN A1, Clause 8.9	Spurious Emission (radiated)	P
802.11 a/n/ac/ax/be – U-NII-2A	15.407 (b) (2) 15.209	RSS-247 Clause 6.2.2.2 RSS-GEN A1, Clause 8.9	Spurious Emission (radiated)	P
802.11 a/n/ac/ax/be – U-NII-2C	15.407 (b) (3) 15.209	RSS-247 Clause 6.2.3.2 RSS-GEN A1 Clause 8.9	Spurious Emission (radiated)	P
802.11 a/n/ac/ax/be – U-NII- 3	15.407 (b) (4) 15.209	RSS-247 Clause 6.2.4.2 RSS-GEN A1 Clause 8.9	Spurious Emission (radiated)	P
802.11 ax/be - U-NII- 5 to 8	15.209 15.35 (b) 15.407 (b) (5) (8)	RSS-248 Clause 4.6.2	Spurious Emission (radiated)	P

P: Pass

F: Fail

NM: Not Measured

NA: Not Applicable

8. Document Revision History

Revision #	Modified by	Revision Details
Rev. 00	K.Khatib	First Issue

Annex A. Test & System Description

A.1 Measurement System

Measurements were performed using the following setups, made in accordance to the general provisions of FCC KDB 789033 D02 General DTS, UNII, 6GHz Test Procedures.

The DUT was installed in a test fixture and this test fixture is connected to a laptop computer and AC/DC power adapter. The laptop computer was used to configure the EUT to continuously transmit at a specified output power using all different modes and modulation schemes, using the Intel proprietary tool DRTU.

Radiated test setup

Radiated Setup 30MHz - 1GHz (Transmitter tests)

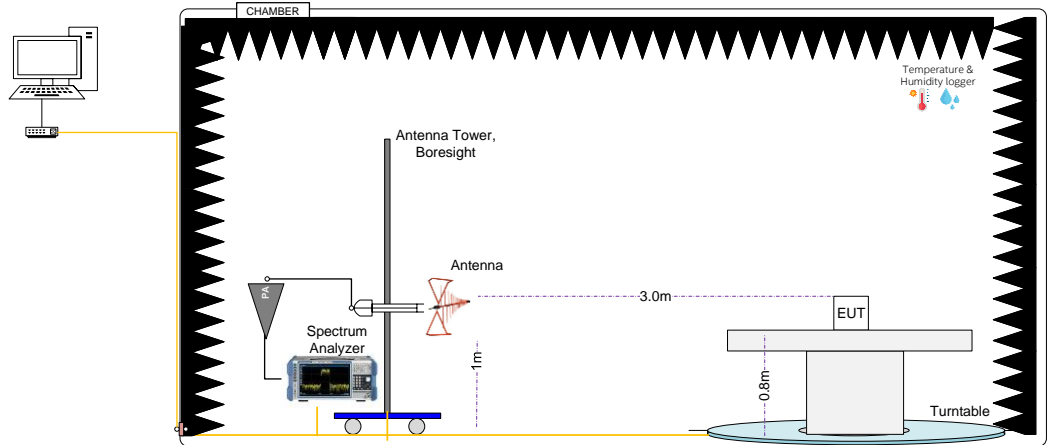

Radiated Setup 1GHz - 11GHz (Transmitter tests)

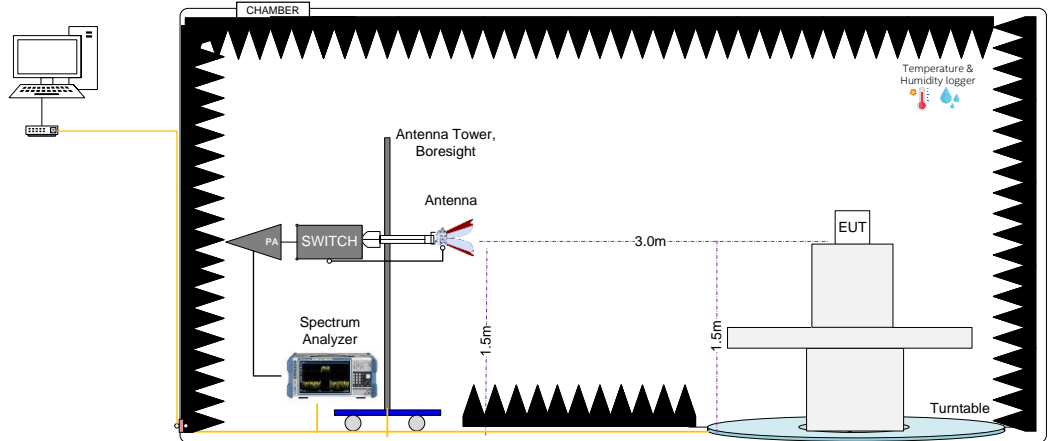

Radiated Setup 11GHz – 40GHz (Transmitter tests)

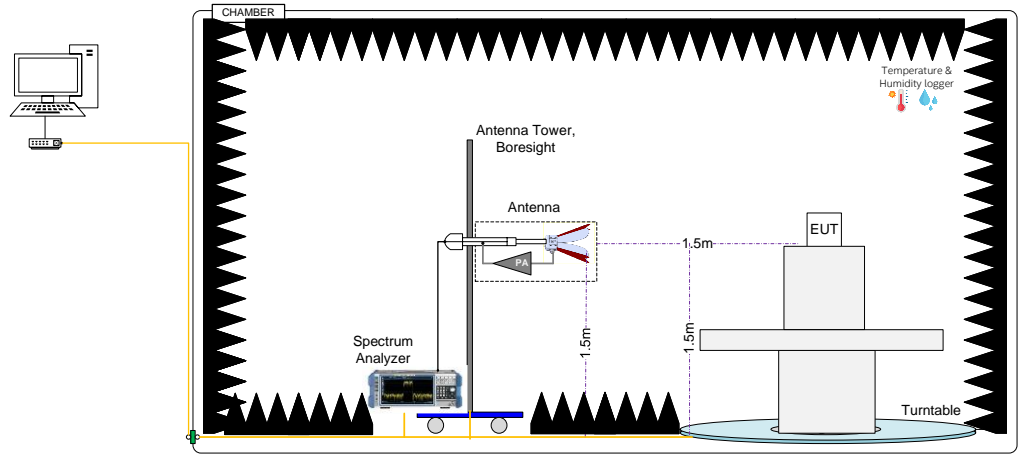

Sample Calculation

The spurious received voltage $V(\text{dB}\mu\text{V})$ in the spectrum Analyzer is converted to Electric field strength using the transducer factor F corresponding to the Rx path Loss:

$$F (\text{dB/m}) = \text{Rx Antenna Factor (dB/m)} + \text{Cable losses (dB)} - \text{Amplifiers Gain (dBi)}$$

$$E (\text{dB}\mu\text{V/m}) = V(\text{dB}\mu\text{V}) + F (\text{dB/m})$$

For field strength measurements made at other than the distance at which the applicable limit is specified, the field strength of the emission at the distance specified by the limit is deduced as follows:

$$E_{\text{SpecLimit}} = E_{\text{Meas}} + 20 \cdot \log(D_{\text{Meas}}/D_{\text{SpecLimit}})$$

where

$E_{\text{SpecLimit}}$ is the field strength of the emission at the distance specified by the limit, in $\text{dB}\mu\text{V/m}$

E_{Meas} is the field strength of the emission at the measurement distance, in $\text{dB}\mu\text{V/m}$

D_{Meas} is the measurement distance, in m

$D_{\text{SpecLimit}}$ is the distance specified by the limit, in m

A.2 Test Equipment List

Radiated Setup #1

ID#	Device	Type/Model	Serial #	Manufacturer	Cal. Date	Cal. Due Date
006-000	Anechoic Chamber	FACT3	5720	ETS-Lindgren	2022-01-21	2024-01-21
006-008	Measurement SW, v11.30	EMC32	100623	Rohde & Schwarz	N/A	N/A
259-000	Temp & Humidity Logger	RA12E-TH-RAS	RA12-B9BD70	Avtech	2022-06-27	2024-06-27
006-001	Turn Table	ETS	-	ETS-Lindgren	N/A	N/A
006-011	Boresight antenna mast	BAM 4.0-P	P/278/2890.01	Maturo	N/A	N/A
007-008	Double Horn Ridged antenna +PA	3116C-PA	00169308bis + 00196308	ETS-Lindgren	2023-05-30	2025-05-30
057-000	Double Horn Ridged antenna	3117	167062	ETS-Lindgren	2022-07-08	2024-07-08
006-061	Bi-Log Periodic antenna	CBL6143A	61382	Teseq	2022-10-24	2024-10-24
147-000	Spectrum analyzer	FSW43	101847	Rohde & Schwarz	2022-11-30	2024-11-30
301-000	Amplifier 9kHz-1300MHz	8447F	3113A07440	HP	2023-03-03	2024-03-03
261-000	Amplifier 1GHz-18GHz	3117-PA	00157993	ETS-Lindgren	2023-02-20	2024-02-20
006-068	RF Switch	RC-2SP6T-40	02112090061	Micro-Circuits	2023-08-22	2024-08-22
006-059	Cable 7m – 25MHz to 40GHz	R286304174	20.46.369	Radiall	2023-02-20	2024-02-20
006-063	Cable 30cm – 1GHz to 40GHz	PE371-12	-	Pasternack	2023-02-27	2024-02-27
006-064	Cable 30cm – 1GHz to 40GHz	PE371-12	-	Pasternack	2023-02-27	2024-02-27
006-065	Cable 60cm – 25MHz to 1GHz	PE300-24	-	Pasternack	2023-06-02	2024-06-02

N/A: Not Applicable

Radiated Setup #2

ID#	Device	Type/Model	Serial #	Manufacturer	Cal. Date	Cal. Due Date
127-000	Spectrum Analyzer	FSV40	101358	Rohde & Schwarz	2023-01-27	2025-01-27
007-007	Double Ridge Horn (1- 18GHz)	3117	00152266	ETS Lindgren	2022-03-29	2024-03-29
007-006	Switch & Positioner	EMCenter	00151232	ETS Lindgren	N/A	N/A
007-011	RF Cable 1-18GHz - 6.5m	140-8500-11-51	001	Atem	2023-02-15	2024-02-15
007-005	Measurement SW, v11.20.00	EMC32	100401	Rohde & Schwarz	N/A	N/A
007-000	Anechoic chamber	RFD-FA-100	5996	ETS Lindgren	2021-09-14	2024-03-14
007-003	Antenna Tower	2171B-3.0M	00150123	ETS Lindgren	N/A	N/A
007-002	Turntable	-	-	ETS Lindgren	N/A	N/A
007-014	RF Cable 18-40 GHz 6m	R286304009	1747364	Radiall	2023-02-16	2024-02-16
007-022	RF Cable 1-18GHz, 1.5m	0501050991200GX	19.23.493	Radiall	2023-02-13	2024-02-13
007-015	RF Cable 1GHz-18GHz 1.5m	-	-	Spirent	2023-02-13	2024-02-13
007-018	RF Cable 1-9.5GHz 1.2m	0500990991200KE	-	Radiall	2023-02-13	2024-02-13
007-020	RF Cable 1-18GHz, 1.2 m	2301761761200PJ	12.22.1104	Radiall	2023-02-15	2024-02-15
325-000	Temp & Humidity Logger	RA12E-TH1-RAS	RA12-B9B7C6	Avtech	2022-01-17	2024-01-17

N/A: Not Applicable

Shared Radiated Equipment

ID#	Device	Type/Model	Serial #	Manufacturer	Cal. Date	Cal. Due Date
412-000	DRTU Power finder V2.1	Test Software	-	Intel	NA	NA
139-000	Power Sensor	NRP-Z81	104383	Rohde & Schwarz	2023-04-21	2025-04-21
061-000	Power Sensor	NRP-Z81	104386	Rohde & Schwarz	2022-03-25	2024-03-25
140-000	Power Sensor	NRP-Z81	104382	Rohde & Schwarz	2022-03-25	2024-03-25
423-000	Power Sensor	NRP-Z81	101152	Rohde & Schwarz	2022-05-18	2024-05-18

N/A: Not Applicable

A.3 Measurement Uncertainty Evaluation

The system uncertainty evaluation is shown in the table below with a coverage factor of $k = 2$ to indicate a 95% level of confidence:

Measurement type	Uncertainty	Unit
Radiated tests <1GHz	± 6.40	dB
Radiated tests 1GHz – 40 GHz	± 6.04	dB

Annex B. Test Results

B.1 Test Conditions

For 802.11b, g and a mode the EUT can transmit at both CHAIN A and CHAIN B RF outputs individually, but not simultaneously.

For 802.11n20 & 802.11ax/be20 (20 MHz channel bandwidth), 802.11n40 & 802.11ax/be40 (40MHz channel bandwidth), 802.11ac80 & 802.11ax/be80 (80MHz channel bandwidth), 802.11ac160 & 802.11ax/be160 (160MHz channel bandwidth) and 802.11be320 (320MHz channel bandwidth) modes the EUT can transmit at both CHAIN A and CHAIN B RF outputs individually, and also simultaneously.

The following data rates were selected based on preliminary testing that identified those rates as the worst cases for the spurious level:

Transmission	Mode	Bandwidth (MHz)	Worst Case Data Rate
SISO	802.11b	20	1Mbps
	802.11g, a	20	6Mbps
	802.11n	20	HT0
		40	HT0
	802.11ac	80	VHT0
		160	VHT0
	802.11ax/be	20	MCS0
		40	MCS0
		80	MCS0
		160	MCS0
802.11be	320	MCS0	
MIMO	802.11n	20/40	HT8
	802.11ac	80/160	VHT0
	802.11ax/be	20/40/80/160	MCS0
	802.11be	320	MCS0

B.2 Radiated spurious emission

The herein test results were performed by:

Test case measurement	Test Personnel
Radiated spurious emissions	K.Khatib, R.Simonini

B.2.1 DTS

Standard references

FCC part	RSS part	Limits			
15.247 (d) 15.209	RSS-247 Clause 5.5 RSS-Gen A1 Clause 8.9	Radiated emissions which fall in the restricted bands, as defined in §15.205(a), must also comply with the radiated emission limits specified in §15.209(a):			
		Freq Range (MHz)	Field Strength (μV/m)	Field Strength (dBμV/m)	Meas. Distance (m)
		30-88	100	40	3
		88-216	150	43.5	3
		216-960	200	46	3
		Above 960	500	54	3
		<p>The emission limits shown in the above table are based on measurements employing CISPR quasi-peak detector except for the frequency bands above 1000 MHz. Radiated emission limits in these three bands are based on measurements employing an average detector.</p> <p>For average radiated emission measurements above 1000 MHz. there is also a limit specified when measuring with peak detector function corresponding to 20 dB above the indicated values in the table.</p>			

Test procedure

The radiated setups shown in section section A.1 were used to measure the radiated spurious emissions.

Depending of the frequency range and bands being tested, different antennas and filters were used.

The final measurement is done by varying the antenna height from 1 to 4 meters, the EUT azimuth over 360° and for both Vertical and Horizontal polarizations.

Test Results**Radiated spurious - 30 MHz – 1 GHz****Radiated Spurious – All modes**

Frequency	Level	Detector	Limit	Margin	Polar
MHz	dB μ V/m	---	dB μ V/m	dB	---
39.6	31.9	Quasi-Peak	40.0	8.1	V
42.0	30.5	Quasi-Peak	40.0	9.5	V
62.5	34.3	Quasi-Peak	40.0	5.7	V
106.7	36.9	Quasi-Peak	43.5	6.6	V

Note 1: The spurious signals detected do not depend on either the operating channel or the modulation mode.

1 GHz – 26 GHz, 802.11b, 1Mbps, Chain B**Radiated Spurious – CH1**

Frequency	Level	Detector	Limit	Margin	Polar
MHz	dB μ V/m	---	dB μ V/m	dB	---
4823.4	51.4	Peak	74.0	22.6	H
4823.9	45.0	Average	54.0	9.0	H
12058.0	47.4	Peak	74.0	26.6	V
12058.5	39.9	Average	54.0	14.2	V
14472.0	46.5	Peak	74.0	27.5	V
14472.0	40.3	Average	54.0	13.7	V

B.2.2 BLE

Standards references

FCC part	RSS part	Limits																					
<p>15.247 (d) 15.209</p>	<p>RSS-247 Clause 5.5 RSS-Gen A1 Clause 8.9</p>	<p>Radiated emissions which fall in the restricted bands, as defined in §15.205(a), must also comply with the radiated emission limits specified in §15.209(a):</p>																					
		<table border="1"> <thead> <tr> <th>Freq Range (MHz)</th> <th>Field Strength (μV/m)</th> <th>Field Strength (dBμV/m)</th> <th>Meas. Distance (m)</th> </tr> </thead> <tbody> <tr> <td>30-88</td> <td>100</td> <td>40</td> <td>3</td> </tr> <tr> <td>88-216</td> <td>150</td> <td>43.5</td> <td>3</td> </tr> <tr> <td>216-960</td> <td>200</td> <td>46</td> <td>3</td> </tr> <tr> <td>Above 960</td> <td>500</td> <td>54</td> <td>3</td> </tr> </tbody> </table>	Freq Range (MHz)	Field Strength (μV/m)	Field Strength (dBμV/m)	Meas. Distance (m)	30-88	100	40	3	88-216	150	43.5	3	216-960	200	46	3	Above 960	500	54	3	
Freq Range (MHz)	Field Strength (μV/m)	Field Strength (dBμV/m)	Meas. Distance (m)																				
30-88	100	40	3																				
88-216	150	43.5	3																				
216-960	200	46	3																				
Above 960	500	54	3																				
<p>The emission limits shown in the above table are based on measurements employing CISPR quasi-peak detector except for the frequency bands above 1000 MHz. Radiated emission limits in these three bands are based on measurements employing an average detector. For average radiated emission measurements above 1000 MHz, there is also a limit specified when measuring with peak detector function, corresponding to 20 dB above the indicated values in the table.</p>																							

Test procedure

The radiated setups shown in section A.1 were used to measure the radiated spurious emissions. were used to measure the radiated spurious emissions.

Depending of the frequency range and bands being tested, different antennas and filters were used.

The final measurement is done by varying the antenna height from 1 to 4 meters, the EUT azimuth over 360° and for both Vertical and Horizontal polarizations.

Test Results**Radiated spurious - 30 MHz – 1 GHz****Radiated Spurious – All modes**

Frequency	Level	Detector	Limit	Margin	Polar
MHz	dBµV/m	---	---	dBµV/m	dB
43.0	31.7	Quasi-Peak	40.0	8.3	V

Note 1: The detected spurious signals do not depend on either the operating channel or the modulation mode.

1 GHz – 26 GHz, BLE**Radiated Spurious – 2402 MHz**

Frequency	Level	Detector	Limit	Margin	Polar
MHz	dBµV/m	---	dBµV/m	dB	---
3963.1	40.4	Average	54.0	13.6	H
3992.5	53.5	Peak	74.0	20.5	V
11871.5	44.9	Peak	74.0	29.1	H
11871.5	33.6	Average	54.0	20.4	V
25490.5	51.9	Peak	74.0	22.1	H
25490.5	39.5	Average	54.0	14.5	V

B.2.3 BT

Standard references

FCC part	RSS part	Limits																					
<p>15.247 (d) 15.209 (a)</p>	<p>RSS-247 Clause 5.5</p> <p>RSS GEN A1 Clause 8.9</p>	<p>Radiated emissions which fall in the restricted bands, as defined in §15.205(a), must also comply with the radiated emission limits specified in §15.209(a):</p>																					
		<table border="1"> <thead> <tr> <th data-bbox="627 463 794 526">Freq Range (MHz)</th> <th data-bbox="826 463 978 526">Field Strength (µV/m)</th> <th data-bbox="1010 463 1161 526">Field Strength (dBµV/m)</th> <th data-bbox="1193 463 1345 526">Meas. Distance (m)</th> </tr> </thead> <tbody> <tr> <td data-bbox="627 533 794 564">30-88</td> <td data-bbox="826 533 978 564">100</td> <td data-bbox="1010 533 1161 564">40</td> <td data-bbox="1193 533 1345 564">3</td> </tr> <tr> <td data-bbox="627 571 794 602">88-216</td> <td data-bbox="826 571 978 602">150</td> <td data-bbox="1010 571 1161 602">43.5</td> <td data-bbox="1193 571 1345 602">3</td> </tr> <tr> <td data-bbox="627 609 794 640">216-960</td> <td data-bbox="826 609 978 640">200</td> <td data-bbox="1010 609 1161 640">46</td> <td data-bbox="1193 609 1345 640">3</td> </tr> <tr> <td data-bbox="627 647 794 678">Above 960</td> <td data-bbox="826 647 978 678">500</td> <td data-bbox="1010 647 1161 678">54</td> <td data-bbox="1193 647 1345 678">3</td> </tr> </tbody> </table>	Freq Range (MHz)	Field Strength (µV/m)	Field Strength (dBµV/m)	Meas. Distance (m)	30-88	100	40	3	88-216	150	43.5	3	216-960	200	46	3	Above 960	500	54	3	
Freq Range (MHz)	Field Strength (µV/m)	Field Strength (dBµV/m)	Meas. Distance (m)																				
30-88	100	40	3																				
88-216	150	43.5	3																				
216-960	200	46	3																				
Above 960	500	54	3																				
<p>The emission limits shown in the above table are based on measurements employing CISPR quasi-peak detector except for the frequency bands above 1000 MHz. Radiated emission limits in these three bands are based on measurements employing an average detector.</p> <p>For average radiated emission measurements above 1000 MHz, there is also a limit specified when measuring with peak detector function, corresponding to 20 dB above the indicated values in the table.</p>																							

B.2.4 Test procedure

The radiated setups shown in section A.1 were used to measure the radiated spurious emissions. Depending of the frequency range and bands being tested, different antennas and filters were used. The final measurement is done by varying the antenna height from 1 m to 4 m, the EUT azimuth over 360° and for both Vertical and Horizontal polarizations.

Test Results**Radiated spurious - 30 MHz – 1 GHz****Radiated Spurious – All modes**

Frequency	Level	Detector	Limit	Margin	Polar
MHz	dBμV/m	---	dBμV/m	dB	---
39.5	32.1	Quasi-Peak	40.0	7.9	V
41.5	29.8	Quasi-Peak	40.0	10.2	V
66.3	33.4	Quasi-Peak	40.0	6.6	V

Note 1: The spurious signals detected do not depend on either the operating channel or the modulation mode.

1 GHz – 26 GHz, BR – GFSK**Radiated Spurious – CH78 DH5**

Frequency	Level	Detector	Limit	Margin	Polar
MHz	dBμV/m	---	dBμV/m	dB	---
3383.5	53.4	Peak	74.0	20.6	H
3396.5	40.9	Average	54.0	13.1	V
12498.9	45.0	Peak	74.0	29.0	V
12498.9	34.7	Average	54.0	19.3	V
25514.5	50.7	Peak	74.0	23.3	V
25514.5	39.5	Average	54.0	14.5	V

B.2.5 U-NII-1

Standard references

FCC part	RSS part	Limits																				
15.407 (b) (1)	RSS-247, Clause 6.2.1.2	For transmitters operating in the 5.15-5.25 GHz band: All emissions outside of the 5.15-5.35 GHz band shall not exceed an e.i.r.p. of -27 dBm/MHz.																				
15.209	RSS-GEN A1, Clause 8.9	<p>Radiated emissions which fall in the restricted bands, as defined in §15.205(a), must also comply with the radiated emission limits specified in §15.209(a):</p> <table border="1"> <thead> <tr> <th>Freq Range (MHz)</th> <th>Field Strength (µV/m)</th> <th>Field Strength (dBµV/m)</th> <th>Meas. Distance (m)</th> </tr> </thead> <tbody> <tr> <td>30-88</td> <td>100</td> <td>40</td> <td>3</td> </tr> <tr> <td>88-216</td> <td>150</td> <td>43.5</td> <td>3</td> </tr> <tr> <td>216-960</td> <td>200</td> <td>46</td> <td>3</td> </tr> <tr> <td>Above 960</td> <td>500</td> <td>54</td> <td>3</td> </tr> </tbody> </table> <p>The emission limits shown in the above table are based on measurements employing CISPR quasi-peak detector except for the frequency bands above 1000 MHz. Radiated emission limits in these three bands are based on measurements employing an average detector.</p> <p>For average radiated emission measurements above 1000 MHz, there is also a limit specified when measuring with peak detector function, corresponding to 20 dB above the indicated values in the table.</p>	Freq Range (MHz)	Field Strength (µV/m)	Field Strength (dBµV/m)	Meas. Distance (m)	30-88	100	40	3	88-216	150	43.5	3	216-960	200	46	3	Above 960	500	54	3
Freq Range (MHz)	Field Strength (µV/m)	Field Strength (dBµV/m)	Meas. Distance (m)																			
30-88	100	40	3																			
88-216	150	43.5	3																			
216-960	200	46	3																			
Above 960	500	54	3																			

Test procedure

The radiated setup shown in section A.1 was used to measure the radiated spurious emissions. Depending of the frequency range and bands being tested, different antennas and filters were used. The final measurement is done by varying the antenna height, the EUT azimuth over 360° and for both Vertical and Horizontal polarizations.

Test Results**Radiated spurious - 30 MHz – 1 GHz****Radiated Spurious – All modes**

Frequency	Level	Detector	Limit	Margin	Polar
MHz	dB μ V/m	---	dB μ V/m	dB	---
38.9	32.1	Quasi-Peak	40.0	7.9	V
39.5	32.4	Quasi-Peak	40.0	7.6	V
66.3	33.3	Quasi-Peak	40.0	6.7	V

Note 1: The detected spurious signals do not depend on either the operating channel or the modulation mode.

1 GHz – 40 GHz, 802.11a, 6Mbps, Chain A**Radiated Spurious – CH48**

Frequency	Level	Detector	Limit	Margin	Polar
MHz	dB μ V/m	---	dB μ V/m	dB	---
7988.5	61.2	Peak	68.2	7.0	V
39957.0	55.5	Peak	74.0	18.5	V
39957.0	47.8	Average	54.0	6.2	H

B.2.6 U-NII-2A

Standard references

FCC part	RSS part	Limits																				
15.407 (a) (2)	RSS-247, Clause 6.2.2.2	For transmitters operating in the 5.25-5.35 GHz band: All emissions outside of the 5.15-5.35 GHz band shall not exceed an e.i.r.p. of -27 dBm/MHz.																				
15.209	RSS-GEN A1, Clause 8.9	<p>Radiated emissions which fall in the restricted bands, as defined in §15.205(a), must also comply with the radiated emission limits specified in §15.209(a):</p> <table border="1"> <thead> <tr> <th>Freq Range (MHz)</th> <th>Field Strength (µV/m)</th> <th>Field Strength (dBµV/m)</th> <th>Meas. Distance (m)</th> </tr> </thead> <tbody> <tr> <td>30-88</td> <td>100</td> <td>40</td> <td>3</td> </tr> <tr> <td>88-216</td> <td>150</td> <td>43.5</td> <td>3</td> </tr> <tr> <td>216-960</td> <td>200</td> <td>46</td> <td>3</td> </tr> <tr> <td>Above 960</td> <td>500</td> <td>54</td> <td>3</td> </tr> </tbody> </table> <p>The emission limits shown in the above table are based on measurements employing CISPR quasi-peak detector except for the frequency bands above 1000 MHz. Radiated emission limits in these three bands are based on measurements employing an average detector.</p> <p>For average radiated emission measurements above 1000 MHz, there is also a limit specified when measuring with peak detector function, corresponding to 20 dB above the indicated values in the table.</p>	Freq Range (MHz)	Field Strength (µV/m)	Field Strength (dBµV/m)	Meas. Distance (m)	30-88	100	40	3	88-216	150	43.5	3	216-960	200	46	3	Above 960	500	54	3
Freq Range (MHz)	Field Strength (µV/m)	Field Strength (dBµV/m)	Meas. Distance (m)																			
30-88	100	40	3																			
88-216	150	43.5	3																			
216-960	200	46	3																			
Above 960	500	54	3																			

Test procedure

The radiated setups shown in section A.1 were used to measure the radiated spurious emissions. Depending of the frequency range and bands being tested, different antennas and filters were used. The final measurement is done by varying the antenna height, the EUT azimuth over 360° and for both Vertical and Horizontal polarizations.

Test Results**Radiated spurious - 30 MHz – 1 GHz****Radiated Spurious – All modes**

Frequency	Level	Detector	Limit	Margin	Polar
MHz	dB μ V/m	---	dB μ V/m	dB	---
38.9	32.3	Quasi-Peak	40.0	7.7	V
42.9	30.8	Quasi-Peak	40.0	9.2	V
66.2	29.3	Quasi-Peak	40.0	10.7	V

Note 1: The detected spurious signals do not depend on either the operating channel or the modulation mode.

1 GHz – 40 GHz, 802.11a, 6Mbps, Chain A**Radiated Spurious – CH56**

Frequency	Level	Detector	Limit	Margin	Polar
MHz	dB μ V/m	---	dB μ V/m	dB	---
7982.7	59.0	Peak	68.2	9.2	V
39989.8	54.9	Peak	74.0	19.1	H
39989.8	47.9	Average	54.0	6.1	H

B.2.7 U-NII-2C

Standard references

FCC part	RSS clause	Limits																				
15.407 (b) (3)	RSS-247 Clause 6.2.3 (2)	For transmitters operating in the 5.47–5.725 GHz band: all emissions outside of the 5.47–5.725 GHz band shall not exceed an EIRP of -27 dBm/MHz.																				
15.209	RSS-GEN A1, Clause 8.9	<p>Radiated emissions which fall in the restricted bands, as defined in §15.205(a), must also comply with the radiated emission limits specified in §15.209(a):</p> <table border="1"> <thead> <tr> <th>Freq Range (MHz)</th> <th>Field Strength (μV/m)</th> <th>Field Strength (dBμV/m)</th> <th>Meas. Distance (m)</th> </tr> </thead> <tbody> <tr> <td>30-88</td> <td>100</td> <td>40</td> <td>3</td> </tr> <tr> <td>88-216</td> <td>150</td> <td>43.5</td> <td>3</td> </tr> <tr> <td>216-960</td> <td>200</td> <td>46</td> <td>3</td> </tr> <tr> <td>Above 960</td> <td>500</td> <td>54</td> <td>3</td> </tr> </tbody> </table> <p>The emission limits shown in the above table are based on measurements employing CISPR quasi-peak detector except for the frequency bands above 1000 MHz. Radiated emission limits in these three bands are based on measurements employing an average detector.</p> <p>For average radiated emission measurements above 1000 MHz, there is also a limit specified when measuring with peak detector function, corresponding to 20 dB above the indicated values in the table.</p>	Freq Range (MHz)	Field Strength (μV/m)	Field Strength (dBμV/m)	Meas. Distance (m)	30-88	100	40	3	88-216	150	43.5	3	216-960	200	46	3	Above 960	500	54	3
Freq Range (MHz)	Field Strength (μV/m)	Field Strength (dBμV/m)	Meas. Distance (m)																			
30-88	100	40	3																			
88-216	150	43.5	3																			
216-960	200	46	3																			
Above 960	500	54	3																			

Test procedure

The radiated setups shown in section A.1 were used to measure the radiated spurious emissions. Depending of the frequency range and bands being tested, different antennas and filters were used. The final measurement is done by varying the antenna height from 1 m to 4 m, the EUT azimuth over 360° and for both Vertical and Horizontal polarizations.

Test Results**Radiated spurious - 30 MHz – 1 GHz****Radiated Spurious – All modes**

Frequency	Level	Detector	Limit	Margin	Polar
MHz	dB μ V/m	---	dB μ V/m	dB	---
39.6	32.0	Quasi-Peak	40.0	8.0	V
66.3	32.4	Quasi-Peak	40.0	7.6	V

Note 1: The detected spurious signals do not depend on either the operating channel or the modulation mode.

1 GHz – 40 GHz, 802.11n20, MCS0, Chain A**Radiated Spurious – CH120**

Frequency	Level	Detector	Limit	Margin	Polar
MHz	dB μ V/m	---	dB μ V/m	dB	---
7974.3	59.2	Peak	68.2	9.0	V
23931.1	48.6	Peak	74.0	25.4	V
23931.1	41.0	Average	54.0	13.0	V
39823.6	55.2	Peak	74.0	18.8	H
39823.6	48.0	Average	54.0	6.0	V

B.2.8 U-NII-3

Standard references

FCC part	RSS part	Limits																				
15.407 (b) (4)	RSS-247 Clause 6.2.4.2	For transmitters operating in the 5.725-5.85 GHz band: All emissions shall be limited to a level of -27 dBm/MHz at 75 MHz or more above or below the band edge increasing linearly to 10 dBm/MHz at 25 MHz above or below the band edge, and from 25 MHz above or below the band edge increasing linearly to a level of 15.6 dBm/MHz at 5 MHz above or below the band edge, and from 5 MHz above or below the band edge increasing linearly to a level of 27 dBm/MHz at the band edge.																				
15.209	RSS-GEN A1, Clause 8.9	<p>Radiated emissions which fall in the restricted bands, as defined in §15.205(a), must also comply with the radiated emission limits specified in §15.209(a):</p> <table border="1" data-bbox="563 689 1353 902"> <thead> <tr> <th data-bbox="563 689 762 754">Freq Range (MHz)</th> <th data-bbox="767 689 954 754">Field Strength (µV/m)</th> <th data-bbox="959 689 1153 754">Field Strength (dBµV/m)</th> <th data-bbox="1158 689 1353 754">Meas. Distance (m)</th> </tr> </thead> <tbody> <tr> <td data-bbox="563 757 762 790">30-88</td> <td data-bbox="767 757 954 790">100</td> <td data-bbox="959 757 1153 790">40</td> <td data-bbox="1158 757 1353 790">3</td> </tr> <tr> <td data-bbox="563 792 762 826">88-216</td> <td data-bbox="767 792 954 826">150</td> <td data-bbox="959 792 1153 826">43.5</td> <td data-bbox="1158 792 1353 826">3</td> </tr> <tr> <td data-bbox="563 828 762 862">216-960</td> <td data-bbox="767 828 954 862">200</td> <td data-bbox="959 828 1153 862">46</td> <td data-bbox="1158 828 1353 862">3</td> </tr> <tr> <td data-bbox="563 864 762 898">Above 960</td> <td data-bbox="767 864 954 898">500</td> <td data-bbox="959 864 1153 898">54</td> <td data-bbox="1158 864 1353 898">3</td> </tr> </tbody> </table> <p>The emission limits shown in the above table are based on measurements employing CISPR quasi-peak detector except for the frequency bands above 1000 MHz. Radiated emission limits in these three bands are based on measurements employing an average detector.</p> <p>For average radiated emission measurements above 1000 MHz, there is also a limit specified when measuring with peak detector function, corresponding to 20 dB above the indicated values in the table.</p>	Freq Range (MHz)	Field Strength (µV/m)	Field Strength (dBµV/m)	Meas. Distance (m)	30-88	100	40	3	88-216	150	43.5	3	216-960	200	46	3	Above 960	500	54	3
Freq Range (MHz)	Field Strength (µV/m)	Field Strength (dBµV/m)	Meas. Distance (m)																			
30-88	100	40	3																			
88-216	150	43.5	3																			
216-960	200	46	3																			
Above 960	500	54	3																			

Test procedure

The radiated setups shown in section A.1 were used to measure the radiated spurious emissions.

Depending on the frequency range and bands being tested, different antennas and filters were used.

The final measurement is done by varying the antenna height, the EUT azimuth over 360° and for both Vertical and Horizontal polarizations.

Test Results**Radiated spurious - 30 MHz – 1 GHz****Radiated Spurious – All modes**

Frequency	Level	Detector	Limit	Margin	Polar
MHz	dB μ V/m	---	dB μ V/m	dB	---
39.5	32.0	Quasi-Peak	40.0	8.0	V
66.2	29.6	Quasi-Peak	40.0	10.4	V

Note 1: The detected spurious signals do not depend on either the operating channel or the modulation mode.

1 GHz – 40 GHz, 802.11n20, MCS0, Chain A**Radiated Spurious – CH157**

Frequency	Level	Detector	Limit	Margin	Polar
MHz	dB μ V/m	---	dB μ V/m	dB	---
7970.5	60.8	Peak	68.2	7.4	V
17360.7	48.6	Peak	68.2	19.6	H

B.2.9 U-NII-5 to U-NII-8

Standard references

FCC part	ISED Clause	Limits																				
15.407 (b) (5)	RSS-248 Clause 4.7.2	For transmitters operating within the 5.925-7.125 GHz band: Any emissions outside of the 5.925-7.125 GHz band must not exceed an e.i.r.p. of -27 dBm/MHz.																				
15.35 (b)	RSS-Gen Clause 8.1	When average radiated emission measurements are specified in this part, including average emission measurements below 1000 MHz, there also is a limit on the peak level of the radio frequency emissions. Unless otherwise specified, e.g., see §§15.250, 15.252, 15.253(d), 15.255, 15.256, and 15.509 through 15.519, the limit on peak radio frequency emissions is 20 dB above the maximum permitted average emission limit applicable to the equipment under test.																				
15.407 (b) (8)	RSS-248 Clause 4.7.2	Unwanted emissions below 1 GHz must comply with the general field strength limits set forth in FCC Part 15.209 and RSS-Gen.																				
15.209	RSS-Gen Clause 8.9	<p>Radiated emissions which fall in the restricted bands, as defined in §15.205(a), must also comply with the radiated emission limits specified in §15.209(a):</p> <table border="1" data-bbox="582 840 1372 1048"> <thead> <tr> <th>Freq Range (MHz)</th> <th>Field Strength (μV/m)</th> <th>Field Strength (dBμV/m)</th> <th>Meas. Distance (m)</th> </tr> </thead> <tbody> <tr> <td>30-88</td> <td>100</td> <td>40</td> <td>3</td> </tr> <tr> <td>88-216</td> <td>150</td> <td>43.5</td> <td>3</td> </tr> <tr> <td>216-960</td> <td>200</td> <td>46</td> <td>3</td> </tr> <tr> <td>Above 960</td> <td>500</td> <td>54</td> <td>3</td> </tr> </tbody> </table> <p>The emission limits shown in the above table are based on measurements employing CISPR quasi-peak detector except for the frequency bands above 1000 MHz. Radiated emission limits in this band is based on measurements employing an average detector.</p> <p>For average radiated emission measurements above 1000 MHz, there is also a limit specified when measuring with peak detector function, corresponding to 20 dB above the indicated values in the table.</p>	Freq Range (MHz)	Field Strength (μV/m)	Field Strength (dBμV/m)	Meas. Distance (m)	30-88	100	40	3	88-216	150	43.5	3	216-960	200	46	3	Above 960	500	54	3
Freq Range (MHz)	Field Strength (μV/m)	Field Strength (dBμV/m)	Meas. Distance (m)																			
30-88	100	40	3																			
88-216	150	43.5	3																			
216-960	200	46	3																			
Above 960	500	54	3																			

Test procedure

The radiated setups shown in section A.1 were used to measure the radiated spurious emissions.

Depending of the frequency range and bands being tested, different antennas and filters were used.

- For frequencies less than or equal to 1000 MHz, measurements were made with the CISPR quasi-peak detector with a resolution bandwidth of 120kHz and a video bandwidth 3 times of the resolution bandwidth.
- For restricted bands, measurements above 1000 MHz were performed using average and peak detectors with a minimum resolution bandwidth of 1 MHz and a video bandwidth 3 times of the resolution bandwidth.
- For unrestricted bands, measurements above 1000 MHz were performed using RMS* and peak detectors with a minimum resolution bandwidth of 1 MHz and a video bandwidth 3 times of the resolution bandwidth.

*RMS detector is required only for FCC. For ISED tests, only average and peak detectors are measured for both restricted and unrestricted bands above 1GHz.

The final measurement is performed by varying the antenna height from 1 m to 4 m, the EUT rotating in azimuth over 360° for both vertical and horizontal polarizations.

Test Results**30 MHz – 1 GHz, Radiated spurious emissions****Radiated Spurious – All modes**

Frequency	Level	Detector	Limit	Margin	Polar
MHz	dB μ V/m	---	dB μ V/m	dB	---
38.9	32.2	Quasi-Peak	40.0	7.8	V
42.3	30.6	Quasi-Peak	40.0	9.4	V
66.2	29.4	Quasi-Peak	40.0	10.6	V

Note 1: The detected spurious signals do not depend on either the operating channel or the modulation mode.

UNII 5**1 GHz – 40 GHz, 802.11ax/be40, MCS0, Chain A****Radiated Spurious – CH3**

Frequency	Level	Detector	Limit	Margin	Polar
MHz	dB μ V/m	---	dB μ V/m	dB	---
7972.8	45.6	RMS	68.2	22.6	H
7973.1	58.4	Peak	88.2	29.8	V
23982.8	48.1	Peak	74.0	25.9	H
23982.8	41.0	Average	54.0	12.9	H
39958.4	55.0	Peak	74.0	19.0	H
39958.4	47.8	Average	54.0	6.2	V

UNII 6**1 GHz – 40 GHz, 802.11ax/be80, MCS0, Chain A****Radiated Spurious – CH107**

Frequency	Level	Detector	Limit	Margin	Polar
MHz	dB μ V/m	---	dB μ V/m	dB	---
7980.7	59.2	Peak	88.2	29.0	H
7982.1	45.5	RMS	68.2	22.7	H
12974.4	47.2	Peak	88.2	41.0	V
12974.4	39.7	RMS	68.2	28.5	V

UNII 7**1 GHz – 40 GHz, 802.11ax/be80, MCS0, Chain B****Radiated Spurious – CH167**

Frequency	Level	Detector	Limit	Margin	Polar
MHz	dBµV/m	---	dBµV/m	dB	---
7986.2	45.3	RMS	68.2	22.9	V
7987.7	59.1	Peak	88.2	29.1	H
39999.0	56.1	Peak	74.0	17.9	H
39999.0	48.0	Average	54.0	6.0	V

UNII 8**1 GHz – 40 GHz, 802.11ax/be80, MCS0, Chain B****Radiated Spurious – CH183**

Frequency	Level	Detector	Limit	Margin	Polar
MHz	dBµV/m	---	dBµV/m	dB	---
5160.0	56.9	Peak	88.2	31.3	H
5160.0	47.8	RMS	68.2	20.4	V
39939.1	55.3	Peak	74.0	18.7	V
39939.1	47.9	Average	54.0	6.1	H