



Suite 408, Pungsan Apt. Factory, 1141-2, Baeksuk-dong,  
Ilsan-gu, Koyang-shi, Kyounggi-do, Korea  
Tel : 82 31 903 9780, Fax : 82 31 903 9787  
E-mail : sales@gtt.co.kr  
URL : <http://www.gtt.co.kr>

# User's manual

## GM Series



PRODUCED BY GTT CO., LTD.

.....

**T**hank you for your selection of new TFT LCD Monitor.  
Please take a few minutes to read this User's manual for the best performance of this monitor.  
Information in this manual is subject to change without prior notice for improving design, function and etc.  
IBM, DOS, PC and VGA are trademarks of International Business Machines Corporation.

---

## **CONTENTS**

- 1. Package Contents**
- 2. Monitor Parts**
- 3. Connecting to PC**
- 4. Features**
- 5. OSD Menu functions**
- 6. Dimension**
- 7. Specification**
- 8. AV OSD function**
- 9. USB function**
- 10. Pivot function**
- 11. Recommended Use**
- 12. Troubleshooting**

## Package Contents

Your TFT-LCD monitor box should contain the following :

### STANDARD PARTS

- **TFT-LCD monitor**
- **DC Power adapter**
  - Connects to DC IN port on the base of monitor
- **Power cord**
  - Connects wall outlet to DC Power adapter
- **D-SUB 15pin video cable**
  - Connects PC to LCD monitor
- **USB upstream cable**
  - Connects PC to USB ports on the base of monitor
- **Stereo audio cable**
  - Connects PC sound card to audio input port on the base of monitor

- **User's manual**
- **Installation CD-ROM**

### OPTIONAL PARTS

- **Video cables (Composite, S-video)**
- **Audio cable for AV monitor**
- **Pivot software**
  - Must be installed to use the monitor in Portrait mode

## Monitor Parts

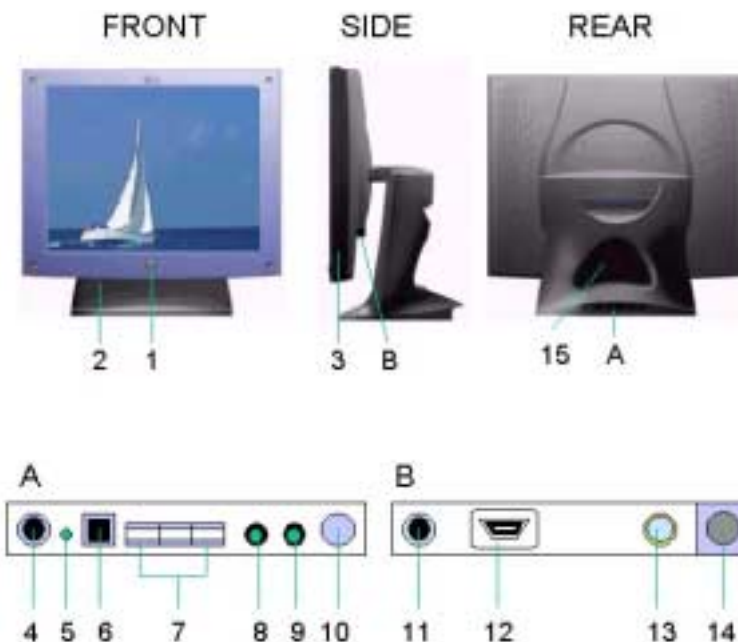

- |                               |  |
|-------------------------------|--|
| 1. Power switch               | 9. Audio IN port                         |
| 2. Speaker hole               | 10. Volume control                       |
| 3. OSD button                 | 11. Power input connect                  |
| 4. Power input connector      | 12. VGA input connector                  |
| 5. LED indicator              | 13. Composite input connector (Optional) |
| 6. USB Up stream connector    | 14. S-Video input connector (Optional)   |
| 7. USB Down stream connectors | 15. Cable hole                           |
| 8. Audio OUT port             |  |

## Connecting to PC

**To attach your TFT-LCD monitor to your system, follow the instructions hereunder**

1. Connect the small DC power cord from the base of the monitor to the head (For first time installation, this step will be completed by the factory)
2. Connect 15-pin D-SUB cable to the connector or display card of your computer system. Tighten all the screws
3. Connect 15-pin D-SUB cable to the appropriate connectors on the back of the monitor head
4. Connect AC adapter cable to the power input connectors on the back of the monitor base
5. Connect one end of the power cord to the AC adapter and the other end to the power outlet
6. Turn on the monitor
  7. To complete the setup
    - A. set up your computer system to :  
1024 x 768 resolution @ 60Hz.
    - B. Use the following OSD controls
      - Auto adjust control
      - Coarse or Clock Phase control

- **Adjustment of the H/V Position and Image Adjust H. Size controls may be required to complete setup of your TFT- LCD monitor. For a full description of these OSD controls, refer to OSD menu functions**
- **Your monitor has two 2 Watt speakers with amplifier. Please connect the speaker jack to the Line out jack of your PC's sound card**

## Features

TFT-LCD (Thin film transistor - liquid crystal display)

The 13.3/14.1/15.1 inch panel and hard coating(3H), anti-glare treatment of the front polarizer enables low reflection, anti-static, high-resolution and high-contrast characteristics.

Plug-and-Play Compatible

This TFT-LCD monitor conforms to the VESA(Video Electronics Standards Association) standard and DDC1/DDC2B. A picture adjustment function makes it possible to adjust the image quality to match the input signal.

An automatic size adjustment function is provided.

Auto-setup control on OSD screen adjust image position, horizontal size or fine settings

Environmentally Friendly

The power consumption can be reduced by using this TFT-LCD monitor in combination of a computer that conforms to the VESA DPMS(Display Power Management Signaling) standard. Desk space can be used effectively due to the 20 cm depth.

VESA standard wall mounting

This TFT-LCD monitor has the VESA (Video Electronics Standards Association) standard wall mounting holes. Monitor head can be mounted on the wall using a VESA-compliant wall mount

## OSD menu functions

**OSD (On-Screen-Display) control buttons functions as follows :**  
**To access OSD Menu, press MENU button**



**MENU : Menu on/move button**

- Show OSD menu on the screen. Moves the highlighted area down to select one of the functions

**EXIT : Menu off button**

- Exit from OSD menu. Exit to main menu from sub menu.

**UP : Adjust button**

- Moves the bar left to decrease the adjustment. Start auto adjust.

**DOWN : Adjust button**

- Moves the bar right to increase the adjustment. Start auto adjust.

**SEL : Input select button (available in AV monitor)**

- Allows the user to select the current signal from the following choice : analog RGB input, Composite video input, S-video input

**[ MAIN MENU DISPLAY ]**



### • AUTO ADJUST



Automatically adjust Image Position, Horizontal Size or Fine setting Press UP or DOWN button to adjust the settings automatically

### • BRIGHTNESS



Controls the brightness of the LCD  
Use UP or DOWN button to increase or decrease the setting

### • CONTRAST



Controls the contrast of the LCD  
Use UP or DOWN button to increase or decrease the setting

### • IMAGE HORI. POSITION



Controls the horizontal image position within the display of the LCD Use the UP or DOWN button to move the image right or left

### • IMAGE VERT. POSITION



Controls the vertical image position within the display of the LCD  
Use the UP or DOWN button to move the image up or down

### • COARSE ( Coarse Tuning)



Improves focus, clarity and image stability  
Use UP or DOWN button to increase or decrease the setting

### • CLOCK PHASE (Fine Tuning)



Improves focus, clarity and image stability  
Use UP or DOWN button to increase or decrease the setting

### • COLOR



Press the UP or DOWN button to enter into the following submenu

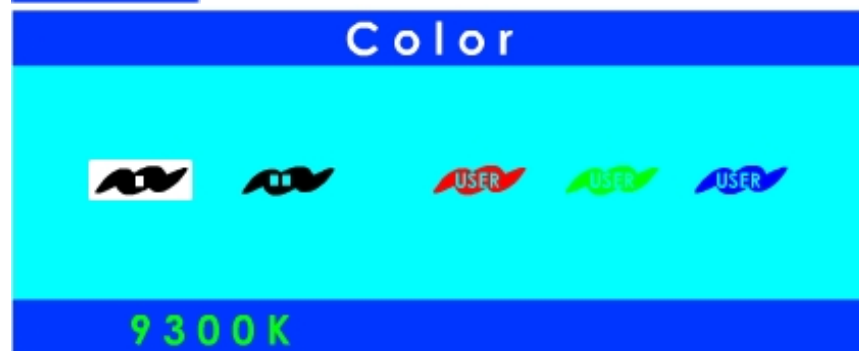

Press the MENU button to select the item you wish to change

#### Color temperature

Provides two preset color adjustment : 9300K and 6500

Select the preset by using MENU button and press EXIT button

### RGB Adjustment

Increases or decreases Red, Green or blue color selected

Use UP or DOWN button to increase or decrease the setting

To exits to the OSD main menu, press the EXIT button

### •LANGUAGE



Provides Five languages for OSD menu.

Select language by using UP or DOWN button

### •INFORMATION



Show the horizontal and vertical frequency

## Dimension

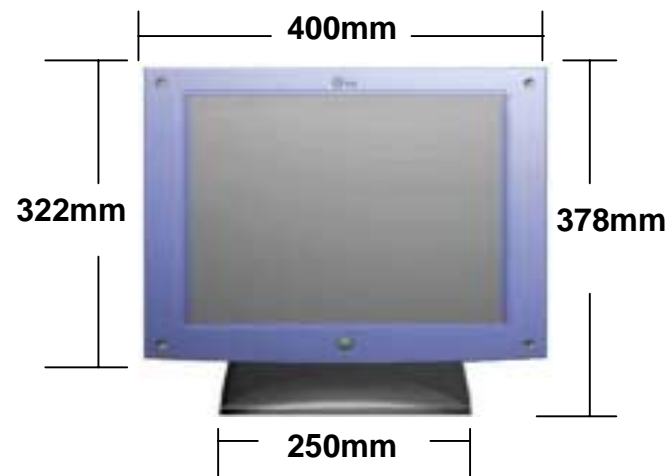

## Specification

MODEL		14.1"
PANEL	Type	Amorphous active matrix TFT-LCD
	Active area	14.1" diagonal
	Pixel format	1024(H) x 768(V)
	Pixel pitch	0.279mm x 0.279mm
	Color depth	6 bit 16M colors by dithering)
	Contrast ratio	200 : 1(Typ.)
	Brightness	150cd/m²
	Display size	285.696 X 214.272
	Viewing angle	U/D: 10° / 30° , R/L: 45° / 45°
	Backlight	1CCFT
	Interface	LVDS
RESOLUTION SUPPORT		XGA 1024 X 768(max)
POWER CONSUMPTION	On working	<30 watt
	Off	<4 watt
OSD CONTROL	Function	Brightness, Contrast, Tuning, Color, Image position(H.V), Language select, Information, Input select, Auto adjust, Information, AV control (Optional)
Plug & Play		DDC1/DDC2B
POWER SAVING		VESA DPMS
Audio	Speakers	3W x 2 with AMP on stand
POWER SUPPLY ADAPTER	Input	AC 100V~240V, 50~60Hz
	Output	12VDC
STANDARD ACCESSORIES		15-PIN VGA cable, AC adapter, Power cord, User's guide
OPTION	Touch screen	Resistive type
	A/V	Composite, S-Video input
	Pivot software	Landscape / Portrait

15.0"	15.1"
Amorphous active matrix TFT-LCD 15.0" diagonal 1024(H) x 768(V) 0.297mm x 0.297mm 8 bit 16M colors 200 : 1(Typ.) 200cd/m² 304.128 X 228.096 U/D: 30° / 55° , R/L: 55° / 55° 4CCFT TTL	Amorphous active matrix TFT-LCD 15.1" diagonal 1024(H) x 768(V) 0.30mm x 0.30mm 6 bit, 262,144 colors (16M colors by dithering) 200 : 1(Typ.) 200cd/m² 307.2 X 230.4 U/D: 45° / 45° , R/L: 60° / 60° 2CCFT TTL
XGA 1024 X 768(max)	XGA 1024 X 768(max)
<30 watt <4 watt	<30 watt <4 watt
Brightness, Contrast, Tuning, Color, Image position(H.V), Language select, Information, Input select, Auto adjust, Information, AV control (Optional)	Brightness, Contrast, Tuning, Color, Image position(H.V), Language select, Information, Input select, Auto adjust, Information, AV control (Optional)
DDC1/DDC2B	DDC1/DDC2B
VESA DPMS	VESA DPMS
3W x 2 with AMP on stand	3W x 2 with AMP on stand
AC 100V~240V, 50~60Hz 12VDC	AC 100V~240V, 50~60Hz 12VDC
15-PIN VGA cable, AC adapter, Power cord, User's guide	15-PIN VGA cable, AC adapter, Power cord, User's guide
Resistive type Composite, S-Video input Landscape / Portrait	Resistive type Composite, S-Video input Landscape / Portrait



## AV OSD Function

[ MAIN MENU DISPLAY ]



### • AUTO ADJUST



Automatically adjust Image Position, Horizontal Size or Fine setting Press UP or DOWN button to adjust the settings automatically

### • BRIGHTNESS



Controls the brightness of the LCD  
Use UP or DOWN button to increase or decrease the setting

### • CONTRAST



Controls the contrast of the LCD  
Use UP or DOWN button to increase or decrease the setting

### • IMAGE HORI. POSITION



Controls the horizontal image position within the display of the LCD Use the UP or DOWN button to move the image right or left

### • IMAGE VERT. POSITION

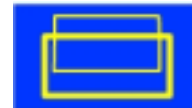

Controls the vertical image position within the display of the LCD  
Use the UP or DOWN button to move the image up or down

### • SATURATION



Adjusts the depth of the video color  
Use UP or DOWN button to increase or decrease the setting

### • HUE



Adjusts the lightness of the video color  
Use UP or DOWN button to increase or decrease the setting

### • LANGUAGE



Provides Five languages for OSD menu.  
Select language by using UP or DOWN button

## •INFORMATION



Show the type of video input signal

## USB Function

You can attach USB peripheral devices (mouse, keyboard, etc.) To complete the USB installation, do the following:

1. Connect the USB cable from the computer to the USB IN jack on the rear of the base.
2. Plug the USB peripheral devices into any downstream port on the rear of the base

### • USB HUB

1 up & 3 down stream

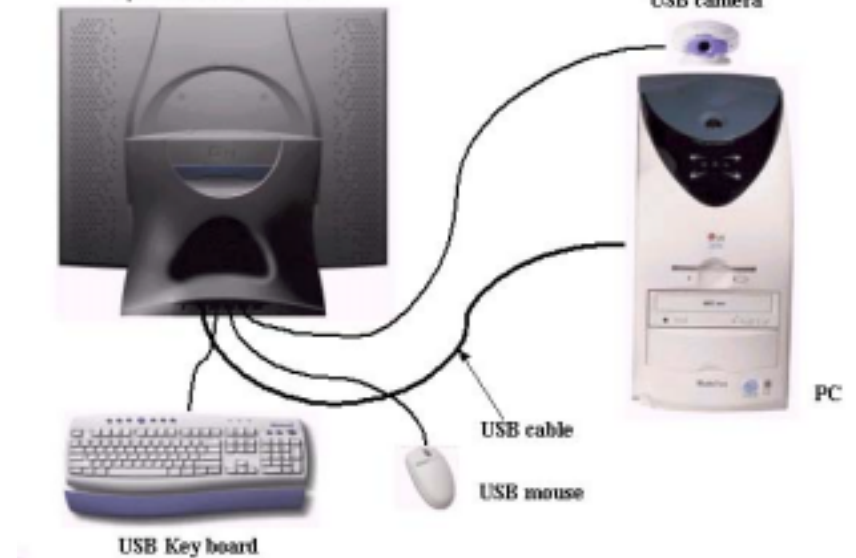

## Pivot

- Landscape (horizontal) mode, like on most existing monitors, is great for spreadsheets or computer games.
- Portrait (vertical) mode is the form factor of most documents we use daily in the office and on the Internet.



To switch from landscape (default) to Portrait modes, do the following:

1. Face front of the monitor
2. Pull bottom of the monitor toward you to tilt bottom away from base.
3. After tilting the monitor, manually rotate the monitor clockwise 90°

To switch from Portrait to Landscape mode, follow steps 1 - 3 above, but manually rotate the monitor head counter-clockwise 90°

**Note :** Before using the portrait display mode, you must first install the pivot software(optional) included with your monitor. Follow the instructions that accompany the pivot software.

## Recommended Use

**FOR OPTIMUM PERFORMANCE, PLEASE NOTE THE FOLLOWING WHEN SETTING UP AND USING THE TFT-LCD MONITOR.**

- DO NOT OPEN THE MONITOR. Opening or removing covers may expose you to dangerous shock hazards or other risks. Once you open it the warranty voids.
- Do not put anything on top of the monitor.
- Do not spill any liquids into the cabinet or use your monitor near water.
- Do not place this product on a sloping or unstable cart, stand or table, as the monitor may fall, causing serious damage to the monitor.
- If you connect or disconnect the VGA cable while both of PC's and LCD monitor's power is turned on, the monitor might show some garbage on the screen or could be damaged. Please turn off the TFT-LCD monitor's power before connect or disconnect VGA cable
- Handle with care when transporting. Save packaging for transporting.
- Do not touch or press the surface of the LCD panel, it will cause a permanent damage. Use only soft cloth with non-ammonia glass cleaner to clean the panel.

## **Troubleshooting**

### **No image on the screen**

- The signal cable should be completely connected to the display card/computer.
- The display card should be completely seated in its slot.
- Power switch and computer power switch should be in the ON position.
- Check to make sure that a supported mode has been selected on the display card or system being used. (Please consult display card or system manual to change graphics mode.)
- Check to make sure that the refresh rate is 60Hz.
- Check the monitor and display card with respect to compatibility and recommended settings.
- Check the signal cable connector for bent or pushed-in pins.

### **Power button does not respond**

- Simultaneously press Power buttons.
- Unplug the power cord of the monitor from the AC outlet, wait 10 to 20 minutes, then plug the power cord into the AC outlet. This will reset the monitor and power supply.

### **LED on monitor is AMBER (with no image on the screen)**

- The signal cable should be completely connected to the display card/computer.
- Make sure the computer is not in a power-saving mode (touch the keyboard or mouse)

### **Image is unstable, unfocused or swimming is apparent**

- Signal cable should be completely attached to the computer
- Use OSD Image Adjust controls to focus and adjust display by increasing or decreasing the *Tuning* control. - When display mode is changed, the OSD Image Adjust settings may need to be re-adjusted.
- Check the monitor and display card with respect to compatibility and recommended signal timings. If your text is garbled, change the video mode to non-interlaced and use 60Hz refresh rate.

### **Display is not sized properly**

- Use OSD Image size horizontal controls to increase or decrease the H. Size.
- Check to make sure that a supported mode and signal timing has been selected on the display card and system being used. (Please consult display card or system manual to change graphics mode or refresh rate.)