

PRECISE BIOACCESS™

- IDENTIFIES PEOPLE, NOT PIN CODES
- RELIABLE ONE-TO-ONE MATCHING
- PLUG AND PLAY
- COMPATIBLE WITH ALL MAJOR ACCESS-CONTROL SYSTEMS

Precise BioAccess™ is a plug and play fingerprint reader that offers unparalleled security for access control. Our unique Precise BioMatch™ technology provides reliable one-to-one matches – personal proof that people are who they claim to be.

Precise BioAccess™ is compatible with Data/Clock (Magstripe), Wiegand 26-56 bits and RS485. Match-on-card technology is also supported. Precise BioAccess™ uses templates stored in a handy database and comes in three models.

Precise BioAccess™ is convenient, fast, accurate, easy to implement and extremely cost effective. It's ideal for new systems and a straightforward, inexpensive way to heighten security in existing systems.

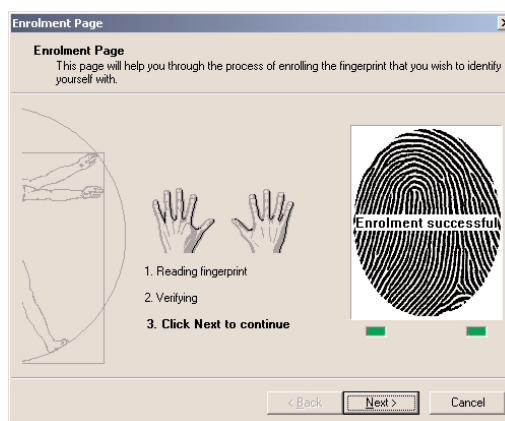

PRECISE BIOACCESS™



Mifare Contactless Card

FEATURES

- Sound On/Off
- External LED control
- Contactless reader technique
- Encrypted template storage
- Easy installation
- No new wiring
- No new software upgrades for access control system
- Matching technique: Precise BioMatch™
- Up to 40 mm read range

TECHNICAL SPECIFICATIONS

- Size 125*68*61 mm (h/w/t)
- Sensor type: Optical
- Sensor resolution: 500 dpi
- Sensor size: 16*14 mm
- Power supply: 12-24 V DC, max 0.25 A, idle 0,11 A
- Outputs:
 - Wiegand
 - Data/Clock (Magstripe), with card present
 - RS485 (Optional, OEM)
 - RS232 (Optional, OEM)
 - Current loop (Optional OEM)
- Inputs:
 - Led control
- Supporting ISO 14443A contactless proximity smart cards
- Supported card: Mifare Standard
- Operating temp: 10°C to +50°C
- LED Indicator: Dual-colour (red & green)

PERFORMANCE

- Verification: less than 1 second
- FAR: < 1 in 2.000
- FRR: < 1 in 100
- Enrolment Time: <10 seconds

BIOMETRIC ENROLMENT STATION

- Pentium II processor or better
- MS Windows (98/NT/2000)
- Precise 100 SC/A Fingerprint reader
- Precise Mifare reader



iButton

FEATURES

- Sound On/Off
- External LED control
- iButton reader technique
- Encrypted template storage
- Easy installation
- No new wiring
- No new software upgrades for access control system
- Matching technique: Precise BioMatch™

TECHNICAL SPECIFICATIONS

- Size 125*68*61 mm (h/w/t)
- Sensor type: Optical
- Sensor resolution: 500 dpi
- Sensor size: 16*14 mm
- Power supply: 12-24 V DC, max 0.25 A, idle 0,11 A
- Outputs:
 - Wiegand
 - Data/Clock (Magstripe), with card present
 - RS485 (Optional, OEM)
 - RS232 (Optional, OEM)
 - Current loop (Optional OEM)
- Inputs:
 - Led control
- Supported iButtons: DS1995L-F5, DS1996L-F5
- Operating temp: 10°C to +50°C
- LED Indicator: Dual-colour (red & green)

PERFORMANCE

- Verification: less than 1 second
- FAR: < 1 in 2.000
- FRR: < 1 in 100
- Enrolment Time: <10 seconds

BIOMETRIC ENROLMENT STATION

- Pentium II processor or better
- MS Windows (98/NT/2000)
- Precise 100 SC/A Fingerprint reader
- iButton reader



Contact Smart Card

FEATURES

- Sound On/Off
- External LED control
- Encrypted template storage
- Easy installation
- No new wiring
- No new software upgrades for access control system
- Ready for MOC
- Matching technique: Precise BioMatch™

TECHNICAL SPECIFICATIONS

- Size 125x68x61 mm (h/w/t)
- Sensor type: Optical
- Sensor resolution: 500 dpi
- Sensor size: 16*14 mm
- Power supply: 12-24 V DC, max 0.25 A, idle 0,11 A
- Outputs:
 - Wiegand
 - Data/Clock (Magstripe), with card present
 - RS485 (Optional, OEM)
 - RS232 (Optional, OEM)
 - Current loop (Optional OEM)
- Inputs:
 - Led control
- Operating temp: 10°C to +50°C
- LED Indicator: Dual-colour (red & green)

PERFORMANCE

- Verification: less than 1 second
- FAR: < 1 in 2.000
- FRR: < 1 in 100
- Enrolment Time: <10 seconds

BIOMETRIC ENROLMENT STATION

- Pentium II processor or better
- MS Windows (98/NT/2000)
- Precise 100 SC/A Fingerprint reader



All specifications are subject to change without notice.