

WLAN USB Adapter

WL-8811CU-V2

| Product requirement | |
|-----------------------|---|
| Power Supply | DC 5V/500mA |
| Operating Temperature | 0 ~ 60°C ambient temperature 5 to 90% (non-condensing) |
| Storage Temperature | -10 ~ 70°C ambient temperature 5 to 95% (non-condensing) |
| Wi-Fi Spec. | IEEE802.11b/ IEEE802.11g/ IEEE802.11n/ IEEE802.11ac |
| RF Spectrum | 2.4GHz: 2.412MHz ~ 2.462GHz 5GHz: 5.180MHz ~ 5.320GHz |

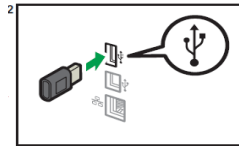

■ Operating Instruction

1. USB Dongleはプリンタ内部に設置済みです。
無線接続、Wi-Fi接続方法と設定の詳細は、プリンター本機に付属のマニュアルを参照してください。

1. USB Dongle is assembled on the inside printer.
Regarding wireless connection and Wi-Fi connection, for details about connections and settings, see the manuals supplied with the printer.

Setzen Sie die Wireless-LAN-Option in den USB-Anschluss auf der Rückseite des Geräts ein.

Verwenden Sie für die Wireless-LAN-Option nicht den USB-Anschluss an der Vorderseite des Geräts. Einzelheiten zu Verbindungen und Einstelllungen finden Sie in den mit dem Gerät mitgelieferten Handbüchern.

Insérez le LAN sans fil en option dans le port USB à l'arrière de l'appareil.

N'insérez pas le LAN sans fil en option dans le port USB à l'avant de l'appareil. Pour plus d'informations concernant les connexions et paramètres, consultez les manuels fournis avec cet appareil.

Indsæt USB-enheden til trådløst LAN i USB-porten bag på maskinen.

USB-enheden til trådløst LAN må ikke indsættes i USB-porten på forsiden af maskinen. For detaljer om tilslutning og indstillinger, se de medfølgende vejledninger til maskinen.

Inserte la opción de LAN inalámbrica en el puerto USB de la parte trasera de la máquina.

No inserte la opción de LAN inalámbrica en el puerto USB de la parte frontal de la máquina. Para más información sobre las conexiones y los ajustes, consulte los manuales suministrados con la máquina.

Steek de optionele USB-adapter voor draadloos LAN in de USB-poort aan de achterkant van het apparaat.

Steek de optionele USB-adapter voor draadloos LAN niet in de USB-poort aan de voorkant van het apparaat. Voor meer informatie over verbindingen en instellingen, zie de handleidingen die zijn meegeleverd met het apparaat.

Sett inn trådløst LAN-enheten (tilleggsstyr) i USB-porten på baksiden av maskinen.

Ikke sett inn trådløst LAN-enheten i USB-porten foran på maskinen. Hvis du vil ha mer informasjon om tilkoblinger og innstillinger, kan du se i brukerhåndbøkene som følger med maskinen.

Introduza a opção de wireless LAN na porta USB na parte traseira do equipamento.

Não introduza a opção de wireless LAN na porta USB na parte frontal do equipamento. Para mais informações sobre ligações e definições, consulte os manuais fornecidos com o equipamento.

Insira o opcional de LAN wireless na porta USB na parte posterior o equipamento.

Não insira o opcional de LAN wireless na porta USB localizada na parte frontal do equipamento. Para obter mais informações sobre conexões e definições, consulte os manuais fornecidos com o equipamento.

Aseta WLAN-lisävaruste laitteen takana olevaan USB-porttiin.

Älä liitä langatonta LAN-valintaa laitteen edessä olevaan USB-porttiin. Lisätietoja yhteyksistä ja asetuksista, katso laitteen mukana toimitetut oppaat.

Sätt i WLAN-mottagaren i USB-porten på maskinens baksida.

Sätt inte i WLAN-mottagaren i USB-porten på framsidan av maskinen. För mer information om anslutningar och inställningar, se handböckerna som levererades med maskinen.

Vložte modul bezdrátové síť LAN do USB portu na zadní straně zařízení.

Nevkládejte modul bezdrátové síť LAN do USB portu na přední straně zařízení. Podrobnosti ohledně připojení a nastavení viz příručky dodávané se zařízením.

Illesze be a vezeték nélküli LAN opciót a készülék hátdoldalán található USB portba.

Ne illesze be a vezeték nélküli LAN opciót a készülék elülső oldalán található USB portba. További részletek a csatlakozásokról és a beállításokról a készülék útmutatóiban található.

Włóż do portu USB z tyłu urządzenia adapter sieci bezprzewodowej.

Nie wkładaj adaptera sieci bezprzewodowej do portu USB z przodu urządzenia. Aby uzyskać więcej informacji dotyczących połączeń i ustawień, zajrzyj do podręcznika dostarczonego z urządzeniem.

Kablosuz LAN seçeneğini makinenin arkasındaki USB bağlantı noktasına takın.

Kablosuz LAN seçeneğini makinenin önündeki USB bağlantı noktasına takmayın. Bağlantı ve ayarlar hakkında ayrıntılı bilgi için makinenin beraberinde verilen kılavuzlara bakınız.

Вставьте модуль беспроводной ЛВС в USB-разъем на задней панели аппарата.

Не вставляйте модуль беспроводной ЛВС в USB-разъем на передней панели аппарата. Для получения сведений о подключении и настройках см. руководства, прилагаемые к аппарату.

Сымсыз жергілікті опцияны құрылғының артқы жағындағы USB портына жалғаңыз.

Сымсыз жергілікті желі опциясын құрылғының алдыңғы жағындағы USB портына қоспаңыз. Қосылымдар мен баптаулар туралы толық мөлiметті құрылғымен бiрге жеткізілген нұсқаулардан қараңыз.

將無線LAN選購件插入機器背後的USB連接埠。
請勿將無線LAN選購件插入機器正面的USB連接埠。關於連線與設定的詳細資訊，請參閱機器隨附的手冊。

Information for This Machine

User Information on Electrical & Electronic Equipment Region **A** (mainly Europe and Asia)

Users in the countries where this symbol shown in this section has been specified in national law on collection and treatment of E-waste

Our Products contain high quality components and are designed to facilitate recycling.

Our products or product packaging are marked with the symbol below.



The symbol indicates that the product must not be treated as municipal waste. It must be disposed of separately via the appropriate return and collection systems available. By following these instructions you ensure that this product is treated correctly and help to reduce potential impacts on the environment and human health, which could otherwise result from inappropriate handling. Recycling of products helps to conserve natural resources and protect the environment.

For more detailed information on collection and recycling systems for this product, please contact the shop where you purchased it, your local dealer or sales/service representatives.

All Other Users

If you wish to discard this product, please contact your local authorities, the shop where you bought this product, your local dealer or sales/service representatives.

For Users in India

This product including components, consumables, parts and spares complies with the "India E-waste Rule" and prohibits use of lead, mercury, hexavalent chromium, polybrominated biphenyls or polybrominated diphenyl ethers in concentrations exceeding 0.1 weight % and 0.01 weight % for cadmium, except for the exemptions set in the Rule.

For Turkey only

AEEE Yönetmeliğine Uygundur.
Bu sistem sarf malzemeleri ve yedek parçaları da dahil olmak üzere AEEE Yönetmeliğine Uygundur.

Üretici:

Ricoh Company, Ltd.

3-6, Nakamagome 1-chome,
Ohta-ku, Tokyo 143-8555 Japan

+81-3-3777-8111 (English only/Sadece İngilizce)

Note for the Battery and/or Accumulator Symbol (For EU countries only)



In accordance with the Battery Directive 2006/66/EC Article 20 Information for end-users Annex II, the above symbol is printed on batteries and accumulators.

This symbol means that in the European Union, used batteries and accumulators should be disposed of separately from your household waste.

In the EU, there are separate collection systems for not only used electrical and electronic products but also batteries and accumulators.

Please dispose of them correctly at your local community waste collection/recycling centre.

Environmental Advice for Users Region A (mainly Europe)

Users in the EU, Switzerland and Norway

Consumables yield

Please refer to either the User's Manual for this information or the packaging of the consumable.

Recycled paper

The machine can use recycled paper which is produced in accordance with European standard EN 12281:2002 or DIN 19309. For products using EP printing technology, the machine can print on 64 g/m² paper, which contains less raw materials and represents a significant resource reduction.

Duplex printing (if applicable)

Duplex printing enables both sides of a sheet of paper to be used. This saves paper and reduces the size of printed documents so that fewer sheets are used. We recommend that this feature is enabled whenever you print.

Toner and ink cartridge return program

Toner and ink cartridge for recycling will be accepted free of charge from users in accordance with local regulations.

For details about the return program, please refer to the Web page below or consult your service person.

<https://www.rioh-return.com/>

Energy efficiency

The amount of electricity a machine consumes depends as much on its specifications as it does on the way you use it. The machine is designed to allow you to reduce electricity costs by switching to Ready mode after it prints the last page. If required, it can immediately print again from this mode. If no additional prints are required and a specified period of time passes, the device switches to an energy saving mode.

In these modes, the machine consumes less power (watts). If the machine is to print again, it needs a little longer to return from an energy saving mode than from Ready mode.

For maximum energy savings, we recommend that the default setting for power management is used.

Products that comply with the Energy Star requirement are always energy efficient.

NOTES TO USERS REGARDING FACSIMILE UNIT (NEW ZEALAND)

The grant of a Telepermit for any item of terminal equipment indicates only that Telecom has accepted that the item complies with minimum conditions for connection to its network. It indicates no endorsement of the product by Telecom, nor does it provide any sort of warranty. Above all, it provides no assurance that any item will work correctly in all respects with another item of Telepermitted equipment of a different make or model, nor does it imply that any product is compatible with all of Telecom's network services.

This equipment is not capable, under all operating conditions, of correct operation at the higher speeds for which it is designed. Telecom will accept no responsibility should difficulties arise in such circumstances.

Devices connected to the telephone port may lose their memory if this fax machine is on line for extended periods. To prevent this, such devices should have the facility for battery or similar backup of memory.

This device may be subject to ringing or bell tinkle when certain other devices are connected to the same line. If this occurs, the problem should not be referred to the Telecom Faults Service.

This equipment should not be used under any circumstances that may constitute a nuisance to other Telecom customers.

Telepermitted equipment only may be connected to the auxiliary telephone port. The auxiliary telephone port is not specifically designed for 3-wire connected equipment that may not respond to incoming ringing when attached to this port.

Notes to users in the state of California (Notes to Users in USA)

Perchlorate Material - special handling may apply. See: www.dtsc.ca.gov/hazardouswaste/perchlorate

Notes to users in the United States of America

FCC Rules

Note:

This equipment has been tested and found to comply with the limits for a Class B digital device, pursuant to Part 15 of the FCC Rules. These limits are designed to provide reasonable protection against harmful interference in a residential installation. This equipment generates, uses and can radiate radio frequency energy and, if not installed and used in accordance with the instructions, may cause harmful interference to radio communications. However, there is no guarantee that interference will not occur in a particular installation. If this equipment does cause harmful interference to radio or television reception, which can be determined by turning the equipment off and on, the user is encouraged to try to correct the interference by one or more of the following measures:

- Reorient or relocate the receiving antenna.
- Increase the separation between the equipment and receiver.
- Connect the equipment into an outlet on a circuit different from that to which the receiver is connected.
- Consult the dealer or an experienced radio /TV technician for help.

Caution:

Federal Communication Commission (FCC) Radiation Exposure Statement

This EUT is compliance with SAR for general population/uncontrolled exposure limits in ANSI/IEEE C95.1-1999 and had been tested in accordance with the measurement methods and procedures specified in OET Bulletin 65 Supplement C. This equipment should be installed and operated with minimum distance 0.5cm between the radiator & your body.

Supplier's Declaration of Conformity

This device complies with Part 15 of the FCC Rules.

Operation is subject to the following two conditions:

- (1) This device may not cause harmful interference, and
- (2) this device must accept any interference received, including interference that may cause undesired operation.

Responsible party: Ricoh USA, Inc.

Address: 70 Valley Stream Parkway Malvern, Pennsylvania 19355

Telephone number: 610-296-8000

Product Name: Multifunction Digital Product(Copier/Printer/Scanner), Printer

Model Number: M C250FW, M C250FWB, P C300W, P C301W

Part 68 of the FCC Rules regarding Facsimile Unit

1. This equipment complies with Part 68 of the FCC rules and requirements adopted by the ACTA. On the cover of this equipment is a label that contains, among other information, a product identifier in the format US:AAAEQ##TXXXXX. If requested, this number must be provided to the telephone company.
2. This equipment uses the RJ11C USOC jack.
3. A plug and jack used to connect this equipment to the premises wiring and telephone network must comply with the applicable FCC Part 68 rules and requirements adopted by the ACTA. A compliant telephone cord and modular plug is provided with this product. It is designed to be connected to a compatible modular jack that is also compliant. See installation instructions for detail.
4. The REN is used to determine the number of devices that may be connected to a telephone line. Excessive RENs on a telephone line may result in the devices not ringing in response to an incoming call. In most but not all areas, the sum of RENs should not exceed five (5.0). To be certain of the number of devices that may be connected to a line, as determined by the total RENs, contact the local telephone company. The REN for this product is part of the product identifier that has the format US:AAAEQ##TXXXXX. The digits represented by ## are the REN without a decimal point (e.g., 03 is a REN of 0.3).
5. If this equipment causes harm to the telephone network, the telephone company will notify you in advance that temporary discontinuance of service may be required. But if advance notice is not practical, the telephone company will notify the customer as soon as possible. Also, you will be advised of your right to file a complaint with the FCC if you believe it is necessary.

6. The telephone company may make changes in its facilities, equipment, operations or procedures that could affect the operation of the equipment. If this happens the telephone company will provide advance notice in order for you to make necessary modifications to maintain uninterrupted service.
7. If trouble is experienced with this equipment, for repair or warranty information, please contact Ricoh USA, Inc. Customer Support Department at 1-888-456-6457. If this device is causing problems with your telephone network, the telephone company may request that you disconnect the equipment until the problem is resolved.
8. In the event of operation problems (document jam, copy jam, communication error indication), see the manual provided with this machine for instruction on resolving the problem.
9. Connection to party line service is subject to state tariffs. Contact the state public utility commission, public service commission or corporation commission for information.
10. If your home has specially wired alarm equipment connected to the telephone line, ensure the installation of this equipment does not disable your alarm equipment. If you have questions about what will disable alarm equipment, consult your telephone company or a qualified installer.

WHEN PROGRAMMING EMERGENCY NUMBERS AND/OR MAKING TEST CALLS TO EMERGENCY NUMBERS:

1. Remain on the line and briefly explain to the dispatcher the reason for the call before hanging up.
2. Perform such activities in the off-peak hours, such as early morning hours or late evenings.

The Telephone Consumer Protection Act of 1991 makes it unlawful for any person to use a computer or other electronic device, including FAX machines, to send any message unless such message clearly contains in a margin at the top or bottom of each transmitted page or on the first page of the transmission, the date and time it is sent and an identification of the business or other entity, or other individual sending the message and the telephone number of the sending machine or such business, other entity, or individual. (The telephone number provided may not be a 900 number or any other number for which charges exceed local or long-distance transmission charges.)

In order to program this information into your FAX machine, you should complete the following steps: Follow the FAX HEADER programming procedure in the Programming chapter of the operating instructions to enter the business identification and telephone number of the terminal or business. This information is transmitted with your document by the FAX HEADER feature. In addition to the information, be sure to program the date and time into your machine.

Notes to Canadian Users of Wireless Devices

This device complies with Industry Canada's licence-exempt RSSs.

Operation is subject to the following two conditions:

- (1) This device may not cause interference; and

(2) This device must accept any interference, including interference that may cause undesired operation of the device.

Federal Communication Commission (FCC) Radiation Exposure Statement

This EUT is compliance with SAR for general population/uncontrolled exposure limits in ANSI/IEEE C95.1-1999 and had been tested in accordance with the measurement methods and procedures specified in OET Bulletin 65 Supplement C. This equipment should be installed and operated with minimum distance 0.5cm between the radiator & your body.

5150-5250 MHz band is restricted to indoor operation only.

5250-5350 MHz band is restricted to indoor operation only.

Compliance with ISED requirement RSS-247 6.4 a) Data transmission is always initiated by software, which is the passed down through the MAC, through the digital and analog baseband, and finally to the RF chip. Several special packets are initiated by the MAC. These are the only ways the digital baseband portion will turn on the RF transmitter, which it then turns off at the end of the packet. Therefore, the transmitter will be on only while one of the aforementioned packets is being transmitted. In other words, this device automatically discontinue transmission in case of either absence of information to transmit or operational failure.

Remarques à l'attention des utilisateurs canadiens d'appareils sans fil

Le présent appareil est conforme aux CNR d'Industrie Canada applicables aux appareils radio exempts de licence.

L'exploitation est autorisée aux deux conditions suivantes :

(1) l'appareil ne doit pas produire de brouillage, et

(2) l'appareil doit accepter tout brouillage radioélectrique subi, même si le brouillage est susceptible d'en compromettre le fonctionnement.

Cet EUT est conforme à la norme SAR pour la population générale / limites d'exposition non contrôlées selon la norme ANSI / IEEE C95.1-1999 et a été testé conformément aux méthodes et procédures de mesure spécifiées dans le CNR-102. Cet équipement doit être installé et utilisé à une distance minimale. 0,5 cm entre le radiateur et votre corps. "

La bande 5150-5250 MHz est restreinte à une utilisation à l'intérieur seulement.

La bande 5250-5350 MHz est restreinte à une utilisation à l'intérieur seulement.

Conformité à la norme CNR-247 6.4 a) La transmission des données est toujours initiée par le logiciel, puis les données sont transmises par l'intermédiaire du MAC, par la bande de base numérique et analogique et, enfin, à la puce RF. Plusieurs paquets spéciaux sont initiés par le MAC. Ce sont les seuls moyens pour qu'une partie de la bande de base numérique active l'émetteur RF, puis désactive celui-ci à la fin du paquet. En conséquence, l'émetteur reste uniquement activé lors de la transmission d'un des

paquets susmentionnés. En d'autres termes, ce dispositif interrompt automatiquement toute transmission en cas d'absence d'information à transmettre ou de défaillance.

Notes to Canadian Users regarding Facsimile Unit

This product meets the applicable Innovation, Science and Economic Development Canada technical specifications.

The Ringer Equivalence Number (REN) indicates the maximum number of devices allowed to be connected to a telephone interface. The termination of an interface may consist of any combination of devices subject only to the requirement that the sum of the RENs of all the devices not exceed five.

Remarques à l'attention des utilisateurs canadiens

Le présent produit est conforme aux spécifications techniques applicables d'Innovation, Sciences et Développement économique Canada.

L'indice d'équivalence de la sonnerie (IES) sert à indiquer le nombre maximal de dispositifs qui peuvent être raccordés à une interface téléphonique. La terminaison d'une interface peut consister en une combinaison quelconque de dispositifs, à la seule condition que la somme des IES de tous les dispositifs n'excède pas cinq.

ENERGY STAR Program

ENERGY STAR® Program Requirements for Imaging Equipment



The ENERGY STAR® Program Requirements for Imaging Equipment encourage energy conservation by promoting energy efficient computers and other office equipment.

The program backs the development and dissemination of products that feature energy saving functions.

It is an open program in which manufacturers participate voluntarily.

Targeted products are computers, monitors, printers, facsimiles, copiers, scanners, and multifunction devices. Energy Star standards and logos are internationally uniform.

Saving Energy

This machine is equipped with the following Energy Saver modes: Energy Saver mode 1 and Energy Saver mode 2. If the machine has been idle for a certain period of time, the machine automatically enters Energy Saver mode.

The machine recovers from Energy Saver mode when it receives a print job, prints a received fax, or when any key is pressed.



Energy Saver mode 1

The machine enters Energy Saver mode 1 if the machine has been idle for about 30 seconds. It takes less time to recover from Energy Saver mode 1 than from power-off state or Energy Saver mode 2, but power consumption is higher in Energy Saver mode 1 than in Energy Saver mode 2.

Energy Saver mode 2

The machine enters Energy Saver mode 2 after the period of time specified for this setting is passed. Power consumption is lower in Energy Saver mode 2 than in Energy Saver mode 1, but it takes longer to recover from Energy Saver mode 2 than from Energy Saver mode 1.

Specifications

| | | |
|-------------------------------|---------------------------------|--|
| Energy Saver mode 1 | Power Consumption ^{*1} |  Region A 44.2 W  Region B 42.6 W |
| | Default Time | 30 seconds |
| | Recovery Time ^{*1} | 10 seconds or less |
| Energy Saver mode 2 | Power Consumption ^{*1} | 1.3 W |
| | Default Time | 1 minute |
| | Recovery Time ^{*1} | 30 seconds |
| Duplex Function ^{*2} | | Standard |

*1 Recovery time and power consumption may differ depending on the conditions and environment of the machine.

*2 Achieves ENERGY STAR energy savings; product fully qualifies when packaged with (or used with) a duplex tray and the duplex function is enabled as an option.

For details about Energy Saver modes, see page 251 "Administrator Tools Settings".

Note

- If the machine is in Energy Saver mode for 24 hours continuously, the machine automatically returns to normal state and performs self-maintenance.