

TR-026 Remote Controller User Manual

RC-046 + TR-026 Outdoor Wireless Remote Control

IMPORTANT SAFEGUARDS

NOTE: These are general definitions only; all may not pertain to the actual product purchased.
DANGER: Indicates an imminently hazardous situation which, if not avoided, will result in death or serious injury. Usage of this signal word is limited to the most extreme situations.
WARNING: Indicates potentially hazardous situation, which, if not avoided, may result in minor / moderate injury or product/ property damage. It also alerts against unsafe practices.
CAUTION: Indicates a potentially hazardous situation, which, if not avoided, may result in minor/moderate injury or product/ property damage. It also alerts against unsafe practices.

When using electrical products, always follow basic safety precautions including the following:



READ ALL INSTRUCTIONS BEFORE USE.

⚠ WARNING

Choking Hazard-- Small parts.
Not for children under 3 years.

- ⚠ **WARNING--** To reduce the risk of fire, electric shock, or serious personal injury
- Do not immerse the product in liquids
 - Do not use an electrical device or appliance with this product whose electrical specifications exceed those specified in the "Electrical Specifications" section of this manual.
 - For Indoor/Outdoor use.

- ⚠ **CAUTION--** To reduce the risk of personal injury or product/ property damage:
- This product is intended for non-commercial, non-industrial use in the remote control of two electrical outlets. Do not use this product for any other purpose.

Features: Controls one electrical outlet up to a distance of 100 feet.

Caution:

- Always purchase the correct size and grade of battery most suitable for the intended use.
- Replace all batteries of a set at the same time.
- Clean the battery contacts and also those of the device prior to battery installation.
- Ensure the batteries are installed correctly with regard to polarity (+and -).
- Remove batteries from equipment with is not to be used for an extended period of time.
- Remove used batteries promptly.

ELECTRICAL RATINGS

125V ac, 60Hz,
15 A Resistive, 15 A General Use, 1000W Tungsten,
500VA Electronic Ballast, 1/2 HP,
120 Vac, 8.3 A Ballast.

RECEIVER MODEL: RC-046
TRANSMITTER MODEL: TR-026
FCC ID: PAGTR-026
IC: 4494A-TR026

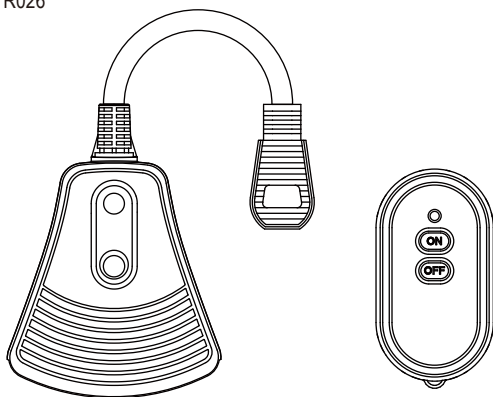

Battery Handling and Usage

- WARNING:** Keep batteries away from children and pets.
- Follow the battery manufacturer's safety and usage instructions.
 - Insert the battery observing the proper polarity (+/-) as indicated inside the Battery Compartment.
 - Remove a spent or discharged battery from the product. remove the battery when not using the product for an extended period.
 - Never throw batteries into a fire. Do not expose batteries to fire or other heat sources.
 - Battery contains mercury. Do not put in trash. Recycle or manage as hazardous waste.

- Dispose or recycle spent / discharged batteries in compliance with all applicable laws. For detailed information contact your local solid waste authority.

CAUTION: Failure to properly align the battery polarity can cause personal injury and/or property damage.

Replacing the battery

- Remove the Battery compartment cover from the back of the remote control by sliding the cover in the direction that its trends curve.
- Remove the spent battery and place a new DC 12V Type A23 battery into the Battery Compartment correctly observing the polarity indications (+/-) inside the Battery Compartment.
- Replace the Battery Compartment Cover.
- Clear the battery contacts and also those of the device prior to battery installation

Replacing the battery

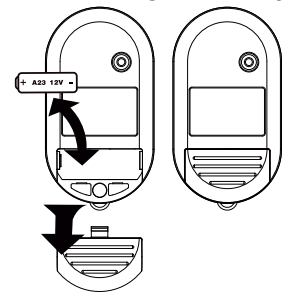

To Set Up

1. Mount the Receiver near a three-prong, grounded, standard 125-volt AC electrical outlet:
 - a. Choose a location on the wall to insert a nail or wood screw (not included) for mounting the Receiver. Please note the following when choosing the location:
 - When hung from the nail/screw, the Receiver must be close enough to the outlet for the cord to plug into the outlet.
 - The device must be mounted vertically with its outlets facing downward and not reaching ground level.
 - b. Insert the nail/screw into the wall in the chosen location. The nail or screw head must extend at least 3/16" from the wall.
 - c. Hang the keyhole of the Receiver on the nail or screw.
2. Plug the Receiver into a standard 125-volt AC electrical outlet.
3. Confirm that the electrical specifications of an item you wish to use with this product do not exceed those specified in the "Electrical Specifications" section. Plug the item into an outlet of the Receiver.
4. Remove the plastic battery tab from the Battery Compartment in the back of the Remote Control to activate the DC 12V Type A23 pre-installed battery.
5. The device must be mounted in a vertical position with the receptacle facing downward and with the receptacle at least 2 feet above the ground level not for water immersion.

To Use

Remote Control:

1. To activate the Receiver, press the ON Button of the Remote Control. The red LED of the Remote Control will illuminate momentarily and the LED of the Receiver will remain illuminated.
NOTE: The Remote Control must be within 100 feet of the Receiver.
2. To turn the Receiver off, press the OFF Button of the Remote Control. The LED on the Receiver will shut off.

Manual On/Off:

Press Manual button on the body of Receiver to turn on or off. The manual button is available if the Remote Control is absence.

Federal Communications Commission Interference Statement

This equipment has been tested and found to comply with the limits for Class B digital device, pursuant to part 15 of the FCC Rules. These limits are designed to provide reasonable protection against harmful interference in a residential installation. This equipment generates, uses and can radiate radio frequency energy and, if not installed and used in accordance with the instructions, may cause harmful interference to radio or television reception, which can be determined by turning the equipment off and on, the user is encouraged to try to correct the interference by one or more of the following measures:

- Reorient or relocate the receiving antenna.
- Increase the separation between the equipment and the receiver.
- Connect the equipment into an outlet on a circuit different from that to which the receiver is connected.
- Consult the dealer or an experienced radio/TV technician for help.

This device complies with Part 15 of the FCC Rules.

Operation is subject to the following two conditions:

- (1) This device may not cause harmful interference, and
- (2) this device must accept any interference received, including interference that may cause undesired operation.

FCC Caution: Any changes or modifications not expressly approved by the party responsible for compliance could void the user's authority to operate this equipment.

Industry Canada statement:

This Class B digital apparatus complies with Canadian ICES-003.

This device complies with Industry Canada license-exempt RSS standard(s). Operation is subject to the following two conditions: (1) this device may not cause interference, and (2) this device must accept any interference, including interference that may cause undesired operation of the device.

Le présent appareil est conforme aux CNR d'Industrie Canada applicables aux appareils radio exempts de licence. L'exploitation est autorisée aux deux conditions suivantes : (1) l'appareil ne doit pas produire de brouillage, et (2) l'utilisateur de l'appareil doit accepter tout brouillage radioélectrique subi, même si le brouillage est susceptible d'en compromettre le fonctionnement.

- ⚠ **WARNING:** This product can expose you to DINP which is known to the State of California to cause cancer and birth defects or other reproductive harm. For more information go to www.P65Warnings.ca.gov.

Made in China

SAVE THESE INSTRUCTIONS!