

**T-MATE: 5VDC BLUETOOTH INTERFACE, PROGRAMMABLE BY MEANS OF AN APP, TO CONTROL ANY TELECO PRODUCT.**

Product code

**TMATExxxAL** (power supply included)  
**TMATExxxBL**

**Characteristics**

- Available in both 868.3MHz and 916MHz frequencies.
- Easy access via Bluetooth from any compatible device.
- Up to 50 programmable device commands.
- Possibility to create scenarios.
- Weekly timer to send commands at a specific date and time.



**T-MATE App**

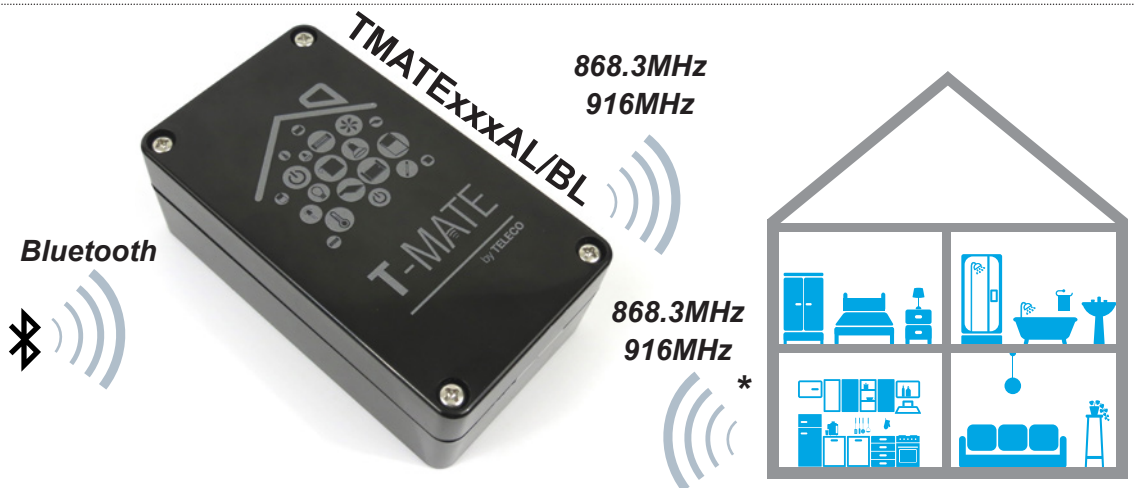

\* The Blue Series receivers are bidirectional. They can receive and execute commands and send the status back to T-Mate

**DIMENSIONS AND CONNECTIONS**

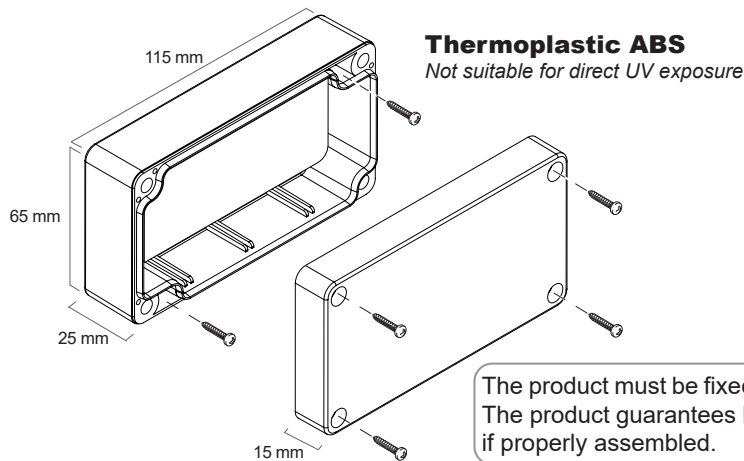

## INSTALLATION

Download the app T-Mate from App Store or Google Play. Check the compatibility with your device first. Once downloaded, it is possible to use it in DEMO mode, even without any TMATE paired.

### Pairing

Activate the Bluetooth communication on your device and power TMATExxxAL/BL ON. Launch the T-Mate app.

**Note: In the Android devices the localization function must be activated.**

Open Setup menu ► Detecting boards, tap on “+”, insert the new installation name and insert the **Code** of the T-Mate. Tap on “Connect” button to pair the device.

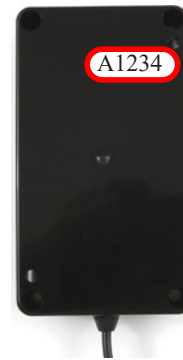
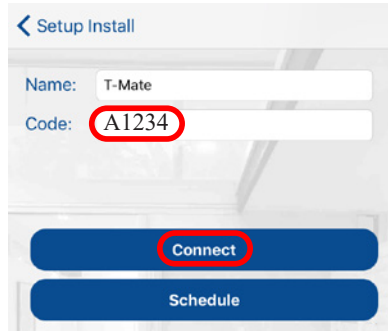
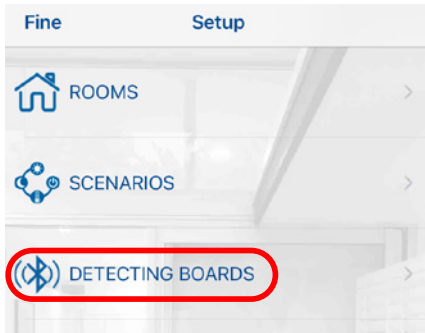

## SETUP ROOMS

Create new rooms accessing the menu “Rooms” in Setup.

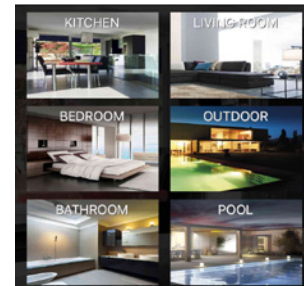
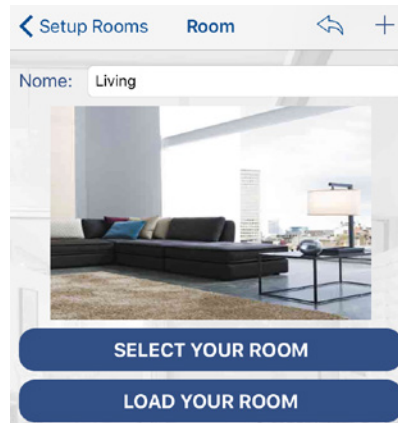
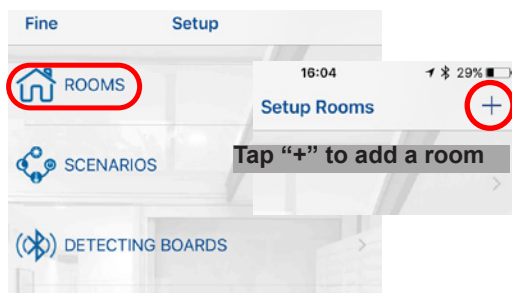

Tap on the icon to enter in the room. Set the name and assign a picture amongst the 6 provided or select a picture of your device gallery.

*Note: swipe a listed room left to delete it.*

## ADDING COMMANDS TO A ROOM

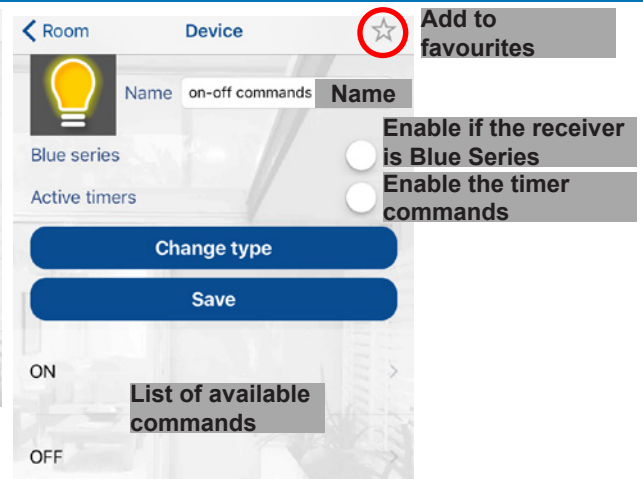
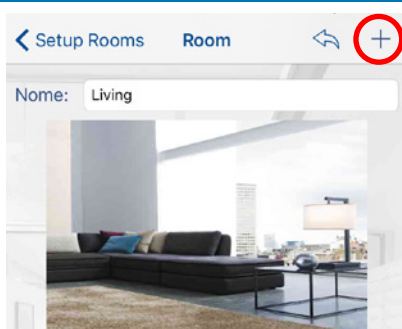

Tap “+” to add remote commands. Select the type of controlled device from the list.

*Note: swipe a listed command left to delete it.*

## TIMERS

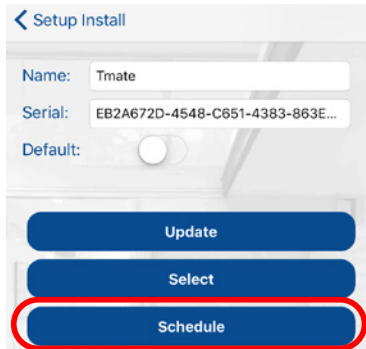
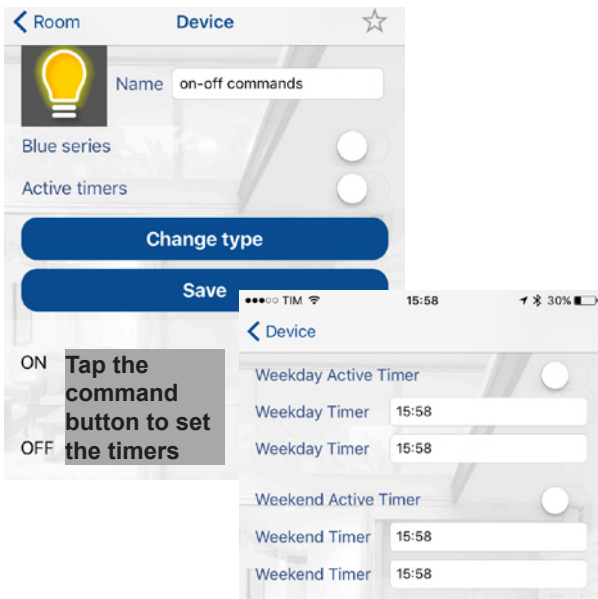

Open Setup menu ▶ Devicename ▶ Schedule to set system date/time. It's possible to set 2 groups of days: weekdays and weekend. Tap on the day names to add in the groups.

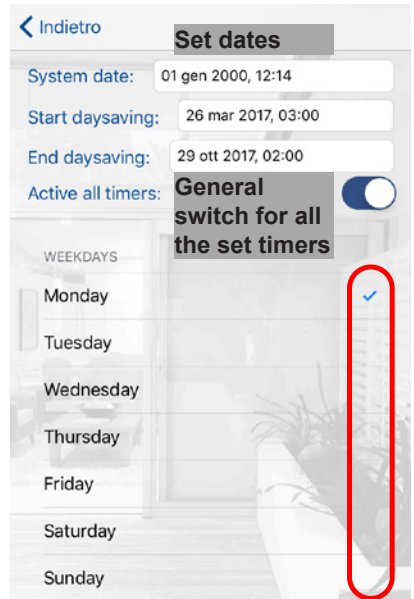

## SCENARIOS

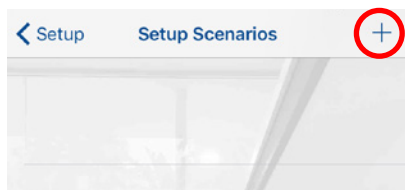

Create new scenarios accessing the menu "Scenarios" in Setup. Tap "+" to add a scenario.



Set the name and assign an icon amongst the 9 provided.

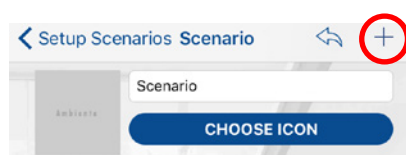

Tap "+" to add remote commands from any room. Select the type of controlled device from the list.

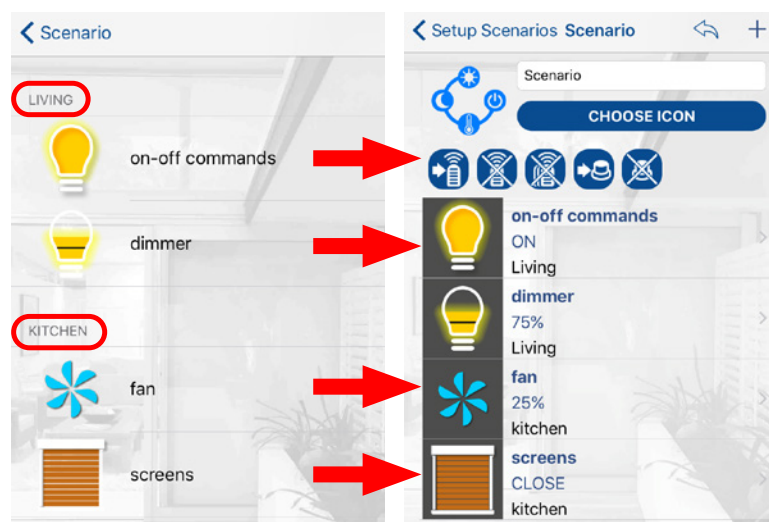

Note: swipe a listed scenario left to delete it.

## ADVANCED SCENARIO PROGRAMMING

Once the scenario has been completed, it's possible to assign it to a transmitter button or to a wired N.O. button connected to the input 4-5.

Enable/disable the scenario recall on the wired input.

Tap to delete all the associated transmitter buttons.

Tap and press the transmitter button to delete.

Tap and press the transmitter button to assign.

When transmitters or the wired input are programmed, these icons are ON

## BACKUP FUNCTION

The smartphone must have an internet connection active.

Launch the **T-Mate app**.

Open Setup menu ► Detecting boards ► Connect to “T-Mate” board ► Tap on “Backup” button.

Once the backup procedure has been completed close the **T-Mate App**.



Memorized Smartphone

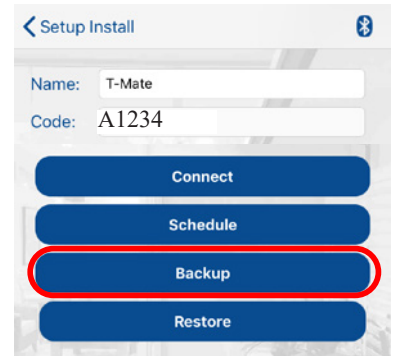
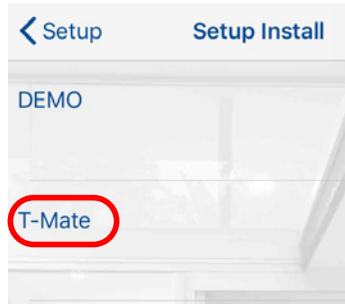
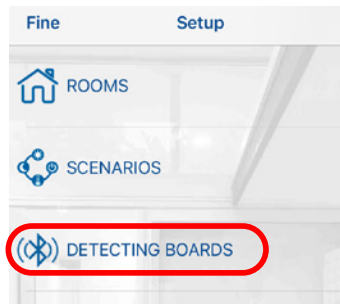

## RESTORE FUNCTION

The smartphone must have an internet connection active.

Launch the **T-Mate app**.

Open Setup menu ► Detecting boards ► Connect to “T-Mate” board ► Tap on “Restore” button.



New Smartphone

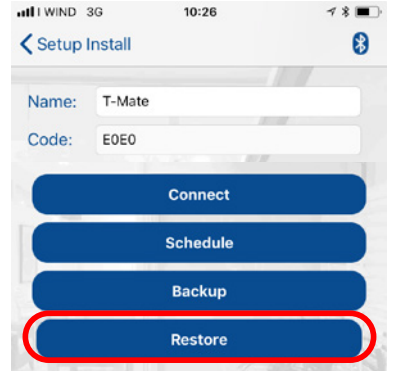
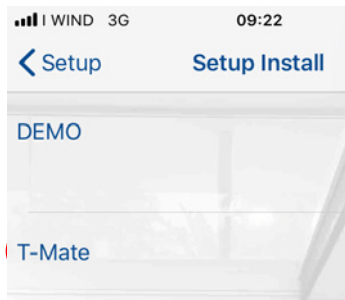
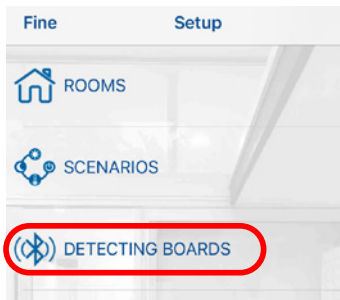



## MEMORIZATION



T-Mate transmitter

For its proper functioning the T-Mate transmitter must be memorized in the controlled receiver. Refer to instruction manual of the receiver for the procedure of memorization.

## REMOTE MEMORIZATION OF OTHER RADIO CODES FROM STANDARD TRANSMITTER

**Note:** The button P3 is located inside the standard transmitter. The added radio code will have the same functions as the code used for memorization. This procedure is compatible with any type of transmitter.

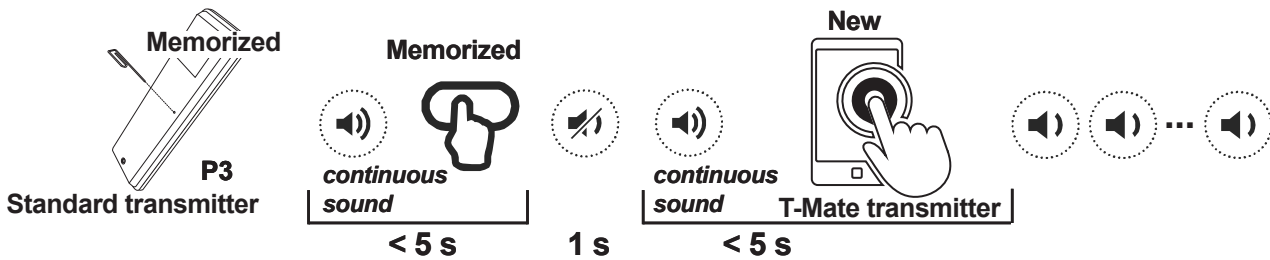

Press button **P3** of the **memorized** standard transmitter and hold. The buzzer emits a continuous sound. Press a button relative to an **already memorized** code. The buzzer stops for 1 second and then starts the continuous sound again. Press the virtual button on the Daisy transmitter relative to the **new** code to be memorized. Successful memorization is indicated by the intermittent sound of the buzzer.

## EXAMPLE OF USE

Device commands: Home page ► Rooms ► select room ► select device command

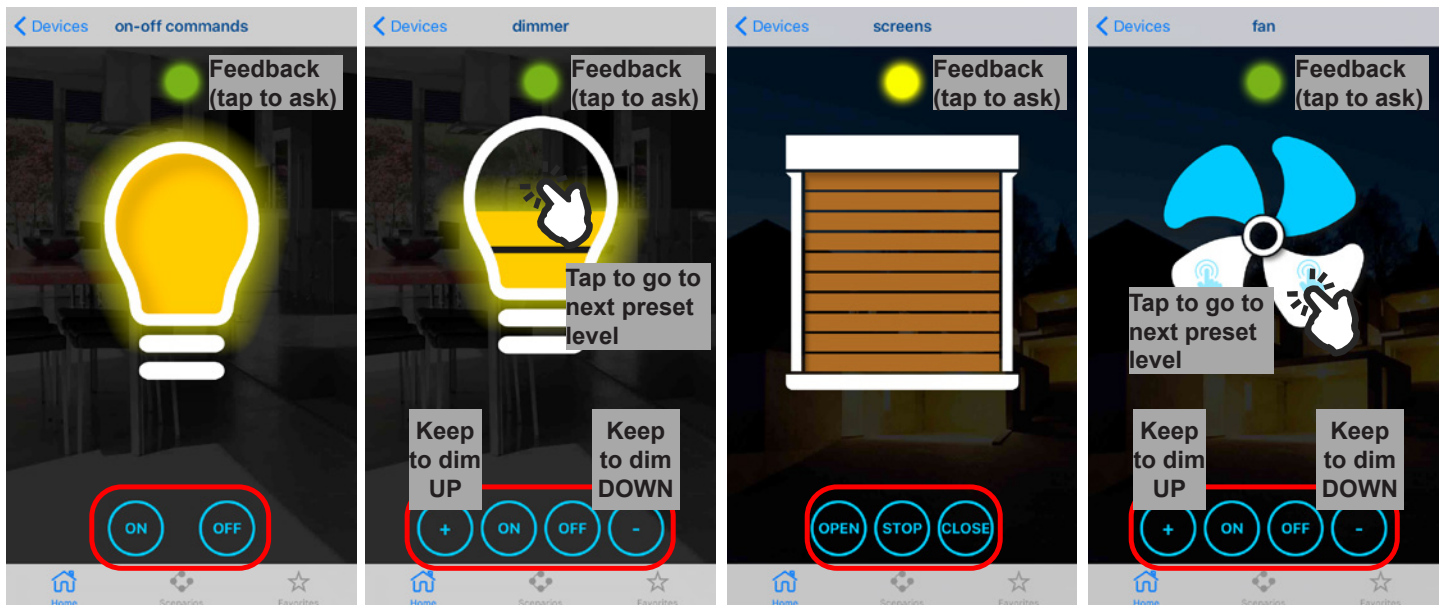

Device commands can be found in the created rooms (1) or in the "favourites" list (2). If the associated receivers belong to Blue Series (bidirectional technology), the status will be displayed aside.

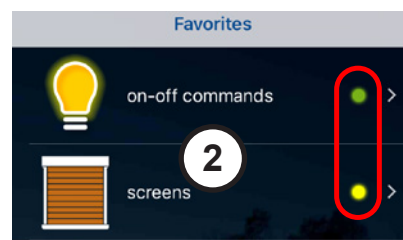
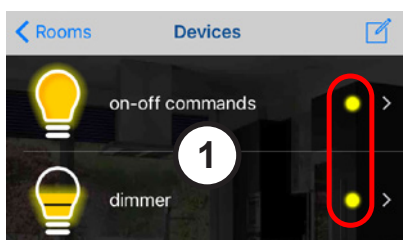

# SCENARIOS

Home page ► Scenarios ► select scenario

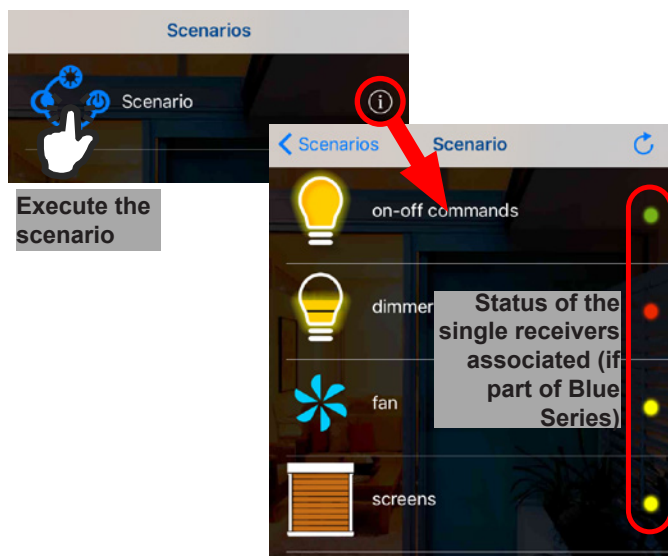

# TECHNICAL SPECIFICATION

Power supply	<b>5 Vdc</b>
Transmission frequency	<b>868.3 MHz (TMATE868xL) 916 MHz (TMATE916xL)</b>
Bluetooth module	<b>Bluetooth 4.1 (BLE) at 2.4GHz</b>
Operating temperature range	<b>-20°C ÷ +50°C</b>
Max. possible virtual transmitters	<b>50</b>
Degree of protection	<b>IP54</b>
Material of the box and its lid	<b>ABS Thermoplastic</b>



**IMPORTANT! READ CAREFULLY THESE INSTRUCTIONS BEFORE INSTALLING AND COMMISSIONING THE PRODUCT. SAVE THESE INSTRUCTIONS FOR FUTURE REFERENCE.**

## **PRODUCT INSTALLATION**

The product at issue must be installed, commissioned and maintained only by licensed and authorised people, respecting the laws concerning the electrical installations. The manufacturer is not responsible for any damage due to wrong installation or improper use.

## **SAFETY INFORMATION**

The radio signal reception of the device could be disturbed by the presence of electrical disturbances being transmitted by other appliances working on the same frequency or if the product is somehow shielded by metal parts. Do not use the device in places or where systems are sensitive to radio emissions (e.g. airports, hospitals). The operator is in no way protected against interference from other telecommunication equipment or systems (e.g. authorised radio systems working on the same frequency range). If you are having problems with its range of action, fix the device up high.

The manufacturer, Teleco Automation s.r.l, declares that the type of radio equipment is compliant with Directive 2014/53/EU. The full text of the EU compliance declaration is available at the following Internet address: [www.telecoautomation.com/ce](http://www.telecoautomation.com/ce).  
**In the view of a constant development of their products, the manufacturer reserves the right for changing technical data and features without prior notice.**

**INFORMATION TO USERS** under art. 14 of the 2012/19/EU DIRECTIVE OF THE EUROPEAN PARLIAMENT AND COUNCIL of 4 July 2012 on waste electrical and electronic equipment (WEEE). The crossed bin symbol on the equipment, or its packaging, indicates that the product must be collected separately from other waste at the end of its useful life and not with mixed urban waste. Please contact your municipality, or local authority, for all information regarding the waste sorting systems available in the area. The retailer is obliged to collect the old equipment free-of-charge when the customer buys a new equivalent equipment. This is to encourage correct recycling/disposal. Appropriate waste sorting for the subsequent recycling, treatment and disposal in an environmentally sound way of the disused equipment avoids negative effects on the environment or human health and favours the re-use or recycling of the equipment's materials.

### **According to FCC regulations, the device is designed as a mobile station.”**

“This device complies with part 15 of the FCC Rules.

Operation is subject to the following two conditions:

- (1) this device may not cause harmful interference, and
- (2) this device must accept any interference received, including interference that may cause undesired operation.

“During its normal function, keep a distance of at least 20 cm from the radiant element.”

Any changes or modifications not expressly approved by the party responsible for compliance could void the User's authority to operate the equipment”.

### **According to ISED regulations, the device is designed as a mobile station.”**

“This device complies with Industry Canada's licence-exempt RSSs. Operation is subject to the following two conditions:

- (1) This device may not cause interference; and
- (2) This device must accept any interference, including interference that may cause undesired operation of the device.”

“During its normal function, keep a distance of at least 20 cm from the radiant element.”

**TELECO AUTOMATION S.R.L.**

**ITALY**

Tel. +39.0438.388511  
info@telecoautomation.com

**TELECO AUTOMATION FRANCE**

**FRANCE**

Tel. +33.(0)472.145080  
info@telecofrance.com

**TELECO AUTOMATION GMBH**

**GERMANY**

Tel. +49.(0)8122.9563024  
info.de@telecoautomation.com

**TELECO AUTOMATION BENELUX SPRL**

**BELGIUM**

Tel. +32.67561967  
info@telecoautomation.be

**TELECO AUTOMATION OCEANIA PTY LTD**

**AUSTRALIA**

Tel. +61.(07)5502.7801  
info@telecoautomation.com.au

**TELECO AUTOMATION IBÉRICA S.L.**

**SPAIN**

Tel. +34.966.16.82.24  
jv.lopez@telecoautomation.com