



M.gear

WHA YU INDUSTRIAL CO., LTD.(HEAD OFFICE)
 DONGGUAN AEON TECH CO.,LTD.(CHINA)
 SUZHOU AEON TECH CO.,LTD.(CHINA)
 AEON TECH (SHANGHAI) CO.,LTD(CHINA)
 DONGGUAN PARNER TECH CO.,LTD.(CHINA)

SPECIFICATION FOR APPROVAL

CUSTOMER: 中磊電子股份有限公司

PART NAME: PIFA Antenna

PART NO:

REVISION:

W. Y. P/NO: C147-510649-A(SSR-210213)

REV: X1

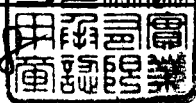
	MANUFACTURER SIGNATURE	CUSTOMER SIGNATURE
APPROVED BY :	Andrew 	
DATE :	2010.01.28 	

WHA YU GROUP

WHA YU INDUSTRIAL CO., LTD.(HEAD OFFICE)

華裕實業股份有限公司

Address: No. 326, Sec. 2, Kung Tao 5 Road, Hsin Chu City, Taiwan, R.O.C.

Tel:+886-3-5714225(REP.) Fax:+ 886-3-5713853 · + 886-3-5723600

DONGGUAN AEON TECH CO.,LTD.(CHINA)

東莞台霖電子通訊有限公司

Address:Hupan Industrial District,Tai Ling Shan Town,Dong Guan City,Guangdong,China

Tel:+86-769-85655858 Fax:+86-769-85655258

SUZHOU AEON TECH CO.,LTD(CHINA)

蘇州華廣電通有限公司

Address:Limin North Road, LiLi Town,LiLi Industrial Park,LinHu Economic Zone

Wujiang City,Jiangsu Province,China

Tel:+86-512-63627980 Fax:+86-512-63627981

AEON TECH (SHANGHAI) CO.,LTD(CHINA)

普翔電子貿易(上海)有限公司

Address:Flat 501,5F,Build 27, NO.68,Guiqing Road, Huhui District, Shanghai,China

Tel:+86-21-64959151 Fax:+86-21-64959059

DONGGUAN PARNER TECH CO.,LTD.(CHINA)

東莞倍能電子有限公司

Address:Hupan Industrial District, Shida Road, Tai Ling Shan Town,

Dong Guan City, Guangdong, China

Tel:+86-769-81662366 Fax:+86-769-81602681

Contents

<i>Item</i>	<i>Description</i>	<i>Page</i>
1.	規格表 1
2.	成品圖 2
3.	測試報告3~8

PIFA Antenna

Specification

1. Electrical Properties (With housing)

- 1.1 Frequency Range.....2.4GHz ~ 2.5GHz / 4.9GHz ~ 5.825GHz
- 1.2 Impedance 50Ω Nominal
- 1.3 VSWR 1.92:1 Max.
- 1.4 Return Loss..... -10 dB Max.
- 1.5 Radiation Omni-directional
- 1.6 Gain(peak).....3.3dBi (excluding cable loss)@2.4GHz ~ 2.5GHz
5.7dBi (excluding cable loss)@4.9GHz ~ 5.825GHz
- 1.7 Cable Loss..... 0.59dB Max.@2.4GHz ~ 2.5GHz
0.89dB Max.@4.9GHz ~ 5.825GHz
- 1.8 Polarization..... Linear ; Vertical
- 1.9 Admitted Power..... 1W
- 1.10 Cable..... φ1.13 Coaxial Cable ; Gray
- 1.11 Connector..... MHF

2. Physical Properties :

- 2.1 Operating Temp.-10°C ~ +60°C
- 2.2 Storage Temp.-10°C ~ +70°C

CG-

REV	DATE	DESCRIPTION
X1	1/25-2010	New Issue

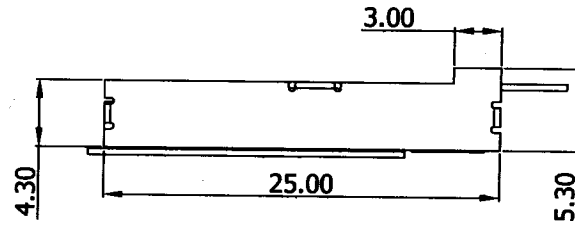
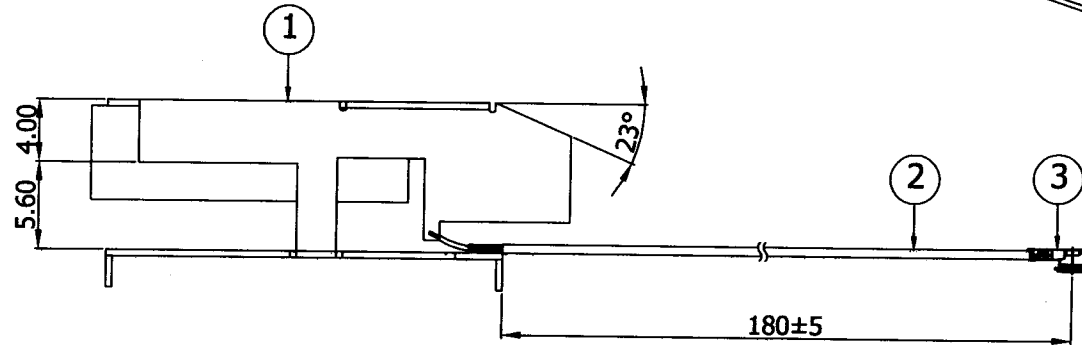
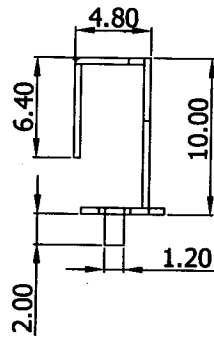
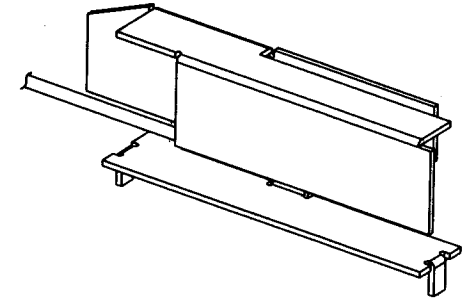
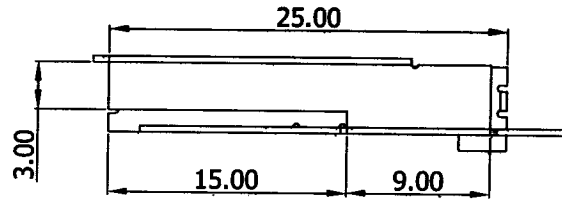

釘書針

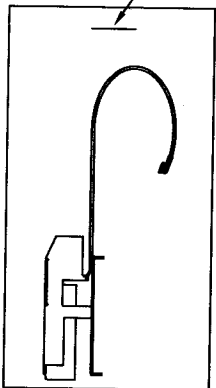

Packing : 1 pcs/bag
(每10袋用釘書機訂起來)

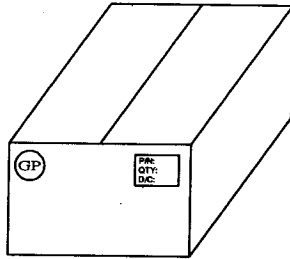

GP標籤貼於外箱兩邊側麥左上角共2PCS
標示Label貼於外箱兩邊側麥共2PCS

NO	DESCRIPTION	QTY	REMARK
3	Connector	MHF Connector	1
2	Cable	φ1.13 Coaxial Cable ; Gray	1
1	PIFA	SUS430 Nickel-Plating	1

CUSTOMER'S SIGNATURE	XX ±5	APPROVED	CUSTOMER: 中磊	
	X ±3.0	Andrew		PART NO :
	.X ±1.0	CHECKED		PARTNAME: PIFA Antenna
	.XX ±0.5	陳信仁		W.Y P/NO : C147-510649-A
	.XXX ±0.1	DRAWING		REV UNIT FILE : SSR-210213
			X1 m/m SHEET : 1/1	

M.gear Wha Yu Group

THIS DRAWING, AND ITS INHERANT DESIGN CONCEPTS, ARE THE PROPERTY OF WHA YU AND AS SUCH MAY NOT BE COPIED, REPRODUCED, OR GIVEN TO THIRD PARTIES WITHOUT THE WRITTEN CONSENT OF WHA YU.

1 S-parameter test results

1.1 S11 test results

1.1.1 M.gear

1.1.1.1 Ant2

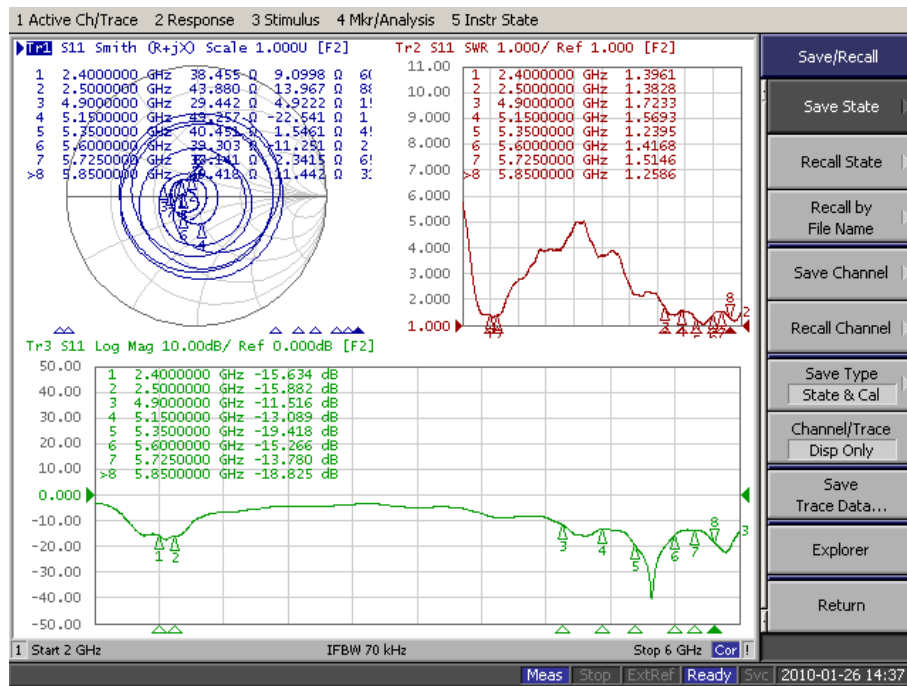

2 Gain & Patterns test results

2.1 Measurement setting

M.gear

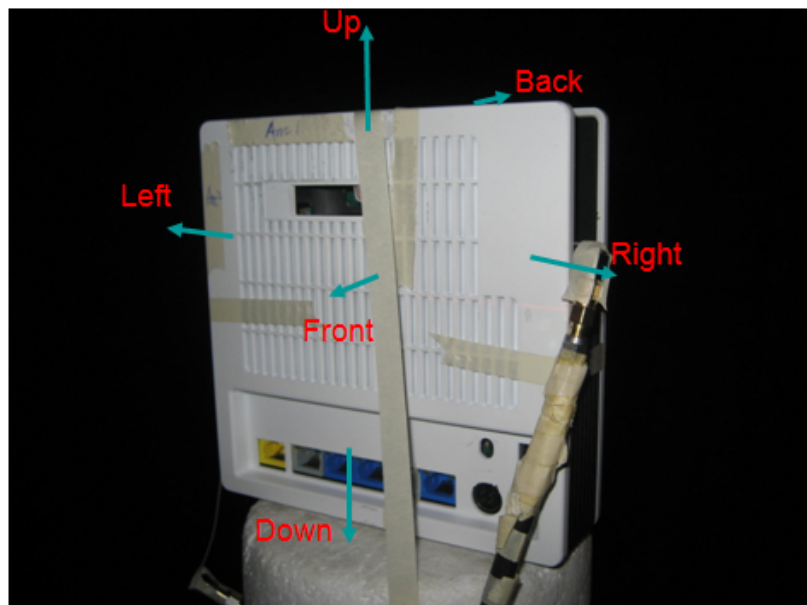
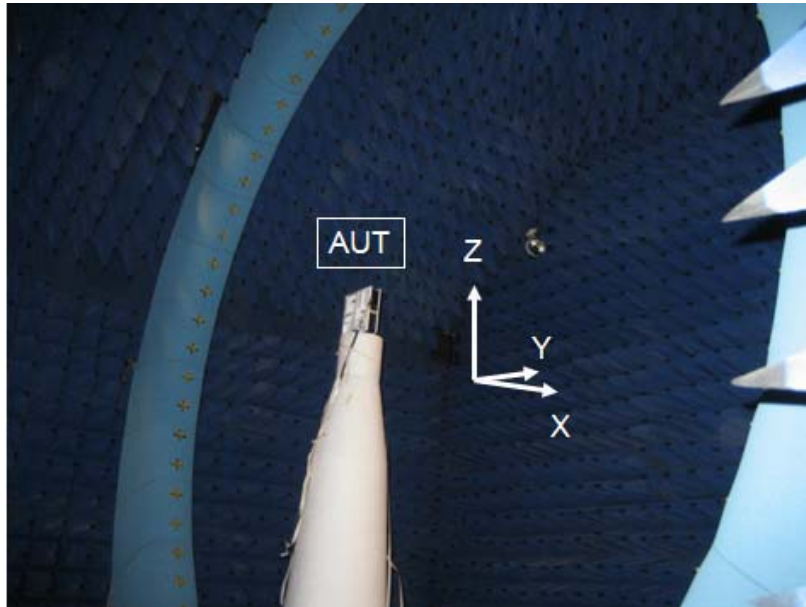

	XY	YZ	XZ
0°	Right	Up	Up
90°	Back	Back	Right
180°	Left	Down	Down
270°	Front	Front	Left

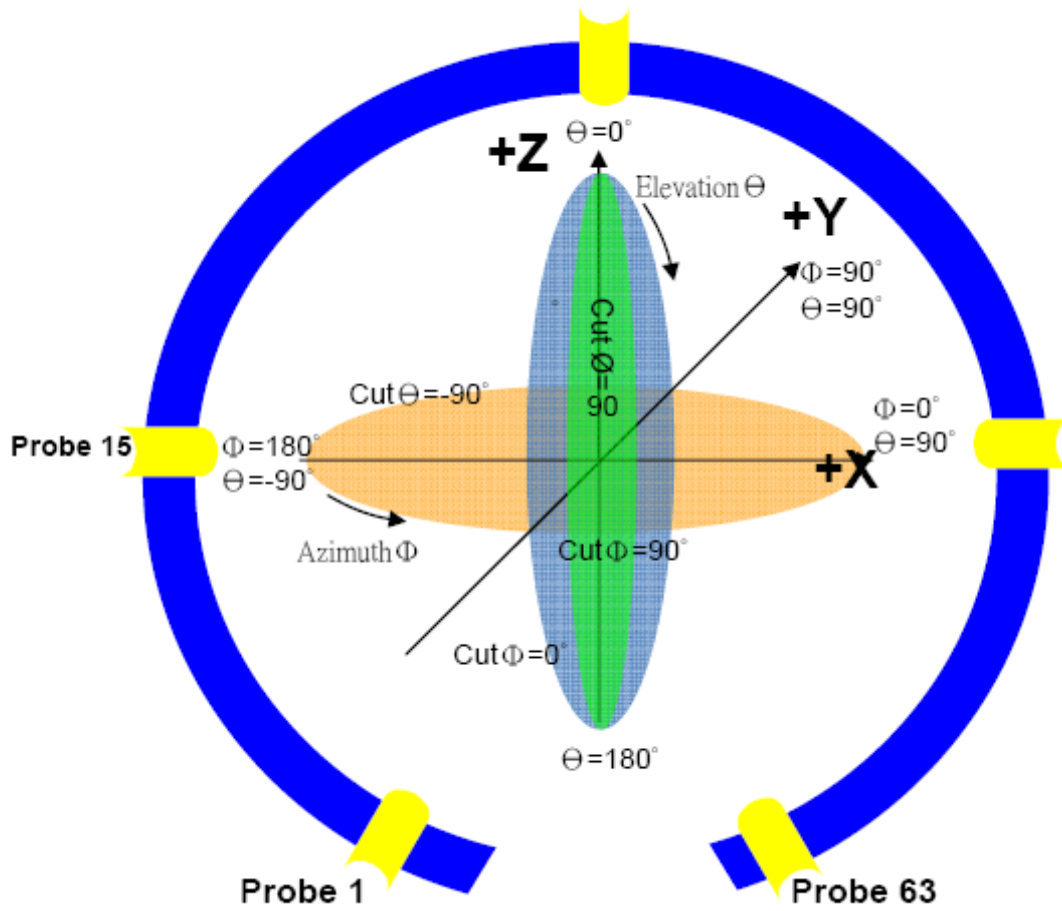

	θ	φ
Total angle	175°	360°
How many angle scan one point	5°	5°
Total scan point	36	73

2.2 2D patterns

2.2.1 M.gear

3.2.1.3 Ant2

2.4~2.5GHz/4.9~5.825GHz

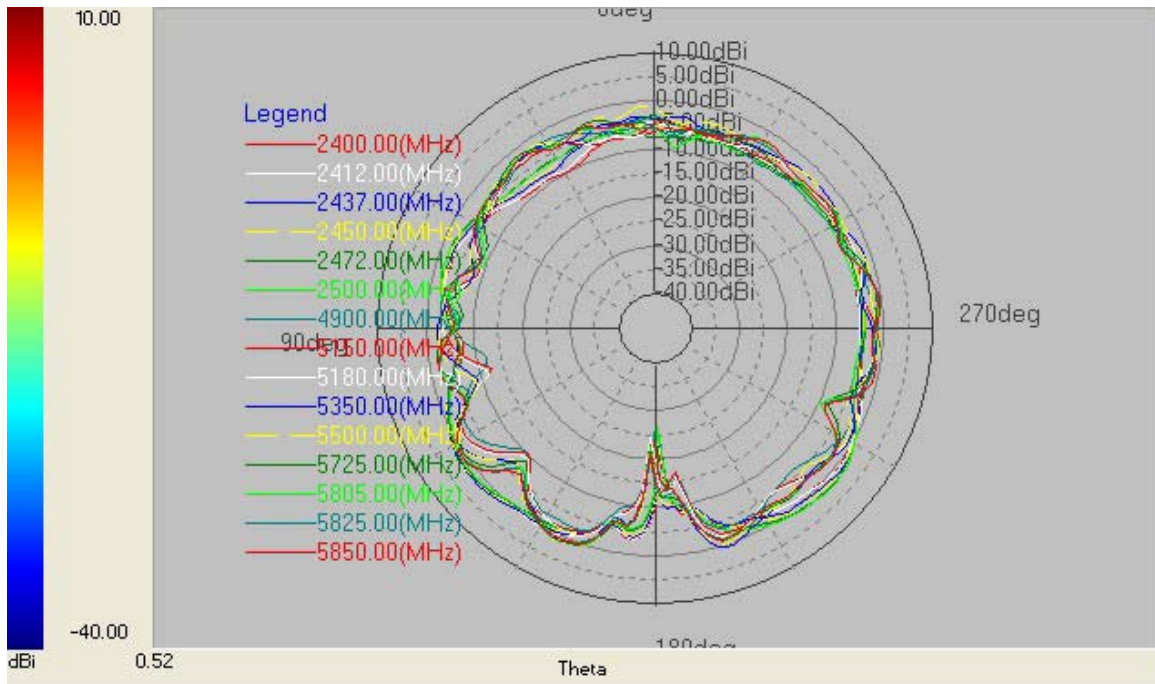

X-Z Plane (E-total)

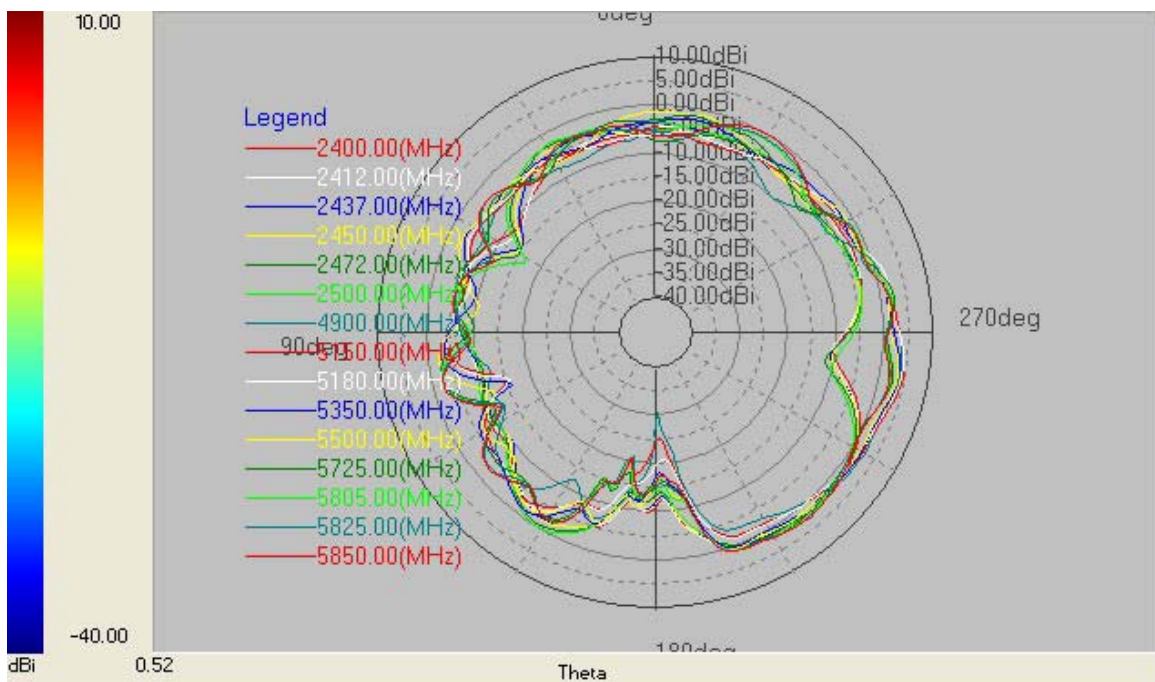

Y-Z Plane (E-total)

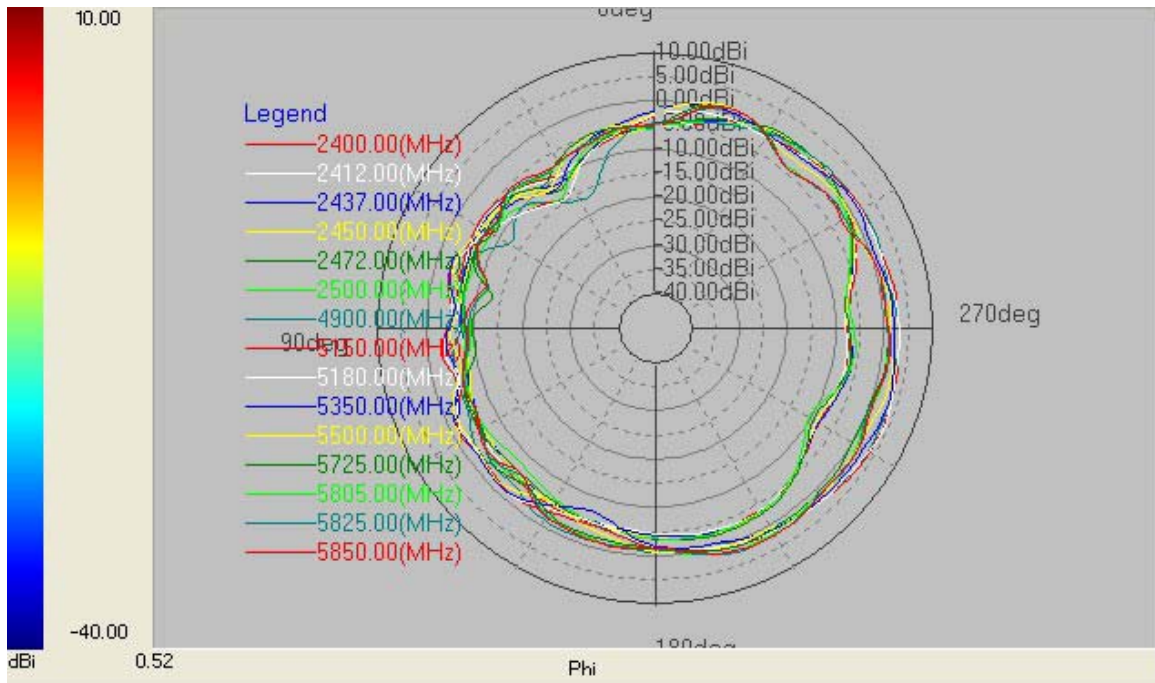

X-Y Plane (E-total)

4 Summary

4.1 Return Loss

	Ant2(dB)
2.4GHz	-15.6
2.5GHz	-15.9
4.9GHz	-11.5
5.15GHz	-13.1
5.35GHz	-19.4
5.6GHz	-15.3
5.75GHz	-13.8
5.85GHz	-18.8

4.3 3D total Peak Gain & Efficiency

Frequency	Ant2	
	Peak Gain (dBi)	Efficiency (%)
2400MHz	3.3	50%
2412MHz	3.3	50%
2437MHz	3.1	50%
2450MHz	3.1	51%
2472MHz	2.9	52%
2500MHz	2.7	50%
4900MHz	5.0	53%
5150MHz	5.7	58%
5180MHz	5.6	58%
5350MHz	5.1	63%
5500MHz	4.9	61%
5725MHz	4.3	56%
5805MHz	4.4	57%
5825MHz	4.1	57%
5850MHz	4.2	59%