

No	ITEM NUMBER	THE NAME OF AN ARTICLE	MODEL/SPEC.	QUANTITY
1	4977505-3	CASE ASSEMBLY	V720-H01	1
2	3363959-1	CASE PLATE	V720-H01	1
3	6432909-4	BUSH CORD	V700-H01	1
A 4	2003762-2	BUSH LOCK	SCL-6B	1
5	3912235-3	CORD ASSEMBLY	V700-H01	1
6	4977506-1	COIL ASSEMBLY	V720-H01	1
7	3976748-6	PCB ASSEMBLY	V720-H01	1
8	3004874-6	TAPPING SCREW,TRUX TRUSS	M4, 2X13	6
9	1050058-8	TAPPING SCREW, PAN	M3X8	4
10	0076995-3	COATING STUFF	TH-1, TH-5	5g
11	6479156-1	LABEL,CABLE	V720-H01	1
12	2048903-5	FERRITE CORE	ZCAT2035-0930A-BK	1
B 13	6473776-1	LABLE,CAUTION	V700-H01	1
14	3004875-4	SCREW,TRUX PAN	M3X8	1
15	2083709-2	TR102	2SC1972	1
16	1060979-2	IC103, IC110	μPC78N05H	2
17	6479115-4	HEAT SINK (1)	V720-H01	1
18	6479163-4	HEAT SINK (2)	V720-H01	1
19	0052502-7	SCREW,SET DOUBLE PAN	M3X10	3
20	0000168-0	NUTS,HEXANGULAR	M3 CLASS1	3

C
D
E
F
G
H

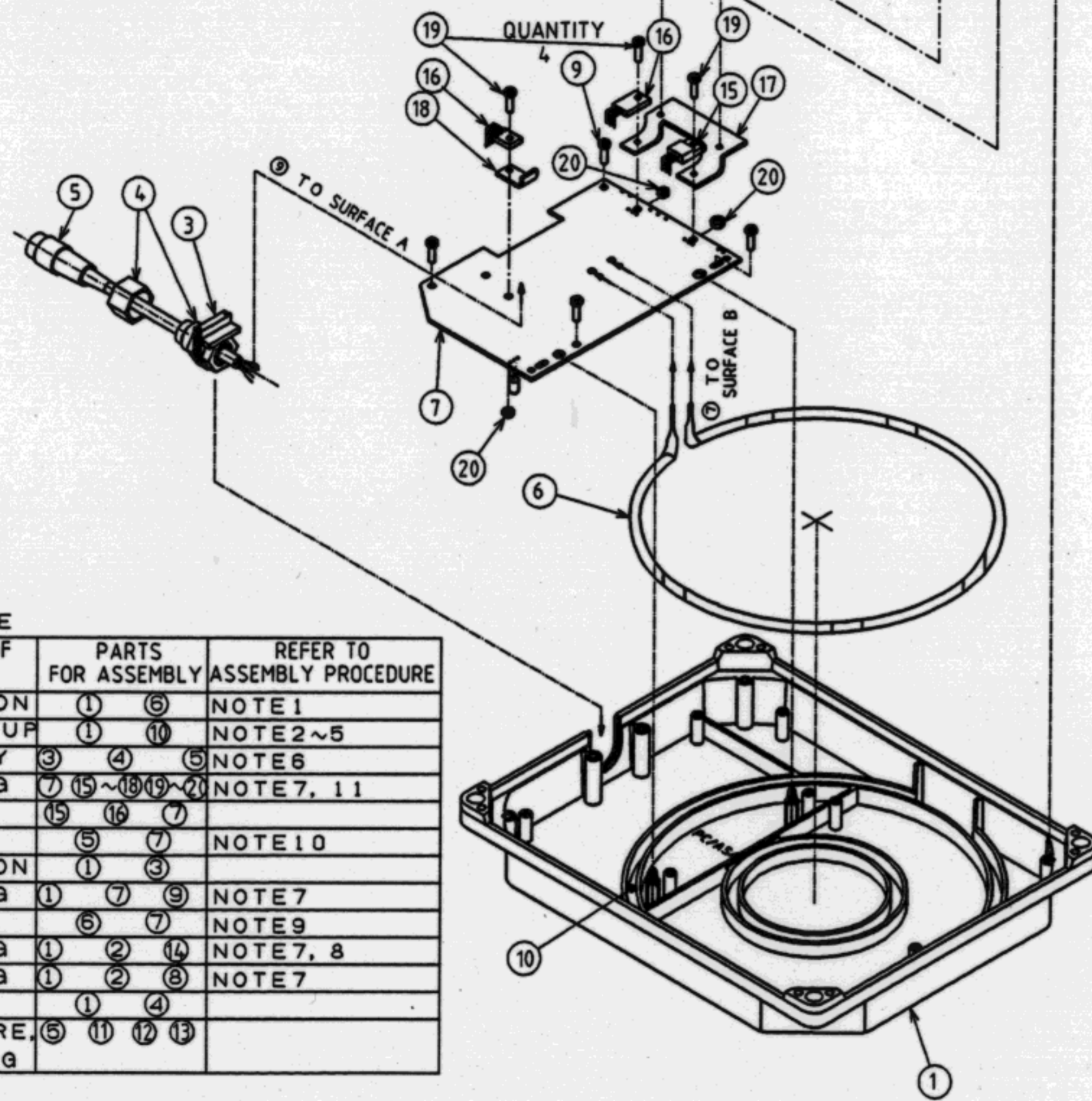

PROCESS	CONTENTS OF THE WORKS	PARTS FOR ASSEMBLY	REFER TO ASSEMBLY PROCEDURE
1	INSERTION	(1) (6)	NOTE 1
2	FILLING UP	(1) (10)	NOTE 2~5
3	ASSEMBLY	(3) (4) (5)	NOTE 6
4	SCREWING	(7) (15)~(19) (20)	NOTE 7, 11
5	SOLDER	(15) (16) (7)	
6	SOLDER	(5) (7)	NOTE 10
7	INSERTION	(1) (3)	
8	SCREWING	(1) (7) (9)	NOTE 7
9	SOLDER	(6) (7)	NOTE 9
10	SCREWING	(1) (2) (14)	NOTE 7, 8
11	SCREWING	(1) (2) (8)	NOTE 7
G 12	FASTEN	(1) (4)	
H 13	AFFIXTURE MOUNTING	(5) (11) (12) (13)	

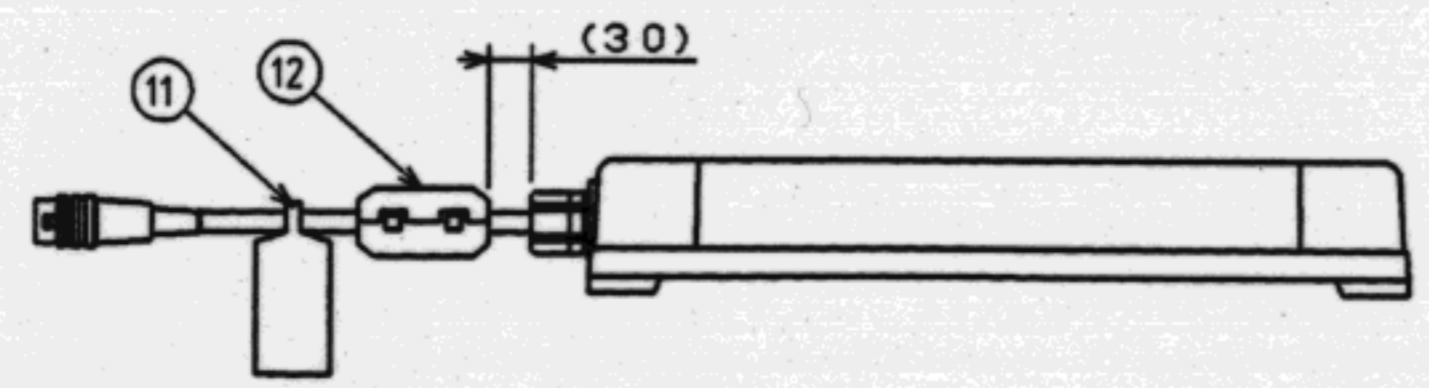

ASSEMBLY PROCEDURE

- NOTE
1. INSERT (6) TO LOCATE THE TERMINALS OF (6) IN THE "PC/ASA" (α) INDICATED ON THE CASE.
 2. FILL THE AREA 'A' WITH (10).
 3. (10) ARE THE MIXTURE STIRRING 'TH-1' AND 'TH-5' (HANNAKAGAKU) IN A RATIO OF 40 TO 100.
 4. FILL UP WITH (10) TO COVER THE (6) IN ALL AREA.
 5. HARDENING CONDITION 45°C, 3HOURS.
-
6. TAKE (4) A PART AND REASSEMBLE TO FOLLOW THE DRAWINGS.
-
7. TURQUE FOR EACH SCREWS: 5 kgf·m
 8. ADJUSTMENT FOLLOWS THE DOC. No. (1789530-8)
 9. TO BE SOLDERED AT THE SURFACE B.
 10. TO BE SOLDERED AT THE SURFACE A.
 11. TO APPLY THE SCREW LOCK (THREEBOND 1401B 0641465-0) (19) (20) AFTER SCREWED.

SYM	DATE	E/C CONTENTS	E/C NO.	SIGN	MATERIAL FINISH	TOLERANCES UNLESS SPECIFIED	DESIGNED	CHECKED	APPROVED	SCALE	3RD ANGLE	SHEET	ASSEMBLY DIAGRAMS
							99/11/18	00.4	6 304-5	1/2		1/2	DRWG NO. 1262478-0 A
													DESIGNED FOR V720-H01

PACKING PAD (1)
0674166-0

INSTRUCTION
1607764-4

BAG
0097826-9
BUSH, SCREW (4)
6432908-6

PACKING CASE
0674165-1

PACKING PAD (2)
0674167-8

PACKING LABEL, CE MARKING
5472016-0

PACKING LABEL
3478860-4

NOTE 1. INDICATION OF THE PACKING LABEL.
TO BE PRINTED THE COLUMN "A TO D" AS FOLLOWS.

TYPE	A
VOLTS.	B
SER NO.	C
QTY.	1

A: MODEL
B: "ID R/W ANTENNA"
C: CORD LENGTH
D: SERIAL No.

2. STAMP THE SERIAL No. AS FOLLOWS.
INDICATION OF THE SERIAL No. ARE TO BE AS
FOLLOWING EXAMPLE.

(EXAMPLE)

0 0 1 0 0 1

CONSECUTIVE NUMBER (001~999)
RETURN TO "001" EVERY MONTH

MONTH (JAN.) OCT. : X NOV. : Y DEC. : Z

THE LOWER TWO DIGITS IN A, D.

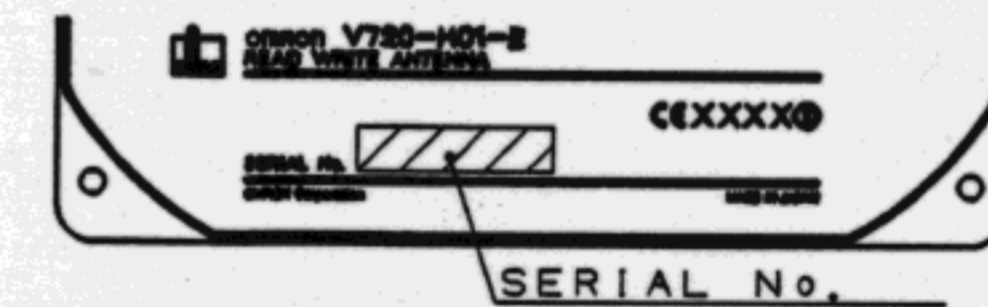

3. INDICATION OF THE PACKING LABEL, CE MARKING.

CEXXXXX

4. DRAWINGS OF LEFT SIDE SHOWS PACKING PROCEDURES.

					MATERIAL				SCALE
					FINISH				3RD ANGLE
					TOLERANCES UNLESS SPECIFIED	DESIGNED 99/11/18 (+7)021RF 2277	CHECKED 0024-6	APPROVED 0024-6	SHEET 2/2
SYM	DATE	E/C CONTENTS	E/C NO.	SIGN					ASSEMBLY DIAGRAMS DRWG NO. 1262478-0 A DESIGNED FOR V720-H01-E