

ENGLISH



# R/C Auto Transforming Robot



EI-4694  
Instruction Manual  
For ages 3+

**WARNING:**  
CHOKING HAZARD - Small parts.  
Not for Children under 3 years.

### Safety Precautions:

- Parents, this toy is recommended for children. To ensure that your child's play time is both safe and fun, please review the operating instructions with your children.
- Do not pick up the toy when it is moving.
- Keep hands, hair and loose clothing away from any moving parts when the toy is turned ON.
- Remove battery from the toy when not in use.

**Warning:** Changes or modifications to this unit not expressly approved by the party responsible for compliance could void the user's authority to operate the equipment.

### FCC Statements:

This device complies with part 15 of the FCC rules. Operation is subject to the following two conditions:

- 1) This device may not cause harmful interference, and
- 2) This device must accept any interference received, including interference that may cause undesired operation.

**NOTE:** This equipment has been tested and found to comply with the limits for a Class B digital device, pursuant to Part 15 of the FCC Rules. These limits are designed to provide reasonable protection against harmful interference in a residential installation. This equipment generates, uses and can radiate radio frequency energy and, if not installed and used in accordance with the instructions, may cause harmful interference to radio communications.

However, there is no guarantee that interference will not occur in a particular installation. If this equipment does cause harmful interference to radio or television reception, which can be determined by turning the equipment off and on, the user is encouraged to try to correct the interference by one or more of the following measures:

- Reorient or relocate the receiving antenna.
- Increase the separation between the equipment and receiver.
- Connect the equipment into an outlet on a circuit different from that to which the receiver is connected.
- Consult the dealer or an experienced radio/TV technician for help.

### Cautions:

- Non-rechargeable batteries are not to be recharged.
- Rechargeable batteries are to be removed from the toy before being charged.
- Rechargeable battery are only to be charged by an adult.
- Different types of batteries or new and used batteries are not to be mixed.
- Only batteries of the same or equivalent type as recommended are to be used.
- Batteries are to be inserted with correct polarity.
- Exhausted batteries are to be removed from the toy.
- The supply terminals are not to be short-circuited.
- Do not mix old and new batteries.
- Do not mix alkaline, standard (carbon-zinc) or rechargeable (nickel-cadmium) batteries.



**WEEE**  
When this appliance is out of use, please remove all batteries and dispose of them separately. Bring electrical appliances to the local collecting points for waste electrical and electronic equipment. Other components can be disposed of in domestic refuse.

### Note:

- Parental guidance is recommended when installing or replacing batteries.
- Users should keep and retain this information for future reference.
- Users should follow instruction manual before using the product.
- Electrostatic discharge, may malfunction and require user to reset by turning off and back on.

### Care and Maintenance:

- Always remove batteries from the toy when it is not being used for a long period of time.
- Wipe the toy gently with a clean damp cloth.
- Keep the toy away from direct sunlight and/or direct heat.
- Do not submerge the toy into water that can damage the electronic assemblies.

### Battery requirement for Transmitter:

- Power Supply : ---
- Battery ratings : DC 9 V ; 0.27 W
- Batteries : 1 x 9 V 6LR61 (not included)

### Battery requirement for Vehicle:

- Power Supply : ---
- Battery ratings : DC 4.5 V ; 2.5 W
- Batteries : 3 x 1.5 V \*AAA\*/LR03/AM4 (not included)

### Delivery contents



Transmitter



Transforming Robot



Instruction manual

ENGLISH

### Part identification

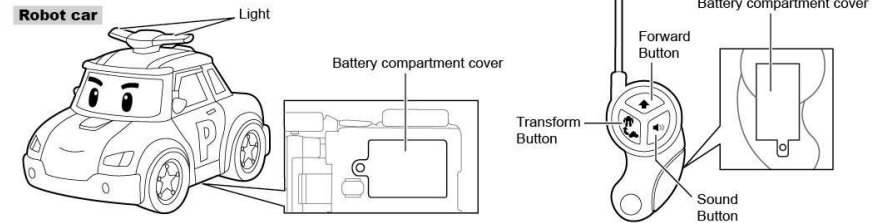

### Battery Installation: Transmitter

Make sure the power switch is on "OFF" position.

1. Open the battery compartment by loosening the screw (fig. 1)
2. Insert 1 x 9V batteries in the battery compartment with correct polarity. (fig. 2)
3. Close the battery compartment cover. (fig. 3)

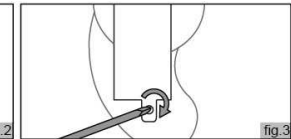
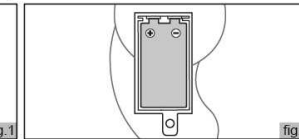
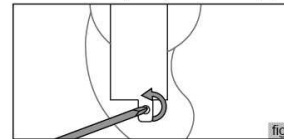

### Battery Installation: Transforming Robot

Make sure the power switch is on "OFF" position.

1. Open the battery compartment by loosening the screw (fig. 4)
2. Insert 3 x AAA batteries in the battery compartment with correct polarity. (fig. 5)
3. Close the battery compartment cover. (fig. 6)

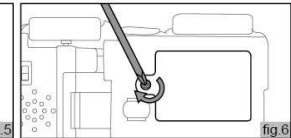
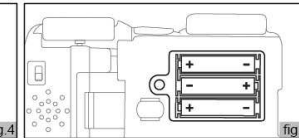
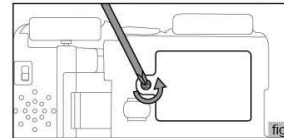

### How to play

1. Set vehicle ON/OFF switch to "ON". Drive the vehicle forward pressing the "Forward button". (fig. 7)
2. Transform a vehicle to a robot for a few second and then transform back to vehicle with turning by pressing the "Transform button". (fig. 8)
3. To activate the siren sound and flashing light effects by pressing the "Sound button". (fig. 9)

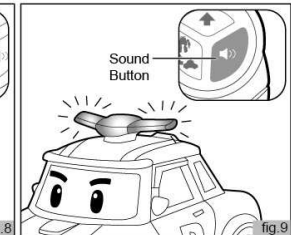
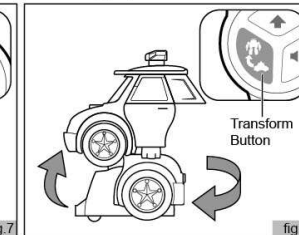
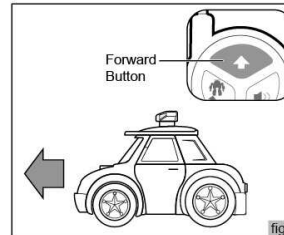

### Driving Tips:

1. Operate only on flat, smooth (but not slippery), dry surfaces and low pile carpet, as hair, carpet or dirt can affect the operation of the vehicle.
2. Don't drive your vehicle in sand or through water or snow, if your vehicle get wet, wipe with a towel and allow to dry completely.

**Hints:** This vehicle will automatically enter sleep mode after being inactive for 10 minutes. To activate it, switch it off and then on again.