

3. BLUETOOTH MODE & APP MODE

You also can go to App Store or Google play to download the Apps to play the game.



Note: Please also go to App help for more Bluetooth Mode instructions.

Work with your MP3 or any other music sources

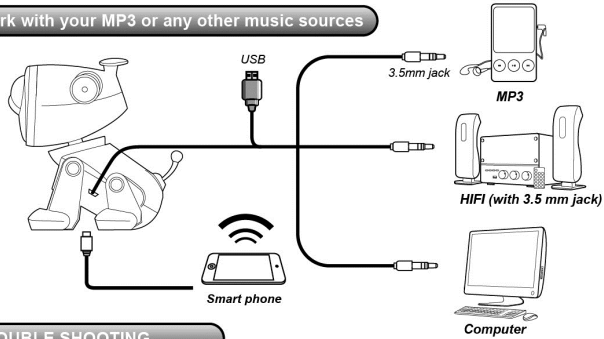

TROUBLE SHOOTING

Symptom	Cause	Correction
The Pet moves slowly, erratically or does not move.	- Batteries are exhausted. - The Pet has fallen into power save mode. - Action is disabled. - Function is adnomal.	- Recharge the battery with the USB charging cable. - Press the function button once. - Press & hold function button for 1 sec. to enable the actions. - Switch off the pet and turn on again.
Can not play music after connected to other music source like MP3, HiFi or Computer.	- Micro USB Connector is not connected correctly. - The Pet has fallen into power save mode. - The music source is not switched on.	- Check Micro USB cable connection. - Check the volume of music source - Check 3.5 mm jack. - Switched on the source music.
Bluetooth connection unsuccessful.	- Other bluetooth device connected.	- Disconnect other bluetooth device and try again.

Apple, the Apple logo, iPhone, iPad and iPod touch are trademarks of Apple Inc., registered in the U.S. and other countries. App Store is a service mark of Apple Inc.

The Bluetooth® word mark and logos are registered trademarks owned by Bluetooth SIG, Inc. and any use of such marks by Silverlit is under license. Other trademarks and trade names are of their respective owners.

Become our fan on facebook
facebook.com/SilverlitToys
Visit us at
www.Silverlit.com

ENGLISH

PARTS IDENTIFICATION

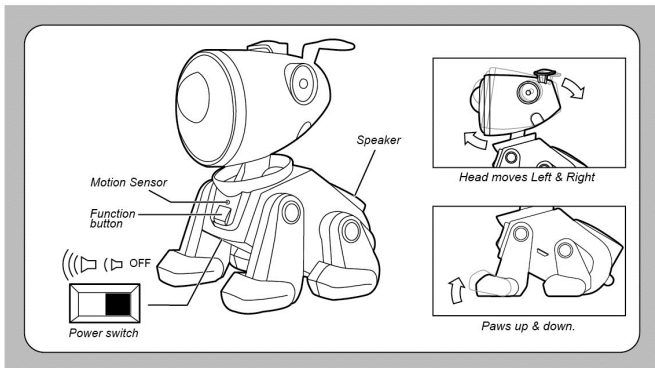

CHARGING THE PET

1. Connect the USB recharge cable to a USB socket. (pic.1)
2. Insert the micro USB into the charging socket on the pet then the charging indicator will light up. (pic.2)
3. Unplug the micro USB after the charging indicator turns off, charging is completed. (pic.3)

Note: It is available to operate during charging.

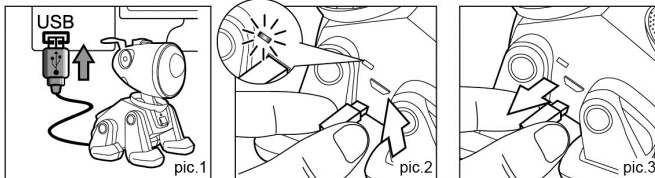

GAME PLAY

1. **STAND ALONE MODE**
- Pet responds to your interaction and different sound effects and melodies.
2. **AUX MODE**
- Play as speaker. You can connect it to your MP3, HiFi or any other music sources..
3. **APP MODE and BLUETOOTH MODE**
- Connect the Bluetooth and download the free App. You can play with all interactive functions.

Note: Please also go to App help for more App Mode instructions.

Tips!
You can have a high or low level volume to select the sound output level. (Only In Stand Alone Mode)

2

ENGLISH

i-Fido

Interactive Pet for iPhone and Android!

Contents:

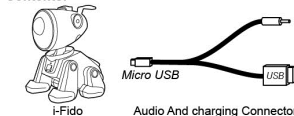

Instruction Manual

EI-4731

Instruction Manual

For ages 5+ / Ab 5 Jahre / A partir de 5 ans
Leeftijd vanaf 5 jaar / A partir de 5 años / Dai 5 anni in su

WARNING:
CHOKING HAZARD - Small Parts.
Not for children under 3 years.

Key Features:

- Amplifier speaker system
- Dance to the beat of the music!
- Lights up with millions of color patterns
- Play with MP3 or any other music source

Instruction Manual

Waste Electrical and Electronic Equipment (WEEE)
When this appliance is out of use, please remove all batteries and dispose of them separately. Bring electrical appliances to the local collecting points for waste electrical and electronic equipment. Other components can be disposed of in domestic refuse.

The normal function of the product may be disturbed by Strong Electro Magnetic Interference. If so, simply reset the product to resume normal operation by following the instruction manual.
In case the function could not resume, please use the product in other location.

FCC Statements

This device complies with part 15 of the FCC rules. Operation is subject to the following two conditions:
1) This device may not cause harmful interference, and
2) This device must accept any interference received, including interference that may cause undesired operation.
NOTE: This equipment has been tested and found to comply with the limits for a Class B digital device, pursuant to Part 15 of the FCC Rules. These limits are designed to provide reasonable protection against harmful interference in a residential installation. However, there is no guarantee that interference will not occur in a particular installation. If this equipment does cause harmful interference to radio or television reception, which can be determined by turning the equipment off and on, the user is encouraged:
- Reorient or relocate the receiving antenna.
- Increase the separation between the equipment and receiver.
- Connect the equipment into an outlet on a circuit different from that to which the receiver is connected.
- Consult the dealer or an experienced radio/TV technician for help.

Safety Precautions:

Warning: Changes or modifications to this unit not expressly approved by the party responsible for compliance could void the user's authority to operate the equipment.

This receiver is equipped with a LiPo rechargeable battery, please pay attention to the following cautions for safety use:

- Do not dispose the battery in fire or heat.
- Do not use or leave the battery near a heat source such as fire or heater.
- Do not strike or throw the battery against hard surface.
- Do not immerse the battery in water, and keep the battery in a cool dry environment.
- When recharging, only use the battery charger specifically for that purpose.
- Do not over-discharge the battery.
- Do not connect the battery to an electrical outlet.
- Do not directly solder the battery and pierce the battery with a nail or other sharp object.
- Do not disassemble or alter the battery.
- Charge the battery every 6 months.
- Do not transport or store the battery together with metal objects such as necklaces, hairpins etc.
- As for a used battery, please recycle after covering the battery terminals with insulation tape or inserting it to an individual poly-bag.

Note:

- Users should keep and retain this information for future reference.
- Users should keep strict accordance with the instruction manual while operation the product.
- Under the environment with electrostatic discharge, the sample may malfunction and require user to reset the sample.

Care and Maintenance:

- Wipe the toy gently with a clean damp cloth.
- Keep the toy away from direct sunlight and/or direct heat.
- Do not submerge the toy into water that can damage the electronic assemblies.

Battery requirement:

- Power supply : DC 3.7 V, 2 W
- Batteries : 1 x 3.7 V Li-Po Rechargeable Battery Pack (included)
- Capacity : 500 mAh

Silverlit Silverlit SAS, Espace Green Parc, Route de Villepelec, 91280 Saint Pierre du Perray / France.
©2013 Silverlit. All rights reserved.

ENGLISH

1. STAND ALONE MODE (No smartphone or any kind of Audio Music sources are required)

- After the ON/OFF switch is switched on, a sound effect will be heard. It indicated you have entered into the INTERACTIVE MODE. Everytime when you press the function button (pic.4) or your hand interacted with the motion sensor (pic.5), special sound effect or melody will be heard and the built-in actions will be activated at the same time. For the Pet, it will move its head forward and backward and it's front paws will lift up and down following the rhythm of the sound effect and melodies.

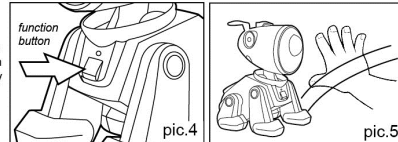

Tips! Motion sensor will be affected by different environment and lighting. Move the Pet to another position if no response. DO NOT PLAY WITH THE PET UNDER DIRECT SUN LIGHT.

- The more you play with the Pet, the more excited the Pet will be. And you will find that the Pet will be automatically entered into the Hyper mode after you played for it at a certain time. More different sound effects, melodies and action patterns will be activated.

Note: In Stand Alone Mode, it will automatically enter into the power save mode after a few minutes when not in use. To turn it on again, switch off and turn on again. (pic.5a)

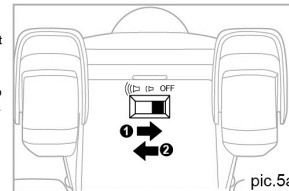

2. AUX MODE

You can simply plug in the Micro USB Connector to the left side of your Pet and connect the 3.5mm jack to any kind of audio music source. The source music can be started right after the connection. The lights of the dog's face will twinkle with different colors according to the rhythm.

Micro USB Connector

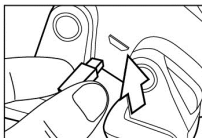

Plug in MP3 or any other music source

Enable Or Disable Actions

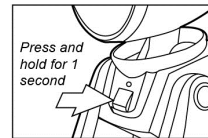

Press and hold for 1 second

While playing with music, you can enable or disable the Pet's actions by pressing and holding the function button for about 1 sec. (The default setting is no action.)

Jam In Music

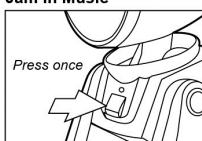

Press once

You can press the function button once to jam the sound effects into your music source.

Activate Actions

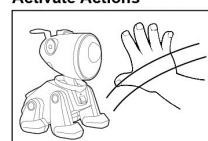

When you swing your hand in front of the Pet, his nose lights will twinkle with different colors and it will do actions if action is enabled.

3