

Photos taking/ Video recording

Press the photographing button to take photo through the camera on the helicopter. The Photo taking indicator will flash when a photo is taken.
 Press the video recording button to start recording video. Press the button again to stop recording. The Video recording indicator will turn on during recording.
 When the memory card is full, the icon on the upper right corner of the screen will be changed to **F**. Move/ remove the saved data from the internal memory before taking photos again.

Transferring files to computer

Opening stored photos and videos

1. Be sure your Helicopter has been switched OFF. Remove MicroSD card from helicopter. Insert it into adaptor and then connect with computer. A pop-up window will appear.

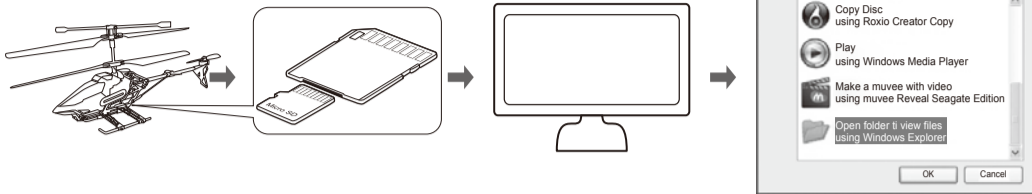

2. Enter the camera folder, find the image files to be needed location. Copy the images or videos to your computer.

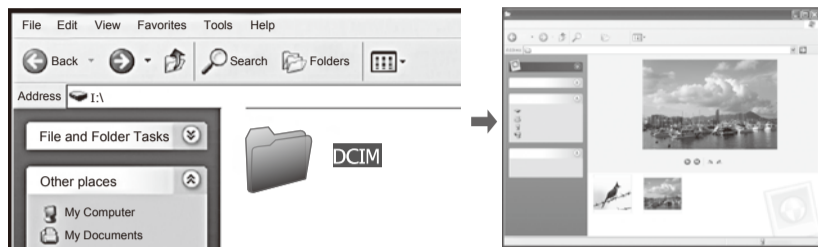

Inserting and removing the MicroSD

1. Open the cover.
2. Insert the MicroSD card (not included) with the gold-colored contacts facing up.
3. Push gently the card until the card disengages from the Helicopter, and then pull it out of the slot.

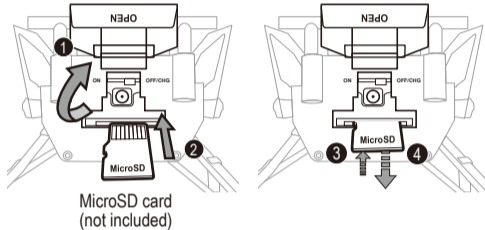

Note: Memory card slot : MicroSD card (not included), up to 32GB

Troubleshooting

Symptom	Cause	Correction
The helicopter does not response.	- The helicopter and/ or the transmitter is switch off ("OFF"). - The battery of the helicopter is weak.	- Set the power switch to "ON" - Recharge the battery of the helicopter.
The video/ photo was not recorded. The icon on the upper right corner of the screen will be changed to F .	- The battery of the helicopter is weak. - The memory card is full.	- Recharge the battery of the helicopter. - Move/ remove some photos/ videos.
The helicopter does not react, or react poorly to operation by transmitter.	- PAIRING / SYNC Procedure is not yet completed or done.	- Reset by switch off both helicopter and transmitter then switch both on again.
Loss of control.	- Out of the control range of distance. - Tail rotor blade is deformed or distorted.	- The transmission range is up to 50 meters in open space. - Replace the tail rotor blade with the spare one provided.

Facebook: facebook.com/SilverlitToys Visit us at www.Silverlit.com



This product is in compliance with the essential requirements and other relevant provisions of Directive 1999/5/EC.

ENGLISH 1
 For ages 15+
 Ab 15 Jahre
 A partir de 15 ans
 Leeftijd vanaf 15 jaar
 A partir de 15 años
 Dai 15 anni in su

Delivery contents

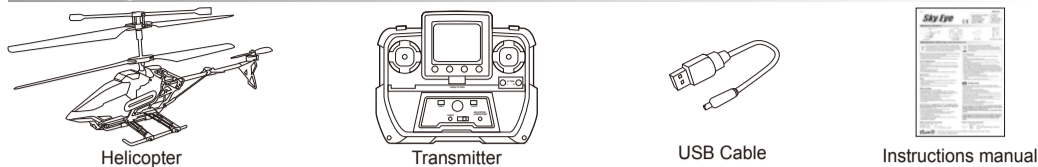

Precautions, Warnings and Statements

Warning: Conversion or modifications to this product not expressly approved by the party responsible for compliance could void the user's authority to operate the product.
 - The transmitter-charger is tailor-made for the LiPo rechargeable battery used in helicopter. Do not use it to charge any battery other than that in the helicopter.
 - Photographing or video recording should only take place with the consent from all involved parties.

Care and Maintenance:

- Always remove batteries from the product when it is not being used for a long period of time. (Transmitter only)
- Regularly examine for damage to the plug, enclosure and other parts. In the event of any damage, the product must not be used with the transmitter charger until the damage has been repaired.
- Wipe the product gently with a clean cloth.
- Keep the product away from direct heat.
- Do not submerge the product into water that can damage the electronic assemblies.

Special notes:

- Please read the operation instructions carefully prior to the first use.

Notes:

- Under the environment with electrostatic discharge, the product may malfunction and require user to reset the product.
- New alkaline batteries are recommended to use in this product to obtain best and maximum performance.
- This product must only be used with the recommended charger.

Battery warnings:

- Non-rechargeable batteries are not to be recharged.
 - Rechargeable batteries are to be removed before being charged. (Transmitter only)
 - Different types of batteries or new and used batteries are not to be mixed. (Transmitter only)
 - Only batteries of the same or equivalent type as recommended are to be used.
 - Batteries are to be inserted with correct polarity.
 - Exhausted batteries are to be removed from the product. (Transmitter only)
 - The supply terminals are not to be short-circuited.
 - Do not mix old and new batteries. (Transmitter only)
 - Do not mix alkaline, standard (carbon-zinc) or rechargeable (nickel-cadmium) batteries. (Transmitter only)
- This helicopter is equipped with a LiPo rechargeable battery, please pay attention to the following cautions for safety use:**
- Do not dispose the battery in fire or heat.
 - Do not use or leave the battery near a heat source such as fire or heater.
 - Do not strike or throw the battery against hard surface.
 - Do not immerse the battery in water, and keep the battery in a cool dry environment.
 - When recharging, only use the battery charger specifically for that purpose.
 - Do not over-charge the battery.
 - Do not connect the battery to an electrical outlet.
 - Do not directly solder the battery and pierce the battery with a nail or other sharp object.
 - Do not disassemble or alter the battery.
 - Charge the battery every 6 months.

Battery requirement (Transmitter):

- Power Supply : ---
- Rating : DC 12 V , 7.2 W
- Batteries : 8 x 1.5 V "AA"/LR6/AM3 (not included)



Silverlit SAS, Espace Green Parc, Route de Villepeclé, 91280 Saint Pierre du Perray / France.
 © 2012 Silverlit. All rights reserved.

Part Identification

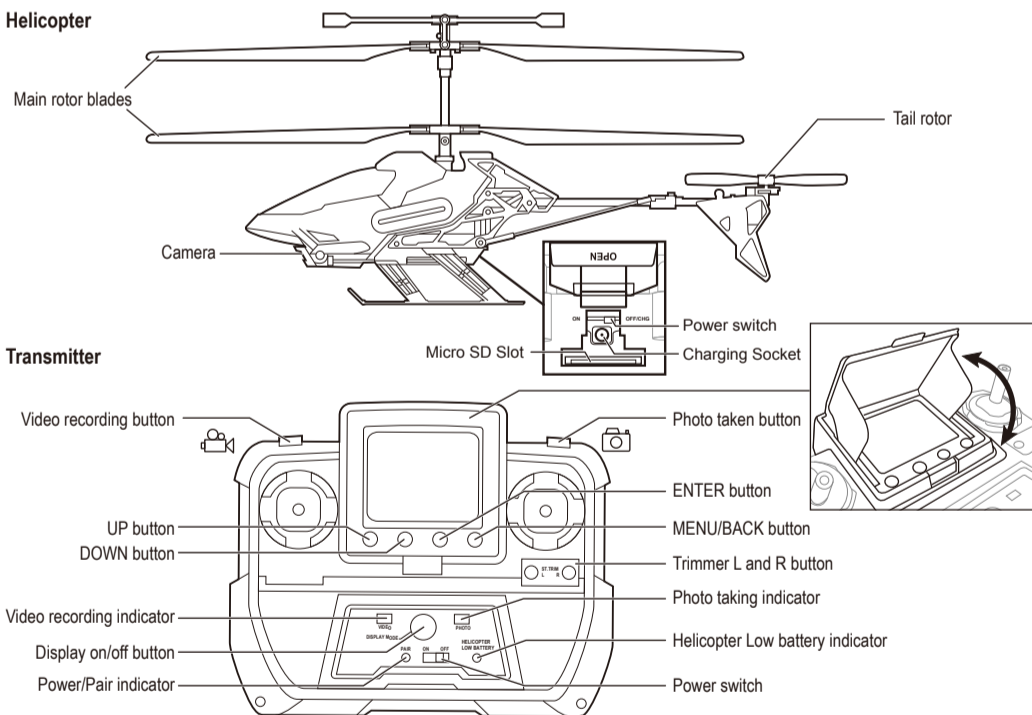

Battery Installation & Charging

Transmitter Battery Installation (*Make sure the power switch is set to "OFF".)

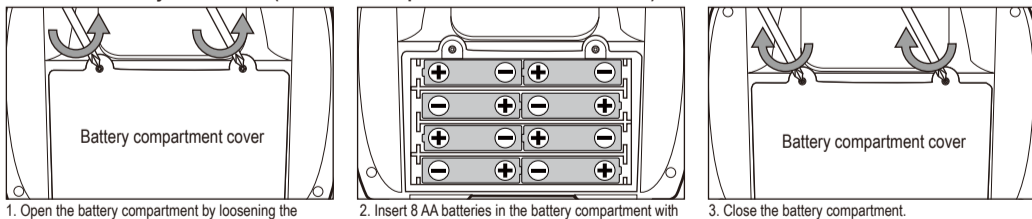

Note: When the power indicator on the transmitter starts blinking, replace the batteries.

Charging Helicopter

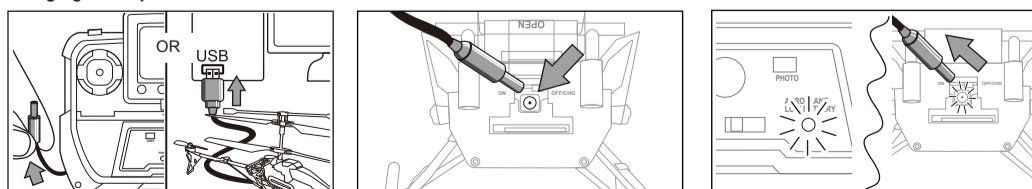

- Note:**
1. The helicopter can operate for about 4 - 5 minutes per every 60 - 80 minutes charging.
 2. Before recharging the battery, wait 10 - 15 minutes for it to cool down.

Flying Your Helicopter

Procedure for PAIR / SYNC the Helicopter and Transmitting

2.4 GHz technology allows for many helicopters to run without signal interference. A connection, or pairing, must be made between the helicopter and the transmitter to function. Sometimes, the pairing will happen automatically, if it does not, or if the connection is lost then follow these steps to sync the helicopter and the transmitter.

1. Place the helicopter on the ground with the tail point towards you and the nose pointing away. Make sure the throttle stick is at the minimum position.
2. Turn the Power Switch button to 'ON' position both on the Helicopter and Transmitter, Red LED will then flash.
3. The Synchronize/Pairing procedure is automatically COMPLETED when you can see the Red LED light up solid (not blinking) on both Helicopter and Transmitter.

1. Flight environment

- Choose the place which meets the following condition:
1. Indoor environment with calm air. Beware of the air circulation from the air-conditioner.
 2. Caution: There must not be any dangerous objects (electric fan, air-conditioner, reading lamp, etc) on the flight path.

2. Trimming the helicopter:

- Gently push the throttle up to raise your helicopter about 0.5 to 1 meter high.

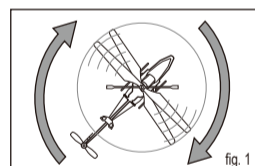

Spiral clockwise

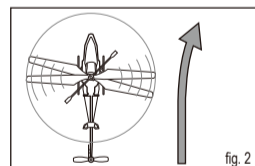

Keep turning clockwise

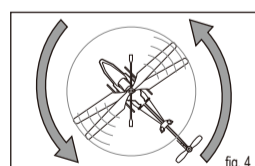

Spiral anticlockwise

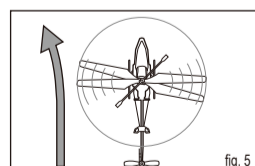

Keep turning anticlockwise

4. Lift-off procedures (after trimming procedure):

- Put the helicopter on a smooth surface. Uneven floor surface will affect its lifting off.
- Slowly increase the throttle.
- Do not look at the transmitter but focus on the helicopter.
- As soon as the helicopter leaves ground, reduce the throttle slightly. (In the worst case, helicopter will go back to the floor but that is better than crashing against the ceiling.)
- Very gently add the throttle if the helicopter descends.
- Very gently reduce the throttle if the helicopter ascends.
- For turning, give short and small inputs to the direction stick. (Most beginners will easily overcontrol the helicopter.)

Tip! Piloting hints

- For controlling the sticks on transmitter, try not to push the sticks immediately any extreme positions. It should be like steering a bicycle rather than pressing computer game sticks.
- For the novice pilot (after the trimming procedure is completed), it is highly recommended to focus exclusively on learning to control the throttle stick first. If the helicopter turns around by itself there is no need to keep it straight. For the first flight, it is important to learn to keep the helicopter at a constant altitude of around 1 meter with very gentle inputs on the throttle stick. Once the pilot masters this, he may start learning to take control with the direction stick.

Tip! Operation hints

- If the helicopter is crashed, switched off the helicopter and the transmitter. Examine the helicopter and ensure it has no damage before switching them on again.
- Don't operate the helicopter under the direct bright light it will affect the control system of your helicopter.
- Don't cover the IR diodes of the transmitter as it will block the IR signal.
- Don't stick any other label onto the helicopter as it will affect receiving of IR signal.