

Targus Antimicrobial Protection is a protective finish creating a cleaner surface. Unlike typically applied sprays, it works continuously to protect the device by preventing the growth of microorganisms. Keep your mouse safer with Targus Antimicrobial Protection.

**Antimicrobial product protection is limited to the device itself.

This mouse has been treated with an antimicrobial additive. Active ingredient: Silver Phosphate Glass (nano-).

EPA Est. 99234-CA-1

La protection antimicrobienne Targus est une finition protectrice créant une surface plus propre. Contrairement aux sprays à application topique, elle agit en continu pour protéger le périphérique en empêchant la croissance des micro-organismes. Gardez votre souris plus sûre avec la protection antimicrobienne Targus.

**La protection antimicrobienne du produit est limitée au produit lui-même.

Cette souris a été traitée avec un additif antimicrobien. Ingrédient actif : Verre phosphaté à l'argent (nano-).

EPA Est. 99234-CA-1

La Protección Antimicrobiana Targus es un acabado protector que crea una superficie más limpia. A diferencia de los aerosoles aplicados tópicamente, permanece activo de forma continua para proteger el dispositivo al evitar el crecimiento de microorganismos. Mantenga su mouse más seguro con la Protección Antimicrobiana Targus.

**La protección de producto antimicrobiana está limitada al dispositivo en sí.

Este mouse ha sido tratado con un aditivo antimicrobiano. Ingrediente activo: vidrio de fosfato de plata (nano-).

EPA Est. 99234-CA-1

2 Year LIMITED Warranty

We pride ourselves on the quality of our products. For complete warranty details and a list of our Worldwide offices, please visit www.Targus.com. Targus product warranty does not cover any device or product that is not manufactured by Targus (including, but not limited to, laptops, smartphones, devices, or any other product that may be used in connection with the Targus product).

Targus and DefenseGuard are trademarks or registered trademarks of Targus International LLC in the U.S. and in certain other countries. All logos and registered trademarks are the property of their respective owners. ©2021 Targus International LLC, 1211 North Miller St., Anaheim, CA 92806. All rights reserved.

GARANTIE DE 2 ANS

Nous sommes fiers de la qualité de nos produits. Pour plus de renseignements sur la garantie complète et une liste de nos bureaux à travers le monde, veuillez consulter www.targus.com. La garantie sur les produits Targus ne couvre pas les dispositifs ni les produits qui ne sont pas fabriqués par Targus (y compris, sans toutefois être limité, les ordinateurs portables, les téléphones portables et autres dispositifs et produits qui peuvent être utilisés en conjonction avec un produit Targus).

Targus et DefenseGuard sont des marques commerciales ou des marques déposées de Targus International LLC aux États-Unis et dans certains autres pays. Tous les logos et marques de commerce enregistrées sont la propriété exclusive de leur propriétaire. ©2021 Targus International LLC, 1211 North Miller St., Anaheim, CA 92806. Tous droits réservés.

2 AÑOS DE GARANTÍA

Nos sentimos muy orgullosos de la calidad de nuestros productos. Para acceder a toda la información de la garantía y a una lista de nuestras oficinas en el mundo, visite www.targus.com. La garantía de producto Targus no cubre ningún dispositivo o producto que no haya sido fabricado por Targus (incluyendo sin limitación, computadoras portátiles, smartphones, dispositivos o cualquier otro producto que pudiera usarse en conexión con el producto Targus).

Targus y DefenseGuard son marcas comerciales registradas de Targus International LLC en los EE. UU. y en ciertos otros países. Todos los logotipos y marcas comerciales registradas son propiedad de sus respectivos dueños. ©2021 Targus International LLC, 1211 North Miller St., Anaheim, CA 92806. Todos los derechos reservados.

Wireless Mouse FCC ID: OXM000130
Wireless Receiver FCC ID: OXM000131

Wireless Mouse IC: 3760B-00115
Wireless Receiver IC: 3760B-00116



Targus®

AMW584

BLUETRACE WIRELESS MOUSE
SOURIS SANS FIL BLUETRACE
MOUSE INALÁMBRICO BLUETRACE

User Guide

Guide de l'utilisateur

Guía del usuario

Product name: Wireless mouse
Model: AMW584/AMW584R
SKU #: AMW584GL

Targus AMW584 Bluetrace Wireless Mouse

Functional Introduction

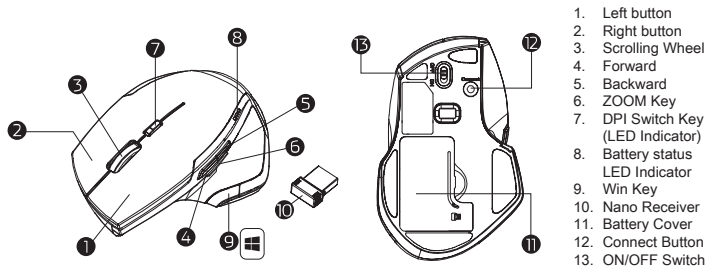

DPI Switch

The LED indicator under tilt wheel will light up when you plug the mouse into the USB port. The brightness of the indicator indicates the DPI setting in use. There are three different settings:

- Bright: 1600 DPI
- Dim: 1300 DPI
- No light: 800 DPI

The default setting is 800 DPI. You can easily switch between DPI settings. In order to save power, the LED display will only last for 10 seconds.

Contents

- Targus Wireless Mouse
- 2 x AA Energizer Battery
- USB Receiver
- User Guide

System Requirements

Windows® 10
macOS®
iOS®
Android™

Targus AMW584 Bluetrace Wireless Mouse

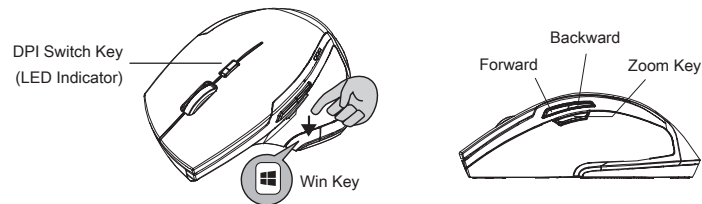

Forward

Press this button to view the next page in your Internet browser.

Backward

Press this button to view the previous page in your Internet browser.

Zoom Key (Zoom in/out)

Press zoom key + scroll to zoom in/out.

Win Key

Windows button for one-touch access to the Start screen.

AMW584	
2.4G Frequency Range	2408MHz-2474MHz
Battery Type	2*AA battery
Effective 2.4G RF Communication Range	10 metres max.
2.4G Maximum EIRP Power (dBm) (EU)	2.2dBm
Rating	3V 100mA

AMW584R	
2.4G Frequency Range	2408MHz-2474MHz
Interface	USB 1.1 / 2.0
2.4G Maximum EIRP Power (dBm) (EU)	-0.2dBm
Rating	5V 100mA

Targus AMW584 Bluetrace Wireless Mouse

Installing the batteries

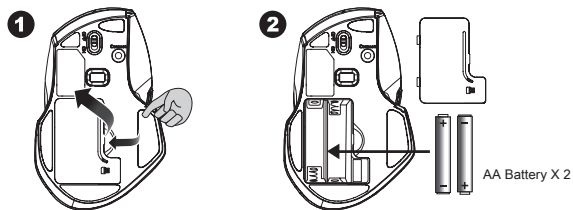
Step 1: Take the battery cover off.**Step 2:** Insert the batteries as shown inside the battery compartment.**Step 3:** Replace the cover.**Step 4:** Turn on power switch.**Warning:**

Please insert the battery with the correct position according to the instruction labeled on the mouse.

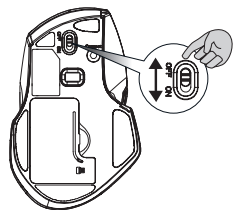
**Step 5:** If you need to travel with your wireless mouse, make sure you turn off the POWER SWITCH.

Targus AMW584 Bluetrace Wireless Mouse

Setup the Connection between the Receiver and the Mouse

1. Insert the batteries into the mouse, then follow the steps below.
2. In the meantime, to open the mouse under the cover, take the nano receiver out.

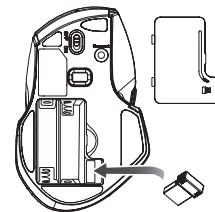

3. Plug the Nano receiver into the USB A port on your computer.

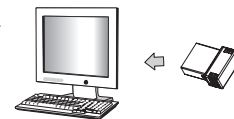

4. If the mouse does not work, please put it into pairing mode.
5. Pairing: Re-plug the receiver into the USB port on your computer, then press the connect button on the mouse. If the mouse does not work after 10 seconds, pair them again. (The receiver has auto pairing function).
6. The LED indicator on mouse flashes steadily when it is in pairing mode and stops blinking when it is successfully paired with the receiver.
7. When low battery, the battery indicator on the mouse will start to blink.

Targus AMW584 Bluetrace Wireless Mouse

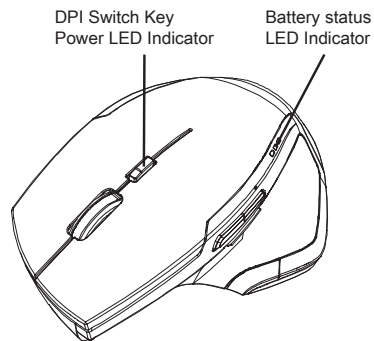
***LED Indicator**

LED is on for 3 sec.
Power ON

LED Blinks for 3 times
During Pairing (LED OFF when
paired or failed after 10 sec.)

LED Blinks for 10 sec.
Low Battery Warning

DPI Indicated
(when DPI switched)

Power status LED Indicator	
Power ON	LED is on for 5 seconds
Wake up	LED is on for 5 seconds
Low battery	LED blinks 10 seconds
Battery status LED Indicator	
3 LED Bright	80~100%
2 LED Bright	50~70%
1 LED Bright	20~40%

Targus AMW584 Bluetrace Wireless Mouse

Introduction

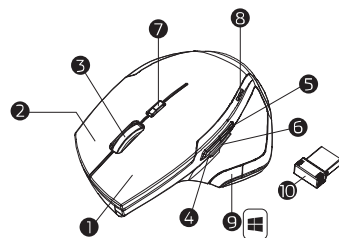

1. Bouton gauche
2. Bouton droit
3. Molette de défilement
4. Avancer
5. Retour en arrière
6. Touche ZOOM
7. Touche de commutation DPI (Indicateur DEL)
8. Statut de la pile (Indicateur DEL)
9. Touche Win
10. Récepteur Nano
11. Couverture du compartiment de la pile
12. Bouton de connexion
13. Interrupteur MARCHÉ / ARRÊT

Commutateur DPI

L'indicateur LED sous la molette s'allume lorsque vous branchez la souris sur le port USB. La luminosité de l'indicateur indique le réglage DPI utilisé. Il existe trois réglages différents :

- Lumineux : 1600 DPI
- Variateur : 1300 DPI
- Pas de lumière: 800 DPI

Le paramètre par défaut est 800 DPI. Vous pouvez facilement basculer entre les paramètres DPI. Afin d'économiser de l'énergie, l'affichage LED ne durera que 10 secondes.

Contenu

- Souris sans fil Targus
- 2 piles AA Energizer
- Récepteur USB
- Guide d'utilisation

Configuration requise du système

Windows® 10
macOS®
iOS®
Android™

Targus AMW584 Bluetrace Wireless Mouse

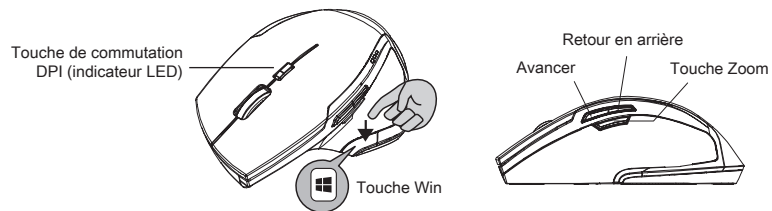
**Avancer**

Appuyez sur ce bouton pour afficher la page suivante dans votre navigateur Internet.

Retour en arrière

Appuyez sur ce bouton pour afficher la page précédente dans votre navigateur Internet.

Touche de zoom (zoom avant / arrière)

Appuyez sur la touche zoom + défilement pour effectuer un zoom avant / arrière.

Touche Win

Bouton Windows pour un accès direct à l'écran de démarrage.

AMW584	
Gamme de fréquences 2,4 G	2408MHz-2474MHz
Type de batterie	2 piles de type AA
Portée effective de communication RF 2,4 G	10 mètres max.
Puissance PIRE maximale 2,4 G (dBm) (UE)	2.2dBm
Valeur nominale	3V 100mA

AMW584R	
Gamme de fréquences 2,4 G	2408MHz-2474MHz
Interface	USB 1.1 / 2.0
Puissance PIRE maximale 2,4 G (dBm) (UE)	-0.2dBm
Valeur nominale	5V 100mA

Targus AMW584 Bluetrace Wireless Mouse

Installation des piles

Étape 1 : Retirez le couvercle du compartiment des piles.

Étape 2 : Insérez les piles comme indiqué à l'intérieur du compartiment des piles.

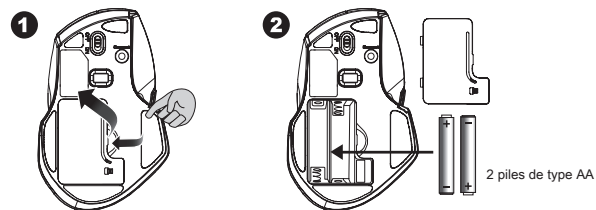

Étape 3 : Remettez le couvercle.

Étape 4 : Allumez l'interrupteur d'alimentation.

Avertissement :

Veillez insérer les piles dans la position correcte selon les instructions indiquées sur la souris.

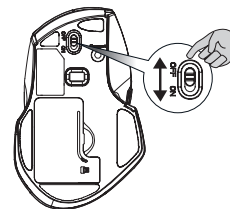

Étape 5 : Si vous devez voyager avec votre souris sans fil, assurez-vous que vous éteignez le BOUTON D'ALIMENTATION.

Targus AMW584 Bluetrace Wireless Mouse

Configurez la connexion entre le récepteur et la souris

1. Insérez les piles dans la souris, puis suivez les étapes ci-dessous.
2. En attendant, pour ouvrir la souris sous le couvercle, sortez le nano-récepteur.

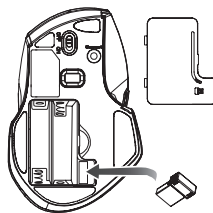

3. Branchez le récepteur Nano dans le port USB A de votre ordinateur.

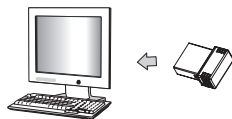

4. Si la souris ne fonctionne pas, veuillez la mettre en mode d'appariement.
5. Appariement : Rebranchez le récepteur dans le port USB de votre ordinateur, puis appuyez sur le bouton de connexion de la souris. Si la souris ne fonctionne pas après 10 secondes, appariez-la à nouveau. (Le récepteur a une fonction d'appariement automatique).
6. L'indicateur LED de la souris clignote régulièrement lorsqu'elle est en mode d'appariement et cesse de clignoter lorsqu'elle est correctement appariée avec le récepteur.
7. Lorsque les piles sont faibles, l'indicateur des piles de la souris commence à clignoter.

Targus AMW584 Bluetrace Wireless Mouse

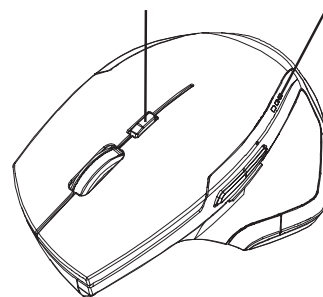
Indicateur LED d'alimentation de
la touche de commutation DPIIndicateur LED du
statut des piles

* Indicateur LED

La LED est allumée pendant 3 secondes.

Mise sous tension

La LED clignote 3 fois

Pendant l'appariement (LED éteinte en cas d'appariement ou échec après 10 secondes)

La LED clignote 10 fois

Avertissement de piles faibles

DPI indiqué

(lorsque DPI commuté)

Indicateur LED du statut de l'alimentation

Mise sous tension	La LED est allumée pendant 5 secondes
Réactivation	La LED est allumée pendant 5 secondes
Piles faibles	La LED clignote pendant 10 secondes

Indicateur LED du statut des piles

3 LED lumineuses	80~100%
2 LED lumineuses	50~70%
1 LED lumineuse	20~40%

Targus AMW584 Bluetrace Wireless Mouse

Presentación funcional

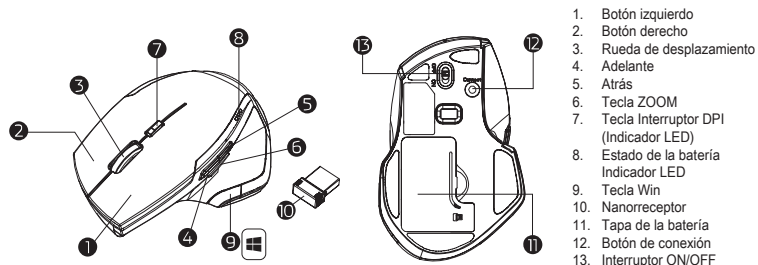

1. Botón izquierdo
2. Botón derecho
3. Rueda de desplazamiento
4. Adelante
5. Atrás
6. Tecla ZOOM
7. Tecla Interruptor DPI (Indicador LED)
8. Estado de la batería Indicador LED
9. Tecla Win
10. Nanorreceptor
11. Tapa de la batería
12. Botón de conexión
13. Interruptor ON/OFF

Interruptor DPI

El indicador LED debajo de la rueda inclinable se enciende al conectar el mouse en el puerto USB. El brillo del indicador muestra que el ajuste DPI está en uso. Hay tres ajustes diferentes:

- Luminoso: 1600 DPI
- Tenue: 1300 DPI
- Sin luz: 800 DPI

El ajuste predeterminado es 800 DPI. Puede cambiar fácilmente entre ajustes DPI. Para ahorrar energía, el indicador LED solo dura 10 segundos.

Contenido

- Mouse inalámbrico Targus
- 2 pilas Energizer AA
- Receptor USB
- Guía del usuario

Requisitos del sistema

Windows® 10
macOS®
iOS®
Android™

Targus AMW584 Bluetrace Wireless Mouse

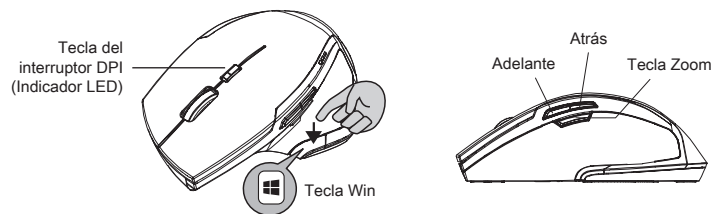

Adelante

Pulse este botón para ver la siguiente página en su explorador de internet.

Atrás

Pulse este botón para ver la página anterior en su explorador de internet.

Tecla Zoom (acercar/alejar el zoom)

Pulse la tecla zoom + desplace para acercar o alejar el zoom.

Tecla Win

Botón Windows para acceso con un solo toque a la pantalla de Inicio.

AMW584	
Rango de frecuencia de 2.4G	2408MHz-2474MHz
Tipo de pila	2* pilas AA
Rango de comunicación de RF de 2.4G efectivo	10 metros máx.
Potencia EIRP máxima de 2.4G (dBm) (UE)	2.2dBm
Clasificación	3V 100mA

AMW584R	
Rango de frecuencia de 2.4G	2408MHz-2474MHz
Interfaz	USB 1.1 / 2.0
Potencia EIRP máxima de 2.4G (dBm) (UE)	-0.2dBm
Clasificación	5V 100mA

Targus AMW584 Bluetrace Wireless Mouse

Instalar la batería

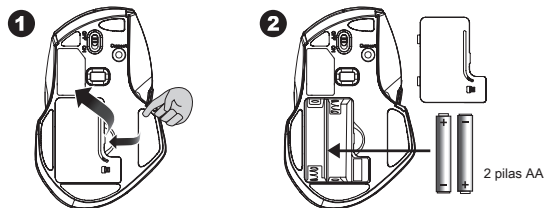
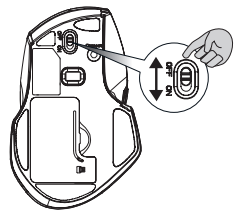
Paso 1: Retire la tapa de la batería.**Paso 2:** Inserte las pilas como se muestra dentro del compartimiento de la batería.**Paso 3:** Coloque la tapa.**Paso 4:** Encienda el interruptor.**Advertencia:**

Inserte las pilas en la posición correcta según las instrucciones que encontrará en el mouse.

Paso 5: Si necesita viajar con su mouse inalámbrico, asegúrese de apagar el INTERRUPTOR DE ENCENDIDO.

Targus AMW584 Bluetrace Wireless Mouse

Configuración de la conexión entre el receptor y el mouse

1. Inserte las pilas en el mouse y siga los pasos a continuación.
2. Mientras tanto, para abrir el mouse, saque el nanorreceptor.

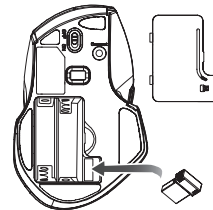

3. Conecte el nanorreceptor en el puerto USB A de su computadora.

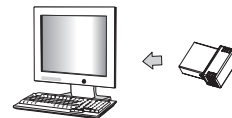

4. Si el mouse no funciona, póngalo en modo emparejamiento.
5. Emparejamiento: Reconecte el receptor en el puerto USB de su computadora, luego pulse el botón de conexión en el mouse. Si el mouse no funciona después de 10 segundos, vuélvalo a emparejar. (El receptor tiene una función de emparejamiento automático).
6. El indicador LED del mouse parpadea de forma continua cuando está en modo emparejamiento y deja de parpadear cuando queda correctamente emparejado con el receptor.
7. Cuando la batería esté baja, el indicador de batería en el mouse empezará a parpadear.

Targus AMW584 Bluetrace Wireless Mouse

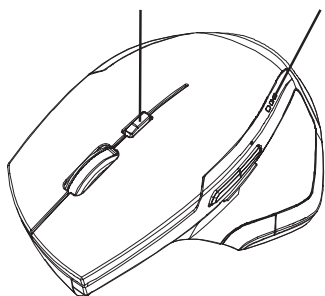
Tecla del interruptor DPI
Indicador LED de encendidoIndicador LED del
estado de la batería***Indicador LED****LED encendido durante 3 segundos**
Encendido ON**La luz LED parpadea 3 veces**
Durante el emparejamiento
(LED apagada cuando se
empareja o si hay fallos después
de 10 segundos)**La luz LED parpadea 10 segundos**
Aviso de batería baja**DPI indicado**
(cuando el DPI cambia)**Indicador LED del estado de encendido o apagado**

Mise sous tension	La LED est allumée pendant 5 secondes
Réactivation	La LED est allumée pendant 5 secondes
Piles faibles	La LED clignote pendant 10 secondes

Indicateur LED du statut des piles

3 LED lumineuses	80~100%
2 LED lumineuses	50~70%
1 LED lumineuse	20~40%

Targus AMW584 Bluetrace Wireless Mouse

Targus**Supplier's Declaration of Conformity**

Manufacturer/ Responsible Party : Targus International LLC
Address : 1211 North Miller Street, Anaheim, CA 92806 USA
Tel: 1-714-765-5555
Fax: 1-714-765-5599
Internet: www.targus.com

Hereby declares that the Product

Trade name: **Targus**

Product name: Wireless Mouse and Wireless receiver

Model number(Reg#): AMW584 (Wireless Mouse)
AMW584R(Wireless receiver)

Conforms to the following specifications

FCC CFR Title 47 Part 15 Subpart B and ANSI C63.4-2014 standard limits
The test data & results are referred to the test report Number: 210315045SZN-001**Supplementary Information:**

This device complies with part 15 of the FCC Rules. Operation is subject to the following two conditions: (1) This device may not cause harmful interference, and (2) this device must accept any interference received, including interference that may cause undesired operation.

Director, Targus International LLC Ngh,CF
Function Title Name

26/5/2021 *alpha*
Date Signed for and on behalf of Targus

Targus AMW584 Bluetrace Wireless Mouse



Déclaration de conformité du fournisseur



Fabricant/	Targus International LLC	Tél. :	1-714-765-5555
Partie responsable:	1211 North Miller Street	Téléç.:	1-714-765-5599
Adresse:	Anaheim, CA 92806 USA	Internet:	www.targus.com

Déclare, par les présentes, que le produit

Dénomination commerciale: **Targus**

Nom du produit: Wireless Mouse and Wireless receiver

Numéro de modèle: AMW584 (Wireless Mouse)
AMW584R(Wireless receiver)

Conforme aux spécifications suivantes

FCC CFR titre 47, section 15, sous-section B et les limites standard ANSI C63.4-2014
Pour obtenir les données et les résultats de test, consultez le rapport de test numéro: 2103150455ZN-001

Renseignements Supplémentaires:

Cet appareil est conforme à la partie 15 des règlement de la FCC. Le fonctionnement est assujéti aux deux conditions suivantes: (1) Cet appareil ne doit pas causer d'interferences nuisibles, et (2) cet appareil doit accepter toute interference reçue, y compris les interferences pouvant entrainer un fonctionnement indésirable.

Directeur, Qualité et Conformité, Targus International LLC	CF Ngoh
Titre de la fonction	Nom
26/5/2021	
Date	Signature pour et au nom de Targus

Targus AMW584 Bluetrace Wireless Mouse



Declaration of Conformity

Manufacturer:	Targus International LLC	Tel:	1-714-765-5555
Address :	1211 North Miller Street	Fax:	1-714-765-5599
	Anaheim, CA 92806 USA	Internet:	www.targus.com
Importer:	Targus Europe Ltd.	Tel:	+44 (0)20 8831 2013
Address:	5 New Square, Bedford Lakes		
	Business Park, Feltham, Middlesex,		
	TW14 8HA, UK		

We herewith confirm the following designated product Wireless Mouse and Wireless Receiver, Model No. AMW584(Wireless Mouse),AMW584R(Wireless Receiver), Brand name "Targus", complies with below UK legislation and relevant standards.

For the evaluation regarding the below legislation, the following standards were applied:

Radio Equipment Regulations 2017

- ETSI EN 301 489-1 V 2.2.3(2019-11)
- ETSI EN 301 489-17 V 3.2.4(2020-09)
- ETSI EN 300 328 V2.2.2(2019-07)
- EN 55032:2015+A11:2020
- EN 55035:2017+A11:2020
- EN 62479: 2010
- BS EN 62368-1 :2014+A11 :2017

The Restriction of the Use of Certain Hazardous Substances in Electrical and Electronic Equipment Regulations 2012

EN IEC 63000:2018

This declaration of conformity is issued under the sole responsibility of the manufacturer.

Director, Targus - Global Sourcing Group	CF Ngoh
Function Title	Name
5/13/2021 / Hong Kong	
Date / Place of Issue	Signed for and on behalf of Targus

Targus AMW584 Bluetrace Wireless Mouse

Targus

Declaration of Conformity



Manufacturer: Targus International LLC Tel: 1-714-765-5555
 Address: 1211 North Miller Street, Fax: 1-714-765-5599
 Anaheim, CA 92806 USA Internet: www.targus.com
 Importer: Targus Europe Ltd. Tel: +44 (0)20 8831 2013
 Address: Targus EMEA Account Management
 Van Hilstraat 19, 5145 RK Waalwijk,
 NETHERLANDS

We herewith confirm the following designated product Wireless Mouse and Wireless Receiver, Model No. AMW584(WIRELESS MOUSE), AMW584R(WIRELESS RECEIVER), Brand name "TARGUS", complies with the Radio Equipment Directive 2014/53/EU, EU ROHS Directive 2011/65/EU and its amendment Directive (EU) 2015/863.

For the evaluation regarding the above Directives, the following standards were applied:

RED: 2014/53/EU

ETSI EN 301 489-1 V2.2.3 (2010-11)

ETSI EN 301 489-17 V3.2.4 (2020-09)

ETSI EN 300 328 V2.2.2 (2019-07)

EN 55032:2015/A11:2020

EN 55035:2017/A11:2020

EN 62479 :2010

EN 62368-1:2014/A11:2017

RoHS Directive: 2011/65/EU and its amendment Directive (EU) 2015/863

EN IEC 63000:2018

Year to begin CE marking: 2021

Director, Targus - Global Sourcing Group
Function Title

CF Ngoh
Name

5/13/2021 / Hong Kong
Date / Place of Issue

Signed for and on behalf of Targus

Targus AMW584 Bluetrace Wireless Mouse

Technical Support

For technical questions, please visit:

US

Internet: <http://targus.com/us/support>

Canada

Internet: <http://www.targus.com/ca/support>

Australia

Internet: <http://www.targus.com/au/support>

Email: infoaust@targus.com

Telephone: 1800-641-645

Telephone: 0800-633-222

Email: latam.soporte@targus.com

New Zealand

Latin America

Product Registration

Targus recommends that you register your Targus accessory shortly after purchasing it. Go to:

http://targus.com/us/product_registration

You will need to provide your full name, email address, country of residence and product information.

Two Year Warranty

We pride ourselves on the quality of our products. For complete warranty details and a list of our worldwide offices, please visit www.targus.com. Targus product warranty does not cover any device or product that is not manufactured by Targus (including, but not limited to, laptops, smartphones, devices, or any other product that may be used in connection with the Targus product). Australian customers: For complete warranty details see warranty statement enclosed.

Targus is a registered trademark of Targus International LLC in the U.S. and in certain other countries. Microsoft, Windows and Windows Vista are registered trademarks or trademarks of Microsoft Corporation in the United States and/or other countries. Mac is a trademark of Apple Inc., registered in the U.S. and other countries. Chromebook is a trademark of Google, Inc. All logos and registered trademarks are the property of their respective owners. ©2021 Targus, 1211 North Miller Street, Anaheim, CA 92806. All rights reserved.

Regulatory Compliance

This device complies with Part 15 of the FCC Rules. Operation is subject to the following two conditions: (1) This device may not cause harmful interference, and (2) This device must accept any interference received, including interference that may cause undesired operation.

Declaration of Conformity

Hereby, Targus declares that this device is in compliance with the essential requirements and other relevant provisions of Directive 2014/53/EU.

Targus AMW584 Bluetrace Wireless Mouse

Technical Support

For technical questions, please visit:

Internet

English	https://uk.targus.com/pages/support
French	https://fr.targus.com/pages/support
German	https://de.targus.com/pages/support
Spanish	https://es.targus.com/pages/support

Phone (language answered in):

Austria:	01 795 676 42 (German)
Belgium:	02-717-2451 (French)
Denmark:	+45 35 25 87 51 (English)
Finland:	+358 922948016 (English)
France:	01-6453-9151 (French)

Germany:	0211-6579-1151 (German)
Netherlands:	02 0504 0671 (English)
Norway:	+4722577729 (English)
Portugal:	+351 21 415 4123 (English)
South Africa:	+27 211 003 270 (English) - Calls answered 10am-6pm South African time
Spain:	91 745 6221 (Spanish)
Sweden:	08-751-4058 (English)
Switzerland:	+41 (0) 44 212 0007 (French or German)
UK:	020-7744-0330 (English)
Eastern Europe and others not listed above:	+44 (0) 207 744 0330 (English)

Australian And New Zealand Consumers Only

Thank you for your purchase. Targus warrants to the original purchaser that its products are free from defects in materials and workmanship and, during the specified warranty period, and lasts as long as the original purchaser owns the product. The warranty period is stated on the packaging or in the documentation provided with this Targus product. Targus' Limited Product Warranty excludes damage caused by accident, neglect, abuse, misuse, improper care, normal wear and tear, ownership transfer, or alteration. The limited warranty also excludes any product that is not manufactured by Targus (including, without limitation, laptops, smartphones, devices, tablets, or any other non-Targus item) that is used in connection with the Targus product.

In the event that the Targus product has a defect in materials or workmanship Targus will, after receiving a warranty claim and inspecting the product, at its discretion, do one of the following: repair, replace, or refund with the same or a similar product (or part) of no lesser quality and ship it to the original purchaser at Targus' expense. As part of this inspection, proof of purchase will be required. There is no charge for inspection. To make a warranty claim, please contact Targus Australia or New Zealand (see details below), or return the product to the place of purchase. The original purchaser must bear the cost of the delivery to Targus.

Under Australian and/or New Zealand Consumer Laws, in addition to any warranty Targus gives, our products come with guarantees that cannot be excluded. You are entitled to a replacement or refund for a major failure and compensation for any other reasonably foreseeable loss or damage. You are entitled to have the products repaired or replaced if they fail to be of acceptable quality and the failure does not amount to a major failure.

For any warranty question, contact Targus Australia Pty. Ltd. (i) by mail at Suite 2, Level 8, 5 Rider Boulevard, Rhodes NSW 2138, by phone AUS 1800 641 645 or NZ 0800 633 222 or by Email: infoaust@targus.com. For additional information, check out our website at targus.com/au/warranty.

Targus AMW584 Bluetrace Wireless Mouse

**Federal Communication Commission
Interference Statement**

This equipment has been tested and found to comply with the limits for a Class B digital device, pursuant to Part 15 of the FCC Rules. These limits are designed to provide reasonable protection against harmful interference in a residential installation. This equipment generates, uses and can radiate radio frequency energy and, if not installed and used in accordance with the instructions, may cause harmful interference to radio communications. However, there is no guarantee that interference will not occur in a particular installation. If this equipment does cause harmful interference to radio or television reception, which can be determined by turning the equipment off and on, the user is encouraged to try to correct the interference by one of the following measures:

- Reorient or relocate the receiving antenna.
- Increase the separation between the equipment and receiver.
- Connect the equipment into an outlet on a circuit different from that to which the receiver is connected.
- Consult the dealer or an experienced radio/TV technician for help.

FCC Caution: Any changes or modifications not expressly approved by the party responsible for compliance could void the user's authority to operate this equipment.

This device complies with Part 15 of the FCC Rules. Operation is subject to the following two conditions: (1) This device may not cause harmful interference, and (2) this device must accept any interference received, including interference that may cause undesired operation.

Industry Canada statement

This device contains licence-exempt transmitter(s)/receiver(s) that comply with Innovation, Science and Economic Development Canada's licence-exempt RSS(s). Operation is subject to the following two conditions:

1. This device may not cause interference.
2. This device must accept any interference, including interference that may cause undesired operation of the device.

L'émetteur/récepteur exempt de licence contenu dans le présent appareil est conforme aux CNR d'Innovation, Sciences et Développement économique Canada applicables aux appareils radio exempts de licence. L'exploitation est autorisée aux deux conditions suivantes:

1. L'appareil ne doit pas produire de brouillage;
2. L'appareil doit accepter tout brouillage radioélectrique subi, même si le brouillage est susceptible d'en compromettre le fonctionnement.