

# Holiday showhome™

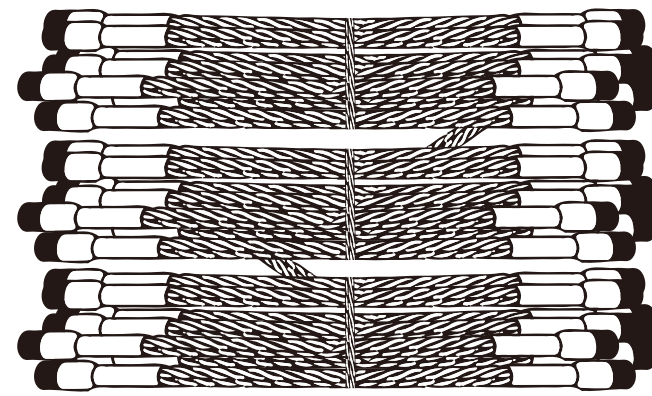

## 300 ULTIMATE LIGHT STRING INSTRUCTION MANUAL

### Package contents and specification

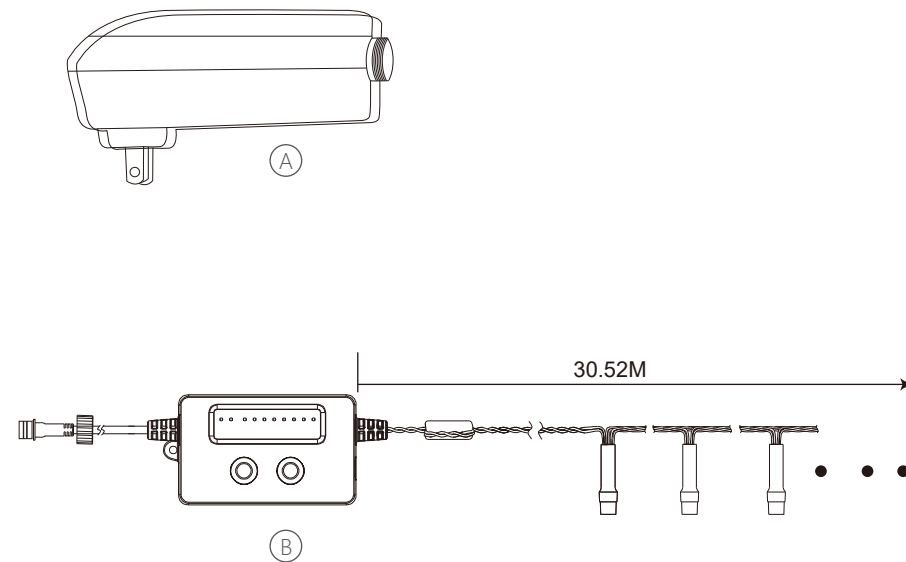

PART	DESCRIPTION	QUANTITY
A	Adapter	1
B	300 Ultimate light string	1

#### Specification

INPUT: 120V ~ 60Hz, 1.0A Max  
 OUTPUT: DC24V 1.5A  
 OPERATION: Indoor/Outdoor  
 OPERATING TEMPERATURE: -15° F TO 90° F (-26° C TO 32° C)  
 WARRANTY: One Year Limited

1

### Installation notes

1 Controller connection adapter as shown

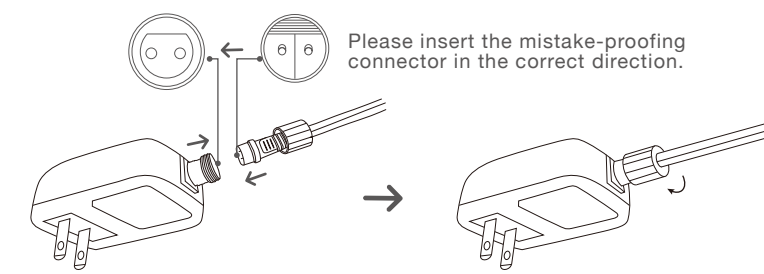

2 Connect the power adapter to the power supply

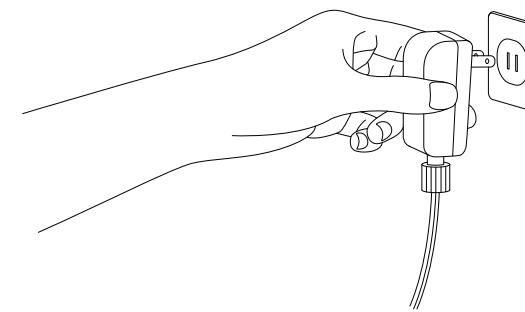

2

### Button Functions

1 There are two ways for WiFi connection:

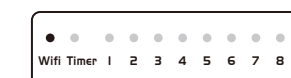
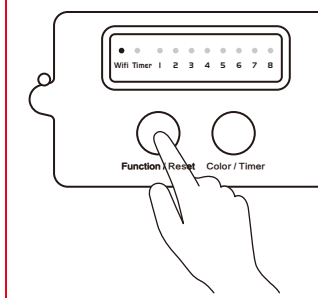

1.STA: WiFi signal indicator light stays on fast flash.



2.AP: WiFi signal indicator keeps flickering slowly.

This two modes can be switchover by long pressing the "reset" button at least for 5s. The current instruction should be in AP mode. (wifi signal indicator light should be in off state)

2 Button switch function instruction:

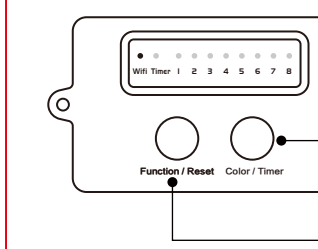

- Short press: button switch function. long press at least for 5s: switchover to wifi mode.
- Short press: switchover to color and theme. long press at least for 2s: set timer.

(2-1) Press the Color/Timer button and hold for more than 2 seconds, you can set the timer. When timer is working, the green timer indicator will light up.

3

### Button Functions

(2-2) Short press the Function/Reset button to change the functions. There are 15 functions as below:

Features	
0	OFF
1	Steady
2	Sparkle
3	Rainbow
4	Fade
5	Snow
6	Snake
7	Twinkle
8	Fireworks
9	Horizontal
10	Waves
11	Updown
12	Glow
13	Color rand
14	Instead
15	Alternate

4

### Button Functions

(2-3) Short press the Color/Timer button to change the functions. There are 16 single color and 13 themes as below:

Color	Theme
0	Monochrome
1	Red
2	Green
3	Blue
4	Orange
5	Pink
6	Spring green
7	Gold
8	Peach
9	Lawn green
10	Cyan
11	Sky blue
12	Yellow
13	Purple
14	Pure white
15	Cold white
0	Spring
1	Summer
2	Autumn
3	Winter
4	Christmas day
5	Valentines' day
6	Independence day
7	Thanks giving day
8	St. patrick's day
9	Halloween
10	Sun
11	Earth
12	Multi-color

3 Connect the audio line between the 300L Ultimate String's audio input interface and your phone(or other music player), then the lights will flash follow the music beat.

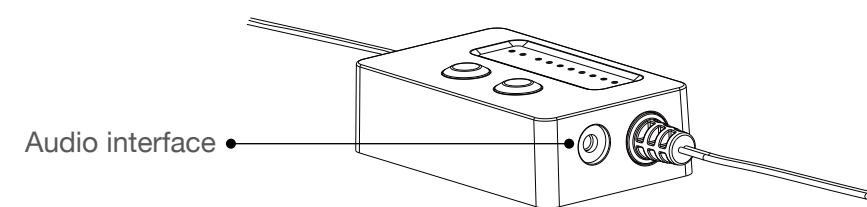

5

### APP Operation

1 Connect your phone

a. Open WiFi settings of your mobile device. b. Find and select "UltimateString\_XXXX" network.



c. Ensure that "UltimateString\_XXXX" network is connected.

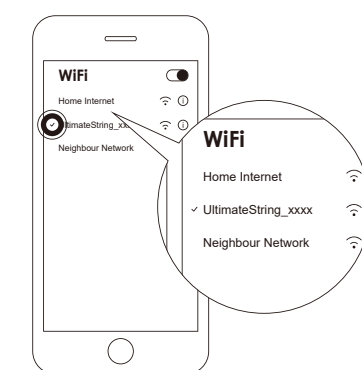

6

### APP Operation

2 Play Effects

a. Launch the app and select "AP" mode. b. Launch the app and open the Effects Gallery.

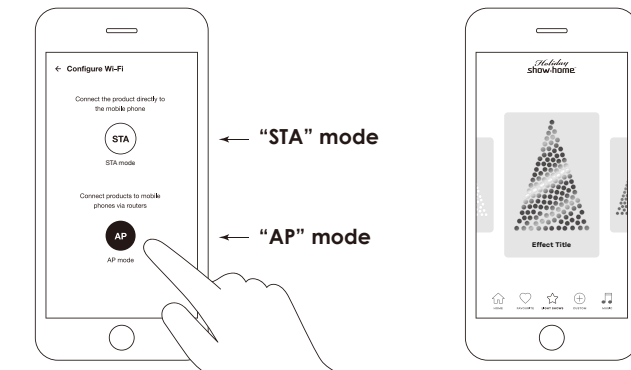

c. Browse effects by swiping left or right. d. Tap to select an effect

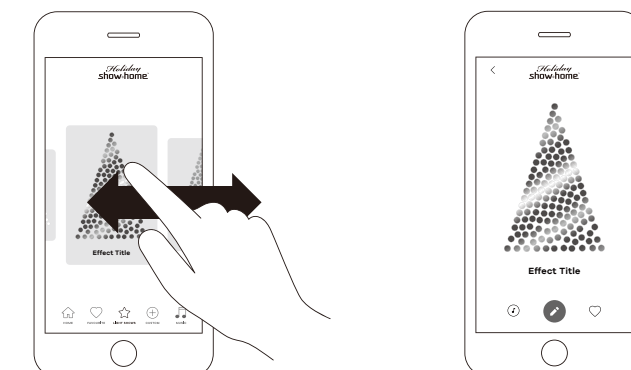

7

### APP Operation

3 Edit Effects

a. While playing an effect, press "⚙️" to show current settings. d. Tap the color sample to change colors or "+" to create a custom color.

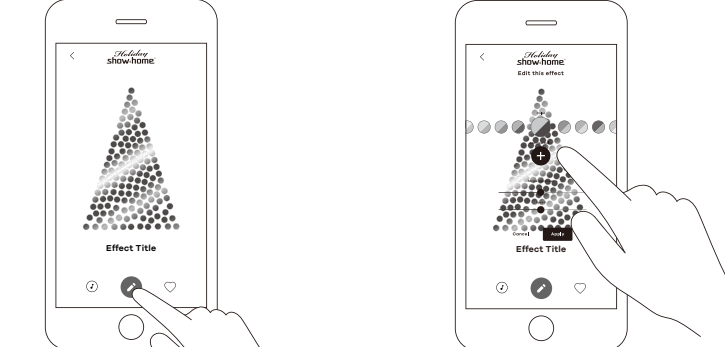

c. Move sliders to increase/decrease speed and intensity of the effect. d. Tap "Apply" to store changes.

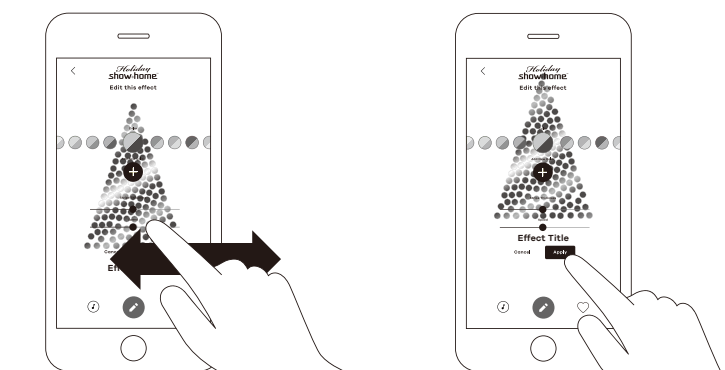

8

### FCC Caution.

This device complies with part 15 of the FCC Rules. Operation is subject to the following two conditions: (1) This device may not cause harmful interference, and (2) this device must accept any interference received, including interference that may cause undesired operation.

Any Changes or modifications not expressly approved by the party responsible for compliance could void the user's authority to operate the equipment.

Note: This equipment has been tested and found to comply with the limits for a Class B digital device, pursuant to part 15 of the FCC Rules. These limits are designed to provide reasonable protection against harmful interference in a residential installation. This equipment generates uses and can radiate radio frequency energy and, if not installed and used in accordance with the instructions, may cause harmful interference to radio communications. However, there is no guarantee that interference will not occur in a particular installation. If this equipment does cause harmful interference to radio or television reception, which can be determined by turning the equipment off and on, the user is encouraged to try to correct the interference by one or more of the following measures: -Reorient or relocate the receiving antenna. -Increase the separation between the equipment and receiver. -Connect the equipment into an outlet on a circuit different from that to which the receiver is connected. -Consult the dealer or an experienced radio/TV technician for help.

\*RF warning for Mobile device: This equipment complies with FCC radiation exposure limits set forth for an uncontrolled environment. This equipment should be installed and operated with minimum distance 20cm between the radiator & your body.



Scan & See Me!  
www.ishowtree.com