

#0858696



**showlights™**  
Laser Light Projector  
Red & Green(With Remote Control)  
Instruction Manual



LASER RADIATION.  
AVOID DIRECT EYE EXPOSURE.  
DO NOT STARE INTO BEAM OR VIEW  
DIRECTLY WITH OPTICAL INSTRUMENTS.  
CLASS IIIa LASER PRODUCT  
MAX OUTPUT<5 mW  
WAVELENGTHS 520-650 NM

Please only use manufacture  
provided power supply  
Built-in timer function:  
6h ON / 18h OFF

**PACKAGE CONTENTS**

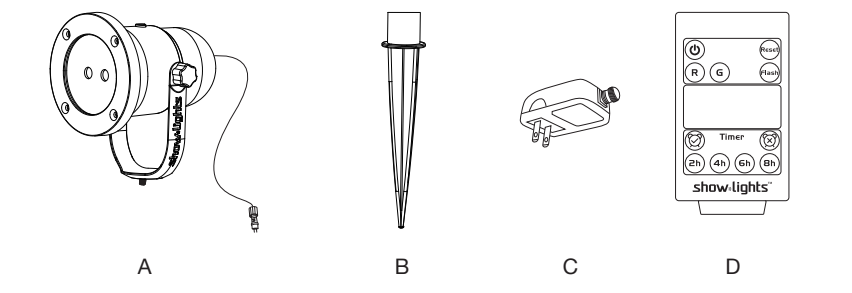

PART	DESCRIPTION	QUANTITY
A	Laser Light Projector	1
B	Ground Stake	1
C	Adapter	1
D	Remote	1

**PRODUCT INSTRUCTIONS**

1. Screw the stake into the holder to secure the projector.

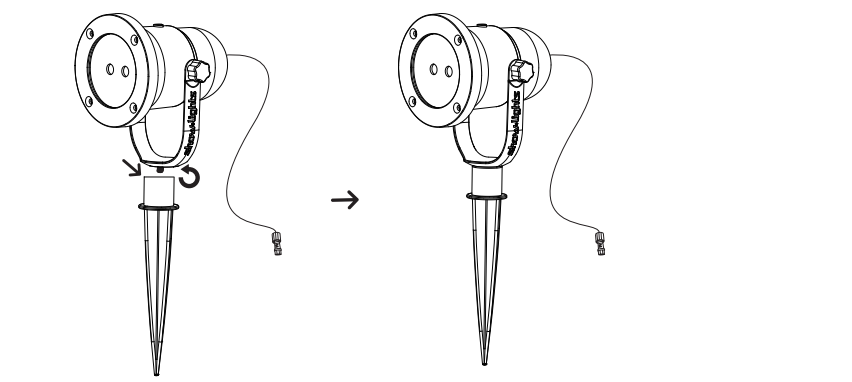

**PRODUCT INSTRUCTIONS**

2. Connect adapter as figure shows.

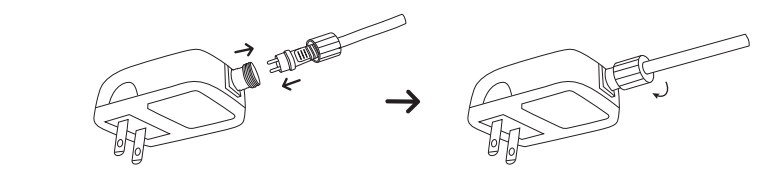

3. Plug power cord into socket, unplug when not in use.

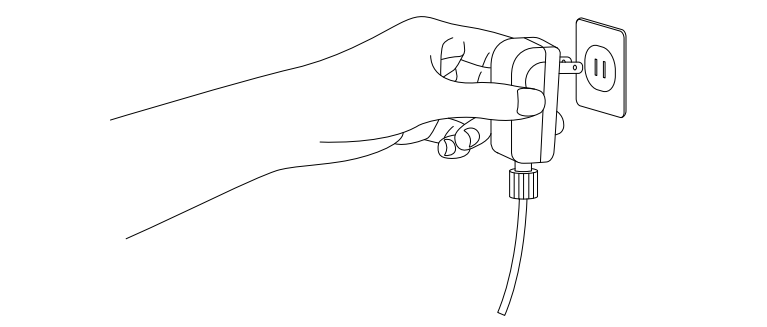

1. Connect the power adapter to the laser light projector.  
The adapter input voltage is AC120V.

- Press the button to switch mode/turn on.
- Press and hold the button to turn off.
- Built-in timer function: 6h On /18h Off.

**PRODUCT SPECIFICATION**

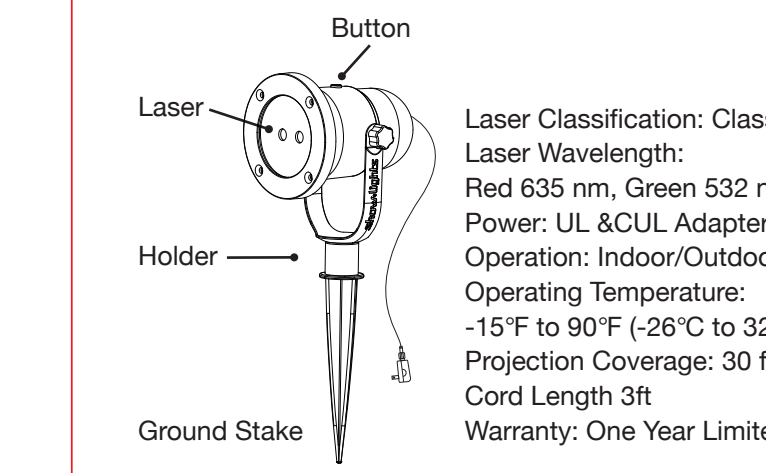

Laser Classification: Class IIIa  
Laser Wavelength:  
Red 635 nm, Green 532 nm  
Power: UL &CUL Adapter 5V, 2A  
Operation: Indoor/Outdoor  
Operating Temperature:  
-15°F to 90°F (-26°C to 32°C)  
Projection Coverage: 30 ft x 30 ft  
Cord Length 3ft  
Warranty: One Year Limited

**BUTTON FUNCTION**

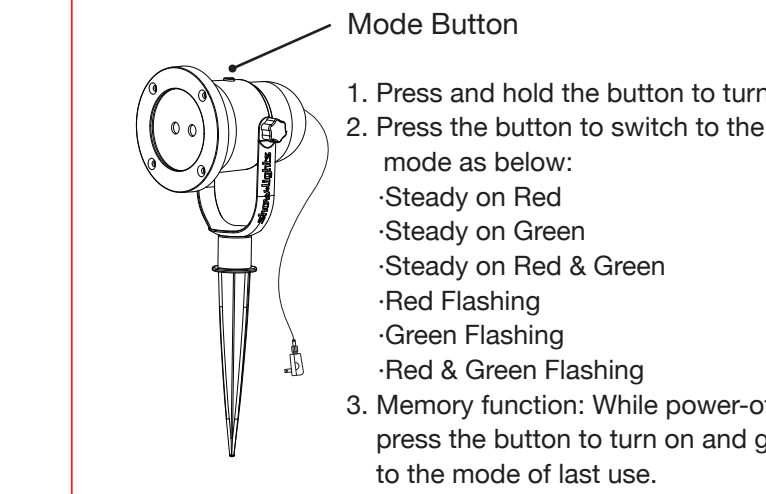

- Press and hold the button to turn off.
- Press the button to switch to the preferred mode as below:  
-Steady on Red  
-Steady on Green  
-Steady on Red & Green  
-Red Flashing  
-Green Flashing  
-Red & Green Flashing
- Memory function: While power-off, short press the button to turn on and get back to the mode of last use.

**REMOTE CONTROL**

1. Remove insulating tape from the battery compartment before use.  
The max receiving distance of this remote is 8 meters.

- Power button: turn on/off.
- Reset button: turn to Default Settings:  
Steady on Red & Green, 6H On /18H Off.
- Red button: switch the red laser On/Off.  
Green button: switch the green laser On/Off.
- Flash button: switch to Steady, flash.
- Timer buttons: setting timer function.  
2h button: set timer, 2H On / 22H Off;  
4h button: set timer, 4H On / 20H Off;  
6h button: set timer, 6H On / 18H Off;  
8h button: set timer, 8H On / 16H Off;  
Cancel button: cancel timer settings.

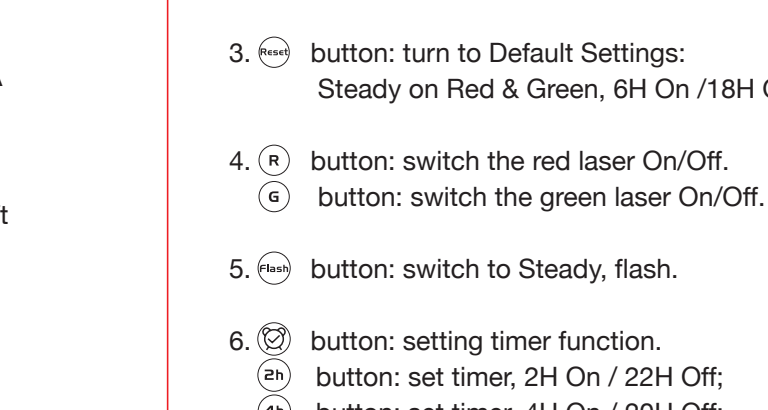

- Battery installation:
- Slide battery cover off.
  - Insert a "CR2025(3 volt)battery.

**REMOTE CONTROL**

- If the remote control does not work, check battery.  
WARNING: This is not a toy and is not intended for use by children.  
(A) Do not dispose of the battery in fire as the battery may leak and explode.  
(B) Do not mix old and new batteries and not mix alkaline, standard (carbon-zinc), or rechargeable(nickel-cadmium)batteries.  
(C) Exhausted batteries are to be removed from the product.  
(D) Dispose of battery properly by following directions on battery.  
(E) Use CR2025 battery only. Use of other batteries may damage remote control  
(F) Safe for indoor use.  
(G)Do not expose the Remote Control to moisture.

**SAFETY INSTRUCTIONS**

- Safety Attention**
- Turn off 30 minutes after working 6 hours to keep the lifetime of product.
  - This product is mainly used for outdoor with waterproof Ip44.  
It has excellent radiating ease. Keep it far away from the flammable objects or liquids.
  - Please use show light laser projector power adapter to support the light. If you need to change a new adapter, please check the parameter of our adapter before you buy a new one.

- CAUTION**
- Danger-laser radiation when open.
  - Avoid direct exposure to beam.
  - Avoid direct eye exposure.
  - Laser radiation-do not stare into beam or view directly with optical instruments.
  - The use of optical instruments with this product will increase eye hazard.
  - Use of controls or adjustments or performance of procedures other than those specified herein may result in hazardous radiation exposure.

**IMPORTANT!**  
\* Do not point the show light laser projector close to the airplane or up in the sky.

**FEDERAL COMMUNICATIONS COMMISSION (FCC) STATEMENT**

**FCC Caution**  
This device complies with part 15 of the FCC Rules. Operation is subject to the following two conditions: (1) This device may not cause harmful interference, and (2) this device must accept any interference received, including interference that may cause undesired operation.

Any Changes or modifications not expressly approved by the party responsible for compliance could void the user's authority to operate the equipment.

**Note:** This equipment has been tested and found to comply with the limits for a Class B digital device, pursuant to part 15 of the FCC Rules. These limits are designed to provide reasonable protection against harmful interference in a residential installation. This equipment generates uses and can radiate radio frequency energy and, if not installed and used in accordance with the instructions, may cause harmful interference to radio communications. However, there is no guarantee that interference will not occur in a particular installation. If this equipment does cause harmful interference to radio or television reception, which can be determined by turning the equipment off and on, the user is encouraged to try to correct the interference by one or more of the following measures:  
-Reorient or relocate the receiving antenna.  
-Increase the separation between the equipment and receiver.  
-Connect the equipment into an outlet on a circuit different from that to which the receiver is connected.  
-Consult the dealer or an experienced radio/TV technician for help.

\*RF warning for Mobile device:  
This equipment complies with FCC radiation exposure limits set forth for an uncontrolled environment. This equipment should be installed and operated with minimum distance 20cm between the radiator & your body.

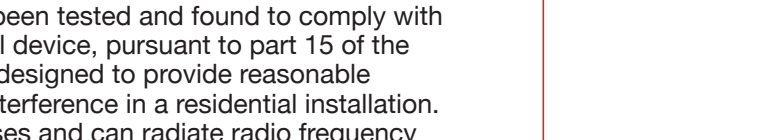

Scan & See Me!  
www.ishowtree.com