

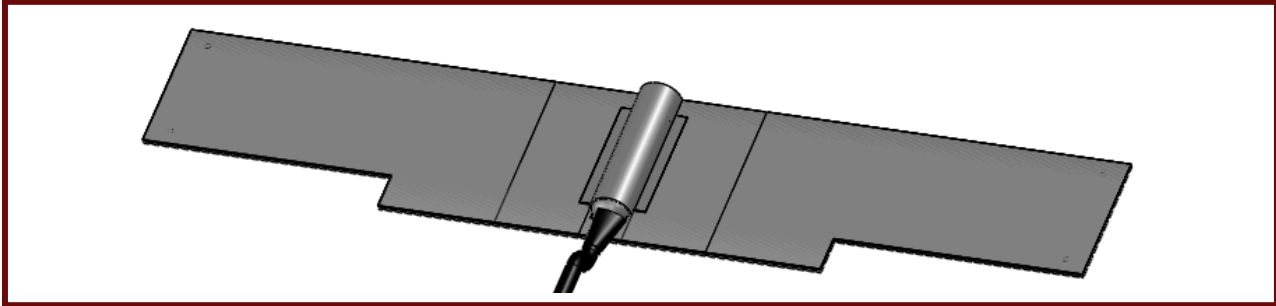

Picture of the Part



Application

The WPANT40015-CB antenna is an aesthetic, efficient coupler antenna for Electric Meters that operates in both 900 MHz and 2.4 GHz ISM Bands. This Antenna works properly on any typical Electric Meter. Standard cable is RG316/RG174 & Straight Type N Female connector.

WP Wireless can assist your engineers to optimize mounting positions for these antennas in your specific application and can further assist to trouble shoot system integration issues such as TRP/TIS and FCC requirements. Please contact sales@wp-wireless.com with your specific application requirements.

Electrical Properties

Parameter	Dual Band Antenna Performance	
	ISM 915 MHz	ISM 2.4 GHz
Operating Frequency [GHz]*	902 ~ 928MHz	2.40 ~ 2.50GHz
Recommended Impedance of the customer Radio Module[Ω]	50 Ohms	
VSWR installed on GE meter*	< 3:1	<3:1
Peak Gain [dBi] (Typical)*	0 to 3 dBi	2 to 3.5 dBi
Efficiency (in %)*	40 to 60 %	40 to 65 %
Polarization	Linear	
Pattern	Near Omni-Directional	
Accepted Power [W] (Max)*	2 watts (+33dBm)	

***Note:** The above mentioned relevant performance metrics are recorded, with the Antenna placed on a typical meter cap/drum.



Mechanical/Environmental Properties

Item	Value
PCB Size	170mm X 32.42mm X 0.25mm
PCB	UL 94-V compliant
PCB Color	10 mils thick, White
Polycarbonate Cover	10 mils thick, Medium Grey
Cable Type	17.5-18" RG316/RG174, Black Color
Connector Type	Type N Female
Operating / Storage Temperature	-40°C to +90°C
Humidity	<75% RH
Pull Strength	Max 1.5Kg/ft
Shock & Vibration	Complies with IEC61169-36 & MIL-STD-202
Environmental	Meets standards for UL 94V-0
Hazardous Materials	RoHS compliant



Drawings of the Antenna

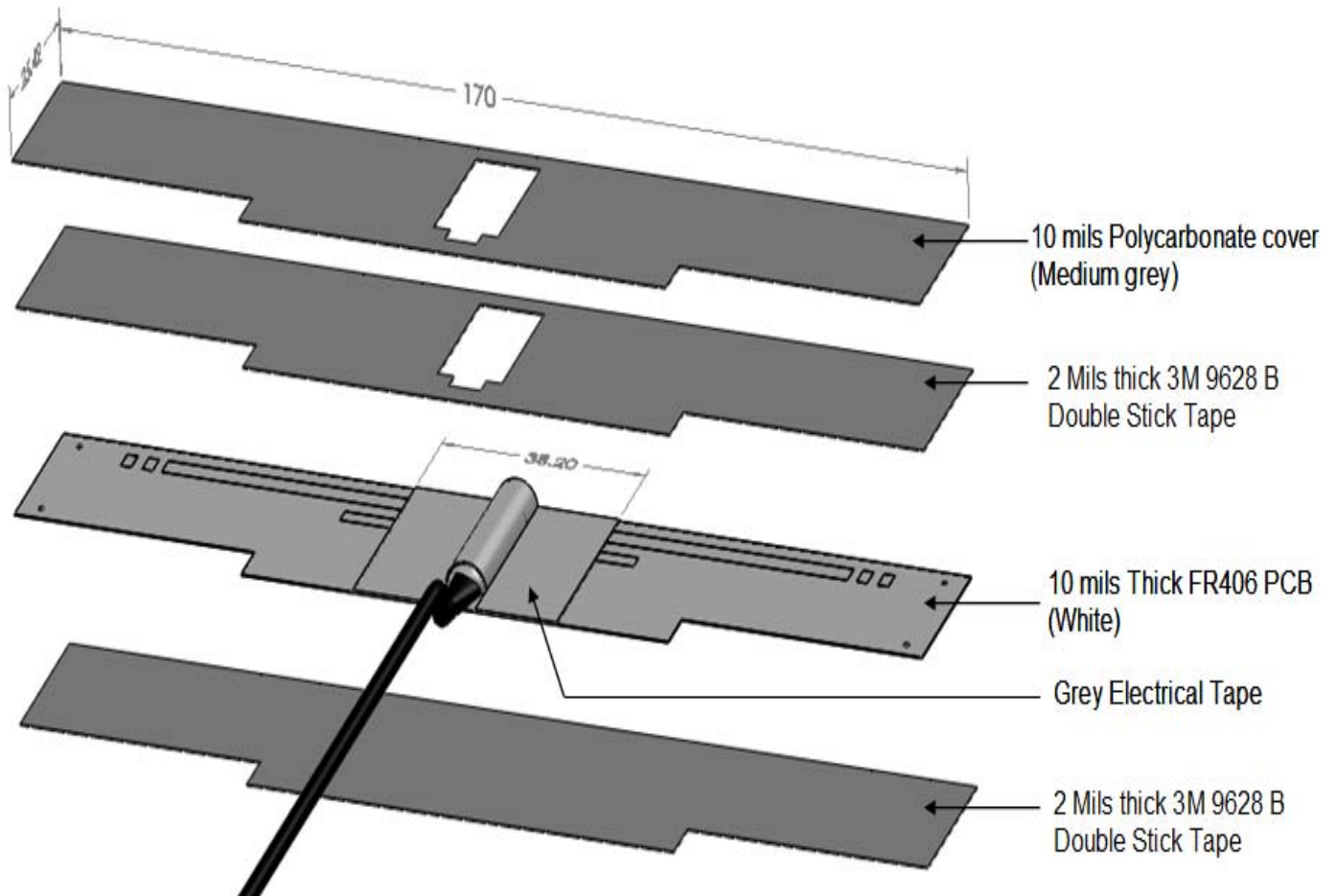



PCB FRONT SIDE VIEW

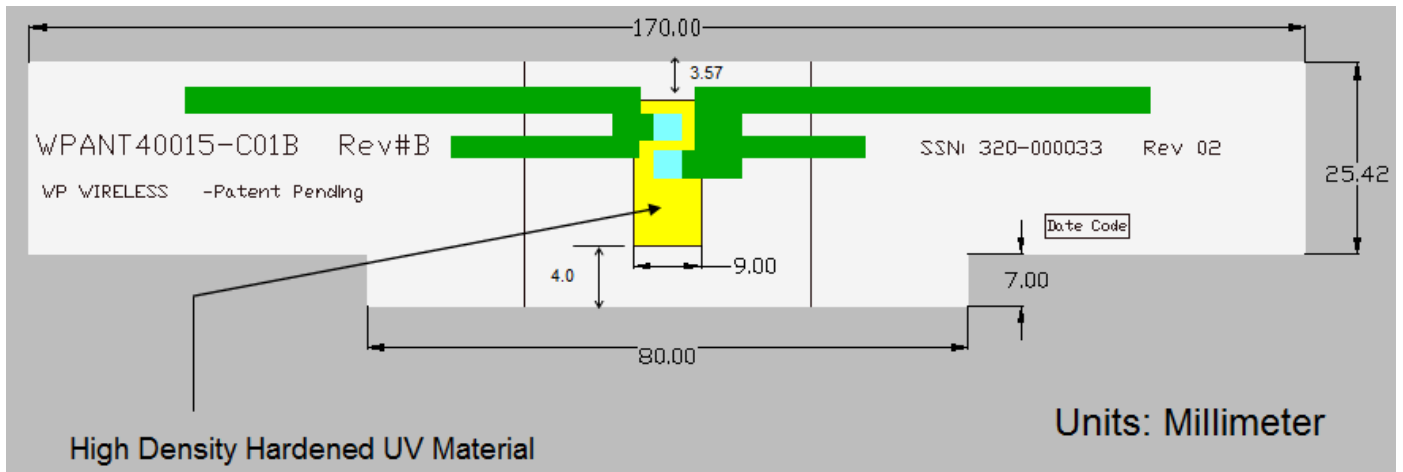

Note: UV Material will not contain any Carbon or Metallic content in it.

10 Mils thick Polycarbonate Cover (Medium Grey)

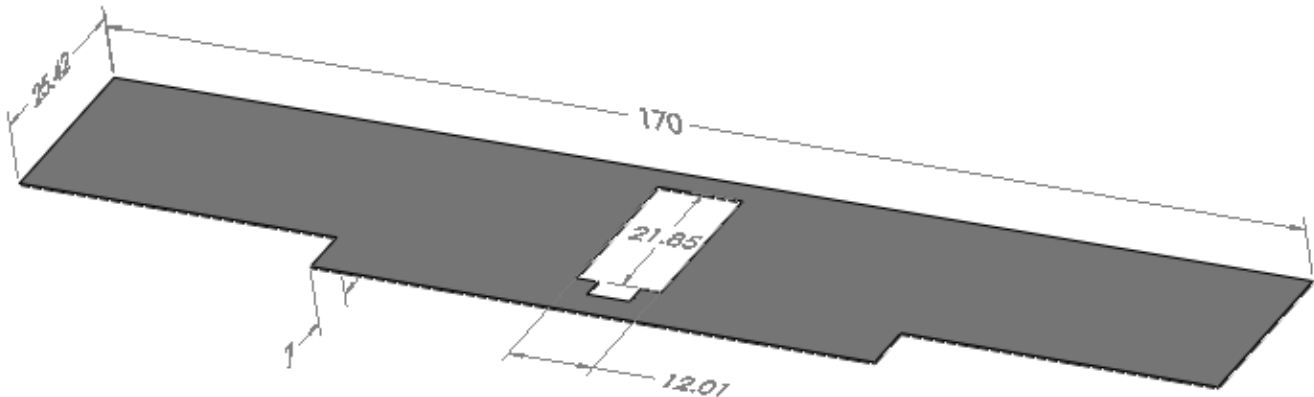

Note: Artwork will be supplied by PG&E (TBD)



WP WIRELESS

PIONEERING TECHNOLOGY
Enabling Your First to Market Vision

WPANT40015-CB

ISM Dual Band Coupler Antenna For Electric Meter

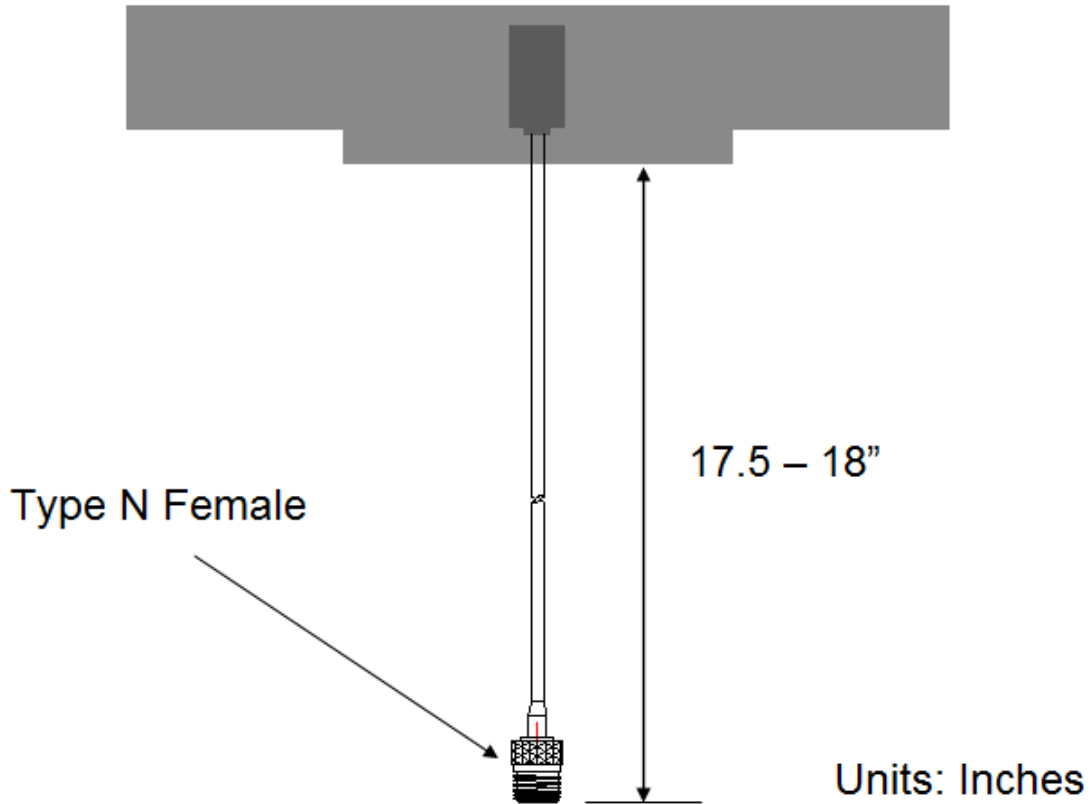

Cable: RG316/RG174
Connector: Type-N Female



Packaging

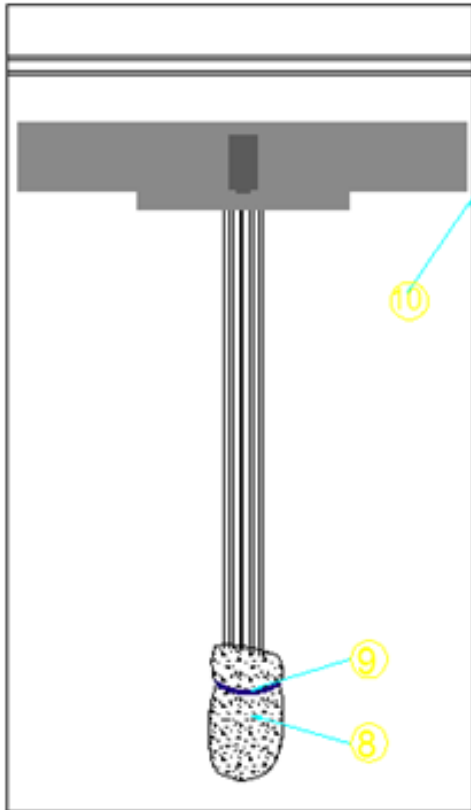

⑩	PE BAG	520*230*T0.05mm	1/20PCS
⑨	RUBBER BAND	COLOR:WHITE	1/20PCS
⑧	PEARL COTTON BAG	COLOR:WHITE 40mm*40mm	1PCS