

WS90t

FEATURES:

- BUILT IN WIRELESS RECEIVER IN EACH SPEAKER
- WIRELESS SIGNAL RANGE UP TO 25 METERS, 50 METERS LINE OF SIGHT.
- NO INTERFERENCE OR DELAYS - AUDIO LATENCY 18MS (MAX)
- WORKS WITH PC AND MAC
- USE ANY SOURCE WITH "LINE OUT" ANALOGUE "OPTICAL" DIGITAL
- IN/OUTPUT VIA 3.5MM MINI JACK
- RF BAND 2.4GHZ/5.2GHZ/5.8GHZ
- DEDICATED PROPRIETARY PROTOCOL
- USB 2.0 INTERFACE
- SAMPLE RATE 48.1 KHZ
- WIRELESS TRANSMITTER
- MULTI-FUNCTION REMOTE CONTROL

SPECIFICATIONS:

ACTIVE LOUDSPEAKER SPECIFICATIONS

POWERED WIRELESS

LOUDSPEAKER SYSTEM

TEXAS INSTRUMENTS DSP &

CLASS D AMPLIFICATION

WIRELESS SOLUTION - STS

TECHNOLOGY (SMSC)

REAR FIRING REFLEX PORT

AMPLIFIER

BI-AMP LF 28W@1% THD

HF 18W@1% THD

HIGH FREQUENCY UNIT

1" 8 OHM SOFT DOME FERRO-FLUID COOLED

LOW FREQUENCY UNIT

4.5" PAPER CONE X 2

FREQUENCY RANGE

45 - 22000HZ (45Hz - 22 KHZ)

CROSSOVER FREQUENCY

3 KHZ (12DB/OCTAVE @2.0KHZ)

DIMENSIONS

H x W x D

859 x 147 x 204

WHAT'S IN THE BOX?

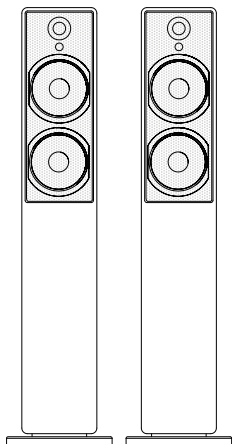

1 X PAIR ACTIVE
LOUDSPEAKERS
– DEDICATED
LEFT AND RIGHT
SPEAKER

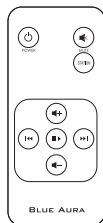

1 X REMOTE
CONTROL

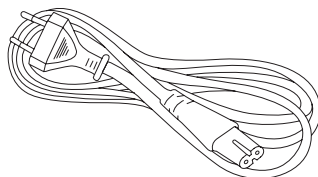

2 X POWER CORDS

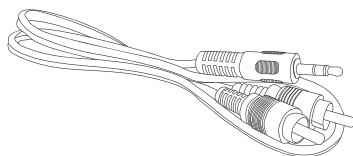

1 X LINE OUT CABLE-
(RCA – MINI JACK)

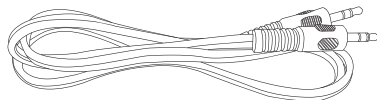

1 X 3.5MM MINI JACK CABLE
(3.5MM MINI JACK – 3.5MM
MINI JACK)



1 X UK ADAPTER (FOR WIRELESS
TRANSMITTER WHERE LINE OUT IS USED)

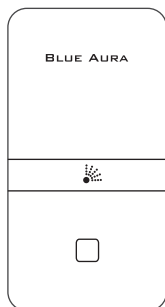

1 X WIRELESS
TRANSMITTER



THE LOUDSPEAKERS ARE COVERED WITH A SOFT FAUX LEATHER MATERIAL. PLEASE TAKE CARE WHEN UNPACKING THE SPEAKERS TO AVOID SCRATCHING OR INDENTING THE MATERIAL.

BEFORE INSTALLING THIS PRODUCT PLEASE READ ALL OF THE INSTRUCTIONS.

THE AMPLIFIER INSIDE THE LOUDSPEAKER HAVE BUILT IN THERMAL AND SHORT CIRCUIT PROTECTION. IF AN AMPLIFIER IS DRIVEN BEYOND ITS POWER OUTPUT CAPABILITIES IT WILL PRODUCE DISTORTED SOUND WHICH MAY DAMAGE YOUR LOUDSPEAKERS. MAKE SURE YOU DO NOT LEAVE YOUR LOUDSPEAKERS UNATTENDED WHEN PLAYING AND REDUCE THE VOLUME AT THE FIRST SIGN OF AUDIBLE DISTORTION. WE RECOMMEND THAT YOU KEEP ALL PACKING UNTIL YOU ARE COMPLETELY SATISFIED WITH YOUR PURCHASE. PLEASE REGISTER YOUR PRODUCT BY COMPLETING THE FORM AT THE BACK OF THIS MANUAL OR BY REGISTERING ON LINE AT WWW.BLUEAURA.CO.UK/REGISTER. IF YOUR PRODUCT WAS PURCHASED OUTSIDE THE UK PLEASE RETURN THIS CARD TO YOUR LOCAL DISTRIBUTOR.

GETTING STARTED

PLACE THE SPEAKERS IN YOUR PREFERRED POSITION BUT WITHIN REACH OF WALL SOCKETS.

LEFT AND RIGHT SPEAKERS CAN BE IDENTIFIED BY LOOKING AT THE REAR OF THE CABINET.

WITH THE MAINS SOCKET IN THE OFF POSITION, CONNECT THE A/C LEAD TO THE SPEAKERS USING ONLY THE SUPPLIED MAINS LEADS AND POWER SUPPLIES. TURN THE MAINS SOCKET ON.

TO USE YOUR SPEAKERS WITH A PC OR MAC

MAC SET-UP

1. INSERT THE USB CONNECTOR FROM THE TRANSMITTER TO A FREE USB SOCKET ON YOUR MAC.
2. GO TO SYSTEM PREFERENCES AND UNDER HARDWARE CHOOSE SOUND.
3. CLICK OUTPUT IN MENU AND CHOOSE USB HEADSET.

PC SET-UP

1. INSERT THE USB CONNECTOR FROM THE TRANSMITTER TO A FREE USB SOCKET ON YOUR PC OR LAPTOP.
2. WAIT UNTIL THE SOFTWARE HAS BEEN INSTALLED, USUALLY A CONFIRMATION BEEP OR MESSAGE WINDOW ALERT.

IF THE ABOVE INSTRUCTIONS DO NOT WORK YOU MAY NEED TO DO THE FOLLOWING.

CLICK START BUTTON ON PC, GO TO THE CONTROL PANEL, AND CHOOSE SOUND & SOUND DEVICES
UNDER PLAYBACK OF AUDIO; DEFAULT UNIT CHOOSE USB HEADSET.

IF YOU ARE STILL HAVING PROBLEMS PLEASE CONTACT
SUPPORT@BLUEAURA.CO.UK.

WIRELESS STATUS

WHEN THE TRANSMITTER IS CONNECTED TO A SOURCE DEVICE THE LED WILL FLASH INTERMITTENTLY

WHEN THE SPEAKERS ARE CONNECTED TO MAINS POWER THE LED ON THE FRONT OF THE SPEAKER WILL LIGHT UP FOR 3 SECONDS THEN POWER OFF.

USING THE REMOTE CONTROL, AIM AT THE ONE OF THE SPEAKERS AND PRESS THE POWER ON BUTTON.

THE SPEAKER WILL AUTOMATICALLY START SEARCHING THROUGH THE CHANNELS

IF A TRANSMITTER IS CONNECTED TO A SOURCE DEVICE THAT IS OPERATIONAL THE SPEAKER WILL LOCK ON, WHICH IS CONFIRMED WHEN THE SPEAKER LED AND TRANSMITTER LED ARE THE SAME COLOUR.

ONCE SET, THE VOLUME MAY NEED TO BE INCREASED WITH THE REMOTE CONTROL

IF THE SPEAKER DOES NOT FIND A CHANNEL (NO WORKING TRANSMITTER) THE SPEAKER WILL POWER OFF.

IN SOME CASES YOU MAY NEED TO FIND A ZONE BY PRESSING THE STATION BUTTON ON THE REAR OF EACH SPEAKER. BY PRESSING THE BUTTON BRIEFLY, THE LED COLOUR ON THE FRONT OF THE SPEAKER CHANGES, PRESS THE BUTTON UNTIL IT MATCHES THE LED COLOUR ON THE TRANSMITTER. IN THIS CASE ENSURE BOTH SPEAKERS FIND THE SAME ZONE. RED, GREEN OR BLUE. THE SPEAKER CAN BE PUT IN STANDBY MODE BY PRESSING THE RED POWER BUTTON ON THE REMOTE CONTROL. THIS WILL TURN OFF THE LED COMPLETELY. TO BRING THE SPEAKER OUT OF STANDBY PRESS THE RED POWER BUTTON AGAIN AND THE VOLUME WILL RETURN TO THE LAST SETTING USED.

IF THE SPEAKER IS TO BE LEFT UNATTENDED FOR PROLONGED PERIODS REMOVE THE PLUG FROM THE BACK OF THE SPEAKER.

IF NO SIGNAL IS BEING RECEIVED FROM A TRANSMITTER THE SPEAKER WILL GO INTO SEARCH MODE. IF NO SIGNAL IS FOUND AFTER TEN MINUTES THE SPEAKER WILL POWER OFF.

IF A SIGNAL IS FOUND WITHIN THAT TIME IT WILL LOCK ON AUTOMATICALLY. THE SPEAKER CAN BE RESET TO DEFAULT SETTING AT ANY TIME BY POWERING ON THEN HOLDING THE YELLOW MUTE BUTTON FOR MORE THAN 5 SECONDS, THE LED WILL FLASH INTERMITTENTLY THEN POWER OFF. WHEN POWERING ON THE SYSTEM IT WILL BE IN THE DEFAULT SETTING.

TO USE YOUR SPEAKERS WITH OTHER DEVICES (RCA CONNECTION)

THE TRANSMITTER NEEDS TO BE POWERED; BY USING THE USB CONNECTOR ON A PC FOR EXAMPLE, POWER IS PROVIDED.

TO USE THE TRANSMITTER WITH EQUIPMENT THAT DOES NOT HAVE A USB SOCKET THE MAINS ADAPTER IS REQUIRED.

CONNECT THE USB CONNECTOR FROM THE TRANSMITTER TO THE USB SOCKET ON THE SUPPLIED MAINS ADAPTER.

USING THE "LINE OUT" CABLE PROVIDED, PLUG THE RED AND WHITE PLUGS (RCA) INTO YOUR DEVICE WITH LINE OUT, E.G. CD PLAYER OR TV, CONNECT THE OTHER END OF THE CABLE (MINI JACK) TO THE TRANSMITTER.

PLUG THE ADAPTER INTO TO A CONVENIENT WALL SOCKET AND TURN ON.

PUSH THE BUTTON IN THE CENTRE OF THE TRANSMITTER TO SELECT A FREE ZONE.

USING THE REMOTE CONTROL PRESS THE "STATION" BUTTON" TO FIND THE SIGNAL FROM THE NEW SOURCE EQUIPMENT.

TO USE YOUR SPEAKERS WITH MP3 DEVICES (HEADPHONE OUT)

PLUG ONE END OF THE SUPPLIED 3.5MM MINI JACK LEAD INTO THE TRANSMITTER AND THE OTHER END INTO THE HEADPHONE SOCKET ON YOUR DEVICE.

PLUG THE USB CONNECTOR FROM THE TRANSMITTER INTO THE MAINS ADAPTER AND PLUG THE MAINS ADAPTER INTO A CONVENIENT WALL SOCKET AND TURN ON. PUSH THE BUTTON IN THE CENTRE OF THE TRANSMITTER TO SELECT A FREE ZONE. USING THE REMOTE CONTROL PRESS THE “STATION” BUTTON” TO FIND THE SIGNAL FROM THE NEW SOURCE EQUIPMENT.

....WIRELESS SOUND FROM MULTIPLE DEVICES

BY ADDING MORE TRANSMITTERS (OPTIONAL), THE AUDIO NETWORK CAN BY SEPARATED INTO 3 HOUSE CODES ALLOWING MULTIPLE DEVICES TO BE USED TO PLAY MUSIC THROUGH YOUR WS90T SPEAKERS.

SOME EXAMPLES OF USING MULTIPLE DEVICES WITH ONE PAIR OF WS90T SPEAKERS.



....ADD MORE WS90T SPEAKERS TO THE AUDIO NETWORK

LIMITLESS NUMBERS OF WS90T SPEAKERS CAN BE ADDED TO YOUR SYSTEM WITHIN WIRELESS RANGE OF THE TRANSMITTER. YOU CAN ADD MORE SPEAKERS TO ONE ROOM, OR ADD SPEAKERS IN SEVERAL ROOMS.

REMOTE CONTROL

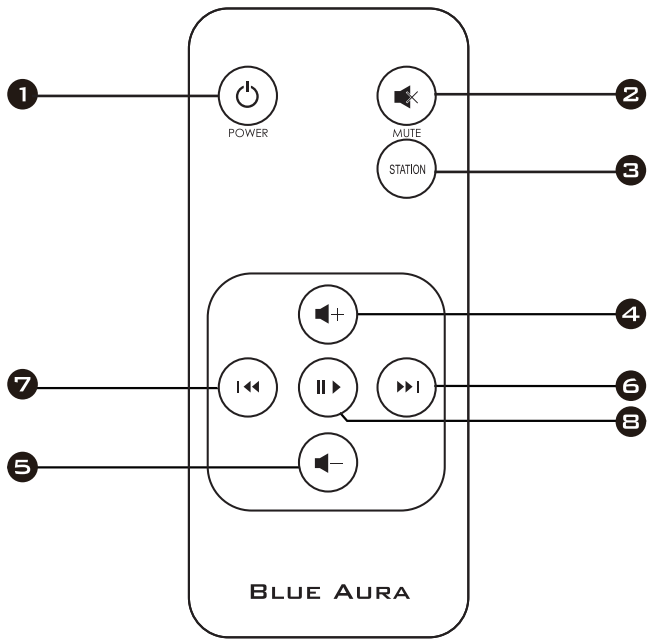

1 POWER ON/OFF

2 MUTE

3 STATION

4 VOL+

5 VOL-

6 SKIP

7 BACK SKIP

8 PLAY/PAUSE

REAR PANEL

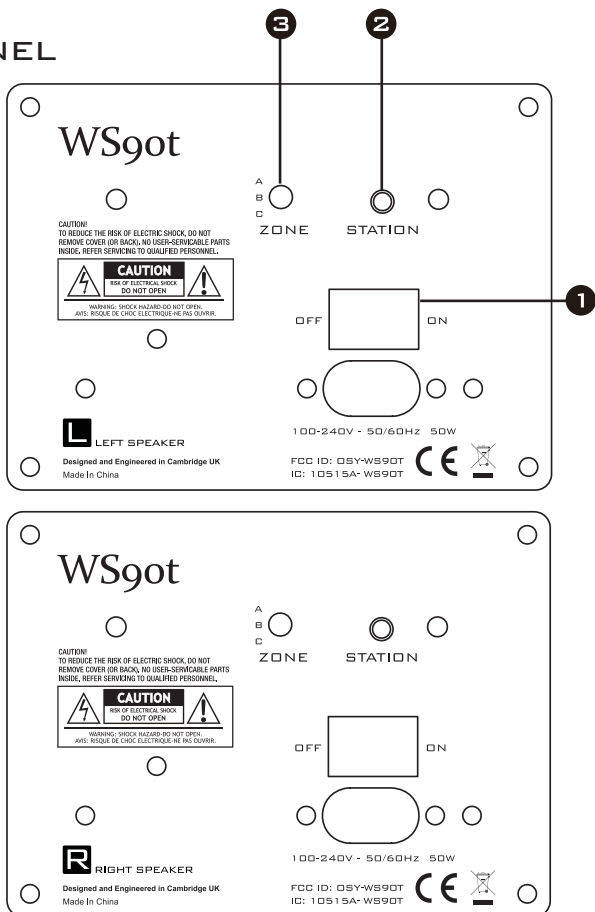

- 1** POWER
- 2** STATION
SWITCH STATION BY PRESSING THIS BUTTON
- 3** ZONE SWITCH
SWITCH ZONE BY LEVER SWITCH

MULTI-ZONE FUNCTION

THE WS90Ti SYSTEM IS FACTORY SET TO DEFAULT MODE.

IN DEFAULT MODE; IF MORE WS90Ti'S ARE ADDED TO THE NETWORK, THE REMOTE WILL CONTROL ALL SPEAKERS WITHIN THE NETWORK SIMULTANEOUSLY, IF WITHIN TRANSMITTER RANGE.

BY USING THE MULTI ZONE FEATURE ON THE REMOTE CONTROL, VOLUME AND SOURCE SELECTION CAN BE INDEPENDENTLY CONTROLLED FOR EACH ZONE. THE SAME SOURCE DEVICE SERVING DIFFERENT ZONES.

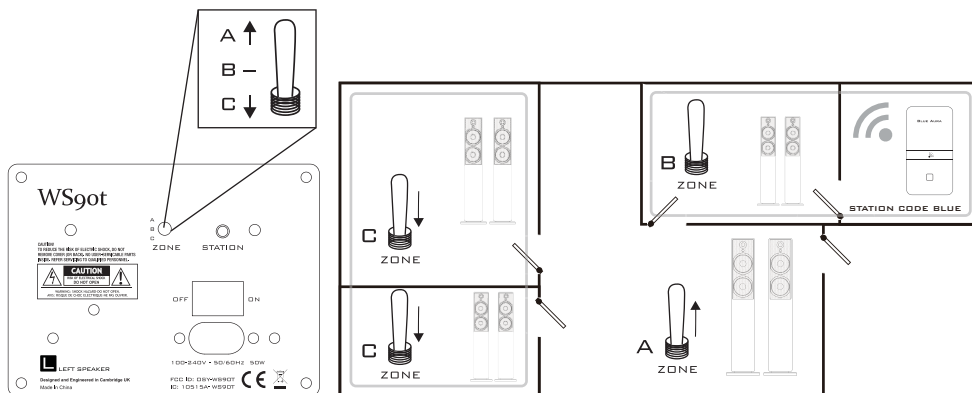

TO ENABLE MULTI ZONE FEATURE

TO SET MULTI- ZONE - POWER ON THE SYSTEM BY PRESSING THE RED BUTTON ON THE REMOTE CONTROL. PRESS AND HOLD DOWN THE ZONE TO BE SET (A B OR C) WITHIN TEN SECONDS OF POWERING ON.

HOLD DOWN THE DESIRED ZONE BUTTON (A B OR C) FOR MORE THAN 5 SECONDS. THE LED WILL BLINK WHEN THE ZONE HAS BEEN SET. REPEAT THE PROCESS FOR THE SPEAKERS IN ANOTHER ZONE AND CHOOSE ANOTHER ZONE BUTTON.

TIP! THIS FUNCTION CAN ALSO BE USED ON ONE SET OF SPEAKERS TO ALLOW LEFT / RIGHT SPEAKER BALANCE TO BE CONTROLLED. FOLLOW THE INSTRUCTIONS ABOVE BUT SET ONE SPEAKER AT A TIME.

THE VOLUME OF THE SPEAKERS IN EACH ZONE CAN NOW BE INDEPENDENTLY CONTROLLED.

THE SPEAKER CAN BE RESET TO DEFAULT SETTING AT ANY TIME BY POWERING ON, THEN HOLDING THE YELLOW MUTE BUTTON FOR MORE THAN 5 SECONDS, THE LED WILL FLASH INTERMITTENTLY THEN POWER OFF. THE SPEAKER WILL BE IN THE DEFAULT SETTING WHEN NEXT TURNED ON.

DEFAULT MODE CAN ALSO BE SET BY HOLDING DOWN THE STATION BUTTON ON THE BACK OF THE SPEAKER FOR MORE THAN 5 SECONDS AFTER TURNING THE SPEAKER ON.

PRODUCT REGISTRATION

(ADDRESS ON BACK COVER)

MODEL
SERIAL NUMBER
DATE OF PURCHASE

CUSTOMER DETAILS

NAME
ADDRESS LINE 1
ADDRESS LINE 2
TOWN
COUNTRY
POSTCODE/ZIP CODE
TELEPHONE

DEALER DETAILS

DEALER NAME
ADDRESS LINE 1
ADDRESS LINE 2
TOWN
COUNTY
POSTCODE
COUNTRY



CAUTION: TO REDUCE THE RISK OF ELECTRIC SHOCK, DO NOT REMOVE COVER. NO USER SERVICEABLE PARTS INSIDE. REFER SERVICING TO QUALIFIED SERVICE PERSONNEL

WARNING: TO REDUCE THE RISK OF ELECTRIC SHOCK, DO NOT EXPOSE THIS APPLIANCE TO RAIN OR MOISTURE.



THE LIGHTNING FLASH WITH ARROWHEAD SYMBOL, WITHIN AN EQUILATERAL TRIANGLE, IS INTENDED TO ALERT THE USER TO THE PRESENCE OF INSULATED “DANGEROUS VOLTAGE” WITHIN THE PRODUCT’S ENCLOSURE THAT MAY BE OF SUFFICIENT MAGNITUDE TO CONSTITUTE A RISK OF ELECTRIC SHOCK TO PERSONS.



THE EXCLAMATION POINT WITHIN AN EQUILATERAL TRIANGLE IS INTENDED TO ALERT THE USER TO THE PRESENCE OF IMPORTANT OPERATING AND MAINTENANCE INSTRUCTIONS IN THE LITERATURE ACCOMPANYING THE APPLIANCE.



CLASS II PRODUCT

DOUBLE INSULATED OR CLASS 2 ELECTRICAL APPLIANCES ARE PRODUCTS THAT HAVE BEEN DESIGNED IN A WAY SO AS NOT TO REQUIRE A SAFETY CONNECTION TO ELECTRICAL EARTH (THESE PRODUCTS MUST NOT HAVE A SAFETY CONNECTION TO EARTH).

IMPORTANT SAFETY INSTRUCTIONS

01. READ THESE INSTRUCTIONS.

02. KEEP THESE INSTRUCTIONS.

03. HEED ALL WARNINGS.

04. FOLLOW ALL INSTRUCTIONS.

05. DO NOT USE APPARATUS NEAR WATER.

06. CLEAN ONLY WITH A DRY CLOTH.

07. DO NOT BLOCK ANY VENTILATION OPENINGS. INSTALL IN ACCORDANCE WITH THE MANUFACTURER'S INSTRUCTIONS.

08. DO NOT INSTALL NEAR ANY HEAT SOURCES SUCH AS RADIATORS, HEAT REGISTERS, STOVES, OR OTHER APPARATUS (INCLUDING AMPLIFIERS) THAT PRODUCE HEAT.

09. PROTECT THE POWER CORD FROM BEING WALKED ON OR PINCHED PARTICULARLY AT PLUGS, CONVENIENCE RECEPTACLES, AND THE POINT WHERE THEY EXIT FROM THE APPARATUS.

10. ONLY USE ATTACHMENTS/ACCESSORIES SPECIFIED BY THE MANUFACTURER.

11. UNPLUG THIS APPARATUS DURING LIGHTNING STORMS OR WHEN UNUSED FOR LONG PERIODS OF TIME.

12. REFER ALL SERVICING TO QUALIFIED SERVICE PERSONNEL. SERVICING IS REQUIRED WHEN THE APPARATUS HAS BEEN DAMAGED IN ANY WAY, SUCH AS POWER-SUPPLY CORD OR PLUG IS DAMAGED, LIQUID HAS BEEN SPILLED OR OBJECTS HAVE FALLEN INTO THE APPARATUS, THE APPARATUS HAS BEEN EXPOSED TO RAIN OR MOISTURE, DOES NOT OPERATE NORMALLY, OR HAS BEEN DROPPED.

13. DAMAGE REQUIRING SERVICE

UNPLUG THE APPARATUS FROM THE WALL OUTLET AND REFER SERVICING TO QUALIFIED SERVICE PERSONNEL UNDER THE FOLLOWING CONDITIONS:

A. WHEN THE POWER-SUPPLY CORD OR PLUG IS DAMAGED,

B. IF LIQUID HAS BEEN SPILLED, OR OBJECTS HAVE FALLEN INTO THE APPARATUS,

C. IF THE APPARATUS HAS BEEN EXPOSED TO RAIN OR WATER,

IMPORTANT SAFETY INSTRUCTIONS

13. DAMAGE REQUIRING SERVICE

D IF THE APPARATUS DOES NOT OPERATE NORMALLY BY FOLLOWING THE OPERATING INSTRUCTIONS. ADJUST ONLY THOSE CONTROLS THAT ARE COVERED BY THE OPERATING INSTRUCTIONS AS AN IMPROPER ADJUSTMENT OF OTHER CONTROLS MAY RESULT IN DAMAGE AND WILL OFTEN REQUIRE EXTENSIVE WORK BY A QUALIFIED TECHNICIAN TO RESTORE THE APPARATUS TO ITS NORMAL OPERATION.

E. IF THE APPARATUS HAS BEEN DROPPED OR DAMAGED IN ANY WAY, AND.

F. WHEN THE APPARATUS EXHIBITS A DISTINCT CHANGE IN PERFORMANCE THIS INDICATES A NEED FOR SERVICE.

14. OBJECT AND LIQUID ENTRY.

NEVER PUSH OBJECTS OF ANY KIND INTO THE APPARATUS THROUGH OPENINGS AS THEY MAY TOUCH DANGEROUS VOLTAGE POINTS OR SHORT-OUT PARTS THAT COULD RESULT IN A FIRE OR ELECTRIC SHOCK. THE APPARATUS SHALL NOT BE EXPOSED TO DRIPPING OR SPLASHING AND NO OBJECTS FILLED WITH LIQUIDS, SUCH AS VASES SHALL BE PLACED ON THE APPARATUS. DON'T PUT CANDLES OR OTHER BURNING OBJECTS ON TOP OF THIS UNIT.

ALWAYS CONSIDER THE ENVIRONMENTAL ISSUES AND FOLLOW LOCAL REGULATIONS WHEN DISPOSING OF BATTERIES.

15 ALWAYS CONSIDER THE ENVIRONMENTAL ISSUES AND FOLLOW LOCAL REGULATIONS WHEN DISPOSING OF BATTERIES.

16. IF YOU INSTALL THE APPARATUS IN A BUILT-IN INSTALLATION, SUCH AS A BOOKCASE OR RACK, ENSURE THAT THERE IS ADEQUATE VENTILATION. LEAVE 20 CM (8") OF FREE SPACE AT THE TOP AND SIDES AND 10CM (4") AT THE REAR. THE REAR EDGE OF THE SHELF OR BOARD ABOVE THE APPARATUS SHALL BE SET 10 CM (4") AWAY FROM THE REAR PANEL OR WALL, CREATING A FLUE-LIKE GAP FOR WARM AIR TO ESCAPE.

17. THE POWER SUPPLY AND POWER CORD FOR THIS APPARATUS IS INTENDED FOR INDOOR USE ONLY.

18. ONLY USE THE ENCLOSED AC ADAPTOR.

DESIGNED, ENGINEERED AND SUPPORTED IN THE UK

FCC COMPLIANCE

THIS DEVICE COMPLIES WITH PART 15 OF THE FCC RULES. OPERATION IS SUBJECT TO THE FOLLOWING TWO CONDITIONS: (1) THIS DEVICE MAY NOT CAUSE HARMFUL INTERFERENCE, AND (2) THIS DEVICE MUST ACCEPT ANY INTERFERENCE RECEIVED, INCLUDING INTERFERENCE THAT MAY CAUSE UNDESIRE^D OPERATION.

CHANGES OR MODIFICATIONS NOT EXPRESSLY APPROVED BY THE PARTY RESPONSIBLE FOR COMPLIANCE COULD VOID THE USER'S AUTHORITY TO OPERATE THE EQUIPMENT.

THIS EQUIPMENT HAS BEEN TESTED AND FOUND TO COMPLY WITH THE LIMITS FOR A CLASS B DIGITAL DEVICE, PURSUANT TO PART 15 OF THE FCC RULES. THESE LIMITS ARE DESIGNED TO PROVIDE REASONABLE PROTECTION AGAINST HARMFUL INTERFERENCE IN A RESIDENTIAL INSTALLATION. THIS EQUIPMENT GENERATES USES AND CAN RADIATE RADIO FREQUENCY ENERGY AND, IF NOT INSTALLED AND USED IN ACCORDANCE WITH THE INSTRUCTIONS, MAY CAUSE HARMFUL INTERFERENCE TO RADIO COMMUNICATIONS. HOWEVER, THERE IS NO GUARANTEE THAT INTERFERENCE WILL NOT OCCUR IN A PARTICULAR INSTALLATION. IF THIS EQUIPMENT DOES CAUSE HARMFUL INTERFERENCE TO RADIO OR TELEVISION RECEPTION, WHICH CAN BE DETERMINED

BY TURNING THE EQUIPMENT OFF AND ON, THE USER IS ENCOURAGED TO TRY TO CORRECT THE INTERFERENCE BY ONE OR MORE OF THE FOLLOWING MEASURES:

—REDIRECT OR RELOCATE THE RECEIVING ANTENNA.

—INCREASE THE SEPARATION BETWEEN THE EQUIPMENT AND RECEIVER.

—CONNECT THE EQUIPMENT INTO AN OUTLET ON A CIRCUIT DIFFERENT FROM THAT TO WHICH THE RECEIVER IS CONNECTED.

—CONSULT THE DEALER OR AN EXPERIENCED RADIO/TV TECHNICIAN FOR HELP.

THE TRANSMITTER OF THIS DEVICE HAS BEEN DESIGNED TO OPERATE WITH THE ATTACHED ANTENNAS, AND HAVING A MAXIMUM GAIN OF 1.5DBI. ANTENNAS NOT IDENTICAL AS THAT OR HAVING A GAIN GREATER THAN 1.5DBI ARE STRICTLY PROHIBITED FOR USE WITH THIS DEVICE. THE REQUIRED ANTENNA IMPEDANCE IS 50 OHMS. TO REDUCE POTENTIAL RADIO INTERFERENCE TO OTHER USERS, THE ANTENNA TYPE AND ITS GAIN SHOULD BE SO CHOSEN THAT THE EQUIVALENT ISOTROPICALLY RADIATED POWER (E.I.R.P.) IS NOT MORE THAN THAT PERMITTED FOR SUCCESSFUL COMMUNICATION

FCC RF EXPOSURE REQUIREMENTS (MPE)

TO SATISFY FCC RF EXPOSURE REQUIREMENTS, A SEPARATION DISTANCE OF 20 CM OR MORE SHOULD BE MAINTAINED BETWEEN THE ANTENNA OF THIS DEVICE AND PERSONS DURING DEVICE OPERATION.

TO ENSURE COMPLIANCE, OPERATIONS AT CLOSER THAN THIS DISTANCE IS NOT RECOMMENDED.

LES ANTENNES INSTALLÉES DOIVENT ÊTRE SITUÉES DE FAÇON À CE QUE LA POPULATION NE PUISSE Y ÊTRE EXPOSÉE À

UNE DISTANCE DE MOINS DE 20 CM. INSTALLER LES ANTENNES DE FAÇON À CE QUE LE PERSONNEL NE PUISSE APPROCHER À 20 CM OU MOINS DE LA POSITION CENTRALE DE L' ANTENNE.

LA FCC DES ÉTATS-UNIS STIPULE QUE CET APPAREIL DOIT ÊTRE EN TOUT TEMPS ÉLOIGNÉ D'AU MOINS 20 CM DES PERSONNES PENDANT SON FONCTIONNEMENT.

UNDER INDUSTRY CANADA REGULATIONS, THIS RADIO TRANSMITTER MAY ONLY OPERATE USING AN ANTENNA OF A TYPE AND MAXIMUM (OR LESSER) GAIN APPROVED FOR THE TRANSMITTER BY INDUSTRY CANADA. TO REDUCE POTENTIAL RADIO INTERFERENCE TO OTHER USERS, THE ANTENNA TYPE

AND ITS GAIN SHOULD BE SO CHOSEN THAT THE EQUIVALENT ISOTROPICALLY RADIATED POWER (E.I.R.P.) IS NOT MORE THAN THAT NECESSARY FOR SUCCESSFUL COMMUNICATION.

CONFORMÉMENT À LA RÉGLEMENTATION D'INDUSTRIE CANADA, LE PRÉSENT ÉMETTEUR RADIO PEUT

FONCTIONNER AVEC UNE ANTENNE D'UN TYPE ET D'UN GAIN MAXIMAL (OU INFÉRIEUR) APPROUVÉ POUR L'ÉMETTEUR PAR INDUSTRIE CANADA. DANS LE BUT DE RÉDUIRE LES RISQUES DE BROUILLAGE RADIOÉLECTRIQUE À L'INTENTION DES AUTRES UTILISATEURS, IL FAUT CHOISIR LE TYPE D'ANTENNE ET SON GAIN DE SORTE QUE LA PUISSANCE ISOTROPE RAYONNÉE ÉQUIVALENTE (P.I.R.E.) NE DÉPASSE PAS L'INTENSITÉ NÉCESSAIRE À L'ÉTABLISSEMENT D'UNE COMMUNICATION SATISFAISANTE.

THIS DEVICE COMPLIES WITH INDUSTRY CANADA LICENCE-EXEMPT
RSS-210 STANDARDS. OPERATION IS SUBJECT TO THE FOLLOWING TWO
CONDITIONS: (1) THIS DEVICE MAY NOT CAUSE INTERFERENCE, AND (2)
THIS DEVICE MUST ACCEPT ANY INTERFERENCE, INCLUDING
INTERFERENCE THAT MAY CAUSE UNDESIRE OPERATION OF THE
DEVICE.

LE PRÉSENT APPAREIL EST CONFORME AUX CNR-210 D'INDUSTRIE
CANADA APPLICABLES AUX APPAREILS RADIO EXEMPTS DE LICENCE.
L'EXPLOITATION EST AUTORISÉE AUX DEUX CONDITIONS SUIVANTES :
(1) L'APPAREIL NE DOIT PAS PRODUIRE DE BROUILLAGE, ET (2)
L'UTILISATEUR DE L'APPAREIL DOIT ACCEPTER TOUT BROUILLAGE
RADIOÉLECTRIQUE SUBI, MÊME SI LE BROUILLAGE EST SUSCEPTIBLE
D'EN COMPROMETTRE LE FONCTIONNEMENT.

BLUE AURA WORLDWIDE GUARANTEE

THIS ENTITLES YOU TO HAVE THE UNIT REPAIRED FREE OF CHARGE, DURING THE FIRST TWO YEARS AFTER PURCHASE, AT ANY AUTHORISED BLUE AURA DISTRIBUTOR PROVIDED THAT IT WAS ORIGINALLY PURCHASED FROM AN AUTHORISED BLUE AURA DEALER OR DISTRIBUTOR. THE MANUFACTURER CAN TAKE NO RESPONSIBILITY FOR DEFECTS ARISING FROM ACCIDENT, MISUSE, ABUSE, WEAR AND TEAR, NEGLIGENCE OR THROUGH UNAUTHORISED ADJUSTMENT AND/OR REPAIR, NEITHER CAN THEY ACCEPT RESPONSIBILITY FOR DAMAGE OR LOSS OCCURRING DURING TRANSIT TO OR FROM THE PERSON CLAIMING UNDER THE GUARANTEE.

THE WARRANTY COVERS:

PARTS AND LABOUR COSTS FOR TWO YEARS FROM THE PURCHASE DATE. AFTER TWO YEARS YOU MUST PAY FOR BOTH PARTS AND LABOUR COSTS, THE WARRANTY DOES NOT COVER TRANSPORTATION COSTS AT ANY TIME.

CLAIMS UNDER GUARANTEE

THIS EQUIPMENT SHOULD BE PACKED IN THE ORIGINAL PACKING AND RETURNED TO THE DEALER FROM WHOM IT WAS PURCHASED, OR FAILING THIS, DIRECTLY TO THE BLUE AURA DISTRIBUTOR IN THE COUNTRY OF RESIDENCE. IT SHOULD BE SENT CARRIAGE PREPAID BY A REPUTABLE CARRIER. NO RESPONSIBILITY CAN BE ACCEPTED FOR THE UNIT WHILST IN TRANSIT TO THE DEALER OR DISTRIBUTOR AND CUSTOMERS ARE THEREFORE ADVISED TO INSURE THE UNIT AGAINST LOSS OR DAMAGE WHILST IN TRANSIT.

FOR FURTHER DETAILS CONTACT BLUE AURA AT:

BLUE AURA CUSTOMER SUPPORT,
01480 477738
OR EMAIL SUPPORT@BLUEAURA.CO.UK.

PROBLEMS?

IF YOUR BLUE AURA DEALER IS UNABLE TO ANSWER ANY QUERY REGARDING THIS OR ANY OTHER BLUE AURA PRODUCT PLEASE CONTACT BLUE AURA CUSTOMER SUPPORT AT THE ABOVE ADDRESS AND WE WILL DO OUR BEST TO HELP YOU.

BLUE AURA RESERVES THE RIGHT TO CHANGE ALL SPECIFICATIONS WITHOUT NOTICE. (E & OE)



BLUE AURA
PROFESSIONAL AUDIO

BLUE AURA
PO BOX 293
ST NEOTS
PE19 9EW

