

# EWS-10R EWS-10T Owner's Manual

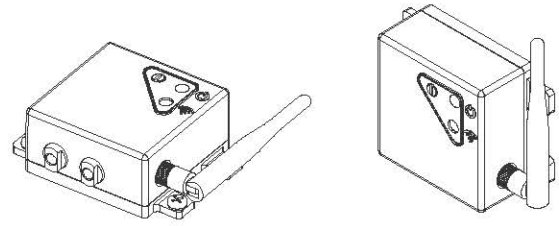

- 1 COMPOSITION
- 2 INSTALLATION
- 3 CONNECTION WIRING
- 4 HOW TO DO PAIRING
- 5 FEATURES
- 6 SPECIFICATIONS

## CAUTION BEFORE USAGE

1. PLEASE USE THE PRODUCT AFTER READING THE MANUAL CAREFULLY FOR SAFE USAGE. PLEASE INSTALL AND USE THE PRODUCT AFTER FULLY AWARE OF THE MANUAL AND PRECAUTION.
2. ASK EXPERIENCED TECHNICIAN FOR PRODUCT INSTALLATION. INSTALLATION SHOULD BE DONE BY THE TECHNICIAN DUE TO PROFESSIONAL SKILLS AND EXPERIENCE IS REQUIRED.
3. DO NOT INSTALL, OPEN OR MODIFY THE PRODUCT RANDOMLY. IT CAN CAUSE PRODUCT MALFUNCTION, ELECTRIC SHOCK, FIRE AND ALSO WATERPROOF PROBLEM FOR WATERPROOF PRODUCT. CONTACT THE SERVICE CENTER AND ASK FOR A/S, IF REPAIRS ARE NECESSARY.
4. USE REGULATED VOLTAGE. PROTECTION CIRCUIT IS BUILT INSIDE BUT OVER VOLTAGE USAGE CAN CAUSE DAMAGE TO THE PRODUCT. MANUFACTURER WILL NOT TAKE RESPONSIBILITY FOR THE PRODUCT MALFUNCTION CAUSED BY OVER VOLTAGE.
5. DO NOT DROP OR GIVE EXTERNAL SHOCK TO THE PRODUCT. THE PRODUCT SCREEN OR EXTERIOR CAN BE DAMAGED AND CAUSE MALFUNCTION OF THE INTERNAL PARTS. IN THIS CASE NORMAL CUSTOMER SUPPORT AND A/S CAN'T BE RECEIVED.
6. CONNECT THE MAIN POWER AFTER INSTALLATION. IT CAN CAUSE PRODUCT MALFUNCTION, FIRE AND ELECTRIC SHOCK.
7. USE AUTHORIZED ACCESSORY & COMPONENTS. USING UNAUTHORIZED ACCESSORY & COMPONENTS CAN CAUSE PRODUCT MALFUNCTION AND THE MANUFACTURER WILL NOT TAKE RESPONSIBILITY FOR THE MALFUNCTION.
8. THE PRODUCT IS DESIGNED FOR NORMAL CONDITION USAGE. PLEASE FULLY CONSULT AND DISCUSS WITH YOUR DEALER OR MANUFACTURER IF YOU NEED TO USE THE PRODUCT IN SPECIAL CONDITION. OTHERWISE, IT CAN CAUSE PRODUCT MALFUNCTION IN ABNORMAL CONDITION USAGE.

## SAFETY & CAUTION DURING THE USAGE

- DO NOT CUT OR DAMAGE THE CABLE RANDOMLY. IT CAN CAUSE PRODUCT MALFUNCTION OR WATERPROOF FUNCTION DEFECT. MANUFACTURER WILL NOT TAKE RESPONSIBILITY FOR THE MALFUNCTION.
  - TIGHTEN THE CONNECTORS WHEN CONNECTING THE EXTENSION CABLE. OTHERWISE, IT CAN CAUSE CONNECTION PROBLEM OR WATERPROOF FUNCTION DEFECT OF THE PRODUCT.
  - CHECK THE FIXED CONDITION OF THE BRACKET AND PRODUCT BEFORE DRIVING. IT CAN CAUSE DAMAGE WHILE DRIVING IN UNSTABLE CONDITION BY PHYSICAL PHENOMENONS. MANUFACTURER WILL NOT TAKE RESPONSIBILITY FOR USER'S NEGLIGENCE.
  - DO NOT USE THE PRODUCT IMMEDIATELY AFTER LEAVING ALONE FOR A LONG PERIOD IN SUMMER OR WINTER. IT CAN CAUSE SERIOUS DAMAGE TO THE PRODUCT WHEN USING IN INAPPROPRIATE TEMPERATURE.
  - THE SHUTTER DOES NOT WORK IN FREEZING CONDITIONS. PLEASE USE AFTER THAWING. (THE MOTOR IS PROTECTED BY THE APPLIED SLIP TORQUE) - SHUTTER APPLIED MODEL ONLY
  - STOP USING THE PRODUCT IMMEDIATELY IF BURNING SMELL, SMOKE OR SEVERE OVERHEATING OCCURS WHILE USAGE AND VISIT THE A/S CENTER.
  - MAKE SURE TO CONNECT POWER CABLE AND CAMERA CABLE IN RIGHT DIRECTION. WRONG WIRE CONNECTION CAN CAUSE DAMAGE TO THE PRODUCT.
  - DO NOT DROP THE PRODUCT IN THE WATER OR KEEP IN HUMID PLACE FOR A LONG TIME. IT WILL BE CLASSIFIED AS INUNDATION REASON AND WON'T BE ABLE TO GET FREE A/S SERVICE. (NON-WATERPROOF MONITOR)
  - DO NOT WRAP THE PRODUCT WITH ANY FABRIC WHILE OPERATING. DUE TO INTERNAL TEMPERATURE RISING, IT CAN CAUSE PRODUCT MALFUNCTION OR FIRE.
  - AVOID SEVERE ELECTROSTATIC CONDITION. IT CAN CAUSE PRODUCT MALFUNCTION.
  - DO NOT PILE UP HEAVY STUFF ON THE PRODUCT. IT CAN CAUSE PRODUCT PROBLEMS OR DAMAGE.
  - IF ANY DEBRIS IS FOUND INSIDE OF THE PRODUCT, DISCONNECT THE POWER CABLE AND VISIT THE A/S CENTER. IT CAN CAUSE ELECTRIC SHOCK OR MALFUNCTION WHEN USED CONTINUOUSLY.
  - DO NOT CLEAN THE PRODUCT WITH CHEMICAL PRODUCT (ALCOHOL, BENZENE, ACETONE AND ECT). IT CAN CAUSE DAMAGE OF THE PRODUCT SURFACE OR PRODUCT MALFUNCTION.
- \* USE REGULATED VOLTAGE FOR EACH CAMERA. (REFER PRODUCT SPECIFICATION)**  
**\* DO NOT CUT THE CABLE RANDOMLY.**  
**\* OUR COMPANY WILL NOT TAKE RESPONSIBILITY IN CASE OF PRODUCT DAMAGE DUE TO CONSUMER'S NEGLIGENCE.**

## 1 COMPOSITION

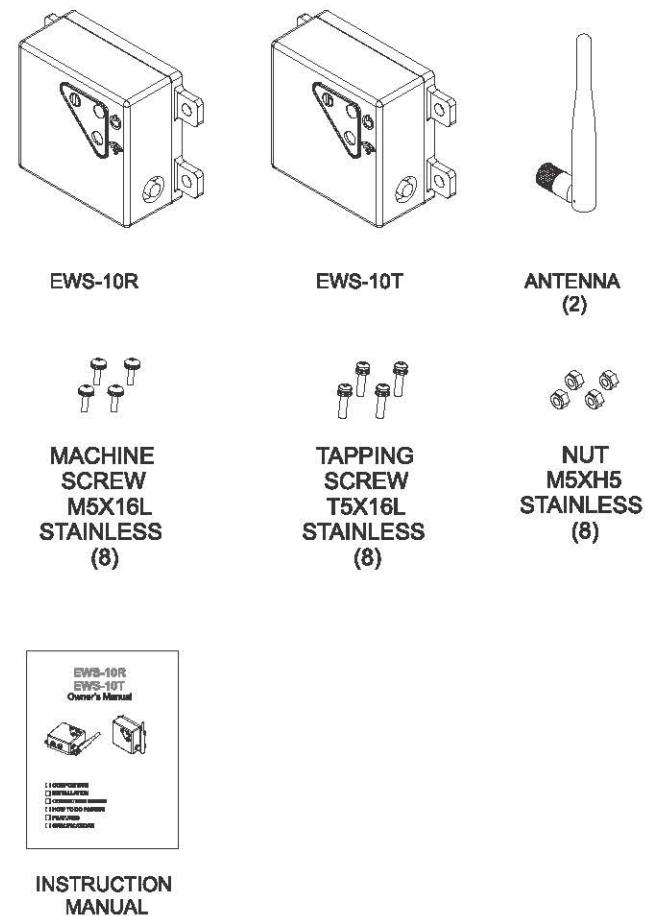

## 2 INSTALLATION

INSTALL CAMERA FIRMLY AT THE ADEQUATE POSITION OF VEHICLE AFTER CHECKING CAMERA'S FIELD OF VIEW. CAMERAS CAN BE INSTALLED AT SUITABLE POSITION OF VEHICLE'S REAR SIDE ACCORDING TO USER'S CONVENIENCE. ASK YOUR DEALER OR EXPERIENCED TECHNICIAN HOW TO INSTALL CAMERA & MONITOR DUE TO DIFFERENT TYPE OF VEHICLE.

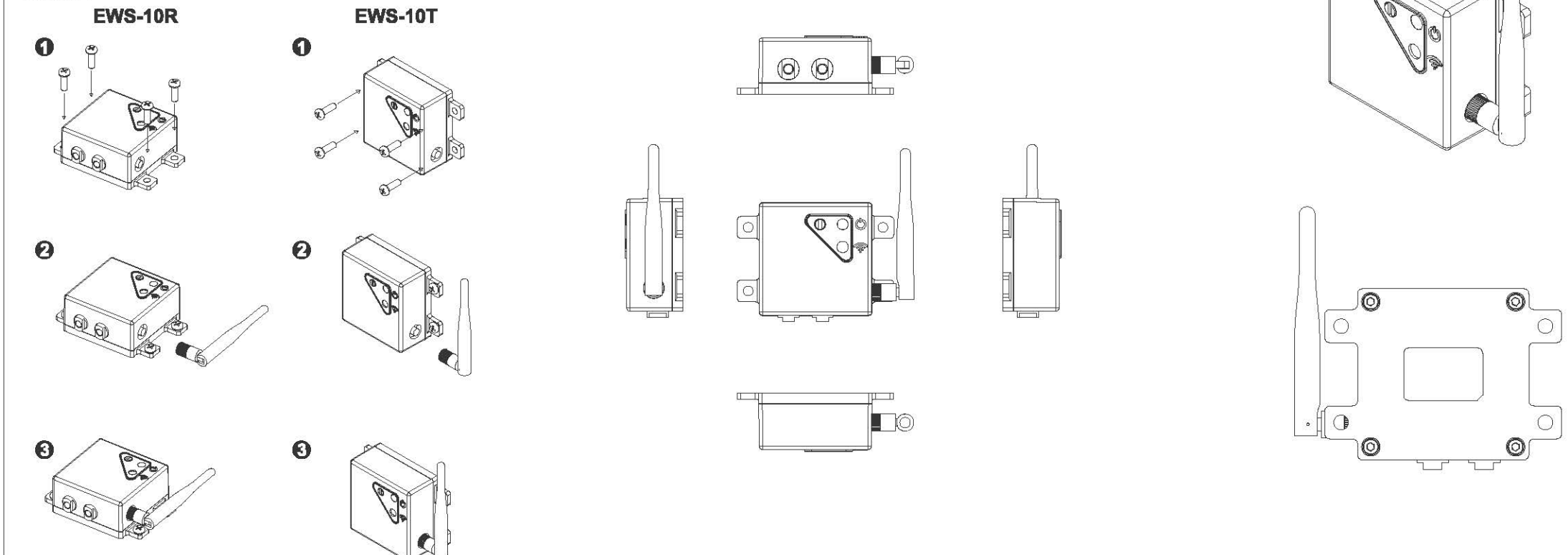



### 3 CONNECTION WIRING

CONNECT CAMERA & MONITOR AFTER CHECKING SPECIFICATION OF MONITOR & EXTENSION CABLE. CONNECT POWER & GROUND WIRE OF MONITOR TO FUSE BOX OF VEHICLE WHEN YOU CONNECT MONITOR POWER.

\* POWER CONNECTION SHOULD BE CHOSEN BY USER ACCORDING TO POWER SUPPLY CONDITIONS. CONNECT CAMERA BACK CABLE WITH EXTENSION CABLE AND THEN CONNECT EXTENSION CABLE WITH MONITOR.

\* USE ACID FREE VASELINE OR GREASE INSIDE OF CONNECTOR BEFORE FIXATION FOR A GUARANTEED LONG LIFETIME. CONNECT CAMERA BACK CABLE WITH EXTENSION CABLE FIRMLY AFTER CHECKING MALE & FEMALE CONNECTOR. OTHERWISE, IT CAUSES PRODUCTS PROBLEM.

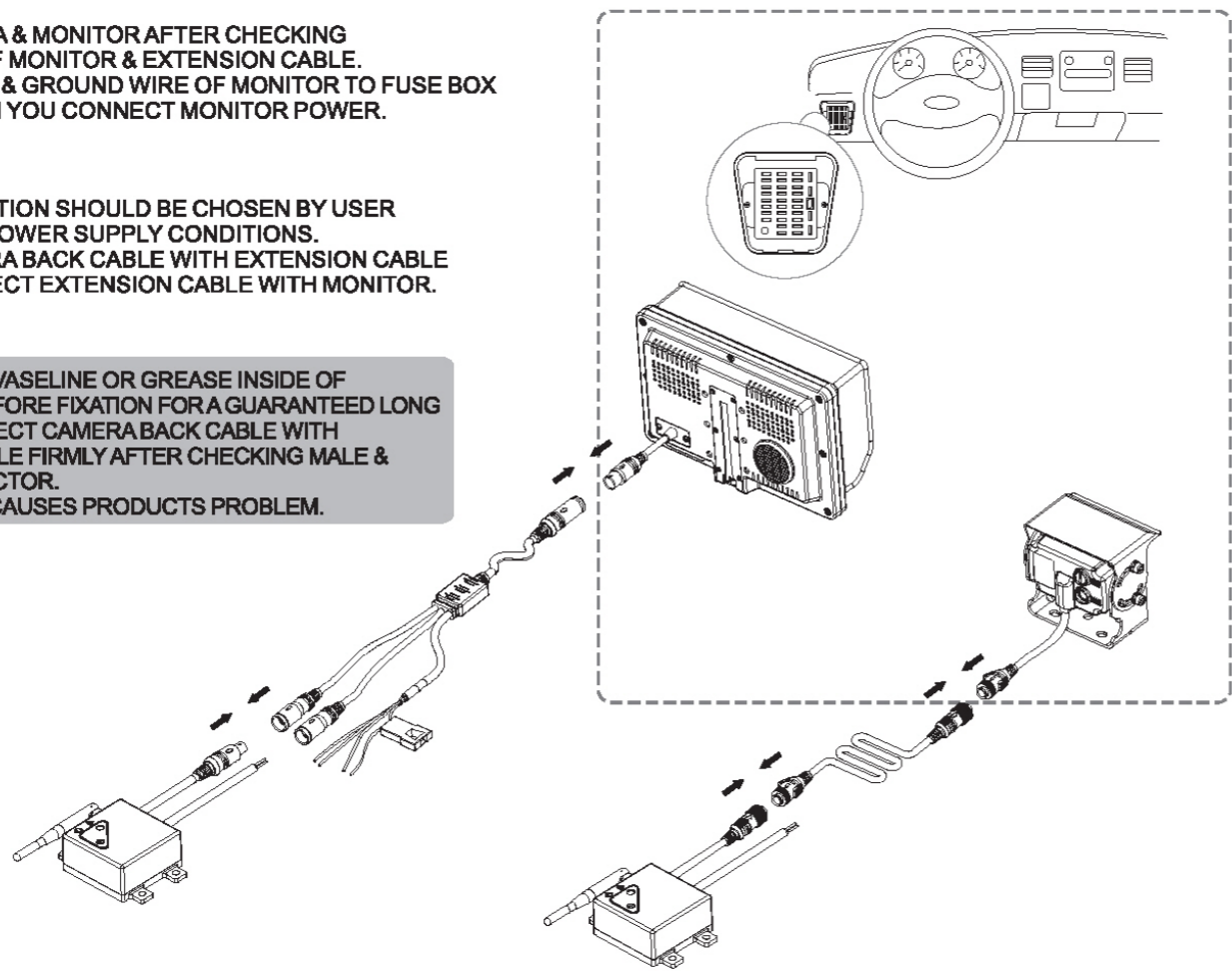

### 4 HOW TO DO PAIRING

1 Start the Vehicle (EWS-10T starts to scan EWS-10R signal for 10sec)



2 Turn on the Hazard Light (enter pairing mode to connect to EWS-10T)



Also has magnetic switch for EWS-10R enter pairing mode manually.

3 EWS-10R & EWS-10T connected after 5sec



Once EWS-10R & EWS-10T has been connected, they will be constantly connected without pressing any buttons. If you want to connect EWS-10R to other EWS-10T, repeat #1) & #2) again.

### 5 FEATURES

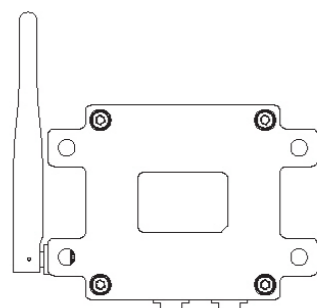
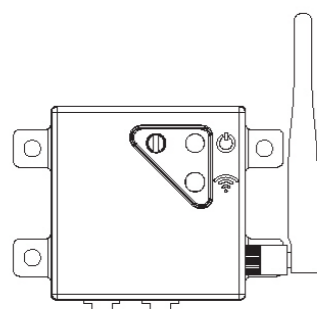

- Little Latency Transmission ( ≈ 100ms)
- Low Delay on Start Up
- Auto Pairing
- Manual Pairing (Magnet Switch)
- Anti Communication Interrupt
- Vandal Resistance (AL Housing)
- Intelligent frequency hopping tech on FHSS
- transmission method

### 6 SPECIFICATIONS

Model No.	EWS-10R / EWS-10T
Operating Frequency	2.4095GHz~2.469GHz ISM band
Data Rate	4 Mbps (Max)
Transmission distance	200M (at open space)
Frame Rate	Up to 25fps at 720 x 576 (PAL) Up to 30fps at 720 x 480 (NTSC)
Type of Spread Spectrum	FHSS
Receiving Sensitivity	-85dBm
Video compression format	MPEG4
Transmission power	19dBm
Latency	Average 100ms
Power Input	DC 10V~32V
Power Consumption	Max. 20W
IP Rating	IP 69K
Operating Temp.	-40℃ ~85℃
Dimension	65(W) X 65(H) X 33(D) mm
Weight	Approx.200g(2x)
Supplied Accesories	EWS-10R EWS-10T Screw Kits (2) Antenna (2) Instruction Manual

#### FCC Compliance Statement:

This device complies with part 15 of the FCC Rules. Operation is subject to the following two conditions: (1) This device may not cause harmful interference, and (2) this device must accept any interference received, including interference that may cause undesired operation.

#### CAUTION:

Changes or modifications not expressly approved by the manufacturer responsible for compliance could void the user's authority to operate the equipment.

#### Important Note:

To comply with FCC RF exposure compliance requirements, the antenna used for this transmitter must be installed to provide a separation distance of at least 20cm from all persons and must not be co-located or operating in conjunction with any other antenna or transmitter.

#### European Union Notice

This system has been tested for conformance with CE radio spectral, EMC and safety requirements.

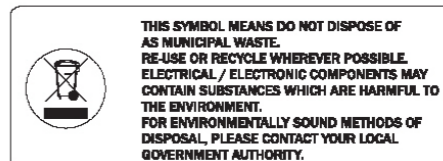

\* Design and specifications are subject to change without notice.  
\* Patent registered.

"Perfect Quality, On-time Delivery & Speedy A/S"