

## Wireless Speaker

# TS-SP04

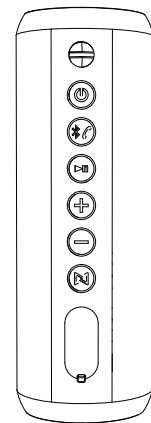

## User Manual

### In The Box

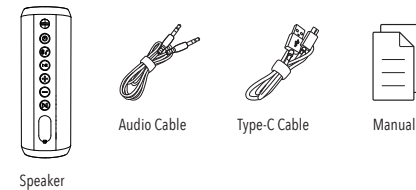

### Product Details

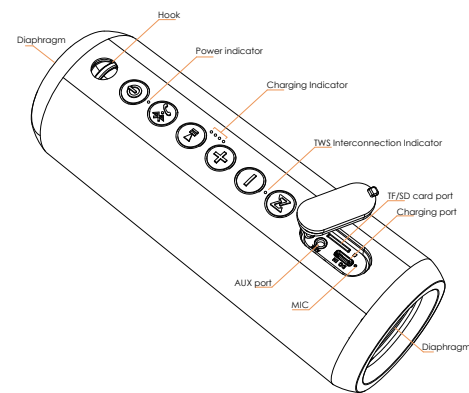

### Introduction to Keys

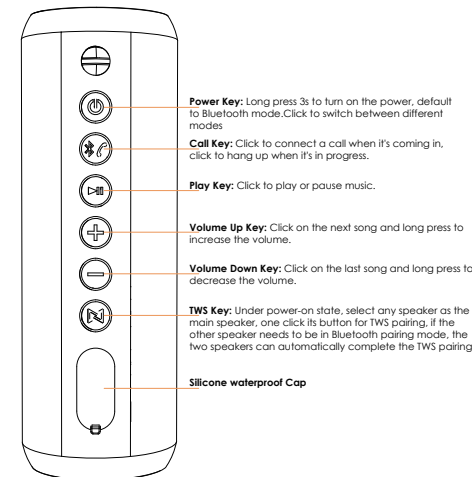

### Tips

#### Connection

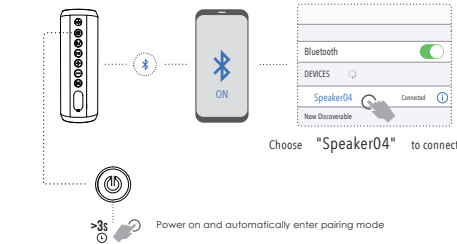

#### Charging

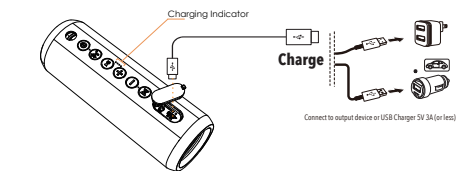

1. Charge the speaker when using it for the first time.
2. Indicator light will blink when charging, when full, all 4 indicator lights will light up.
3. Full charge time is about 1-3 hours.

### Specification

- Bluetooth version:** Bluetooth V5.4
- Buttons:** Power, Call, Play, Volume Up, Volume Down, TWS
- Interface:** TYPE-C, 3.5MM AXU-IN, TF
- Function:** Music play+ Calling + AUX IN + FM + TF + colorful flashing light
- TWS:** Support bluetooth + AUX state TWS connection playback
- Battery:** 3.7V 4400mAh
- Charging:** 5V/1.5A(max)
- Speaker:** 2 \* (45mm 10W)
- Size:** 200mmH\*Φ66mm
- Playing time:** 12 hours@80% volume

### Please read this manual carefully before use.

#### ! Safety warnings

Do not place any naked flame sources, such as lighted candles. Dispose of batteries responsibly and be aware of the environmental effects of battery disposal. Do not expose the batteries (batteries installed) to excessive heat, such as fire or the like.

#### ⚠ Warning

To prevent possible hearing damage, do not listen at high volume levels for long periods. For your own safety, please be aware of your surroundings when using these Speakers.

### FCC STATEMENT :

This device complies with Part 15 of the FCC Rules. Operation is subject to the following two conditions:  
(1) This device may not cause harmful interference, and  
(2) This device must accept any interference received, including interference that may cause undesired operation.  
Warning: Changes or modifications not expressly approved by the party responsible for compliance could void the user's authority to operate the equipment.

**NOTE:** This equipment has been tested and found to comply with the limits for a Class B digital device, pursuant to Part 15 of the FCC Rules. These limits are designed to provide reasonable protection against harmful interference in a residential installation. This equipment generates uses and can radiate radio frequency energy and, if not installed and used in accordance with the instructions, may cause harmful interference to radio communications. However, there is no guarantee that interference will not occur in a particular installation. If this equipment does cause interference to radio or television reception, which can be determined by turning the equipment off and on, the user is encouraged to try to correct the interference by one or more of the following measures:  
Reorient or relocate the receiving antenna.  
Increase the separation between the equipment and receiver. Connect the equipment into an outlet on a circuit different from that to which the receiver is connected.  
Consult the dealer or an experienced radio/TV technician for help.

### RF warning statement:

The device has been evaluated to meet general RF exposure requirement. The device can be used in portable exposure condition without restriction.