

## Label Specification

Label P/N: 334-0033-00

Units: Inches

Date: 09/07/2011

Dederick

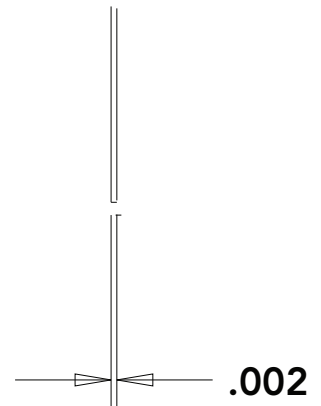
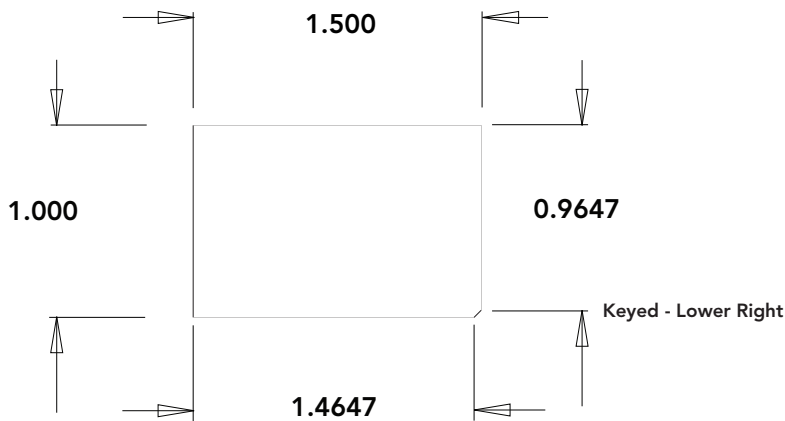

### MATERIAL:

POLYESTER

### OVERLAY:

- GLOSS
- SEMI-GLOSS
- MATTE
- TEXTURED LEXAN

LIGHTSPEED TECHNOLOGIES, INC.

www.lightspeed-tek.com

800.732.8999

334-0033-00\_MC\_NAMEPLATE\_REVB

### LABEL SPECIFICATIONS

LABEL PART:	334-0033-00
REVISION:	B
DATE:	09/07/2011
MATERIAL:	POLYESTER, GLOSS
ADHESIVE:	UL APPROVED
WIDTH:	1.500 INCHES
HEIGHT:	1.000 INCHES
THICKNESS:	2 MIL
TOLERANCES:	0.002 INCH
COLORS:	BLACK BACKGROUND, WHITE TEXT
SUBSTRATES:	ABS
ENVIRONMENT:	INDOOR USE
APPLICATION:	PEEL OFF ROLL
SERIALIZED:	NO
UL REQUIREMENTS:	UL APPROVED PROCESS FOR MAT/ADH
REGULATORY REQUIREMENTS:	UL, RoHS

**NOTE:**

1. Bottom of 395-0019-01 Media Connector(MC) plastic base
2. Latest version of 334-0033-00 Media Connector(MC) nameplate
3. Drawing for UL or FCC examination of nameplate location
4. Only bottom chassis shown

REV.	DESCRIPTION	DATE
A	PRODUCTION RELEASED COMPONENT	09/08/2011

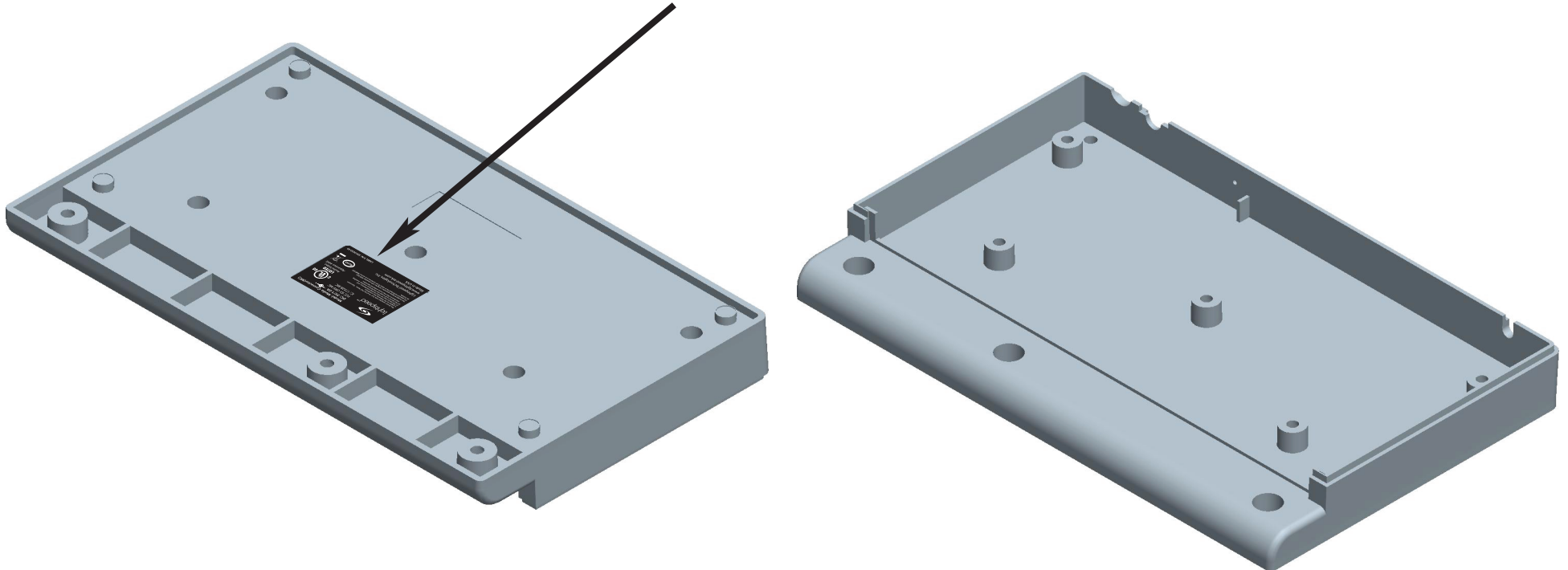

Bottom side of 395-0019-01 Media Connector(MC)

<p><b>DISCLAIMER</b></p> <p>THIS DRAWING AND THE INFORMATION CONTAINED WITHIN IS FOR GENERAL PRESENTATION FOR A UL EXAMINATION. DRAWING IS PROVIDED AS PART OF PRODUCT PACKAGE AND ONLY SHOWS REQUESTED INFORMATION ON LABEL LOCATION.</p>	<p>DRAWN BY JAMIE DEDERICK</p>	<p>CUSTOMER: LIGHTSPEED</p>	
	<p>DATE 09/08/2011</p>		<p>TITLE:</p>
	<p>COMMENTS: CUSTOMER PROJECT: Media Connector(MC) Nameplate Location</p>		<p>SCALE: NA</p>
<p>PROPRIETARY AND CONFIDENTIAL</p> <p>THE INFORMATION CONTAINED IN THIS DRAWING IS THE SOLE PROPERTY OF LIGHTSPEED TECHNOLOGIES. ANY REPRODUCTION IN PART OR AS A WHOLE WITHOUT THE WRITTEN PERMISSION OF LIGHTSPEED TECHNOLOGIES IS PROHIBITED.</p>	<p>SIZE DWG. NO.</p> <p><b>A</b></p>	<p>REV</p> <p><b>A</b></p>	