



Label Specification

Label P/N: 334-0038-00

Units: Inches

Date: 08/23/11

Dederick

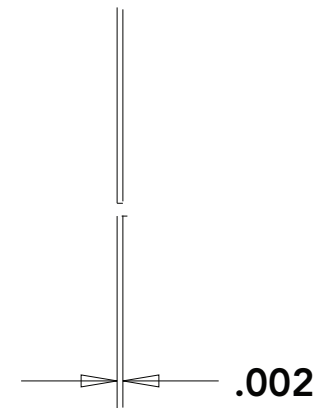
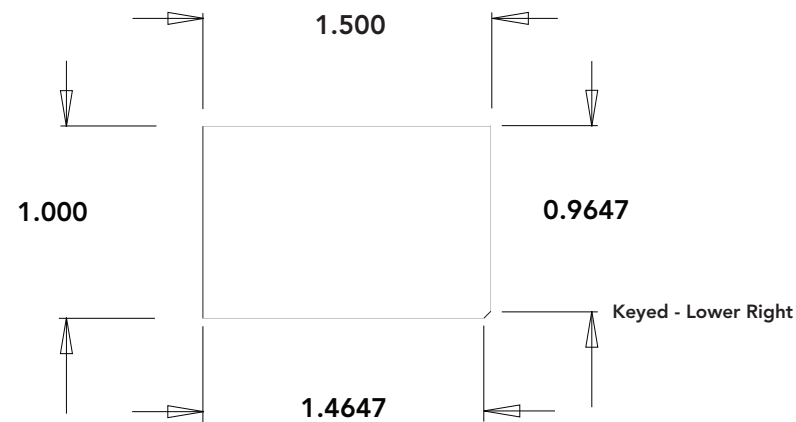

Background Color to be:
 Pantone 327-2

LIGHTSPEED TECHNOLOGIES, INC.
 www.lightspeed-tek.com
 800.732.8999
 334-0038-00_FCBP_NAMEPLATE
LABEL SPECIFICATIONS

LABEL PART:	334-0038-00
REVISION:	02
DATE:	8/23/2011
MATERIAL:	POLYESTER, GLOSS
ADHESIVE:	UL APPROVED
WIDTH:	1.500 INCHES
HEIGHT:	1.000 INCHES
THICKNESS:	2 MIL
TOLERANCES:	0.002 INCH
COLORS:	PANTONE 327-2 BACKGROUND, WHITE TEXT
SUBSTRATES:	ABS
ENVIRONMENT:	INDOOR USE
APPLICATION:	SHEETS - APPLIED BY LIGHTSPEED
SERIALIZED:	NO
UL REQUIREMENTS:	UL APPROVED PROCESS FOR MAT/ADH
REGULATORY REQUIREMENTS:	UL, RoHS

MATERIAL:

POLYESTER

OVERLAY:

GLOSS

SEMI-GLOSS

MATTE

TEXTURED LEXAN

PANTONE 327-2 SWATCH



REV	REF	DESCRIPTION OF CHANGE	CHK BY	DATE
02		ADDED CUTOUT	TN	01JUN11

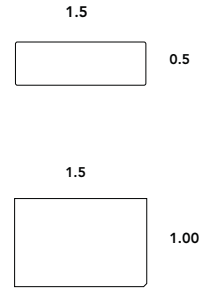
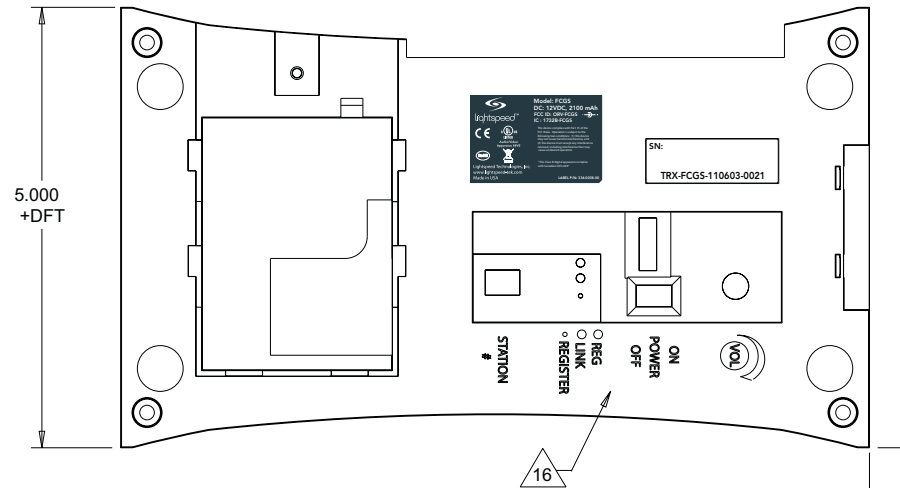
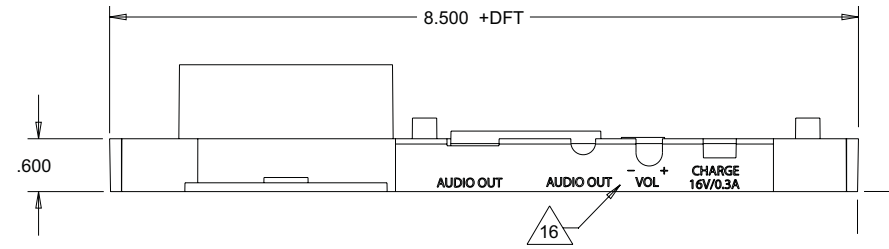
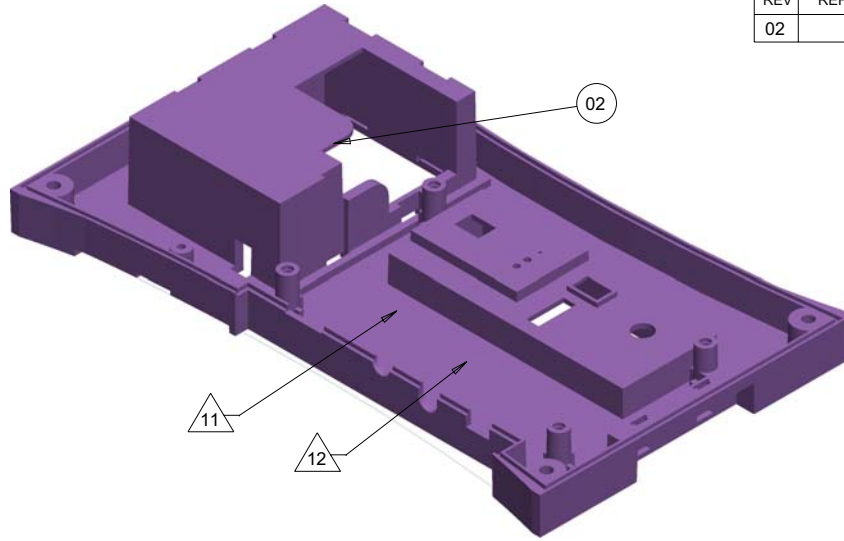

- 16 FILM NUMBER: LS-1040
- 15. ALL OUTSIDE SURFACES: TEXTURE MOLD-TECH MT 11010
- 14. UL REQUIRED MARKINGS & DOCUMENTATION FOR SUBPARTS WITH UL REQUIREMENTS, MUST BE INCLUDED WITH EACH SHIPMENT.
- 13. PARTS MUST BE FABRICATED/MOLDED BY A UL RECOGNIZED FABRICATOR/MOLDER. MATERIAL AND PROCESS MUST BE UL RECOGNIZED.
- 12 MOLD REVISION DATE CODE AND REVISION NUMBER TO BE ENGRAVED IN THIS AREA.
- 11 PLASTIC RECYCLING CODE ">PC/ABS<" THIS AREA. RAISED/RECESSED TEXT HEIGHT .094 X .003/.006
- 10. ALL MATERIALS AND PROCESSES SHALL BE ROHS COMPLIANT
- 9. MOLD DESIGN TO BE APPROVED BY LIGHTSPEED INC.
- 8. COSMETIC GRADE B ALL SURFACES
- 7. UL 94 HB FLAME RATED
- 6. CORNERS AND FILLETS MODELED SHARP: R .005 MAX
- 5. SINK: .005MAX
- 4. FLASH: .008 MAX
- 3. EJECTOR MARKS: +.xxx/-.yyy MAX
- 2. DEGATE: +.008/-.008
- 1. DIMENSIONING AND TOLERANCING PER ASME Y14.5M - 1994

NOTES: UNLESS OTHERWISE SPECIFIED.

		LightSPEED Technologies, INC. 11509 SW HERMAN ROAD TUALATIN, OR 97062 USA	
RELEASED FOR PRODUCTION TOOLING	SIGNATURE	DATE	
DWN TN		DIMENSIONS ARE IN INCHES TOLERANCES UNLESS OTHERWISE SPECIFIED	
ENGR TN		DEC ± .005	ANL/R ± °
CHKR		SCALE	FIRST USED ON
PROD		NONE	DAS
MATERIAL PC/ABS - LIGHTSPEED BLACK			
FINISH SEE NOTES			
TITLE CASE, BASE, DAS POD			
CODE IDENT NO	SIZE	PART NUMBER	SH 1 OF 1 REV
	C	395-0035-00	02