

RF Wireless Keypad with Optical Trackball



User's Manual

This device combines the functions of wireless numerical keypad and trackball mouse that can provide Notebook users a best and convenient solution anywhere. It is also suitable for PC users for its one-touch access to calculator, Internet and E-mail as an extension function.

Features and Specifications

- 27.12MHz wireless technology
- 4096 IDs free from interference
- Patented optical trackball
- Advanced power saving management
- Power recharging through USB charging cable
- Mouse left and right keys
- Windows 98SE/Me/2000/XP/2003/X64 compatible
- FCC & CE approvals
- Dimension: 103.5L x 119W x 32.5mmH

Package Contents

- Keypad with trackball
- USB receiver
- USB extension Y-cable
- 2 AAA rechargeable batteries
- Carrying pouch
- User's manual

Installation

1. Plug USB receiver to Notebook or PC's USB port.
The LED light turns on automatically.

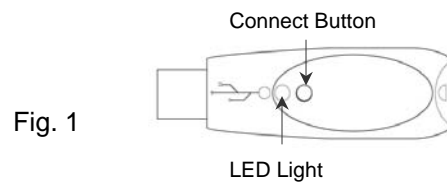

2. Insert two AAA rechargeable batteries. Please ensure they are in the right direction.

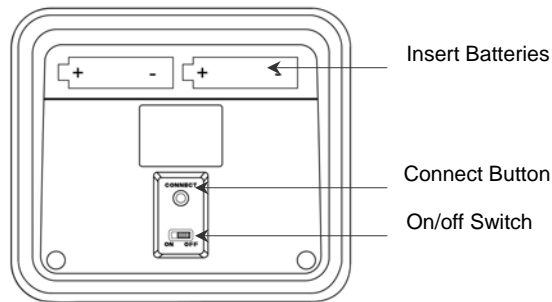

3. Press and release the "Connect" button on the receiver to turn off the LED light.

4. Press and release the “Connect Button” on the keypad, LED light on the receiver will turn on, indicating that the setup has been completed. Keypad is now ready to use.

Operating the Keypad

1. Put Keypad on tabletop, the optical ball is used for moving screen cursor.
2. Right and left key beneath/above the Trackball two models can be used for right- and left-handed users.

Left key

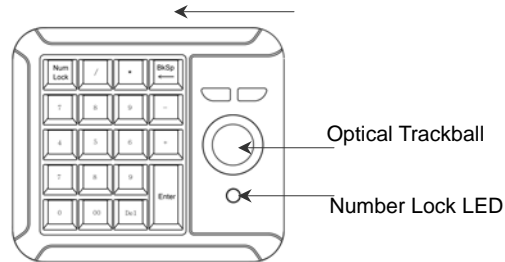

For Right-handed user

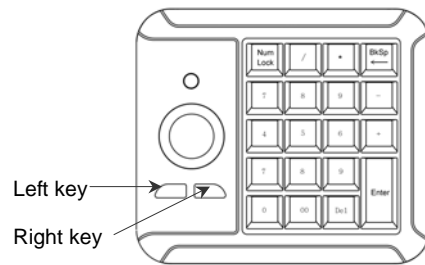

For Left-handed user

3. While the “Num Lock” key is ON (Num Lock LED is flashing). The keypad works as numerical one and its key function is defined as below:

Num Lock	/	*	BkSp
7	8	9	-
4	5	6	+

1	2	3	Enter
0	00	.	

4. While the Num Lock is OFF (Num Lock LED is vanished). The keypad's key function is defined as below:

5.

Num Lock			BkSp
HOME	↑		-
←		→	+
END	↓	PgDn	Enter
INS	Shift	DEL	

6. There are 3 compound keys for use while the NumLock off.

- Shift+END → € (European dollar symbol)
- Shift+Enter → e-mail (Open the e-mail)
- Shift+ + → Internet (Open the website)

7. When the numeric key or screen cursor remains moving slow or no movement at all, the low battery status indicated. Please plug USB receiver to USB female port of Y-cable and plug USB male of Y-cable to Notebook or PC's USB port, and then insert recharging male to KM-9300/9301.

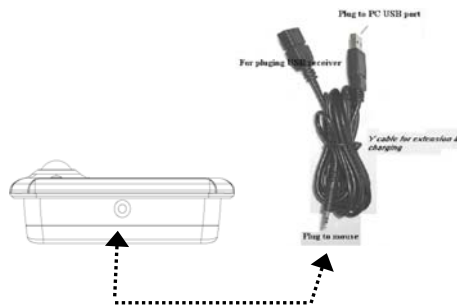

8. We suggest to turn off Keypad power (power switch on the back of keypad) when it is not in usage status for saving power.

Note:

FCC Caution: Any changes or modifications not expressly approved by the party responsible for compliance could void the user's authority to operate this equipment.

This device complies with Part 15 of the FCC Rules. Operation is subject to the following two conditions:
(1) This device may not cause harmful interference, and (2) this device must accept any interference received, including interference that may cause undesired operation.