

Audio cable

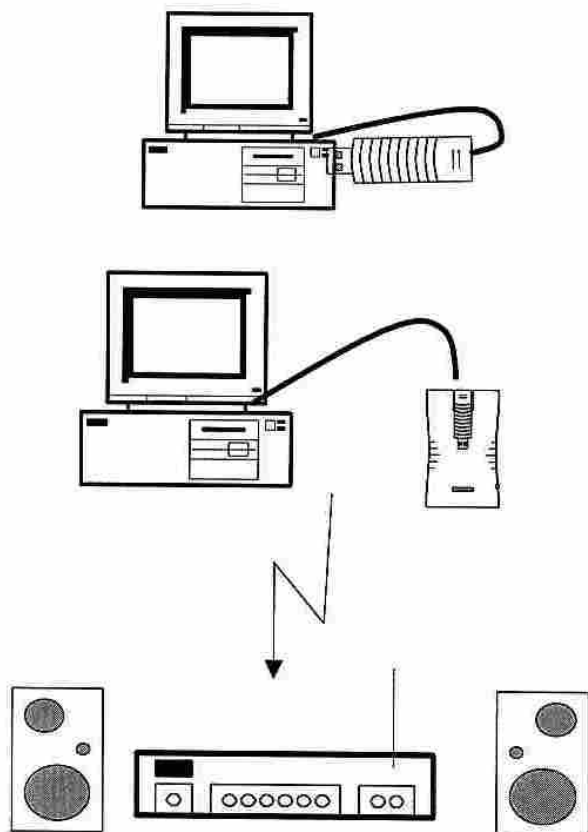

## *Replace PC multi-media speaker at home use*

**Way 1 : receiver the signal by home Hi-Fi radio from PC sound card with GF-88**



Any kind of home radio or Hi-Fi radio with speaker

Installation :

1. Insert the GF-88 remote part to PC USB port
2. Plug in one end of the audio cable to the output of sound card, plug the other end to GF-88 remote part
3. The audio signal will broadcast FM 88MHz like the FM broadcasting station
4. Set your home Hi-Fi radio to FM 88MHz to received the broadcasting signal from GF-88 remote part
5. PC can send out the audio signal of MP3 or CD-ROM by sound card
6. If PC doesn't have USB port, please plug GF-88 remote part to it's base part to have a power supply

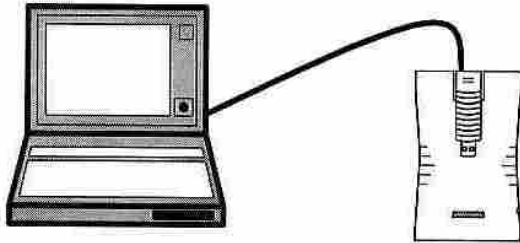
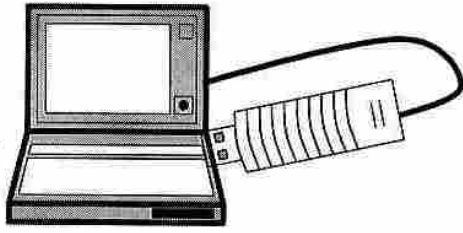

It can be link to note book PC's  
USB port and sound card output

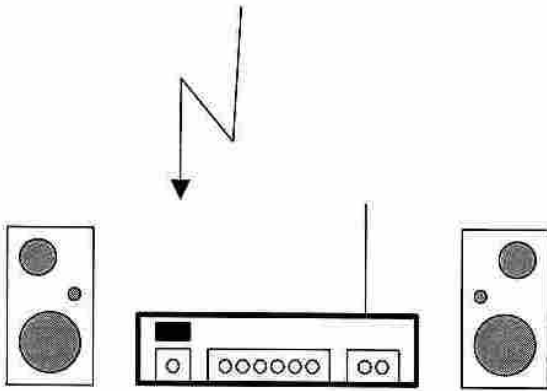

Any kind of home radio or Hi-Fi radio with speaker

***No need to have a ear-phone or head set to listen MP3 or walkman***

**Way 2 : send the signal from MP3 or walkman by GF-88 remote part, receive the signal with home radio or Hi-Fi radio**

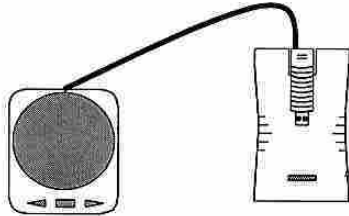

MP3 player or walkman

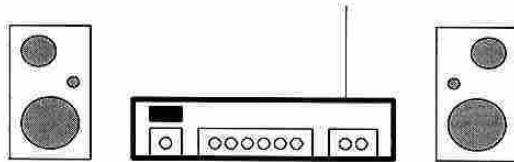

Any kind of home radio or Hi-Fi radio with speaker

Installation :

1. Plug in GF-88 to base part
2. Link the audio cable between MP3 player or walkman to GF-88 remote part
3. The audio signal will broadcast FM 88MHz like the FM broadcasting
4. Set your home Hi-Fi radio to FM 88MHz to received the broadcasting signal from GF-88 remote part

*No need to have a ear-phone or head set to listen MP3 or walkman during driving*

**Way 3 : send the signal from MP3 or walkman by GF-88 remote part, receive the signal with car radio**

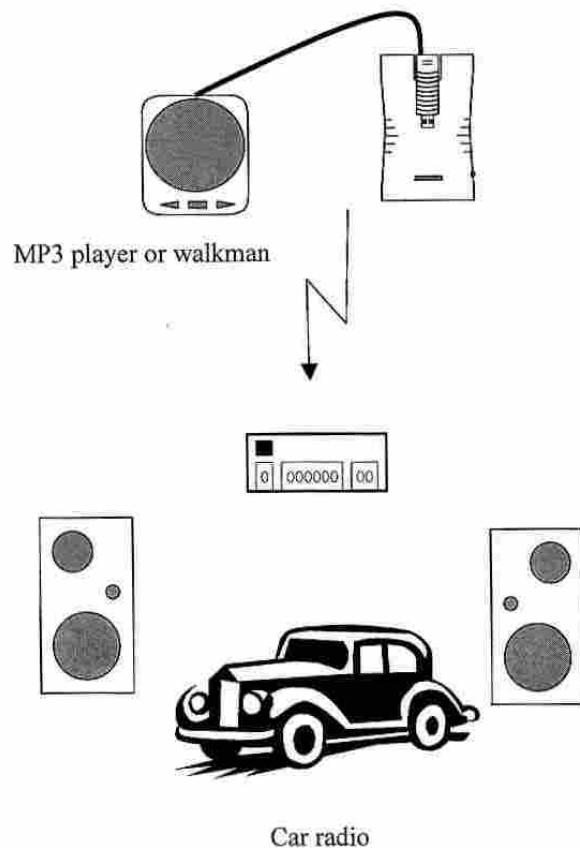

Installation :

1. Plug in GF-88 to base part
2. Link the audio cable between MP3 player or walkman to GF-88 remote part
3. The audio signal will broadcast FM 88MHz like the FM broadcasting
4. Set your car radio to FM 88MHz to received the broadcasting signal from GF-88 remote part

### Information to User

#### Notice 1

You are cautioned that changes or modifications not expressly approved by the part responsible for compliance could void the user's authority to operate the equipment.

#### Notice 2

This equipment has been tested and found to comply with the limits for a Class B digital device, pursuant to part 15 of the FCC rules. These limits are designed to provide reasonable protection against harmful interference in a residential installation. This equipment generates, uses and can radiate radio frequency energy and, if not installed and used in accordance with the instructions, may cause harmful interference to radio communications.