

SYLVANIA

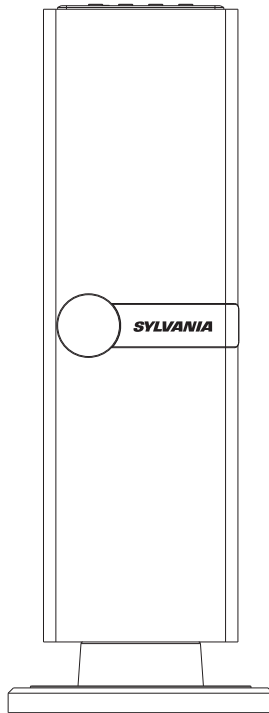

BLUETOOTH MINI TOWER SPEAKER
MODEL: SP269PL-ASST



INSTRUCTION MANUAL

PLEASE READ CAREFULLY BEFORE OPERATING THIS EQUIPMENT

IMPORTANT SAFETY INSTRUCTIONS

	CAUTION RISK OF ELECTRIC SHOCK DO NOT OPEN	
<p>CAUTION: TO REDUCE THE RISK OF ELECTRIC SHOCK, DO NOT REMOVE COVER (OR BACK). NO USER-SERVICEABLE PARTS INSIDE. REFER SERVICING TO QUALIFIED SERVICE PERSONNEL.</p>		



The lightning flash with arrowhead symbol within an equilateral triangle is intended to alert the user to the presence of uninsulated "dangerous voltage" within the product's enclosure that may be of sufficient magnitude to constitute a risk of electric shock to persons.



The exclamation point within an equilateral triangle is intended to alert the user to the presence of important operating and maintenance (servicing) instructions in the literature accompanying the appliance.

FCC NOTICE:
This equipment has been tested and found to comply with the limits for a Class B digital device, pursuant to part 15 of the FCC Rules. These limits are designed to provide reasonable protection against harmful interference in a residential installation. This equipment generates, uses and can radiate radio frequency energy and, if not installed and used in accordance with the instructions, may cause harmful interference to radio communications.

However, there is no guarantee that interference will not occur in a particular installation. If this equipment does cause harmful interference to radio or television reception, which can be determined by turning the equipment off and on, the user is encouraged to try to correct the interference by one or more of the following measures:

- Reorient or relocate the receiving antenna.
- Increase the separation between the equipment and receiver.
- Connect the equipment into an outlet on a circuit different from that to which the receiver is connected.
- Consult the dealer or an experienced radio/TV technician for help.

FCC WARNING:
To assure continued compliance, follow the attached installation instructions and use only shielded cables when connecting to other devices. Modifications not authorized by the manufacturer may void user's authority to operate this device.

WARNING:
TO REDUCE THE RISK OF FIRE OR ELECTRIC SHOCK, DO NOT EXPOSE THIS PRODUCT TO RAIN OR MOISTURE.

WARNING:
TO REDUCE THE RISK OF FIRE OR ELECTRIC SHOCK, AND ANNOYING INTERFERENCE, USE THE RECOMMENDED ACCESSORIES ONLY.

WARNING:
To reduce the risk of fire or electric shock, do not expose this apparatus to rain or moisture. The apparatus shall not be exposed to dripping or splashing and that objects filled with liquids, such as vases shall not be placed on apparatus.

Before using the unit, be sure to read all operating instructions carefully. Please note that these are general precautions and may not pertain to your unit.

For example, this unit may not have the capability to be connected to an outdoor antenna.

1) Read these instructions.

All the safety and operating instructions should be read before the product is operated.

2) Keep these instructions.

The safety and operating instructions should be retained for future reference.

3) Heed all warnings.

All warnings on the product and in the operating instructions should be adhered to.

4) Follow all instructions.

All operating and use instructions should be followed.

5) Do not use this apparatus near water.

Do not use this product near water and moisture, for example: near a bathtub, washbowl, kitchen sink or laundry tub; in a wet basement; or near a swimming pool.

6) Clean only with dry cloth.

Unplug this product from the wall outlet before cleaning. Do not use liquid cleaners or aerosol cleaners. Use a dry cloth for cleaning.

7) Do not block any ventilation openings. Install in accordance with the manufacturer's instructions.

Slots and openings in the cabinet and in the back or bottom are provided for ventilation, to ensure reliable operation of the product and to protect it from overheating. These openings must not be blocked or covered. The openings should never be blocked by placing the product on a bed, sofa, rug or other similar surface. This product should never be placed near or over a radiator or heat source. This product should not be placed in a built-in installation such as a bookcase or rack unless proper ventilation is provided or the manufacturer's instructions have been adhered to.

8) Do not install near any heat sources such as radiators, heat registers, stoves, or other apparatus (including amplifiers) that produce heat.

9) Do not defeat the safety purpose of the polarized or grounding-type plug. A polarized plug has two blades with one wider than the other. A grounding type plug has two blades and a third grounding prong. The wide blade or the third prong are provided for your safety. If the provided plug does not fit into your outlet, consult an electrician for replacement of the obsolete outlet.

10) Protect the power cord from being walked on or pinched particularly at plugs, convenience receptacles, and the point where they exit from the apparatus.

11) Only use attachments/accessories specified by the manufacturer.

12) Use only with the cart, stand, tripod, bracket, or table specified by the manufacturer, or sold with the apparatus. When a cart is used, use caution when moving the cart/apparatus combination to avoid injury from tip-over.

An appliance and cart combination should be moved with care.

Quick stop, excessive force and uneven surfaces may cause the appliance and cart combination to overturn.



13) Unplug this apparatus during lightning storms or when unused for long periods of time.

To protect your product from a lightning storm, or when it is left unattended and unused for long periods of time, unplug it from the wall outlet and disconnect the antenna or cable system. This will prevent damage to the product due to lightning and power-line surges.

14) Refer all servicing to qualified service personnel. Servicing is required when the apparatus has been damaged in any way, such as power-supply cord or plug is damaged, liquid has been spilled or objects have fallen into the apparatus, the apparatus has been exposed to rain or moisture does not operate normally, or has been dropped.

15) Power source

This product should be operated only from the type of power source indicated on the marking label. If you are not sure of the type of power supply to your home, consult your appliance dealer or local power company. For products intended to operate from battery power, or other source, refer to the operation instructions.

INSTALLATION

1. Remote Sensor
2. Speakers
3. Speaker Net

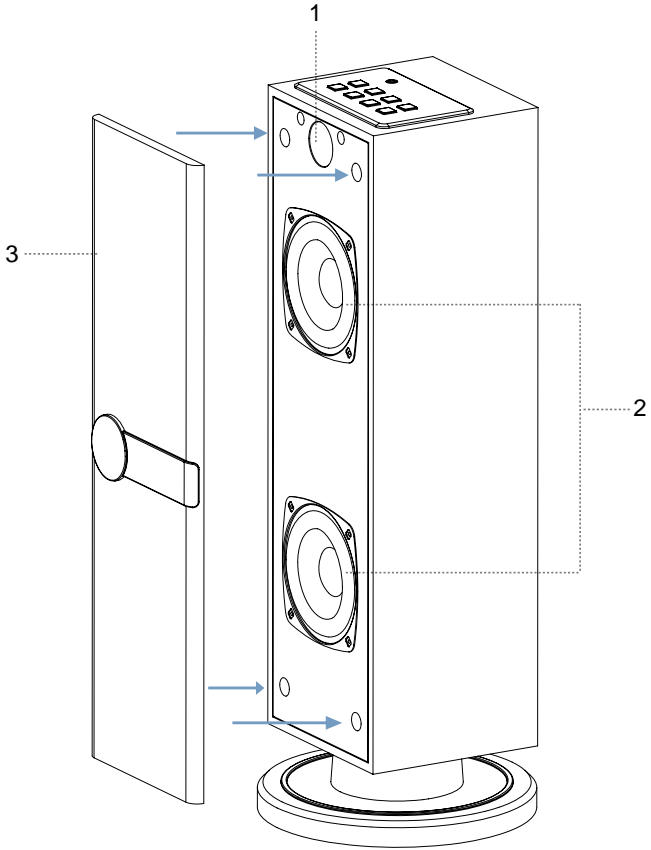

Note:
The Speaker Net can be taken out and reassembled as Figure above.

LOCATION OF CONTROLS

MAIN UNIT

1. AUX IN jack
2. Indicator
3. EQ(Equalizer)button
4. POWER button
5. SOURCE button
6. VOL- (Volume Down) button
7. VOL+ (Volume Up) button
8. ►► (Next) button
9. ◀◀ (Previous) button
10. ►◄ (Play/Pause) button
11. DC IN Jack

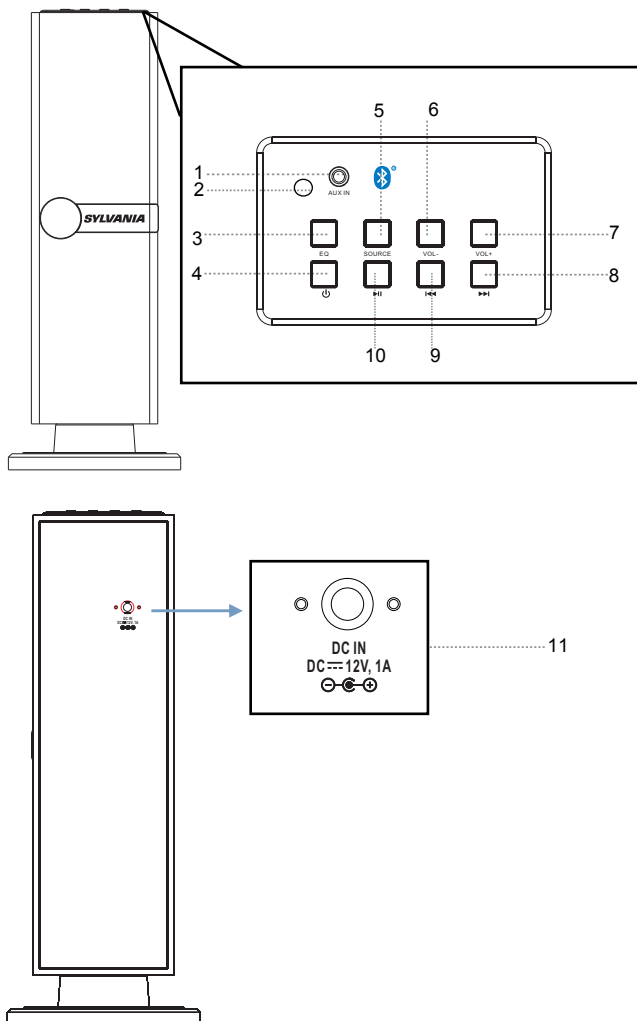

LOCATION OF CONTROLS

REMOTE CONTROL

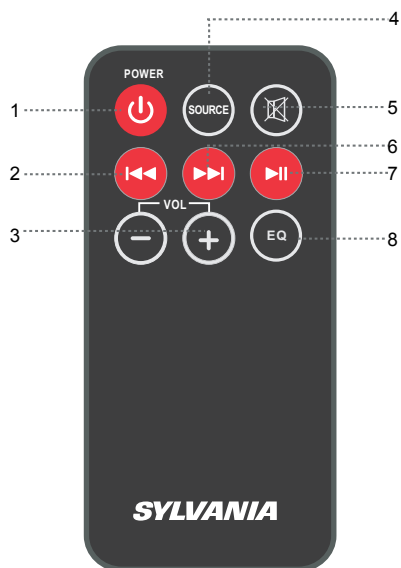

- | | |
|----------------------------|--------------------------|
| 1. ⏻ POWER button | 5. 🔇 (Mute) button |
| 2. ⏮ (Previous) button | 6. ⏭ (Next) button |
| 3. VOL (Volume)+/- buttons | 7. ⏸ (Play/Pause) button |
| 4. SOURCE button | 8. EQ (Equalizer) button |

BATTERY INSTALLATION--- REMOTE CONTROL

-First Time Use

Remove and discard the insulation tab as figure on the right

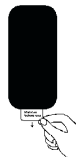

-Replacing Batteries For Remote Control

1. Push and slide out the battery holder as figure 1 below.
2. Replace the battery with a new CR2025 button cell as the polarity markings on the rear of the Remote markings on the Control.
3. Close the battery holder.

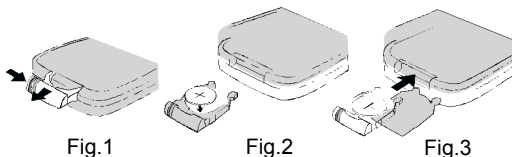

BATTERY PRECAUTIONS

Follow these precautions when using a battery in this device:

1. Use only the size and type of battery specified.
2. Be sure to follow the correct polarity when installing the battery as indicated in the battery compartment. A reversed battery may cause damage to the device.
3. Do not mix different types of batteries together (e.g. Alkaline and Carbon-zinc) or old batteries with fresh ones.
4. If the batteries in the device are consumed or the device is not to be used for a long period of time, remove the batteries to prevent damage or injury from possible battery leakage.
5. Do not try to recharge the battery not intended to be recharged; it can overheat and rupture. (Follow battery manufacturer's instructions.)
6. The batteries shall not be exposed to excessive heat such as sunshine, fire or the like.
7. Clean the battery contacts and also those of the device prior to battery installation





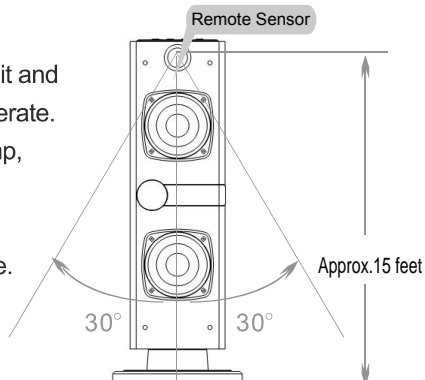

EFFECTIVE DISTANCE OF REMOTE TRANSMITTER

NOTES:

- When there is an obstacle between the unit and the transmitter, the transmitter may not operate.
- When direct sunlight, an incandescent lamp, fluorescent lamp or any other strong light shines on the REMOTE SENSOR of the unit, the remote operation may be unstable.

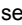

GENERAL OPERATIONS

1. Insert the AC/DC Adapter plug into a conveniently located AC outlet having 100-240V~50/60Hz. The Indicate (Red) will light.
2. Press the  Power button on the unit or remote control to power on the unit.
3. Press the SOURCE button repeatedly to switch to desired mode. The color of Indicator turns to corresponding color as below:
 - ~ Blue: Bluetooth
 - ~ Green: AUX IN
4. During Playback:
 - ~ Press the VOL (Volume) buttons to adjust volume level as desired.
 - ~ Press the EQ button repeatedly to select and set equalizer mode as desired.
 - ~ Press  (Mute) button on the Remote Control to turn off the sound. Press again to resume.
 - ~ Press the  or  button to skip track.
 - ~ Press the  (Play/Pause) button to pause. Press again to resume normal playback.
 - ~ Press the EQ button on unit or on remote control to change the EQ mode.
5. When finished listening, press the  Power button to power off the unit. The indicator will turn Red.

NOTE:

Pull out the AC/DC Adapter plug to shut off the unit if no using for long period of time.

LISTEN TO EXTERNAL AUDIO DEVICES

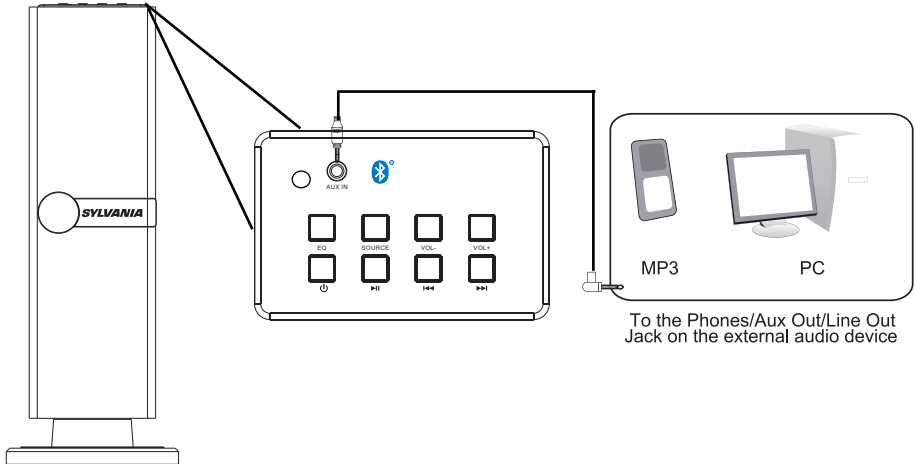

1. Connect one end of supplied audio connection cable to the AUX IN jack on the top of the unit as the figure above.
2. Connect the other end to the Audio out/Line out/Phone jack on the external player (such like iPhone, iPad, MP3 player, Discman... etc.).
3. Power ON the unit.
4. Press the SOURCE button repeatedly until the color of Indicator turns to Green.
5. Play the music in the external player as usual.

BLUETOOTH PAIRING AND PLAYBACK

1. Power ON the unit.
2. Press the SOURCE button on the unit or remote control until the color of Indicator changed to Blue.
3. Turn on the BT function on the external BT device and play the music as usual.
4. During palyback:
 - Press the VOL (Volume) +/- buttons to adjust volume level.
 - Press the ◀◀ or ▶▶ button to skip track.
 - Press the ▶|| (Play/Pause) button to pause. Press again to resume normal playback.

NOTES:

In first time use, pairing the external BT device as below:

- A. Power ON the unit, press the SOURCE button repeatedly until the color of Indicator turned to Blue and blinking.
- B. Power ON the external BT player and enter to searching mode. Start pairing as the on screen instructions on the external BT Player (For details pairing procedures, please refer to the user's manual of your BT device.).
- C. When the external BT player searched the Speaker, our model number "SP269PL" will appear on the display of external BT device. Select it and make pairing.
- D. Pairing code "0000" may need to enter.
- E. After successful connection, play music as usual.

TROUBLESHOOTING GUIDE

Check the followings before requesting service		
SYMPTOM	POSSIBLE CAUSE	POSSIBLE SOLUTION
No power	AC/DC adapter plug not connected to the wall outlet	Plug to the wall outlet.
No sound	Volume in minimum position	Raise volume level by pressing the VOL (Volume) + button
	The connected device is not in playback mode	Play the music/movie in the connected device as usual and make sure the volume level of it is in high level
	Input source incorrect	Press the SOURCE button repeatedly to set the input source to the desired mode
Sound distortion	Bass level of the connected device too high	Reduce the bass level of the connected device
	Volume level too high	Reduce the volume level by pressing the VOL (Volume) - button
Remote not working	The battery is consumed	Replace with new battery
Bluetooth reception failure	The external device is far from the unit	Put the external BT device close to the unit
	Have not paired	Pair both units as BT pairing page

TECHNICAL SPECIFICATIONS

AC/DC Adapter

Input.....AC 100-240V~50/60Hz

Output.....DC 12V  1 A  

Speakers3W x 2

Bluetooth Working Distance.....Up to 30 feet
(Measured in open area. Wall and structures may affect the effective range.)

Remote Working Distance.....Up to 15 feet

Accessories

- 1 x User Manual
- 1 x Remote Control
- 1 x AUX IN Cable
- 1 x AC/DC Adapter

You are cautioned that changes or modifications not expressly approved by the party responsible for compliance could void your authority to operate the equipment.

This device complies with Industry Canada licence-exempt RSS standard(s). Operation is subject to the following two conditions: (1) this device may not cause interference, and (2) this device must accept any interference, including interference that may cause undesired operation of the device.

Le présent appareil est conforme aux CNR d'Industrie Canada applicables aux appareils radio exempts de licence. L'exploitation est autorisée aux deux conditions suivantes : (1) l'appareil ne doit pas produire de brouillage, et (2) l'utilisateur de l'appareil doit accepter tout brouillage radioélectrique subi, même si le brouillage est susceptible d'en compromettre le fonctionnement.