

ON-THE-GO  
WIRELESS SPEAKER  
WITH **AMAZON ALEXA**

User's Guide for Model ISBWW418B v2082-01



**iLIVE** PLATINUM

## SAFETY WARNINGS

- WARNING: Where the mains plug or appliance coupler is used as the disconnect device, such disconnect device shall remain readily operable.
- Risk of electric shock. Grounding continuity must be maintained.
- Lithium batteries, like all rechargeable batteries, are recyclable and should be recycled or disposed of according to state and local guidelines. They should never be disposed of in normal household waste, and they should never be incinerated, as they might explode. Contact your local government for disposal or recycling practices in your area.
- Only use the included power supply or a UL/ETL certified power supply of the same power output specifications.

**WARNING:** This product can expose you to chemicals including lead, which is known to the State of California to cause cancer and birth defects or other reproductive harm.  
For more information go to: [www.P65Warnings.ca.gov](http://www.P65Warnings.ca.gov)  
**This product meets and complies with all Federal regulations.**



## FCC STATEMENT :

This device complies with Part 15 of the FCC Rules. Operation is subject to the following two conditions:

- (1) This device may not cause harmful interference, and
- (2) This device must accept any interference received, including interference that may cause undesired operation.

**Warning:** Changes or modifications not expressly approved by the party responsible for compliance could void the user's authority to operate the equipment.

NOTE: This equipment has been tested and found to comply with the limits for a Class B digital device, pursuant to Part 15 of the FCC Rules. These limits are designed to provide reasonable protection against harmful interference in a residential installation. This equipment generates uses and can radiate radio frequency energy and, if not installed and used in accordance with the instructions, may cause harmful interference to radio communications. However, there is no guarantee that interference will not occur in a particular installation. If this equipment does cause harmful interference to radio or television reception, which can be determined by turning the equipment off and on, the user is encouraged to try to correct the interference by one or more of the following measures:

Reorient or relocate the receiving antenna.

Increase the separation between the equipment and receiver.

Connect the equipment into an outlet on a circuit different from that to which the receiver is connected.

Consult the dealer or an experienced radio/TV technician for help.

## RF warning statement:

The device has been evaluated to meet general RF exposure requirement. The device can be used in portable exposure condition without restriction .

# TABLE OF CONTENTS

## **Introduction - 5**

- Features
- Includes
- Water Resistance Level IPX6

## **Overview**

- Speaker Controls & Inputs - 6
- Control Functions - 7
- Source Mode/Connection/Alexa Indicator Lights - 7

## **Setup**

1. Charging the Speaker - 8
2. Download the Alexa App - 9
3. Download the iLive Smart Bluetooth App - 9
3. iLive Smart Bluetooth App - 10
4. Things to Try with Alexa - 13

## **Smart Bluetooth App**

- Home Screen - 14
- Menu Screen - 15
- Music Player Screen - 16

## **Other Ways to Play - 17**

- Bluetooth Without the App
- Aux In

## **Troubleshooting - 18**

## **Customer Support - 19**

- Contact Information
- International Support
- Warranty Information

# INTRODUCTION

Take Alexa with you where ever you go with our On-the-Go speaker. Link Amazon Alexa with the speaker and ask Alexa to play music\*, read the news, check weather, control your smart home and more.

## Features

- » Voice-activated Amazon Alexa cloud-based voice service\*
- » Free iLive Smart Bluetooth app download
- » Bluetooth Wireless - range 33 ft.
- » IPX6 waterproof
- » Aux In (3.5mm audio input)
- » Built-in microphones with far-field voice recognition
- » Built-in rechargeable battery with Micro-USB port for battery recharge

## Includes

- » Detachable carabiner clip
- » 3.5mm audio cable
- » Micro-USB charging cable
- » User's Guide
- » Warranty

## Water Resistance Level IPX6

- » Protection from powerful jets of water and splashing from any angle.
- » Not suitable for submerging in water.

**IMPORTANT:** To ensure your speaker is prepared for use in a wet environment, disconnect and remove any power cables, and tightly close the cover on the rear of the unit. If the cover is not properly closed, water resistance will be compromised and could result in damage to the speaker or personal injury.

\*Spotify and Pandora not supported on this device.

\*Free app download required. Mobile carrier/data charges may apply when Amazon Alexa and not connected to a Wi-Fi network.

Specifications, software updates, and third party content are subject to change without prior notice.

# OVERVIEW

## Speaker Controls & Inputs

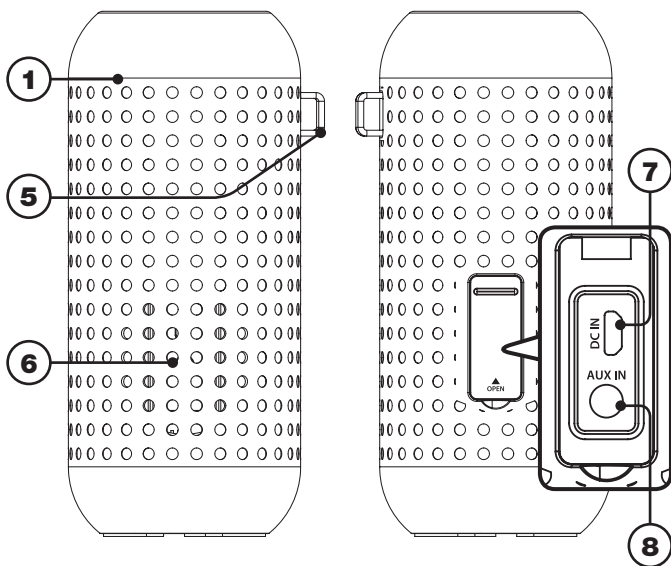
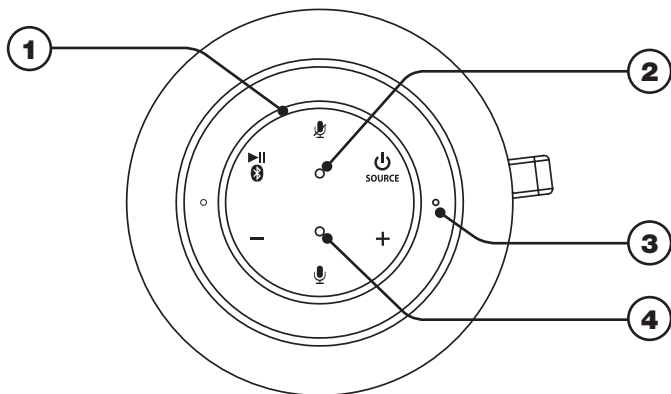

1. **Alexa Indicator Lights**
2. **Alexa Mute Indicator Light**
3. **Microphones (x2)**
4. **Source Mode Indicator Light**

5. **Carabiner Clip Attachment**
6. **Speaker**
7. **USB Charging Port (5V 1A)**
8. **Aux In (3.5mm audio input)**

## Control Functions



### » **Alexa ON**

Press to activate Amazon Alexa and say a command. You can also just say, "Alexa..", within range of the speaker's microphones.



### » **Alexa Mute**

Press to mute the microphones and disable Amazon Alexa. Press and hold for 10 seconds to reset the speaker.



### » **Volume**

Press to adjust the volume up or down. You can also ask Alexa to set the volume level by saying, "Alexa, set volume to..".



### » **Play/Pause/Disconnect Bluetooth**

Press to play or pause audio from a connected Bluetooth device. In Bluetooth Mode, press and hold to begin disconnect from a Bluetooth device. *This unit features automatic device pairing, see Initial Bluetooth Connection on pg 10.*



### » **Power/Source**

Press to power the speaker ON.

**SOURCE**

Press and hold to power the speaker OFF.

Press to switch between Bluetooth and Aux modes.

## Source Mode/Connection/Alexa Indicator Lights

### » **Alexa Indicators**

Light Blue - Amazon Alexa listening/responding

### » **Microphone Indicators**

Red - Amazon Alexa and microphones muted

### » **Mode/Connection Indicators**

Flashing Blue - Connecting to Bluetooth

Solid Blue - Bluetooth connected

Solid Green - Aux In

# SETUP

## 1. Charging the Speaker

Use a Micro-USB to USB cable (included) to connect the **DC IN (Micro-USB power input) on the speaker** to the USB port on a powered on computer or USB power adapter (not included).

A fully charged battery will provide up to 5 hours of playtime. Battery life will improve at lower volume levels and decrease at higher volume levels.

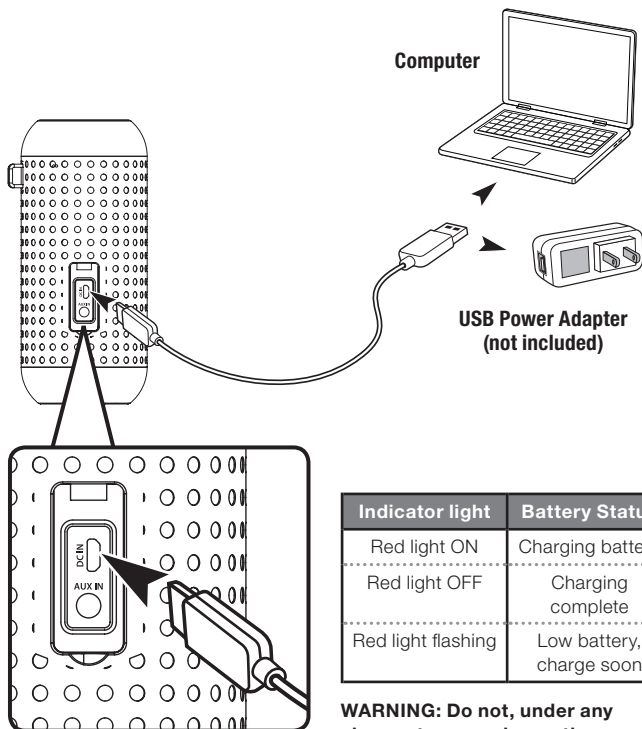

**Power port located under the waterproof cover on the rear of the speaker**

Indicator light	Battery Status
Red light ON	Charging battery
Red light OFF	Charging complete
Red light flashing	Low battery, charge soon

**WARNING: Do not, under any circumstances, charge the speaker while it is near water. Allow ample time to dry after being splashed.**

## 2. Download the Alexa App

Download the Amazon Alexa app to your device by scanning the appropriate QR code below or search for the **Amazon Alexa app** in the Google Play™ Store, or Apple App Store®.

Android



Apple



The Amazon Alexa app connects your speaker to Alexa's voice services. It's also where you can see an overview of your requests and manage your contacts, lists, news, music, and settings.

Once downloaded, open the Alexa app and log into your Amazon account. If you do not already have an Amazon account, choose "Create a new Amazon account" and enter the requested info. Once logged in, the app will prompt you for setup. You can add these details now by choosing "Get Started," or skip these steps and complete the process later. **You cannot use Alexa Voice Services if you aren't logged into an Amazon account.**

## 3. Download the iLive Smart Bluetooth App

The iLive Smart Bluetooth app connects your Amazon account and Amazon Alexa Voice Services with the speaker. Download our free app to your device by scanning the QR codes below or search for the **iLive Smart Bluetooth** app in the Google Play™ Store, or Apple App Store®.

Android



Apple



**Note: This app is designed for mobile devices only, such as smartphones or Wi-Fi enabled tablets. It is not available for use on regular desktop or laptop computers.**

**If you are not connected to a Wi-Fi network, using Amazon Alexa may use your mobile carrier's data to fulfill requests and answer questions.**



# SETUP

## 3. iLive Smart Bluetooth App

To use the speaker with Amazon Alexa, your mobile device must both be connected to a Wi-Fi network and signed into the Amazon Alexa app. The iLive Smart Bluetooth app uses a Bluetooth connection with your device to access Wi-Fi and Alexa. The app will guide you through the connection process, just follow the on-screen instructions.

After the initial Bluetooth connection, the speaker will automatically have access to Amazon Alexa, as long as your device is signed in to the Amazon Alexa app.

### Initial App Connection

*Note: If you have a dual band wireless router, be sure your device is connected to the 2.4GHz band, not the 5GHz band.*

1. Press and hold the **Power/Source** button to power on the speaker. Be sure the speaker is in Bluetooth Mode, indicated by a slowly flashing blue light from the Mode/Connection LED and a voice prompt from the speaker. *If the speaker is not in Bluetooth Mode, press the Power/Source button to switch to it (Image A, below).*
2. Open the app and begin following the on screen instructions (Image B, below).

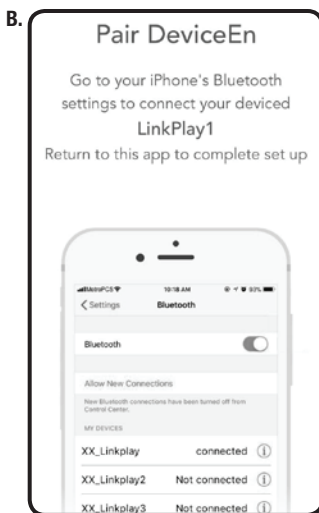
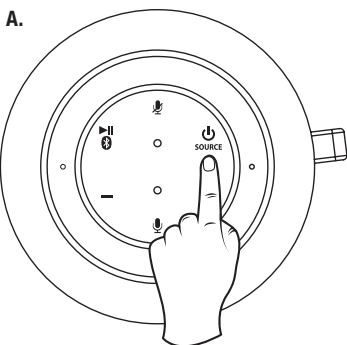

3. On your Bluetooth device, open the Bluetooth Settings and select **ISBWV418** from the list of available devices. *It may take a moment before your device detects the speaker and is available in the list. When pairing, remain within 3 ft. of your device. You may also need to scan for Bluetooth devices manually from your mobile device (Image C, below).*
4. When successfully paired, the **Mode/Connection LED** on the speaker will turn solid blue and a voice will announce the connection. Audio from the connected device will now be played through the speaker.
5. Return to the iLive Smart Bluetooth app. After a few moments, the app should automatically pair with your phone (Image D, below).

**Setup instructions continued on the next page.**

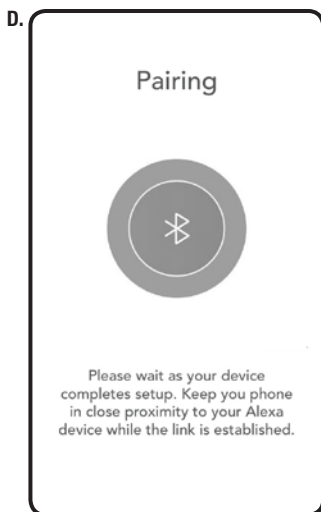
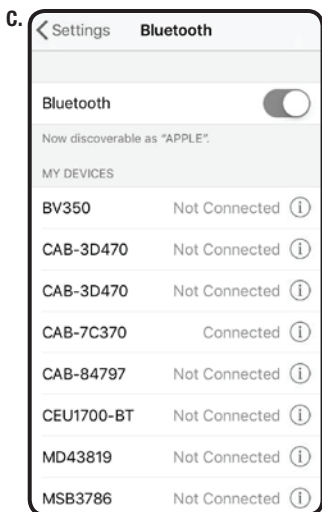

# SETUP

## Initial App Connection (continued)

6. When the connection is complete, the app will prompt you to link the speaker with the Amazon Alexa app on your device (*Image E, below*). **If you do not have the Amazon Alexa app on your device, refer to the instructions on pg. 9.**
7. Enter your Amazon account information to complete setup and begin using Amazon Alexa with your speaker (*Image F, below*).
8. To work properly, Amazon Alexa needs permission to record and store audio in the cloud. To continue with Alexa setup, accept the terms to allow Alexa the permissions required (*Image G, right*).
9. Press "Done" to finish setup and begin using your speaker (*Image H, right*).

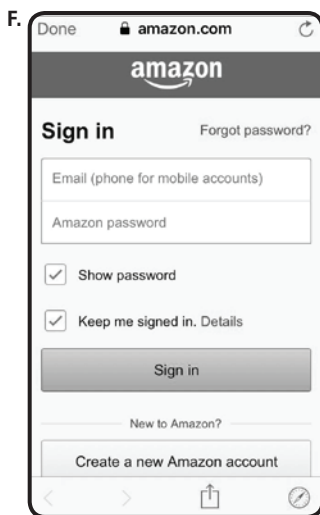
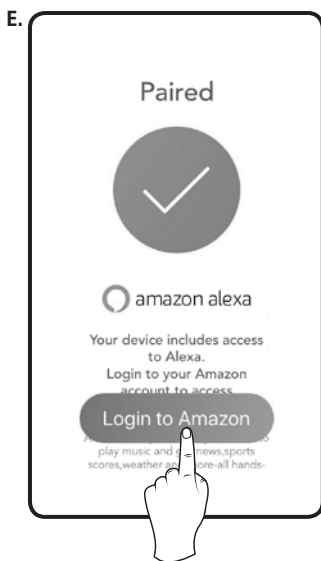

## 4. Things to Try with Alexa

Now that you're connected, try interacting with Alexa. Start by saying "Alexa," followed by a command or question. Here are some examples:

- » "Alexa, tell me a joke."
- » "Alexa, what's in the news?"
- » "Alexa, add apples to my shopping list."
- » "Alexa, what can you do?"

While the speaker is on, Alexa is in standby mode, awaiting a command or question from you. All you need to do is say "Alexa...", within range of the speaker's microphones and she will respond. When Alexa is listening and responding to your commands, the Mode/Connection indicators on the speaker will light up bright blue, accompanied by a chime. You can also press the  button on the speaker to manually activate Alexa.

You can mute Alexa and disable the microphones by pressing the  button. The Microphone Mute indicator will turn solid red while muted. This only affects Alexa, the speaker's audio functions will still work normally.

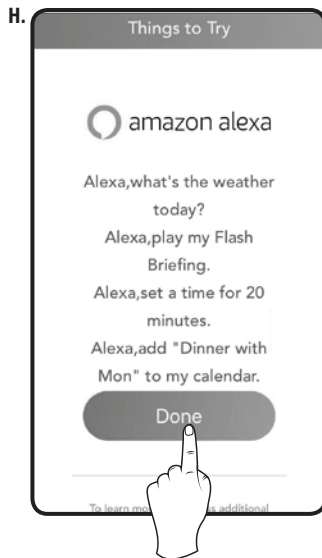
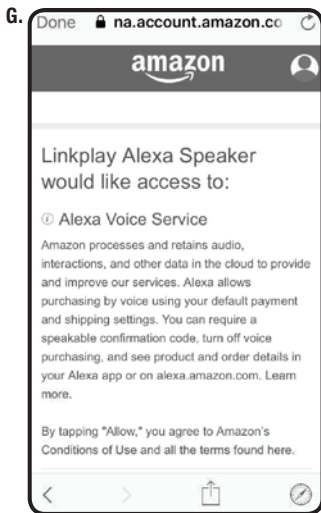

# SMART BLUETOOTH APP

## Home Screen

This is the default screen when you open the iLive Smart Bluetooth app.

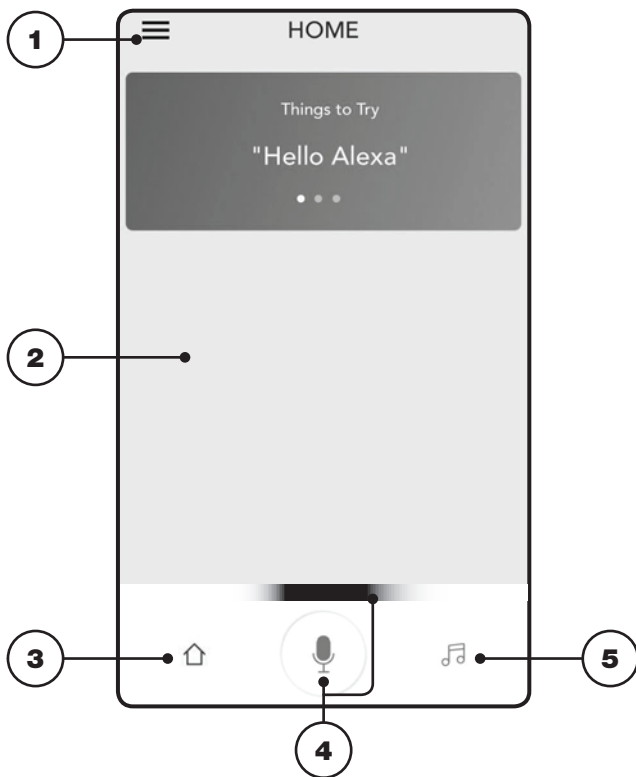

### 1. Menu & Settings

View and adjust settings.

### 2. Information Area

Displays information from Alexa, for example weather, shopping list, etc.

### 3. Home

Press to go to the Home screen.

### 4. Alexa Button/Indicator

Press to activate Alexa and ask her a question.

### 5. Music

Press to go to the Music player.

## Menu Screen

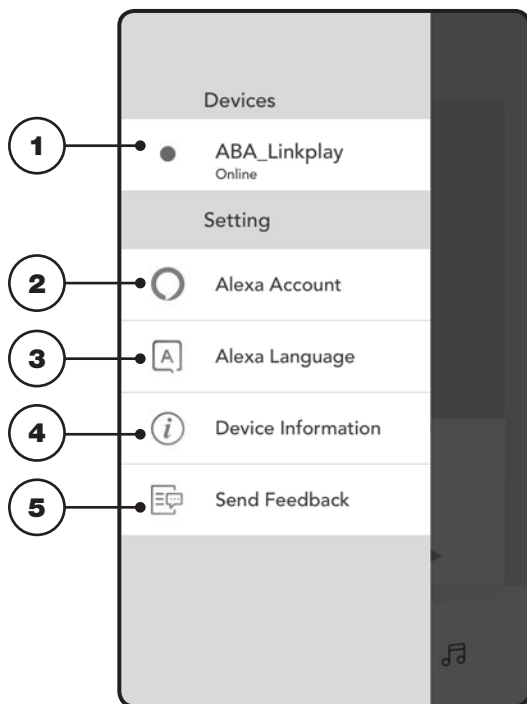

### 1. Devices

Linked devices shown here.

### 2. Alexa Account

Sign in or out of Amazon Alexa.

### 3. Alexa Language

Press to change Alexa's interface language.

### 4. Device Information

View and change the device name.

### 5. Send Feedback

Send feedback to the app developer.

# SMART BLUETOOTH APP

## Music Player Screen

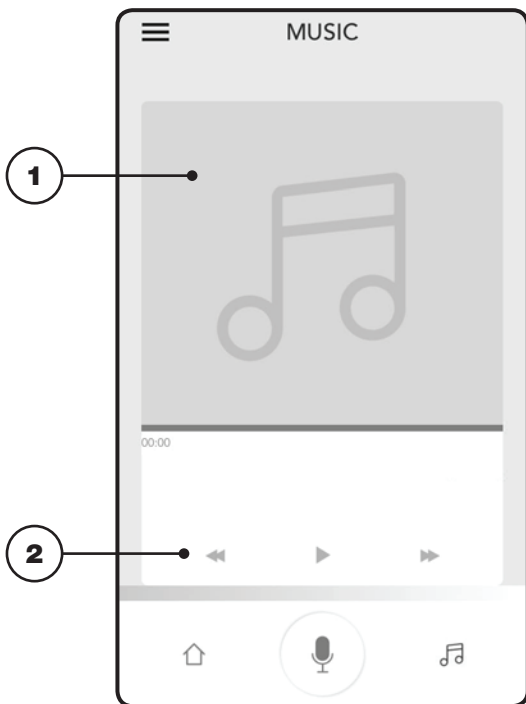

### 1. Audio information

Artist and track info displayed here.

### 2. Play Controls

Use to play, pause, or skip audio.

# OTHER WAYS TO PLAY

## Bluetooth Without the App

The speaker can also function as a standard Bluetooth speaker without using the app or Amazon Alexa Voice Services. Use a connected Bluetooth device to select and begin playing audio. Use the controls on the device or the speaker to play, pause, or skip audio.

## Aux In

Requires a 3.5mm audio cable (included).

- » Power on the speaker, then press the **Power/Source** button again to select **Aux In Mode**, indicated by a solid green LED light.
- » Connect a 3.5mm audio cable to the **Aux In** on the unit and the **audio output/headphone jack** on an audio device.
- » Audio played through the connected device will now be heard through the speakers. Use the controls on the connected device to play, pause, or skip selected tracks.

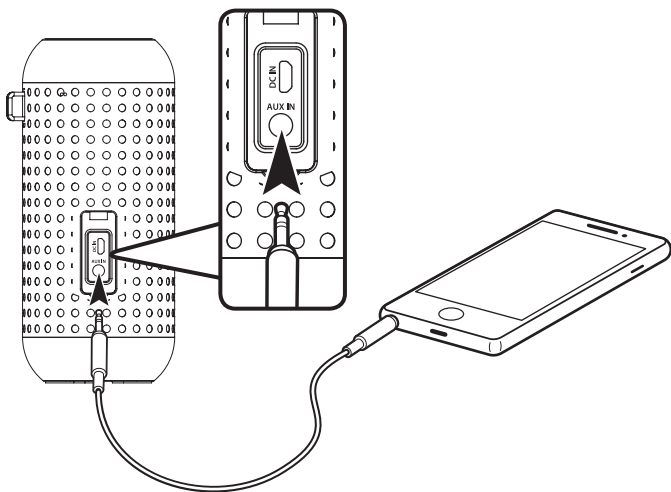



# TROUBLESHOOTING

<b>PROBLEM</b>	<b>POSSIBLE SOLUTION</b>
Speaker will not power on	<ul style="list-style-type: none"><li>» Make sure the speaker's battery is charged. Recharge if needed.</li></ul>
Intermittent audio/Audio doesn't play	<ul style="list-style-type: none"><li>» Make sure the volume on the speaker and your connected device is turned up to an audible level.</li></ul>
Audio distortion	<ul style="list-style-type: none"><li>» Volume on the speaker or connected Bluetooth device may be too high. Reduce the volume of one or both of the devices.</li></ul>
Bluetooth won't play or fails to connect	<ul style="list-style-type: none"><li>» Make sure the volume on your Bluetooth device is turned up to an audible level.</li><li>» Make sure the speaker's battery is charged and is powered on.</li><li>» Make sure both the speaker and your device are in Bluetooth mode.</li><li>» Stay within 3 ft. of the speaker when pairing.</li><li>» Stay within 33 ft. of the speaker when paired.</li></ul>
Amazon Alexa not responding	<ul style="list-style-type: none"><li>» Be sure the connected Bluetooth device is connected to a Wi-Fi network or mobile data.</li><li>» Be sure the connected Bluetooth device has the Amazon Alexa app and is logged into your Amazon account.</li><li>» Be sure the Wi-Fi network or router is functioning normally. Restart if needed.</li></ul>
White noise/Speaker will not function properly	<ul style="list-style-type: none"><li>» Power the speaker OFF, then ON again.</li><li>» Hold down the  button for 10 seconds to reset the speaker.</li></ul>

# CUSTOMER SUPPORT

## Contact Information

Website: [www.iLiveElectronics.com](http://www.iLiveElectronics.com)  
Email Support: [prodinfo@dpiinc.com](mailto:prodinfo@dpiinc.com)  
Email Parts: [partsinfo@dpiinc.com](mailto:partsinfo@dpiinc.com)  
Phone Support: 1-888-999-4215

## Warranty Information

For Warranty Information and the most up-to-date version of this User's Guide, go to **[www.iLiveElectronics.com](http://www.iLiveElectronics.com)**.

## International Support

To download this User's Guide in English, Spanish, or French, or to get answers to frequently asked questions, visit the support section at:

**[www.iLiveElectronics.com](http://www.iLiveElectronics.com)**

Para descargar este Manual del Usuario en inglés, español y francés, o para obtener respuestas a preguntas frecuentes, visite la sección de apoyo en:

**[www.iLiveElectronics.com](http://www.iLiveElectronics.com)**

Pour télécharger ce guide de l'utilisateur en anglais, espagnol ou français, ou pour obtenir des réponses à des questions fréquemment posées, consultez la rubrique:

**[www.iLiveElectronics.com](http://www.iLiveElectronics.com)**



***Protect for Today  
Sustain for Tomorrow***

Copyright © 2018 Digital Products International (DPI, Inc.)

Amazon, Alexa and all related logos are trademarks of Amazon.com, Inc. or its affiliates.

All other trademarks appearing herein are the property of their respective owners.