

**POWERED
AIR SURFER**
Rule the Air

IMPORTANT:

- Please read instructions carefully before playing!
- Keep these instructions as they contain important information.

ITEM NO.14022

AGES 8+

AEROSHOCK HOVERCRAFT
1:12 TURBO
Rechargeable Battery Pack
(Battery not included)

RAJOO CONTROLLER
1 x 1.5V
ALUMINUM BATTERY
(Battery not included)

AEROSHOCK HOVERCRAFT™

INSTRUCTION MANUAL

Ride on a Cushion of Air! Aeroshock Hovercraft is a radio control hovercraft with firing rocket launcher! Lift up off the ground with two powerful air-lifting fans and go into TURBO DRIVE! Remember to drive your Aeroshock Hovercraft on smooth, dry and clean surfaces to experience the ultimate hovercraft adventure!

SAFETY PRECAUTIONS!

Adults, to ensure that the child's play is both safe and fun, please review operating instructions and the following safety rules before operating vehicle.

- Do not pick up vehicle while in motion.
 - Keep fingers, hair and loose clothing away from the air-lifting fans while the vehicle is in operation.
 - To avoid accidental operation, remove battery pack when not in use.
1. We suggest the use of rechargeable batteries.
 2. Radio interference is caused by the presence of another radio-controlled vehicle operating on the same frequency as our vehicle.
 3. Radio interference can be caused by the operation of your vehicle near high voltage electrical wires, large steel reinforced concrete buildings and passing trains with CB radios.
 4. DO NOT operate your vehicle over wet surfaces. Water can damage the internal electronic assemblies.
 5. DO NOT drive your remote control vehicle into streets.
 6. For best results, hold antenna up, not pointed down toward the R/C vehicle. Too far away from the controller, your signal strength will become weak and the vehicle will not function properly.

GETTING TO KNOW YOUR AEROSHOCK HOVERCRAFT

CONTENTS:

- 1 Aeroshock Hovercraft
- 1 Pilot Figure
- 1 Controller
- 1 Steering Wheel
- 2 Stabilizer Wings
- 6 Rockets

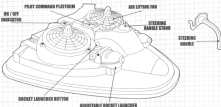

BATTERY REQUIREMENTS FOR AEROSHOCK HOVERCRAFT

Aeroshock Hovercraft is powered by a 7.2V rechargeable battery pack (not included). Make sure you fully charge the rechargeable battery pack before you play. Follow the manufacturer's charging instructions for use.

NOTE:

1. Do not recharge battery pack if it is hot. Allow battery pack to cool before recharging.
2. Do not use, charge or store the batteries near fire, hot or wet places.
3. Charging times differ with ages and conditions of battery packs and chargers.
4. Recharge battery pack after electrical power is fully discharged.

ATTENTION !!! IMPORTANT BATTERY INFORMATION

- Use only fresh batteries of the required size and recommended type.
- Do not mix old and new batteries, different types of batteries (standard alkaline, or rechargeable), or rechargeable batteries of different capacities. We suggest the use of rechargeable batteries.
- Please respect the correct polarity (+) and (-).
- Non-rechargeable batteries are not to be recharged.
- Do not throw batteries into the fire.
- Remove rechargeable batteries from the toy before being charged.
- Rechargeable batteries are only to be charged under adult supervision.
- Use only the battery types as recommended.
- Replace all batteries of same type/brand at the same time.
- Do not short-circuit the battery contacts.
- Remove exhausted batteries from the toy.
- Batteries should be replaced by adults because of small parts.

BATTERY INSTALLATION

When using the 7.2V Rechargeable Battery Pack (not included), follow the manufacturer's charging instructions. PLEASE NOTE: the battery pack may become hot during use, make sure to handle with care.

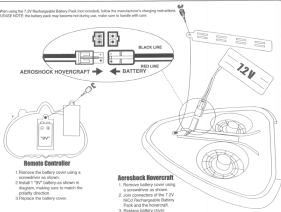

1. Remove the battery cover using a screwdriver as shown.
2. Install 1 "7V" battery-as shown in diagram, making sure to match the polarity direction.
3. Replace the battery cover.

Aeroshock Hovercraft

1. Remove battery cover using a screwdriver as shown.
2. Join connectors of the 7.2V NiCd Rechargeable Battery Pack and the hovercraft.
3. Replace battery cover.

Note:

1. Quality of control function may deteriorate when battery power is low.

STEP 1: ASSEMBLY AND ROCKET LAUNCHERS

1 Attach stabilizer wings.



2 Attach rockets to vehicle.



3 Attach steering handle. Insert rockets into launchers. Press button to launch rockets.



STEP 2: OPERATING AEROSHOCK HOVERCRAFT

TURN POWER ON



Turn power ON for the hovercraft and radio controller as shown.

FORWARD



STOP



2-SPEED TURNING:

Using the TURBO DRIVE button, you can turn Aeroshock Hovercraft at 2-Speeds.

Practice turning at different speeds and be a Pro-Pilot!

- Press Turbo Drive once for super-fast hairpin turns.
- Press Turbo Drive again for turns with precision and control.

4 WIDE LEFT TURN

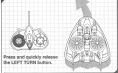

5 WIDE RIGHT TURN

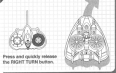

6 SHARP LEFT TURN

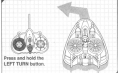

7 SHARP RIGHT TURN



STEP 3 - TIPS & HINTS

1. Drive with total steering control! Make turns with the TURBO DRIVE button off, then when the hovercraft is facing the direction you want, press the TURBO DRIVE button once and watch it go!
2. Remember that when the hovercraft is coming towards you, the steering is opposite to the way you turn. Try imaging that you are standing on the pilot's platform and this will help you turn the way you want.
3. The illuminated red light on the hovercraft and the radio controller indicate that they are in operation.
4. Turn the hovercraft and radio controller to OFF when not in use.

TROUBLESHOOTING GUIDE

This device complies with Part 15 of the FCC Rules. Operation is subject to the following two conditions: (1) This device may not cause harmful interference, and (2) this device must accept any interference received, including interference that may cause undesired operation.

NOTE: This equipment has been tested and found to comply with the limits for a Class B digital device, pursuant to Part 15 of the FCC Rules. These limits are designed to provide reasonable protection against harmful interference in a residential installation. This equipment generates, uses and can radiate radio frequency energy and, if not installed and used in accordance with the instructions, may cause harmful interference to radio communications. However, there is no guarantee that interference will not occur in a particular installation. If this equipment does cause harmful interference to radio or television reception, which can be determined by turning the equipment off and on, the user is encouraged to try to correct the interference by one or more of the following measures:

- * Reorient or relocate the receiving antenna.
- * Increase the separation between the equipment and receiver.
- * Connect the equipment into an outlet on a circuit different from that to which the receiver is connected.
- * Consult the dealer or an experienced radio / TV technician for help.

WARNING:
Changes or modifications to this unit not expressly approved by the party responsible for compliance could void the user's authority to operate the equipment.



Manufactured and Distributed by:
© 2003 WowZone
All Rights Reserved
WowZone (USA) PMS, CO
5011 51st Ave. S, Scottsdale, AZ,
U.S.A. East: Hong Kong
WowZone (World America Office)
4888 Centre Street, Suite 100,
Tulsa, Oklahoma, 74101, Canada
Customer Hotline: (516) 244-1244
<http://www.wowzone.com>

WZ030001