

DWG NO.	1301-SVB 154 405 Uen	SH 1	REV A
REVISIONS			
REV	DESCRIPTION	DATE	APPROVED
A	SEE CR 102970 N.BOURGET	02/11/03	SIG ON FILE

ALL DATA AND INFORMATION CONTAINED IN OR DISCLOSED BY THIS DOCUMENT IS CONFIDENTIAL AND PROPRIETARY INFORMATION OF ERICSSON WIRELESS COMMUNICATIONS INC. AND ALL RIGHTS THEREIN ARE EXPRESSLY RESERVED. BY ACCEPTING THIS MATERIAL THE RECIPIENT AGREES THAT THIS MATERIAL AND THE INFORMATION CONTAINED THEREIN IS HELD IN CONFIDENCE AND IN TRUST AND WILL NOT BE USED, COPIED, REPRODUCED IN WHOLE OR IN PART, NOR ITS CONTENTS REVEALED IN ANY MANNER TO OTHERS WITHOUT THE EXPRESS WRITTEN PERMISSION OF ERICSSON WIRELESS COMMUNICATIONS INC. THIS TECHNOLOGY IS CONTROLLED BY THE UNITED STATES GOVERNMENT. DIVERSION CONTRARY TO U.S. LAW PROHIBITED.

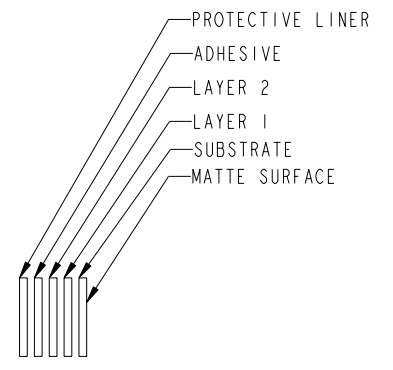
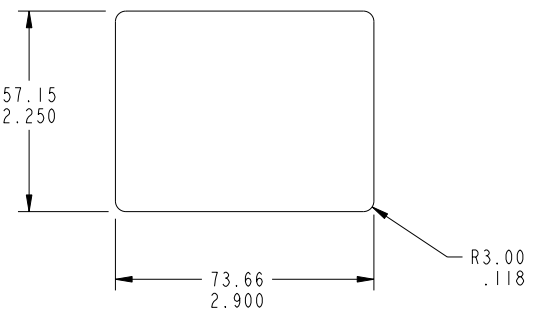

LAYER CONFIGURATION

LABEL SLASH NO.	ARTWORK FILE	ARTWORK REVISION	ARTWORK LAYER NO.	COLOR
/1	190 89-SVB 154 405	A	1	BLACK FED-STD-595 NO.27038 SEMI-GLOSS
			2	WHITE FED-STD-595 NO.27925 SEMI-GLOSS

12. DURABILITY TEST TO COMPLY WITH UL 1950 STANDARD THIRD EDITION, PARAGRAPH 1.7.15.
11. PART TO BE MANUFACTURED IN ACCORDANCE WITH UL 969 STANDARD.
10. TEMPERATURE RATING: LABEL MATERIAL, ADHESIVE AND INK MUST BE SUITABLE FOR CONTINUOUS USE FROM -40°C (-40°F) TO +70°C (+158°F).
9. ARTWORK WAS CREATED IN CORELDRAW 9.0. DEVIATION FROM SPECIFIED FONT(S) NOT PERMITTED WITHOUT PRIOR APPROVAL BY EWU.
8. FOR ARTWORK USE ELECTRONIC DATA 190 89-SVB 154 405 AND APPROPRIATE SLASH NUMBER AND REVISION PER TABLE 1.
7. BAG AND TAG ITEM IN ACCORDANCE WITH EWU PRODUCT IDENTIFICATION MARKING SPECIFICATION GS80-31042-1, MARKING CODE 101, CONTENT/FORMAT OPTION 1.
6. USE COLORS SPECIFIED IN TABLE 1. COLOR SAMPLES TO BE VISUALLY INSPECTED AND APPROVED BY EWU PRIOR TO MANUFACTURE.
5. MATERIAL:
 - a. SUBSTRATE: 0.25/.010 THK POLYCARBONATE UL94-V0 SHEET. VELVET MATTE, GE-LEXAN FR65-112.
 - 3M LAMINATING ADHESIVE #468MP. NO SUBSTITUTIONS PERMITTED WITHOUT PRIOR APPROVAL BY EWU.
4. WORKMANSHIP SHALL BE IN ACCORDANCE WITH ERICSSON WIRELESS COMMUNICATIONS INC. (EWU) MECHANICAL WORKMANSHIP STANDARD 80-10767-1.
3. INTERPRET DIMENSIONS AND TOLERANCES PER ASME Y14.5M-1994.
2. MILLIMETERS (MM) ARE THE CONTROLLING DIMENSIONS ON THIS DRAWING. INCH DIMENSIONS ARE FOR REFERENCE ONLY.
1. INTERPRET DRAWING PER MIL-STD-100.

NOTES: UNLESS OTHERWISE SPECIFIED

PRELIMINARY

ERICSSON PROPRIETARY
COPYRIGHT (C) 2003 ERICSSON WIRELESS COMMUNICATIONS INC (EWU). ALL RIGHTS RESERVED.

MM
INCHES

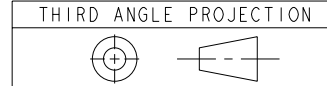

UNLESS OTHERWISE SPECIFIED
DIMENSION UNITS APPLY
AFTER SURFACE TREATMENT

TOLERANCES		
MM	LINEAR	ANGULAR
X	± 2.5	.X ± .1
X.X	± 0.76	.XX ± .03
X.XX	± 0.25	.XXX ± .010

HOLE DIAMETERS		
MM	INCHES	INCHES
0.34 - 6.35	+0.13 -0.03	.013 - .250 +.005 -.001
6.37 - 12.70	+0.15 -0.03	.251 - .500 +.006 -.001
12.72 - 25.40	+0.25 -0.03	.501 - 1.000 +.010 -.001

CONTRACT NO.	NONE	DATE	02/11/03
DRW	N. BOURGET	CHK	REDD SIG ON FILE
ENG		P. E.	
MFG			
TITLE			
<p style="text-align: center;">LABEL, RBS 1130, REGULATORY</p>			
SIZE	DRAWING NO.	REV	
D	1301-SVB 154 405 Uen	A	
SCALE	1/1	SHEET	1 OF 1