

Before Flying

To insure a good flight, make sure the area you are flying in is open and free of obstacles. When first learning how to fly, give yourself lots of room to fly and land in. As you get more experienced and have more control of your LiteHawk ZOOM you can fly in smaller areas. Early mornings or dusk are great times to learn how to fly, because winds are at their calmest. When flying in a field with tall grass or uneven ground, remove landing gear and belly land the ZOOM. Do not fly in the following places: Near crowds or high voltage, near any obstacles, wind speeds over 5km/h (3mph), thunder, rain or snow or between high buildings.

Learn To Fly

- Hand Launching Your LiteHawk ZOOM.**
- Stand in the middle of the wide area, facing the wind. (Remember under 5km/h wind).
 - Hold the plane in your right hand.
 - Move the left joystick (throttle stick) to max power.
 - Toss the plane into the wind slightly upwards angle. This is the easiest and best way for beginners first flights.
 - Once you have let go of the plane, move your right hand onto the radio to operate the right control stick. Pull down on the right side control stick to help the plane climb into the sky.
 - Once you are comfortable with the height of the plane reduce the throttle speed.

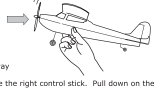

Basic Flying Pattern

- Once you have your LiteHawk ZOOM up in the air and at a comfortable height. You can begin flying a standard pattern. It is important, when learning, to fly in a standard pattern. This way you won't get confused with controls or direction.
- The standard flying pattern is to perform ovals to the right. As you make the oval circuit when in a straight flight you can move the throttle stick and elevator stick up and down to see how the plane reacts.

LiteHawk ZOOM Controls

- Elevator control:** To go up: Move the right joystick downwards. To go down: Move the right joystick upwards

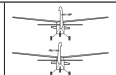

Activate or "Sync" the radio and plane together

- 1 Switch the transmitter power ON.
- 2 Plug in the plane's battery.
- 3 Push the left hand joystick from the bottom all the way to the top, and then back to rest in the bottom position. This may take a few seconds to sync. The radio will also beep twice and the blinking green light will change to a solid green colour.
- 4 Unplug the plane battery, then turn off the radio. Your LiteHawk ZOOM is now Bound and ready to fly! This only needs to be done on initial set-up.

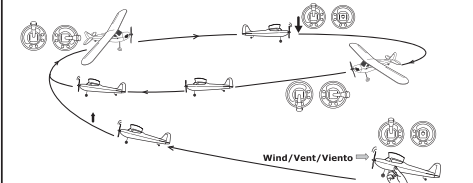

Landing

To perform a safe landing, make sure to fly your plane into the wind. Reduce the throttle slowly until the plane starts to lose altitude. Keep reducing power and adjust the elevator, if needed, to keep the plane level. Keep the nose up as the plane lands!

Wind/Vent/Viento



Radio and Plane Lose Bind

The binding process effectively ties the transmitter and receiver together. Under normal circumstances, both items are supplied like this from the factory and you sync them during the Activation process. However if you find that your transmitter and receiver are not bound (no response to transmitter controls) you should do the following:

1. Press and hold any trim button on the transmitter while turning ON the transmitter's power. The transmitter will continuously beep and the power indicator will blink really fast.
2. Within 5 seconds, install the plane's battery and the beep will stop and the power indicator will blink slow.
3. Push the left throttle joystick to top and bottom. The transmitter will beep twice, and the transmitter and receiver lights will be ON solid. The transmitter and receiver are now bound.

NOTE: If you fail to install the plane's battery within 5 seconds and the transmitter stops beeping, please repeat the binding process above.

10+ LITEHAWK ZOOM

Changes or modifications not expressly approved by the party responsible for compliance could void the user's authority to operate the equipment.

100% Factory Assembled, Tested and Ready To Fly!

PLEASE DO NOT RETURN THIS PRODUCT TO ANY RETAIL STORE.
For any questions or problems with the product please call us at 1-800-268-5707 or visit our website: www.litehawk.ca
Made for and distributed by Borfigest (Canada) Limited 50 Konrad Cres., Markham, ON L3R 8T4

285-12001

Welcome to the World Of LiteHawk Aircraft!

- Welcome aboard Captain, this is for your new LiteHawk ZOOM! Before we get ready for your first aerial adventure, let's cover the basics together.
- The LiteHawk ZOOM is designed for outdoor flight, but you may fly it in larger indoor areas such as a warehouse, or gymnasium.
 - 2.4GHz radio technology makes it possible to fly multiple LiteHawk ZOOM models simultaneously.
 - Your new LiteHawk ZOOM 3CH R/C Plane is a sophisticated model suitable for both advanced R/C flyers and beginners alike! You can master the basics of flying quickly and even attempt simple aerobatics such as looping and figure 8's.
 - Attempting to fly your LiteHawk ZOOM without completely reading the manual may cause injury to yourself and people in the vicinity, as well as damage to the RC model. Please read the instruction Manual thoroughly before taking your first flight.

LiteHawk ZOOM - Precautions / Précautions / Precauciones

- The LiteHawk ZOOM is not intended for children under the age of 10 unless closely supervised by an adult.
- Improper use may cause serious injury. - Please read LiPo Battery section before use. - Do not fly in areas close to high voltage lines or crowds. - Do not fly when wind speed is above 5 km/h (3 mph). - Do not fly in rain, snow or if there is lightning and/or thunder. - Do not touch ANY moving parts while the model is powered.

- WARNING: CHOKING HAZARD** - Small Parts. Not for Children under 3 years.
- CAUTION:** Do not touch the running propeller! Do not play above someone's head! Adult supervision is required!
- DANGER!** Never insert any sharp objects, pins or screws into the plane as this may puncture the internal battery!

SAFETY PRECAUTIONS

1. Always keep hair and loose clothing away from the propeller when power switch is turned ON.
2. Turn off controller/charger and plane when not in use.
3. Remove battery from controller/charger when not in use.
4. Parental guidance is recommended for the flight.
5. Keep your eyes in your sight so that you supervise it at all times.
6. New alkaline batteries are recommended for use in controller to obtain maximum performance.
7. Your charger is built-in for the LiPo battery used in your LiteHawk ZOOM. Do not use it to charge any battery other than that in the LiteHawk ZOOM.

Battery Safety Information

- Requires 1 x 3V AA batteries.
- Batteries are small objects.
- Replacement of batteries must be done by adults.
- Follow the polarity (+/-) diagram.
- Promptly remove dead batteries from the toy.
- Dispose of used batteries properly.
- Remove batteries for prolonged storage.
- DO NOT reuse used batteries.
- DO NOT dispose of batteries in fire, as batteries may explode or leak.
- DO NOT mix old and new batteries or different types of batteries (i.e. alkaline/zinc-air).
- DO NOT short-circuit the supply terminals.

SPECIAL NOTE TO ADULTS

- This toy is not intended for children under the age of 3.

CARE AND MAINTENANCE

- Always remove batteries from the toy when it is not being used for a long period of time. (controller/charger only)
- Keep the toy away from direct heat or extreme cold.
- Do not submerge the toy in water. This can damage the electronic assemblies.

Your LiteHawk ZOOM is equipped with a Lithium Polymer battery.

Special LiPo Battery Instructions

- Never charge battery unattended.
- Charge battery in isolated area. Keep away from flammable materials.
- Do not expose to direct sunlight. There is a risk of the batteries exploding, overheating or igniting.
- Do not disassemble, modify, heat or short circuit the batteries. Do not place them in fires or leave them in hot places.
- Do not allow the batteries to get wet.
- Only charge the batteries with the specified battery charger.
- Only use the batteries in the device specified by LiteHawk.
- In the unlikely event of leakage or explosion use sand or a chemical fire extinguisher for the battery.
- Batteries must be recycled or disposed of properly.

Before charging the Litehawk ZOOM please read the following!

- DO NOT leave the battery unattended during charging.
- DO NOT leave the battery plugged into the charger any longer than 2 hours. If the Red light does not go out in this time, the charger or battery could be faulty - unplug immediately!
- DO NOT drain the battery to the point at which you can no longer lift off. Stop using the ZOOM when you begin to lose significant power.
- DO NOT install another battery without letting the motor cool first! 5-10 minutes is sufficient.
- DO NOT recharge the battery until it is cool to the touch! 10 minutes is sufficient.
- DO NOT store battery for longer than 24 hours without recharging to at least 65% capacity.

Do Not Fully Discharge the battery! Stop and recharge when your ZOOM begins to lose power!
Failing to do so will result in irreparable damage to the battery!

LiteHawk ZOOM - Transmitter Set Up / Installation d'émetteur / Transmisor de instalación

- Battery Installation 1. Open the Battery Cover. 2. If used batteries are present, remove these batteries from the unit by pulling up on one end of each battery. 3. Install new batteries as shown in the polarity diagram (+/-). 4. Replace battery door securely. 5. Check your local laws and regulations for correct recycling and/or battery disposal.

LiteHawk ZOOM - Initial Plane Set Up

- Install the landing gear on your ZOOM:**
- Press the front and rear landing gear into the fuselage. The landing gear is ideal for smooth flat take off and landing areas. If you are going to fly by hand launching, or landing on an uneven surface like tall grass, sand, or even soft snow - you may find it easier not to install the landing gear.

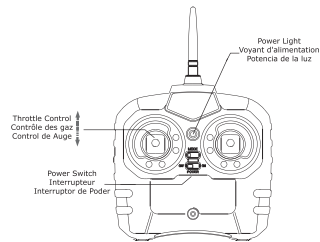

LiPo Battery Charging

- Place the LiPo battery connector lead into the socket on the back of the transmitter.
 - The lower transmitter indicator light will turn red, the battery is now being charged.
 - When lower transmitter indicator light turns off (20-30 mins charging time), the battery is charged.
- Install the LiPo battery**
- a. Take the battery connector from the bottom of the fuselage.
 - b. Connect the battery.
 - c. Fit the battery connector back into the fuselage. The battery is held in place by the velcro.