

Super Digital Walkie Talkie

Item No. Si010

Contents:

- 2 Super Digital Walkie Talkies
- 2 Earphones
- Instruction manual

Product overview:

1. Digital Watch
2. Watch Button A
3. Watch Button B
4. Microphone
5. On/Off Switch
6. Earphone Jack
7. TALK Button
8. Battery Compartment
9. Voice Changer Button
10. LED indicator
11. Earphone

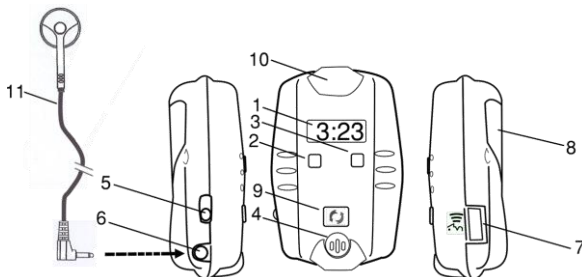

How to use:

A. Pairing:

The two walkie talkies are paired in factory by default and are ready to communicate. In case the units cannot detect each other even in close proximity, try pairing again as follows:

1. It is recommended to switch off any walkie talkies nearby other than the two units for pairing.
2. Press and hold the **TALK** button and **Voice Changer** button while switch on the unit. Wait until the LED indicator flashes quickly. Release both buttons. Repeat for the second unit. Both units should be close to each other.
3. The LED indicator will flash quickly while searching.
4. The LED indicator will flash slowly if pairing is successful. Now the two units can communicate with each other.

B. Talk

1. Plug the earphone (included) into the earphone jack.
2. Switch on both walkie talkies.
3. The LED indicator will flash slowly if both unit are in the listening state.
4. Press and hold the **TALK** button in one unit and speak into the microphone. Release the **TALK** button to listen. The receiving side do not need to press any button.
5. The LED indicators of both units are ON when they are communicating.
6. Talking is allowed in single direction only. Only one unit can talk at a time.
7. Press the **Voice Changer** button on the transmitting side to apply voice changer effect. There are four different effects. Press the **Voice Changer** button to cycle through the effects. Voice returns to normal when pressed the fifth time with a double beep tone. Voice changer effect is cancelled when the unit is switched off.

C. Power-Save Mode

The walkie talkie will enter Power-Save mode if it is left idle for 10 minutes. The LED indicator will be turned off in this state. Press the **TALK** button or **Voice Changer** button to wake up the device. Although the battery drain is reduced in Power-Save Mode, it is highly recommended to slide the ON/OFF switch to OFF when not in use.

D. Controls of Digital Watch:

Normal Display Mode 1: Display Hour: Minute

Press B – Button:

Display shows Month, and Date for 1 second and back to normal time display

Press A – Button

Normal Display Mode 2: Display Hour: Minute and Month, Date alternatively

Press B – Button:

Display shows Second, press again to show normal time

Press A – Button

Time Setting Mode: Allow adjustment of Month, Date, Hour and Minute

Month Setting Mode

Press B- Button : Month advance

Press A Button

Date Setting Mode

Press B- Button : Date advance

Press A Button

Hour Setting Mode

Press B- Button : Hour advance

Press A Button

Minute Setting Mode

Press B- Button : Minute advance

(Minute not adjusted)

(Minute adjusted)

Press A – Button

Press A – Button, then B - Button

Normal Display Mode 1

E. Battery Installation:

Each Super Digital Walkie Talkie uses three AG13/LR44 (1.5V X 3) batteries (included)

1. Unscrew the battery compartment (8) door on the back of the unit.
2. Insert three AG13 (LR44) batteries into the unit with the "+" side on top.
3. Replace the battery compartment door and tighten the screw.
4. Replace with new batteries when the sound becomes weak.
5. Insert new batteries according to the polarity marks.



The Digital Watch (1) uses one LR41 (1.5V X 1) battery (included). Follow the steps below to replace the battery when required.

1. Remove the two screws from the back of the spy listener (a) with a screwdriver (not included).
2. Take out the watch module (b) from the case. Loosen the two screws holding the metal plate of the watch module with a small Phillips/cross head screwdriver (not included).
3. After the metal plate (c) is removed, take the old battery out. Insert a new LR41 battery (d), with the "+" side on top.
4. Replace the metal plate, the watch module and the back cover.

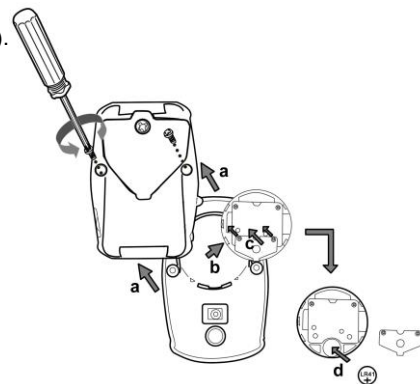

F. LED Indicator

The LED indicator will show the status of the walkie talkie

| LED Indicator | State |
|-----------------|--|
| Flashing (Fast) | Pairing in progress |
| Flashing (Slow) | Idle (Waiting for transmission) |
| On (Constant) | Transmitting/Receiving |
| Off | Walkie Talkie is OFF or in Power-Save Mode |

G. Troubleshooting Your Super Digital Walkie Talkie

| Problem | Solution |
|---|---|
| No sound (green LED indicator is not illuminated) | <ul style="list-style-type: none"> ● Replace all three batteries with new ones. ● The walkie talkie is in Power-Save mode |
| No sound (green LED indicator is illuminated) | <ul style="list-style-type: none"> ● Speak closer and louder into the microphone ● Out of range, move closer ● Press the TALK button when speaking ● Do not press the TALK button when the other side is speaking ● Keep away from radio interference such as microwave cooker, wireless router or other wireless device ● Switch off and switch on again if the above do not resolve the problem |
| No sound (green LED indicator is flashing) | <ul style="list-style-type: none"> ● Out of range, move closer ● Press the TALK button when speaking ● Keep away from radio interference such as microwave cooker, wireless router or other wireless device ● Repeat Pairing by following the steps in Section A |

Batteries required:

Walkie Talkies – 6 x AG13 (LR44) (1.5V X 3) (included)

Digital Watches – 2 x LR41 (1.5V X 1) (included)

IMPORTANT: Keep these instructions. DO NOT DISCARD.



1. Only adults should install and replace batteries.
2. Alkaline batteries are recommended.
3. If the toy has not been used for a long time, remove the batteries.
4. Do not mix old and new batteries.
5. Do not mix alkaline, standard (carbon zinc) or rechargeable (nickel cadmium) batteries.
6. Exhausted batteries are to be removed from the toy.
7. The supply terminals are not to be short-circuited.
8. Non-rechargeable batteries are not to be recharged.
9. Rechargeable batteries are to be removed from the toy before being charged.
10. Rechargeable batteries are only to be charged under adult supervision.
11. Only batteries of the same or equivalent type as recommended are to be used.
12. Batteries are to be inserted with the correct polarity.
13. Do not dispose of batteries in fire, batteries may explode or leak.
14. Batteries may explode or leak if misused.

Note: Under the environment with electrostatic discharge, the device may reset and require user to switch off and switch on and set the time again.



If at any time in the future you should need to dispose of this product please note that waste electrical products should not be disposed of with household waste. Please recycle where facilities exist. Check with your Local Authority or retailer for recycling advice.(Waste Electrical and Electronic Equipment Directive)

FCC Information FCC ID: OIJSI0101

This device complies with Part 15 of the Federal Communications Commission (FCC) Rules. Operation is subject to the following two conditions:

- This device may not cause harmful interference.
- This device must accept any interference received, including interference that may cause undesired operation.

CAUTION:

Changes or modifications to this unit not expressly approved by the party responsible for compliance could void the user's authority to operate this equipment.

This equipment has been tested and found to comply with the limits for a Class B digital device, pursuant to Part 15 of the FCC Rules. These limits are designed to provide reasonable protection against harmful interference in a residential installation. This equipment generates, uses and can radiate radio frequency energy and, if not installed and used in accordance with the manufacturer's instructions, may cause interference harmful to radio communications.

There is no guarantee, however, that interference will not occur in a particular installation. If this equipment does cause harmful interference to radio or television reception, which can be determined by turning the equipment off and on, the user is encouraged to try to correct the interference by one or more of the following measures:

- Reorient or relocate the receiving antenna.
- Increase the separation between the equipment and receiver.
- Connect the equipment to an outlet on a circuit different from that to which the receiver is connected.
- Consult the dealer or an experienced radio or TV technician for help.