

Instruction Manual for Wireless Headset



HW-N9M Wireless gaming headset

Instruction Manual

1. Product accessories

- A, Headset -----1PCS
- B, Detachable Microphone-----1PCS
- C, Transmitter -----1PCS
- D, Type C to USB Cable -----1PCS
- E, Charger Cable -----1PCS
- F, 3.5mm Audio Cable-----1PCS

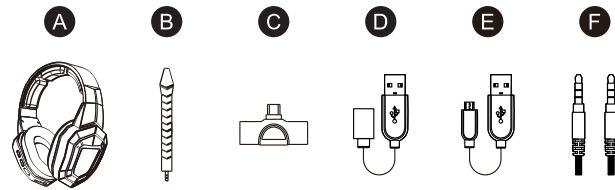

2. Function overview

Transmitter

- 1) Type-C Plug
- 2) Working indicator light

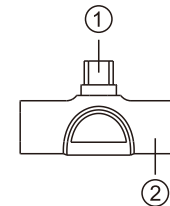

Note: This transmitter can work for Nintendo Switch and most Android phones, Can't work for apple devices.

Headset

- 1) Microphone Port
- 2) Power Button(Long press 2 seconds on/off)
- 3) Pairing Button (Long press 3 seconds to pairing)
- 4) Mute Button
- 5) Volume +/-
- 6) AUX Port
- 7) Charging port
- 8) Charging indicator light
- 9) Working indicator light

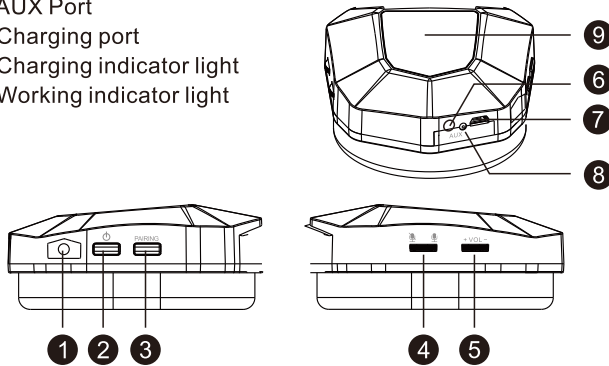

3. Charging method

Please use the charging cable to charge the headset, when it is charging , the charging indicator light is on; it takes around 10 hours to complete charging; when it is fully charged, the red light is off.

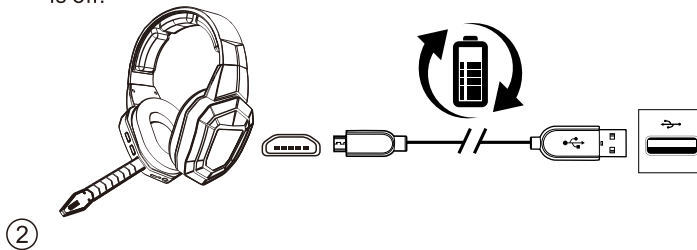

4. Pairing

- 1) Connect the transmitter, LED indicator light is flashing.
- 2) Power on the Headset, LED indicator light is flashing.
- 3) Press and hold the pairing button on the headset, the LED lighting is fast flashing.
- 4) After successful pairing, the headset and transmitter indicators light up permanently.

5. Operation

- 1) The first time use the headset or a long time without charging, Please charge it again for 6 hours.
- 2) -When charging, the red light will keep on lighting. After fully charged, the red light will go out.
-When the headset battery is low, the Red light will flash slowly.
- 3) When the headset and transmitter are not paired, the blue light will flash; if they are paired, the blue light will keep on lighting .
- 4) The default for microphone is on. When the microphone is mute; Transmitter Red light on. When turn on the microphones , the transmitter red light off.
- 5) A:When the headset is wired connection. The headset turns off automatically.
B:Unplug the audio cable.The headset wireless function is switched back on.

6. Switch Connection

Please use transmitter connect the USB Cable and plug into Switch TV dock. Be careful to avoid loose plugs,Otherwise, it causes no sound.

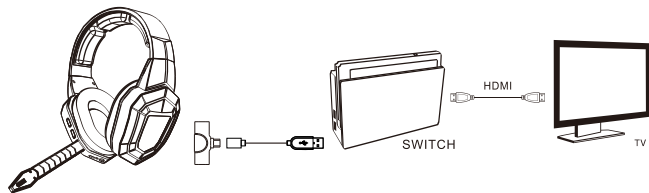

Please use transmitter connect the Switch.

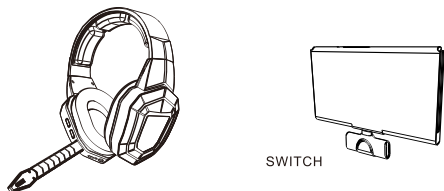

When the headset no power, Also can use AUX cable connect the switch.

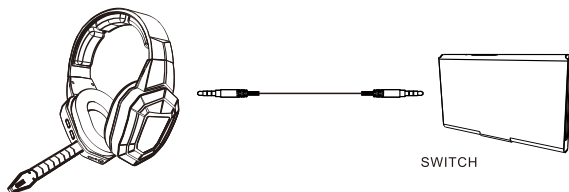

7. Phone Connection

Please use transmitter connect the Type-C Phone.
(Apple phones can't chat.)



④

8. Wired Connection

Please use 3.5mm audio cable connect between headset and AUX device.

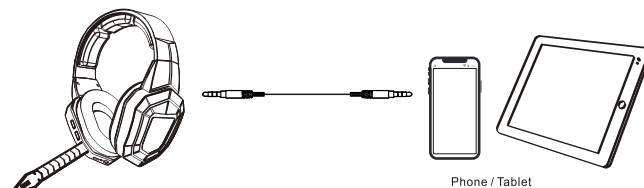

9. PS4/PS5/PC Connection

Please use transmitter connect the USB Cable, then plug in a device that supports USB audio.

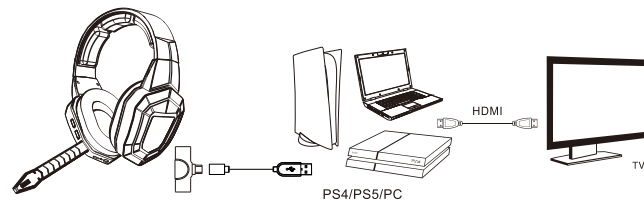

10. Xbox one/Xbox series X/s Connection

Please use AUX cable connect between headset and xbox controller.
Note: Wireless connection to xbox does not support chat.

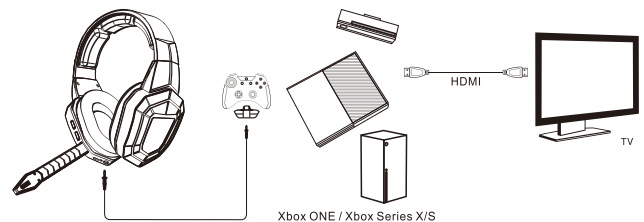

⑤

11. Specifications

Transmitter:

Frequency range: 2.404-2.477GHz

Delay time: 20mS

Transmitting power: +6 dBm

Receive sensitivity: -90dBm

Headset

Continuous operating time: ≥24h

Charging time: ≈10h

Frequency range: 2.404-2.477GHz

Delay time: 20mS

Transmitting power: +6 dBm

Receive sensitivity: -90dBm

Diameter of loudspeaker: Φ40mm

Loudspeaker impedance: 32Ω

Frequency response: 20~20KHz

Specification of microphone: 6*2.7mm

Microphone sensitivity: -58dB

NOTE: This equipment has been tested and found to comply with the limits for a Class B digital device, pursuant to part 15 of the FCC Rules. These limits are designed to provide reasonable protection against harmful interference in a residential installation. This equipment generates uses and can radiate radio frequency energy and, if not installed and used in accordance with the instructions, may cause harmful interference to radio communications. However, there is no guarantee that interference will not occur in a particular installation. If this equipment does cause harmful interference to radio or television reception, which can be determined by turning the equipment off and on, the user is encouraged to try to correct the interference by one or more of the following measures:

- Reorient or relocate the receiving antenna.
- Increase the separation between the equipment and receiver.
- Connect the equipment into an outlet on a circuit different from that to which the receiver is connected.
- Consult the dealer or an experienced radio/TV technician for help

Changes or modifications not expressly approved by the party responsible for compliance could void the user's authority to operate the equipment.

This device complies with Part 15 of the FCC Rules. Operation is subject to the following two conditions:

- (1) this device may not cause harmful interference, and (2) this device must accept any interference received, including interference that may cause undesired operation.