

## **Optical wireless gaming headset instruction manual**



**(Work with X BOX 360/PS3/PS4/PC/MAC)**  
**(COMPATIBLE WITH XBOX ONE IF YOU HAVE MICROSOFT  
ADAPTOR OR NEW CONTROLLER)**

## *Contents*

English 02-20

Français 21-40

Español 41-60

Deutsch 61-80

Italiano 81-100

日本語 101-120

## Optical wireless gaming headset instruction manual

Item name : 2.4G optical wireless gaming headset

### 1, Product & accessories :

- A, Headset -----1PCS
- B, Transmitter-----1PCS
- C, Detachable Microphone-----1PCS
- D, Micro USB-USB short cable -----1PCS
- E, Micro USB-USB long cable -----1PCS
- F, Optical cable-----1PCS
- G, 2.5-3.5 Xbox cable -----1PCS
- H, 3.5-3.5 Xbox cable -----1PCS

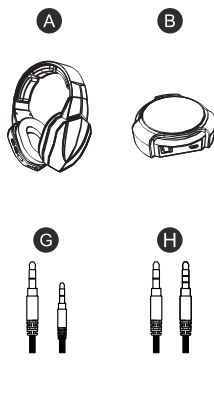

### 2, Connection ports function :

#### Transmitter

- 1, Optical in
- 2, MICRO USB port
- 3, Working indicating light  
(Flashing during pairing, solid blue when paired, solid red while mic muted)

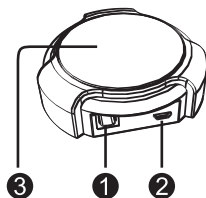

### Headset

- 1. 3.5mm Microphone port
- 2. 3.5mm XBOX port
- 3. Working indicating light (Flashing during pairing , solid blue light paired in use )
- 4. Power button ( long press 3 seconds to power on )
- 5. Mic mute + pairing button
- 6. Game sound volume switch
- 7. Chatting sound volume switch
- 8. USB charging port
- 9. Charging indication (red light on during charging , red light off after fully charge )

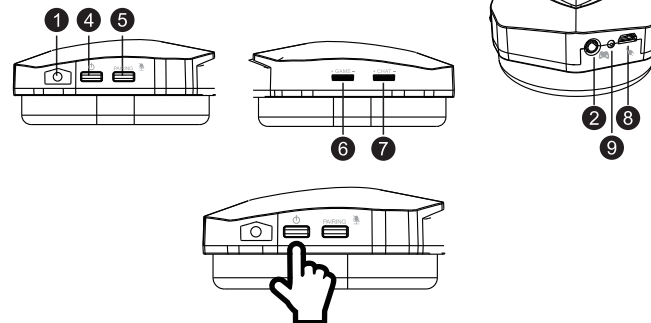

Stereophonic sound and 7.1 virtual surround sound can be switched by short press under the working condition.  
(Note: there is no such function when inputting by a handle)

### 3, Connection method :

First of all , connect Micro USB-USB long cable to DC 5V charging adaptor USB port to charge

- ① headset for around 5 hours, red light on during charging and off after fully charge .

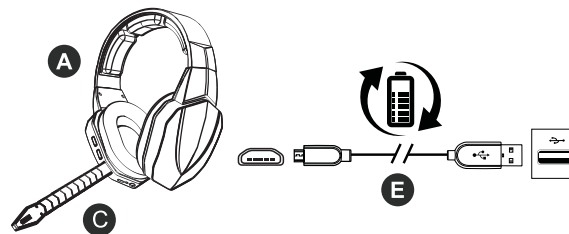

#### 4, PS4 setting

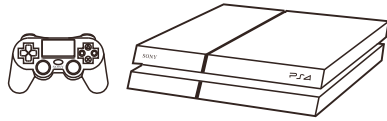

1, Connect PS4 optical port with **B** Transmitter optical port **1** using **F** Optical cable ( protection cover must be removed ); Using **D** Micro USB short cable to connect PS4 USB port with **B** Transmitter **2** USB port as below :

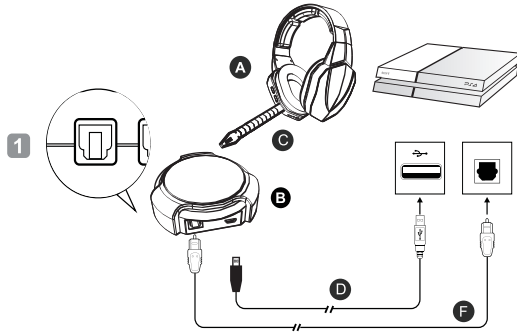

2, Detail connection diagram :

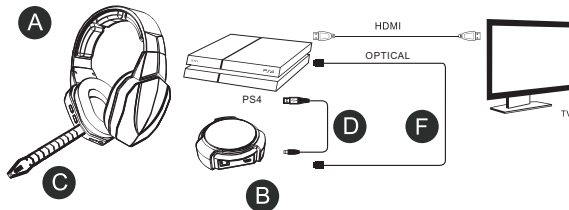

3, PS4 console setting

1), After power on PS4 , choose setting

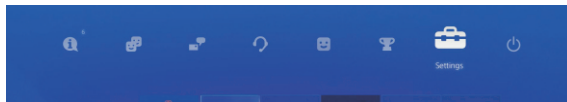

④

2), Choose Sound and Screen and press Enter



3), Choose Audio Output Settings and press Enter

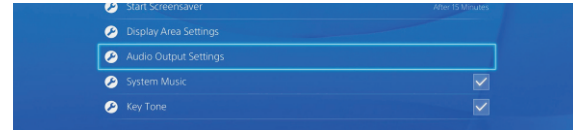

4), Choose Primary Output Port and press Enter



5), Choose DIGITAL OUT (OPTICAL) and press Enter



6), Remove ✓ tick mark in front of "Dolby Digital 5.1ch", "DTS 5.1ch"



7), Choose Audio Format (Priority) and press Enter



8), Choose "Linear PCM and press Enter

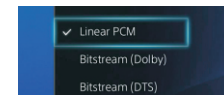

EN

⑤

9), Then choose setting and choose Devices and press Enter

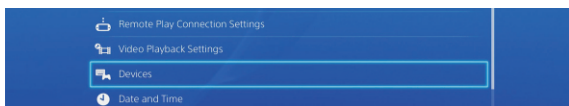

10), Choose Audio Devices and press Enter



11), Choose Output to Headphones and press Enter

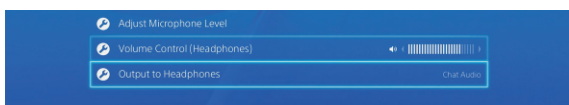

12), Choose Chat Audio and press Enter

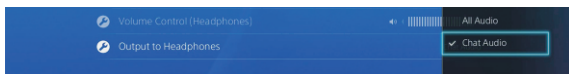

4, Operation method:

- 1), Connect transmitter and PS4 console USB port using the short USB cable, light flashing .
- 2), Long press power button for 3 seconds to power on the headset , the headset should auto pair with the transmitter and solid blue light light up , if the headset light keep flashing , please pair them once again .
- 3), During pairing , please power on PS4 and do not play audio , place headset close to transmitter within 50 cm and long press mute button on headset for 5 seconds and release your finger when light keep fast flashing , then the light on transmitter and headset will become solid blue.
- 4), Default setting for mute is off ( chat on ) , if you want to mute your chat voice , please press the mute button once and transmitter light will become red.
- 5), Volume adjusting switch allow you to adjust the game background and chat volume.

6

5, Common issue and solution

Common issue	Solution
1) Can't power on headset 2) Charging light off	1、 Long press power on button for 3 seconds 2、 Using USB cable to charge the headset , charging red indicating light on during charging and off after fully charge at about 5 hours charging
Power off after 10 mins	Fully charge headset for 5 hours before use
No background sound	1、 Optical cable not connected correctly , please remove protection cover and connect with right direction 2、 please make sure console setting will be :-Use HDMI cable to connect with PS4 and TV-Use fiber-optical cable to connect with PS4 and transmitter;- Use the USB cable to connect with the transmitter and USB port of PS4 : make sure the console setting is right also : Settings--Sound and Screen--Audio Output Settings--① Primary Output Port--DIGITAL Out(OPTICAL)--Delete ✓ "Dolby Digital 5.1ch" and "DTS 5.1ch" ② Audio Format (Priority)--Linear PCM Settings -- Devices -- Audio Devices -- Output to Headphones-- Chat Audio
No mic sound	1、 Plug in microphone for headset 2、 Use short USB cable for audio transmission 3、 Setting issue : Settings-Accessory Settings-Audio Device Settings-Input Device and Output Device Select all options: 2.4G Wireless headset --OK 4、 Mic being muted , press the mute/pair button to active mic sound

5, PS3 setting

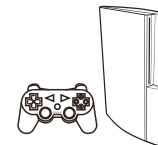

- 1, Connect PS3 optical port with **B** Transmitter optical port **1** using **F** Optical cable ( protection cover must be removed ) ; Using **D** Micro USB short cable to connect PS3 USB port with **B** Transmitter **2** USB port as below :

7

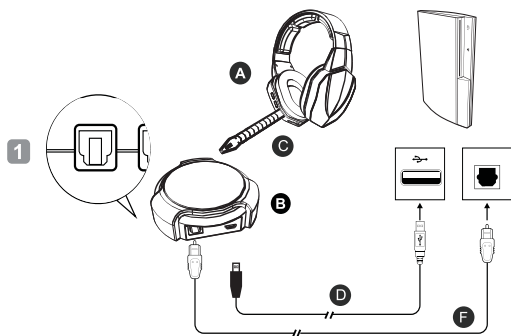

2, Detail connection diagram :

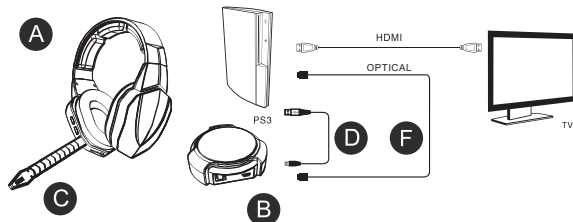

3, PS3 console setting

- 1), After power on PS3 console , select setting and choose Accessory Settings



- 2), Select Audio Device Settings

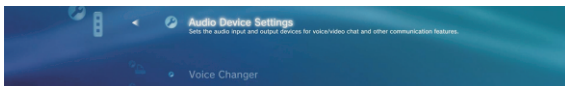

- 3), Set Input Device and Output Device to 2.4G Wireless headset , at this moment , you can set the microphone level and test the sound level when you wear the headset , you can set mic level from 1 to 5

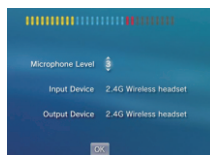

- 4), Back to setting screen , select Sound Settings

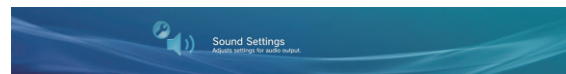

- 5), Select Audio Output Settings



- 6), Select Optical Digital



- 7), Remove ✓'ticks of "Dolby Digital 5.1ch" and "DTS 5.1ch" and press Enter to confirm



- 8), Set Audio Multi-Output on



4, Operation method :

- 1), Connect transmitter and PS3 console USB port using the short USB cable ,light flashing .
- 2), Long press power button for 3 seconds to power on the headset , the headset should auto pair with the transmitter and solid blue light light up , if the headset light keep flashing, please pair them once again .
- 3), During pairing , please power on PS3 and do not play audio , place headset close to transmitter within 50 cm and long press mute button on headset for 5 seconds and release your finger when light keep fast flashing , then the light on transmitter and headset will become solid blue.
- 4), Default setting for mute is off ( chat on ) , if you want to mute your chat voice, please press the mute button once and transmitter light will become red.
- 5), Volume adjusting switch allow you to adjust the game background and chat volume .

## 5, Common issue and solution

Common issue	Solution
1) Can't power on headset 2) Charging light off	1、 Long press power on button for 3 seconds 2、 Using USB cable to charge the headset , charging red indicating light on during charging and off after fully charge at about 5 hours charging
Power off after 10 mins	Fully charge headset for 5 hours before use
No background sound	1. Optical cable not connected correctly , please remove protection cover and connect with right direction 2. Console setting should be : Settings--System--Console settings--Audio-- ①Digital Output -- DigitalStereo(don't choose Dolby Digital 5.1 or Dolby Digital with WMA Pro), ②Sound Effects--Enable Sound Effents , ③Ratings Collection Sound ---Turn On
No mic sound	1、 Plug in microphone for headset 2、 Use short USB cable for audio transmission 3、 Setting should be : Settings--Accessory Settings--Audio Device Settings--Input Device and Output Device - Select all options: 2.4G Wireless headset-OK-Enter 3.Press pairing button once for mute off 4、 Mic being muted , press the mute/pair button to active mic sound

## 6, Xbox 360S setting



1, Connect Xbox 360S optical port with **B** Transmitter optical port **1** using **F** Optical cable ( protection cover must be removed ) ; Using Micro USB Audio cable to connect Xbox 360S USB port with **B** Transmitter **2** USB port as below :

10

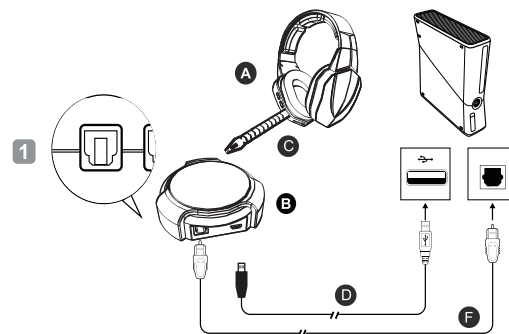

### 2, Detail connection diagram :

Using HDMI cable to connect Xbox360S console with TV ( Display ) , connect 2.5mm to 3.5 mm Xbox cable with 3.5 mm plug to headset & 2.5mm plug to Xbox controller 2.5mm jack

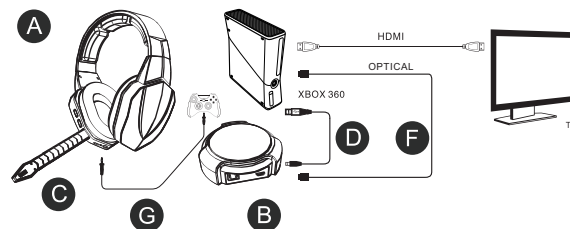

### 3, Connection for old version Xbox 360 & Xbox 360E ( no optical port ) if TV had optical port

Connect HDMI cable with console and TV ( Display ) , connect transmitter and TV ( with optical port ) using optical cable , connect transmitter USB port & console USB port with USB audio cable

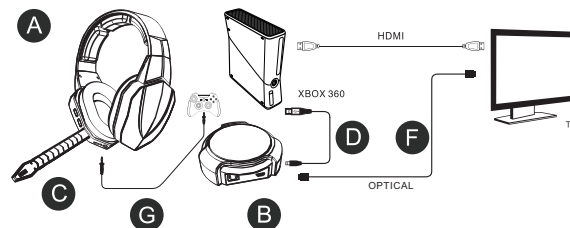

11

#### 4, XBOX 360 System Setting

1), After power on Xbox 360 , select setting then select System

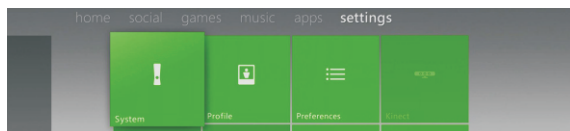

2), Select Console Settings

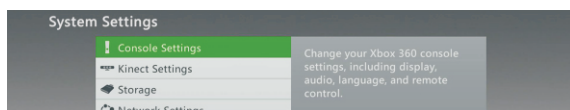

3), Select Audio

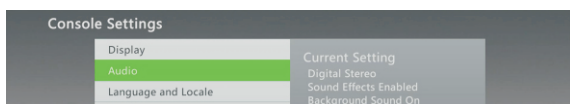

4), Select Digital Output

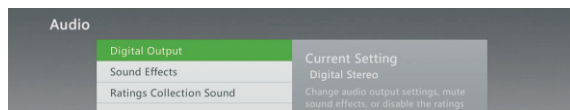

5), Select Digital Stereo and select Digital Stereo

( do not choose Dolby Digital 5.1 or Dolby Digital with WMA Pro )

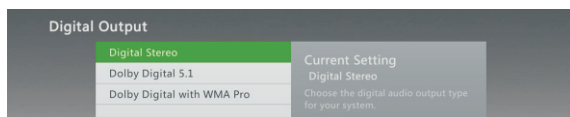

6), Select Sound Effects

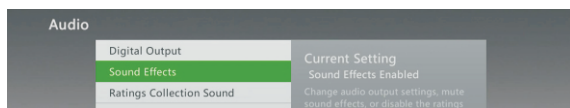

12

7), Select Enable Sound Effects

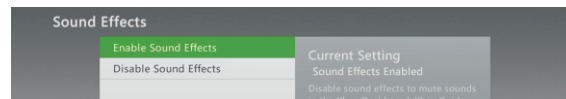

8), Back to settings in main screen and choose Preferences

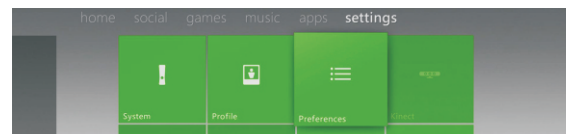

9), Select Voice

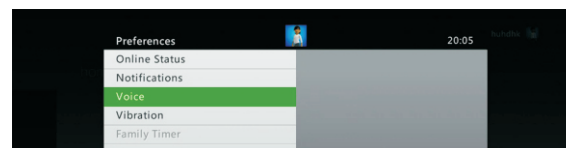

10), Adjust Volume level of Voice Volume & Game Volume and choose Play Through Both

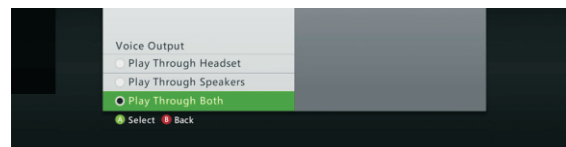

5, Operation method :

- 1), Connect transmitter and Xbox 360 console USB port using the short USB cable, light flashing .
- 2), Long press power button for 3 seconds to power on the headset, the headset should auto pair with the transmitter and solid blue light light up, if the headset light keep flashing , please pair them once again .
- 3), During pairing , please power on Xbox 360 and do not play audio, place headset close to transmitter within 50 cm and long press mute button on headset for 5 seconds and release your finger when light keep fast flashing , then the light on transmitter and headset will become solid blue.
- 4), Default setting for mute is off ( chat on ), if you want to mute your chat voice, please press the mute button once and transmitter light will become red.
- 5), Volume adjusting switch allow you to adjust the game background and chat volume .

13



## 6, Common issue and solution

Common issue	Solution
<p>1) Can't power on headset</p> <p>2) Charging light off</p>	<p>1、 Long press power on button for 3 seconds</p> <p>2、 Using USB cable to charge the headset , charging red indicating light on during charging and off after fully charge at about 5 hours charging</p>
Power off after 10 mins	Fully charge headset for 5 hours before use
No background sound	<p>1.Optical cable not connected correctly , please remove protection cover and connect with right direction</p> <p>2.Console setting should be :</p> <p>Settings--System--Console settings--Audio--</p> <p>①Digital Output -- Digital Stereo(don't choose Dolby Digital 5.1 or Dolby Digital with WMA Pro),</p> <p>②Sound Effects--Enable Sound Effents,</p> <p>③Ratings Collection Sound ---Turn On</p>
No mic sound	<p>1. Plug in microphone for headset</p> <p>2.Please press the mic mute off , mic volume can be adjusted higher or lower by chat volume switch .</p>

## 7, XBOX ONE setting

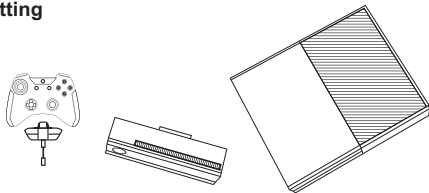

- 1, Connect Xbox One optical port with **B** Transmitter optical port **1** using **F** Optical cable ( protection cover must be removed ) ; Using Micro USB Audio cable to connect Xbox One USB port with **B** Transmitter **2** USB port as below :

14

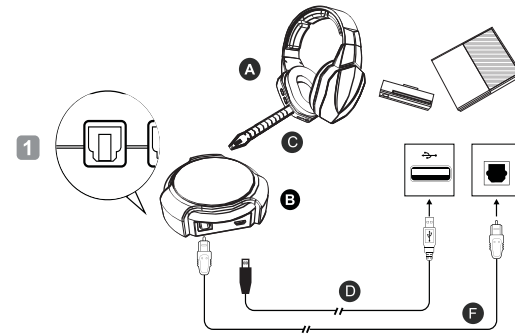

### 2, Detail connection diagram :

Using HDMI cable to connect Xbox console and TV ( Display ) recommend to use Kinect for chatting ( wireless ) , if you don't have Kinect, you can buy a Microsoft adapter using attached 3.5mm 3 poles to 3.5 mm 4 poles cable with 3.5 mm 3 poles plug to headset and 3.5 mm 4 poles plug to adapter's 3.5 mm jack.

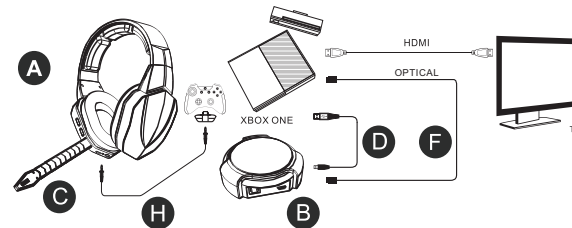

Cable connect between the headset and an adaptor in the controller.

Detail connection :

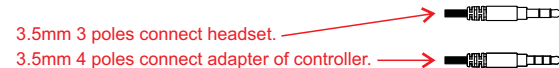

### 3, XBOX ONE System setting

- 1), After power on Xbox One , select setting --- all setting

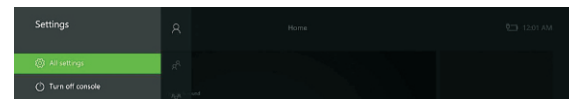

15

2), Select Display & sound

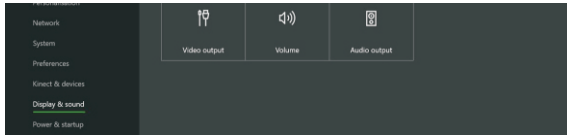

3), Select Audio output

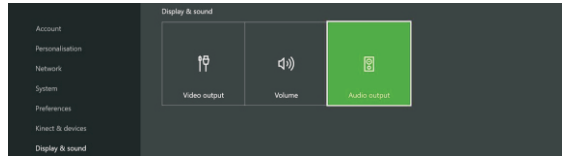

4), Select Optical audio

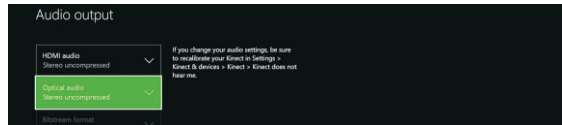

5), Choose Stereo uncompressed

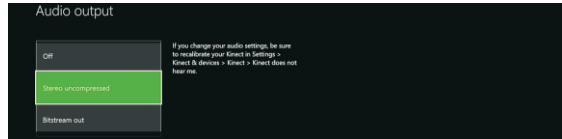

6), Back to Display & sound screen , select Volume

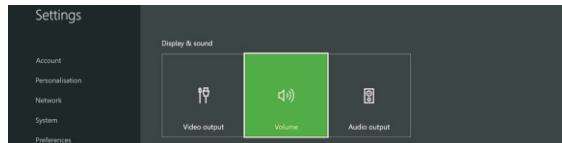

7), Select Chat mixer



8), Choose Do nothing



4, Operation method :

- 1) Connect transmitter and Xbox One console USB port using the short USB cable ,light flashing .
- 2) Long press power button for 3 seconds to power on the headset , the headset should auto pair with the transmitter and solid blue light light up , if the headset light keep flashing , please pair them once again .
- 3) During pairing , please power on Xbox One and do not play audio, place headset close to transmitter within 50 cm and long press mute button on headset for 5 seconds and release your finger when light keep fast flashing , then the light on transmitter and headset will become solid blue.
- 4) Default setting for mute is off ( chat on ) , if you want to mute your chat voice , please press the mute button once and transmitter light will become red
- 5) Volume adjusting switch allow you to adjust the game background and chat volume .

5, Common issue and solution

Common issue	Solution
<p>1) Can't power on headset</p> <p>2) Charging light off</p>	<p>1、 Long press power on button for 3 seconds</p> <p>2、 Using USB cable to charge the headset , charging red indicating light on during charging and off after fully charge at about 5 hours charging</p>
Power off after 10 mins	Fully charge headset for 5 hours before use
No background sound	<p>1、 Optical cable not connected correctly , please remove protection cover and connect with right direction</p> <p>2、 setting should be : Setting -- Display &amp; Sound -- ① optical --stereo uncompressed ( don't choose stereo bitstream cut or off ② chat mixer -- Do nothing</p>
No mic sound	<p>1、 Plug in microphone for headset</p> <p>2、 When using Kinet for chatting, please set kinet to open position and put kinet in a good position facing you to receive your chat voice</p> <p>3、 When using Microsoft adapter , Please press the mic mute off , mic volume can be adjusted higher or lower by chat volume switch .</p>

## 8, Suitable for PC/MAC



1, Using Micro USB-USB long cable to connect transmitter with PC , please keep the distance between transmitter & PC as far as possible

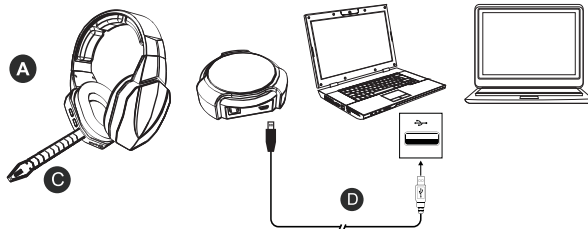

2, PC setting ( Windows 8 version for example)

- 1), USB the 80 mm long USB cable to connect transmitter with your PC
- 2), Move your mouse to right bottom corner of desk top on the speaker icon as shown in Picture 1, click right button of mouse as shown in Picture 2,

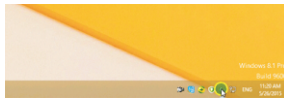

Picture 1



Picture 2

3, Click mouse left button to choose the "Playback" as shown in Picture 3, and then choose the "2.4G wireless headset" as shown in Picture 4 , click mouse left button to choose the "Set Default " as shown in Picture 5

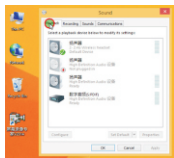

Picture 3

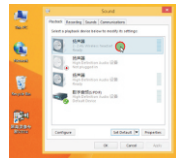

Picture 4

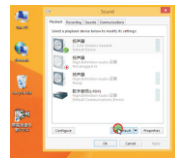

Picture 5

4, Click mouse left button to choose the "Recording" as Picture 6 , and then choose the "2.4G wireless headset" as shown in Picture 7 , and choose the "Set Default " as shown in Picture 8 , Now that the PC setting is finished.

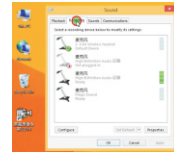

Picture 6

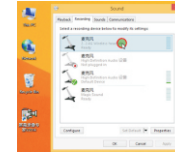

Picture 7

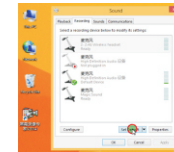

Picture 8

## 9, MAC setting

Step 1 -- Choose System preferences



Step 2 choose Sound



Step 3 choose input setting and set to 2.4G Wireless Headset

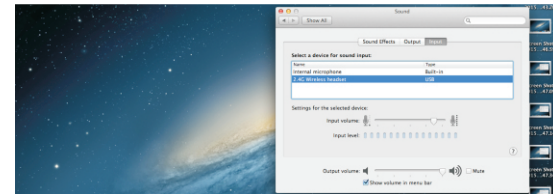

Step 4 Choose output setting and set to 2.4G Wireless Headset

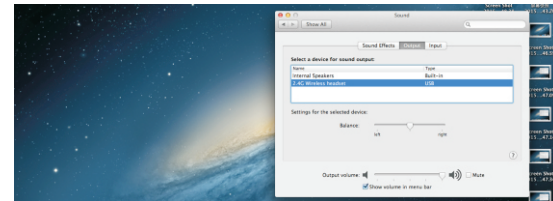

Step 5 Choose Sound Effects as Play sound effects though -- 2.4 G Wireless Headset , tick the three ticks shown in below diagram

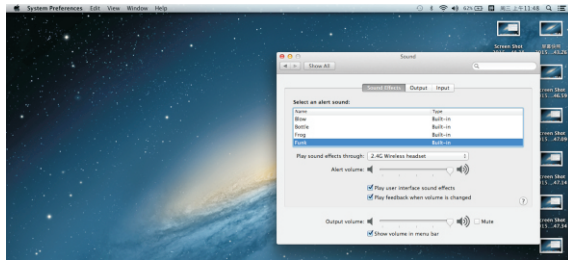

## 10, Specification

Headset :

Continuous working hours:  $\geq 6h$

Charging hours:  $\approx 5h$

Frequency range: 2.403-2.478 Ghz

Latency: 24MS

Transmission power: +2 dBm

Receiving sensitivity: -85dBm

Speaker diameter:  $\Phi 40mm$

Speaker impedance:  $32\Omega$

Speaker frequency response: 20~20KHz

Microphone specification:  $6*2.7mm$

Microphone sensitivity: -58dB

Microphone direction: OMNI directional

Microphone frequency response: 50Hz-8KHz

Transmitter :

Working voltage: 5V

Frequency range: 2.403-2.478 GHz

Latency: 24MS

Transmission power: +2 dBm

Transmission distance: 10M

Receiving sensitivity: -85dBm

NOTE: This equipment has been tested and found to comply with the limits for a Class B digital device, pursuant to part 15 of the FCC Rules. These limits are designed to provide reasonable protection against harmful interference in a residential installation. This equipment generates uses and can radiate radio frequency energy and, if not installed and used in accordance with the instructions, may cause harmful interference to radio communications. However, there is no guarantee that interference will not occur in a particular installation. If this equipment does cause harmful interference to radio or television reception, which can be determined by turning the equipment off and on, the user is encouraged to try to correct the interference by one or more of the following measures:

- Reorient or relocate the receiving antenna.
- Increase the separation between the equipment and receiver.
- Connect the equipment into an outlet on a circuit different from that to which the receiver is connected.
- Consult the dealer or an experienced radio/TV technician for help

Changes or modifications not expressly approved by the party responsible for compliance could void the user's authority to operate the equipment. This device complies with Part 15 of the FCC Rules. Operation is subject to the following two conditions:

- (1) this device may not cause harmful interference, and
- (2) this device must accept any interference received, including interference that may cause undesired operation.