

# *IK-1*

*Baby Monitor*

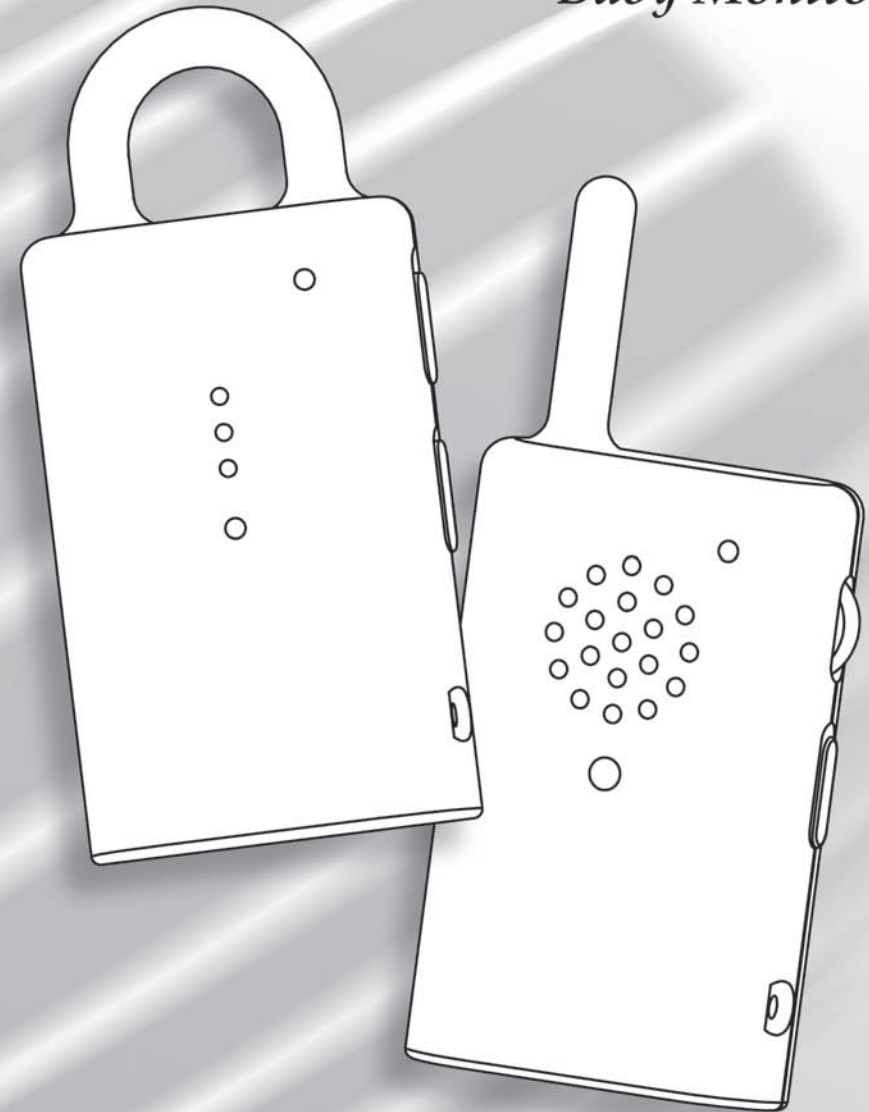

*Manual*

Thank you for purchasing our IK-1 baby monitor. Your unit has been manufactured and checked under the strictest quality control to ensure that each unit leaves the factory in perfect condition. If in the unlikely event you find any defects or have any problem, please contact your dealer, our branch or service center.

Please read this manual carefully to obtain maximum performance and extended service life from the unit.

### **Features**

- Voice activated transmitter
- Indicator on receiver showing received signal loudness even when volume is turned down
- Selectable two channels with crystal clear sound
- Low battery indicator on transmitter and receiver
- Subaudible private tone function minimize interference from other electrical devices
- Transmitter and receiver can operate with either AA size batteries or 9V AC adapter

### **Power Supply**

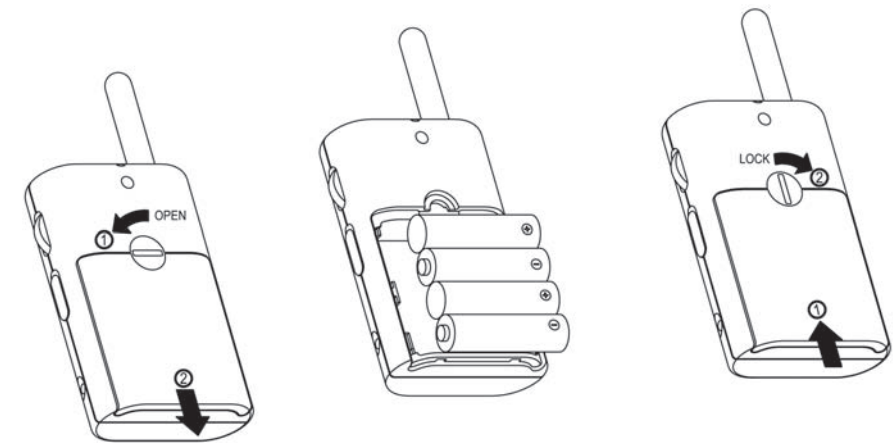

#### **1. Operation from batteries**

Turn the locking screw counter clockwise 90° and slide open the battery cover in the direction as shown. Insert four UM-3/AA size batteries, observe correct polarity (+/-) indication. Install back the battery door and turn the locking screw clockwise 90° to lock the battery door in place.

N.B. For best performance, do not mix use old and new batteries or alkaline and rechargeable batteries.

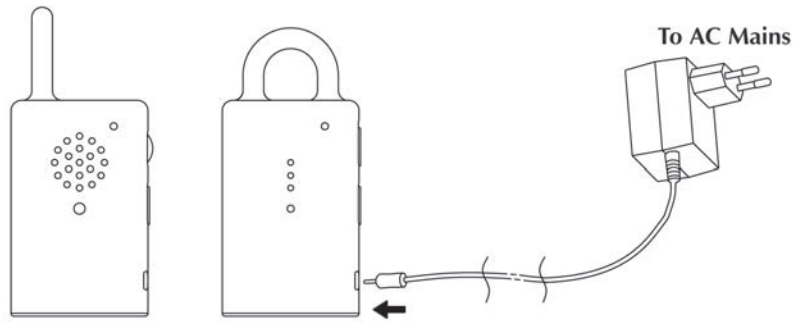

## 2. Operation from AC mains

The unit can be operated on AC mains using 9V 100mA type AC adapter (purchased separately). Connect the output plug (Ø 2.35mm) of the adapter to the DC jack on the unit, make sure the polarity is correct.

## Controls Layout

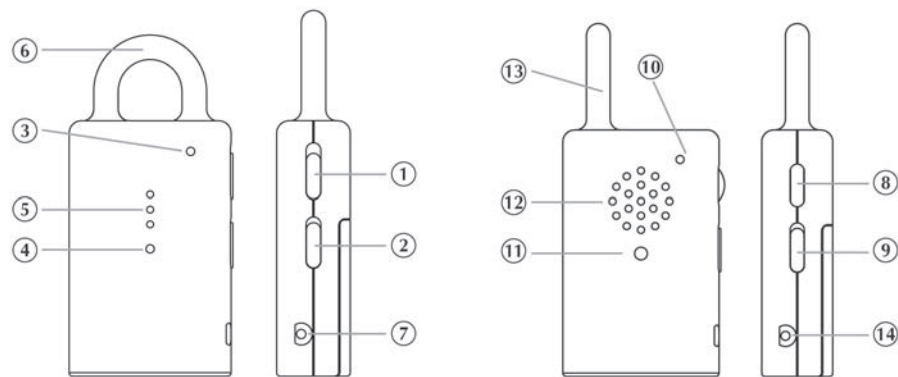

### TRANSMITTER

### RECEIVER

- |                                      |                                      |
|--------------------------------------|--------------------------------------|
| ① Power ON/OFF switch                | ⑧ Volume control with ON/OFF switch  |
| ② Channel selector                   | ⑨ Channel selector                   |
| ③ Power On and Battery Low indicator | ⑩ Power On and Battery Low indicator |
| ④ Transmit indicator                 | ⑪ Receive indicator                  |
| ⑤ Microphone                         | ⑫ Speaker                            |
| ⑥ Antenna                            | ⑬ Antenna                            |
| ⑦ DC jack                            | ⑭ DC jack                            |

## OPERATION

1. Set the transmitter Power ON-OFF switch ① to ON position.
2. Set the channel selector ② to either CH1 or CH2 position .
3. The Power On indicator ③ will light up green. If it becomes red or dim, the batteries have run down and need to be replaced.
4. Place the transmitter nearby the cot with the microphone ⑤ facing towards the baby, preferably 1m away.
5. Once the built-in condenser microphone ⑤ picks up any sound from the baby, the transmitter will automatically switches into transmit mode and the transmit indicator ④ lights up.
6. When the baby stops making sound, the transmitter will return to standby mode and the transmit indicator ④ goes off.
7. Using the Channel Selector ⑨ on receiver, set to the same channel as the transmitter.
8. Turn the Volume Control ⑧ to switch on the receiver at a reasonable distance away from the transmitter. (Too close a distance will create feedback which cause a screeching sound at the speaker). The Power On indicator ⑩ will light up green, if it becomes red or dim, the batteries have run down and need to be replaced.
9. Whenever a signal is received, the receiver indicator ⑪ will light up. The louder the voice, the brighter the indicator. This indicator is useful to monitor the baby when volume of speaker is turned down.
10. In case you hear interference or static noises, change to another channel on both the transmitter and receiver.
11. This baby monitor is incorporated with private tone feature, so static noises will not be heard in the receiver under standby mode. However, it is necessary that the transmitter and receiver have the same private tone (as indicated by colour code in the battery compartment) to communicate with each other.
12. Both the transmitter and receiver can be carried around using hand strap. To install hand strap (purchased separately), follow diagram as shown.

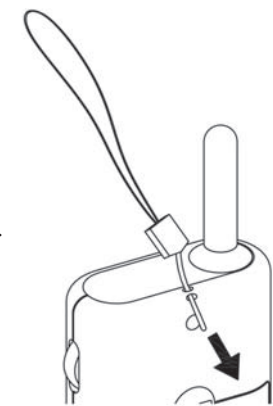

**Precautions**

- Use only 9V 100mA type AC adapters. Use of other AC adapter may cause damage to the unit.
- When not using the unit for a long period of time, remove all battery from the transmitter and receiver to avoid battery leakage.
- Disconnect the AC adapter from the wall outlet when the unit is not to be operated.
- The unit is best performed within a temperature range of 0 °C to 40°C (22 F to 104 F).
- Do not leave the unit expose to direct sunlight for a long time or near any heat source, moisture and excessive dust environment.
- When the unit cabinet become dirty, use detergent and clean with a soft cloth. Never use abrasive cleaner or chemical solvent.
- Do not open the cabinet, no serviceable parts inside.

**Standard Accessor**

- a. Transmitter Unit ..... 1
- b. Receiver Unit ..... 1
- c. User Manual ..... 1

The users manual or instruction manual for an intentional or unintentional radiator shall caution the user that changes or modifications not expressly approved by the party responsible for compliance could void the user's authority to operate the equipment. In cases where the manual is provided only in a form other than paper, such as on a computer disk or over the Internet, the information required by this section may be included in the manual in that alternative form, provided the user can reasonably be expected to have the capability to access information in that form.

**FCC Information**

This device complies with Part 15 of the FCC Results.

Operation is subject to the following two conditions :

- (1) This device may not cause harmful interface, and
- (2) This device must accept any interference received, including interference that may cause undesired operation.

**WARNING**

Change or modification not expressly approved by the manufacturer could void the user's authority to operate the equipment.

**TROUBLE SHOOTING GUIDE**

<b>Problem</b>	<b>Possible Causes</b>	<b>Solution</b>
Transmitter has no transmission	<ul style="list-style-type: none"> <li>- The input sound level is too low</li> <li>- Battery has run down or AC adapter improperly connected</li> </ul>	<ul style="list-style-type: none"> <li>- Place transmitter closer to baby</li> <li>- Replace with new battery or check connection</li> </ul>
Transmitter always on	<ul style="list-style-type: none"> <li>- The input sound level is too high</li> </ul>	<ul style="list-style-type: none"> <li>- Place the transmitter further away from the baby</li> </ul>
Static noise sometimes heard	<ul style="list-style-type: none"> <li>- Interference from other devices operating on same channel</li> </ul>	<ul style="list-style-type: none"> <li>- Switch to another channel</li> </ul>
Many static noises and interference	<ul style="list-style-type: none"> <li>- Transmitter is located near other electrical appliances</li> </ul>	<ul style="list-style-type: none"> <li>- Remove the electrical appliance or re-locate the transmitter far away from the source of interference.</li> </ul>
Communication distance is too short	<ul style="list-style-type: none"> <li>- Transmitter or receiver battery has run down</li> <li>- Too many metal shielding structures between transmitter and receiver</li> </ul>	<ul style="list-style-type: none"> <li>- Replace with new battery or use AC adapters as power supply</li> <li>- Re-locate the transmitter or receiver</li> </ul>
Receiver cannot receive signal from transmitter	<ul style="list-style-type: none"> <li>- Receiver and transmitter are set with different private tones</li> </ul>	<ul style="list-style-type: none"> <li>- Consult your dealer and change another set with properly matched private tone.</li> </ul>