

USER MANUAL

(KIOSK 15", 21.5")



Thank you for purchasing a product of SAM4S

(The contents of this manual is subject to change without prior notice.)

- The copyright of this e-Manual is in SAM4S
- Some equipment nomenclature and abbreviations used here may differ from that contained in other SAM4S publications.
- The changes or modifications not expressly approved by the party responsible for compliance could void the user's authority to operate the equipment.



Safety Instructions

- Read the safety instructions carefully and thoroughly. All cautions and warnings on the equipment or user's manual should be noted.
- Lay this equipment on a stable surface before setting it up.
- Keep this equipment away from humidity and high temperature.
- Make sure the power voltage is within safety range and has been adjusted properly to the value of 100~240V before connecting the equipment to the power outlet.
- Always keep the strong magnetic or electrical objects away from the equipment.
- Always unplug the power cord before connecting any External Devices.
- Never pour liquid into the opening that could damage the equipment or cause an electrical shock.

FCC Instructions

FCC Compliance Statement

This device complies with part 15 of the FCC rules. Operation is subject to the following two conditions: (1) This device may not cause harmful interference, and (2) this device must accept any interference received, including interference that may cause undesired operation.

FCC Interference Statement

This equipment has been tested and found to comply with the limits for a Class B digital device, pursuant to part 15 of the FCC Rules. These limits are designed to provide reasonable protection against harmful interference in a residential installation. This equipment generates, uses and can radiate radio frequency energy and, if not installed and used in accordance with the instructions, may cause harmful interference to radio communications. However, there is no guarantee that interference will not occur in a particular installation. If this equipment does cause harmful interference to radio or television reception, which can be determined by turning the equipment off and on, the user is encouraged to correct the interference by one of the following measures:

Reorient or relocate the receiving antenna.

Increase the separation between the equipment and receiver.

Connect the equipment into an outlet on a circuit different from which the receiver is connected.

Consult the dealer or an experienced radio/TV technician for help.

FCC Caution

Any changes or modifications not expressly approved by the party responsible for compliance could void the user's authority to operate this equipment. This transmitter must not be co-located or operating in conjunction with any other antenna or transmitter.

FCC Radiation Exposure Statement

This equipment complies with FCC radiation exposure limits set forth for an uncontrolled environment. This equipment should be installed and operated with minimum distance 20 cm between the radiator and your body. This transmitter must not be co-located or operating in conjunction with any other antenna or transmitter.

KIOSK Figure

Desk type

Stand type

SK-161 (163) is an self ordering kiosk. It is a device for buyers to select the desired menu and pay by themselves without the help of the clerk at the store. The order will be checked by the clerk and will inform the buyer when it is ready.



Unpacking



< Main body >



< Power Cable >

System Spec

		SK-161	SK-163
Picture			
Display	Display	15 inch : XGA, 1024 x 768	21.5 inch : FHD, 1920 x 1080
	Touch	10 points support, Projected capacitive touch	
System	CPU	Intel Celeron J1900 (Quad Core up to 2.4GHz) Intel Core i3, i5 support	
	Storage	SATA III 2.5" SSD/mSATA 64GB (up to 256GB)	
	Memory	SODIMM DDR3 4GB (up to 8GB)	
	OS	Windows10 IoT	
	Audio	2 x 5.0W Speaker	
	Printer	3 inch thermal printer with auto-cutter	
	Power	Input AC 100~240V/50~60Hz	
	I/O	Serial	4 ports
USB		4 ports	
LAN		IEEE 802.3 10/100/1000 ethernet	
External display		VGA 1 Port, HDMI 1 Port	
General	Dimension	364(W) x 232(D) x 530(H)mm	364(W) x 232(H) x 776(D)mm
	Weight	12.6kg	16.2kg
Option	Barcode scanner	2D	
	Wi-Fi	IEEE 802.11 b/g/n	
	Stand	Plate (400(W) x 400(D) x 810(H)mm/27.2kg) Wheel (400(W) x 400(D) x 900(H)mm/21.8kg)	
	EFT bracket	External bracket for payment terminal	
	Cash box	Support	

* Without any prior notice, design and specification are subject to change.

Name and Function of Each Part

Front View

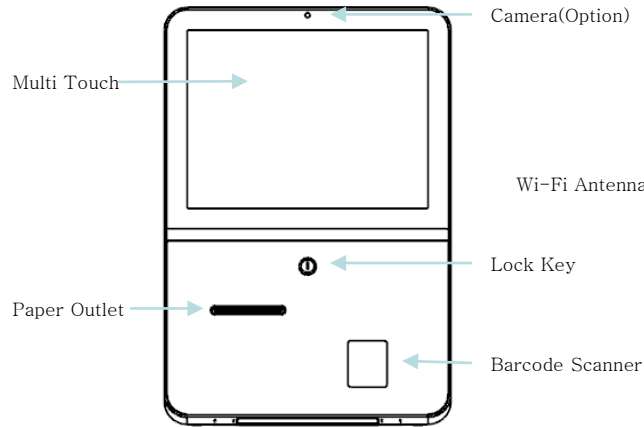

Back View

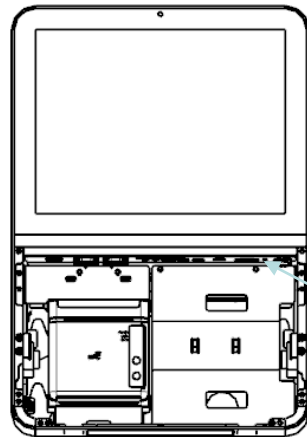
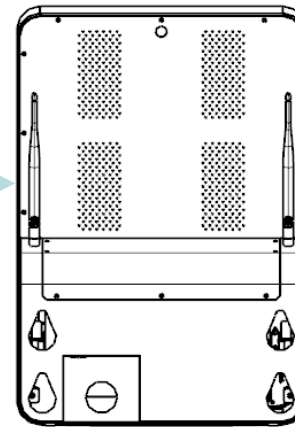

Interface

- 2 x D-SUB 9P Serial Port
- Audio Port(Mic, Line Out)
- RJ-45 LAN(Ethernet) Port
- 4 x USB 2.0 Port
- HDMI Port
- Display Port(VGA)
- 12V DC Power Input
- Power Button

Usage Procedure

Connect the power cable to a power inlet.
Connect the power cable to a power outlet.

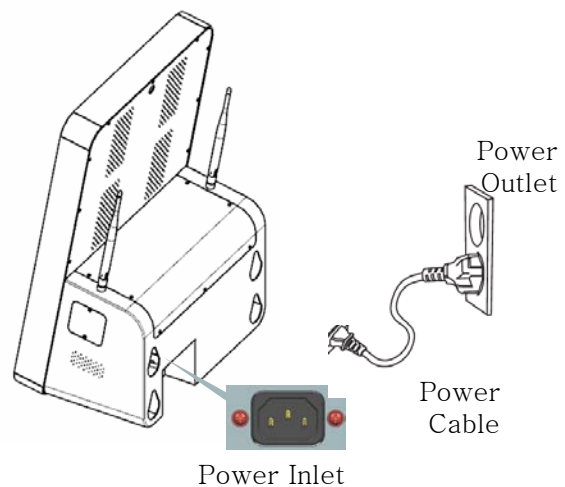

Open the Front Cover

Turn the key clockwise, open the “Interface cover” in the direction as shown and connect the peripheral cables.

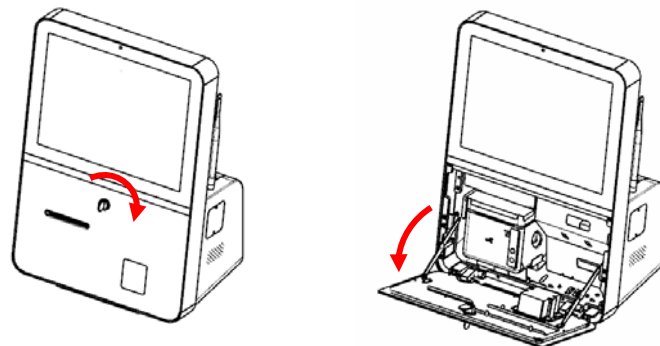

Press power button to boot system.

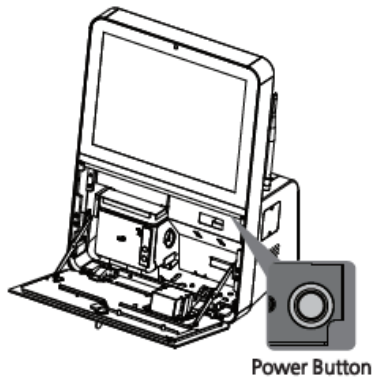

Touch Screen Calibration

*If touch points are not accurate, recalibrate the touch screen as following steps.

1. Open the 'SiWDaemon Control Panel' by right clicking the button of mouse on  icon of Windows tray icons.
2. Double-click 'Multi touch-Device' on 'Device' tab.
3. Click the 'Standard Calibration' button.
4. Calibration procedure will be proceeded with following messages.

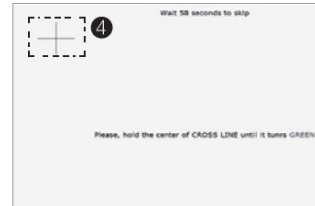
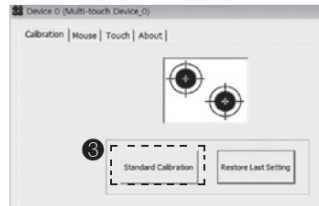
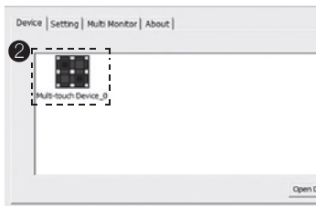
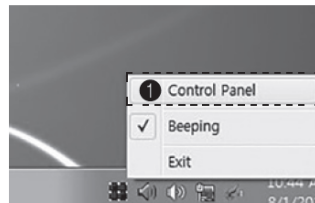

Paper Roll Installation

