

DWG. NO. 2840-614

Candidate	Votes
Berman	10,000
Gohmert	10,000
Lujan	10,000
Wittman	10,000

FCC ID: O76-X1DL0915A

IC: #####-#####

GOJO Industries, Inc.

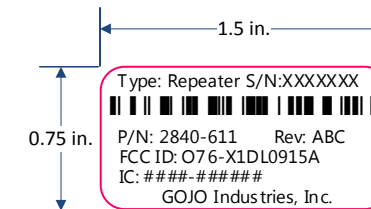

SCALE 1:1

NOTES:

1. MATERIAL:
FASSON 77113
COLOR: WHITE
FACESTOCK: 0.7 MIL CLEAR BOPP
ADHESIVE: S2001
LINER: 1.2 MIL PET
2. OVAL BOXED DIMENSIONS ARE CRITICAL.
3. PART TO BE FREE OF DIRT, GREASE, OIL OR ANY FOREIGN MATERIAL
4. SHIPPING REQUIREMENTS:
CAREFULLY PACKED TO AVOID DAMAGE IN QUANTITIES, IN UNIFORM SIZED SHIPPING CONTAINERS ON UNIFORM SIZED PALLET (48"LENGTH X 40"WIDTH X 66" TALL) CARTONS TO BE MARKED CLEARLY IN 1" HIGH MINIMUM LETTERS. WITH QUANTITY, GOJO PART, LOT, AND P.O. NUMBER.

INTERPRET DRAWING PER
ASME Y14.100
UNLESS OTHERWISE SPECIFIED
DIMENSIONS ARE IN INCHES

THIRD ANGLE PROJECTION

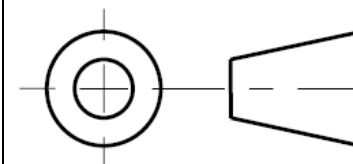

TITLE:	FCC LABEL, AMS REPEATER
STATE:	Developmental

CONFIDENTIAL ©2013 GOJO Industries, Inc. All Rights Reserved.

TOLERANCES:

DECIMALS:
 $X.X = 0.1$
 $.X.XX = 0.01$
 $.X.XXX = 0.005$

FRACTIONS:
X/XX = 1/32

ANGLES:
X.X = 0.5
X.XX = 0.50

THIS DRAWING IS THE PROPERTY OF
GOJO INDUSTRIES, INC.
ONE GOJO PLAZA, SUITE 500 AKRON, OH 44311 AND IS LOANED UPON CONDITION THAT IT IS NOT TO BE
REPRODUCED OR COPIED IN WHOLE OR PART, OR USED FOR FURNISHING INFORMATION TO OTHERS OR FOR ANY
OTHER PURPOSE DETRIMENTAL TO THE INTEREST OF GOJO INDUSTRIES, INC. AND WILL BE RETURNED UPON REQUEST

DRAWN BY: M. BULLOCK		SCALE 1:1	SHEET
DATE: 1/15/13		DO NOT SCALE	1 of 1
CHKD BY:	SIZE	DWG. NO.	REV
DATE:	B	2840-614	1