

Notice

Thank you for purchasing a HUMAX IP Set-Top Box. Please read this user manual carefully, to be able to safely install, use and maintain the product at maximum performance. Keep this user manual next to your product for future reference.

Repairs and Warranty Service

Should your RG-200 require warranty service, please contact Humax first to obtain authorization. You can reach us at **866.humax.usa**, **17501 Von Karman Avenue, Irvine, CA 92614**, or by visiting our website at **<http://www.humaxusa.com/support.html>**.

This product incorporates copyright protection technology that is protected by U.S. patents and other intellectual property rights. Use of this copyright protection technology must be authorized by Macrovision Corporation, and is intended for home and other limited consumer uses only unless otherwise authorized by Macrovision. Reverse engineering or disassembly is prohibited.

Apparantus Claims of U.S. Patent Nos. 4,631,603; 4,577,216; 4,819,098 and 4,907,093 licensed for limited viewing uses only.

Dolby and the double-D symbol are trademarks of Dolby Laboratories.

Manufactured under license from Dolby Laboratories.

All other trademarks are the properties of their respective owners.

Copyright © 2001- 2004 HUMAX Corporation

Not to be copied, used or translated in part or whole without HUMAX's prior consent in writing except approval of ownership of copyright and copyright law.

The information in this document is subject to change without notice.

Important Information



THIS SYMBOL IS INTENDED TO ALERT THE USER TO THE PRESENCE OF UNINSULATED "DANGEROUS VOLTAGE" WITHIN THE PRODUCT'S ENCLOSURE THAT IS OF SUFFICIENT MAGNITUDE TO CONSTITUTE A RISK OF ELECTRIC SHOCK TO PERSONS.



THIS SYMBOL IS INTENDED TO ALERT THE USER TO THE PRESENCE OF IMPORTANT OPERATING AND MAINTENANCE (SERVICING) INSTRUCTIONS IN THE LITERATURE ACCOMPANYING THE DEVICE.

WARNING: TO REDUCE THE RISK OF FIRE OR ELECTRIC SHOCK. DO NOT EXPOSE THIS DEVICE TO RAIN OR MOISTURE.

- Read these instructions.
- Keep these instructions.
- Heed all warnings.
- Follow all instructions.
- Do not use this product near water.
- Clean only with dry cloth.
- Do not block any ventilation openings.
- Install in accordance with the manufacturer's instructions.
- Do not install near any heat sources such as radiators, heat registers, stoves, or other products (including amplifiers) that produce heat.
- Do not defeat the safety purpose of the polarized or grounding-type plug. A polarized plug has two blades with one wider than the other. A grounding type plug has two blades and a third grounding prong. The wide blade or the third prong is provided for your safety. If the provided plug does not fit into your outlet, consult an electrician for replacement of the obsolete outlet.
- Protect the power cord from being walked on or pinched particularly at plugs, convenience receptacles, and the point where they exit from the product.
- Use only attachments/accessories specified by the manufacturer.
- Use this product only with the cart, stand, tripod, bracket, or table specified by the manufacturer, or sold with the product. When a cart is used, use caution when moving the cart/product combination to avoid injury from tip-over
- Unplug this product during lightning storms or when unused for long periods of time.



- Refer all servicing to qualified service personnel. Servicing is required when the product has been damaged in any way, such as power-supply cord or plug being damaged, exposure to liquid or moisture, irregular operation, or has been dropped.
- The product should not be exposed to dripping or splashing liquids and that no objects filled with liquids, such as vases, should be placed on the product.

This device complies with part 15 of the FCC Rules. Operation is subject to the following two conditions:

- (1) This device may not cause harmful interference, and
- (2) This device must accept any interference that may cause undesired operation.

INFORMATION TO THE USER

This equipment has been tested and found to comply with the limits for a Class B digital device, pursuant to part 15 of the FCC Rules. These limits are designed to provide reasonable protection against harmful interference in a residential installation. This equipment generates, uses and can radiate radio frequency energy and, if not installed and used in accordance with the instructions, may cause harmful interference to radio communications. However, there is no guarantee that interference will not occur in a particular installation. If this equipment does cause harmful interference to radio or television reception, which can be determined by turning the equipment off and on, the user is encouraged to try to correct the interference by one more of the following measures:

1. Reorient or relocate the receiving antenna.
2. Increase the separation between the equipment and product.
3. Connect the equipment into an outlet on a circuit different from that to which the product is connected.
4. Consult the dealer or an experienced radio/TV technician for help.

Caution:

- FCC regulations state that any unauthorized changes or modifications to this equipment may void the user's authority to operate it.
- RISK OF EXPLOSION IF BATTERY IS REPLACED BY AN INCORRECT TYPE. DISPOSE OF USED BATTERIES ACCORDING TO THE INSTRUCTIONS.

Contents

| | |
|---|-------------|
| 1. Read Before Using the Product | GB5 |
| 1.1 Package Contents | GB5 |
| 1.2 Front Panel | GB6 |
| 1.3 Rear Panel | GB7 |
| 2. Setup | GB9 |
| 2.1 Connecting to LAN ports | GB9 |
| 2.2 Connecting to TV/VCR | GB10 |
| 2.3 Connecting to AV Receiver | GB13 |
| 2.4 Connecting to Antenna (optional) | GB14 |
| 2.5 Powering On | GB15 |
| 3. Troubleshooting | GB16 |
| 4. Specification | GB17 |

1 Read Before Using This Product

This chapter provides detailed instructions on the product and its accessories.

1.1 Package Contents

When you unpack your package contents, make sure you have all the necessary items shown in figure below. If any of items is missing or damaged, please contact your product dealer for replacement.



Remote Controller



User's Manual

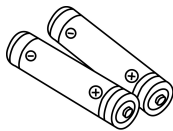

Batteries

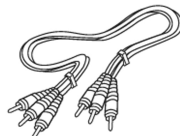

RCA Cable

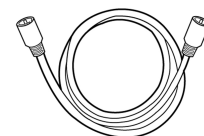

RF Cable

1 Read Before Using This Product

1.2 Front Panel

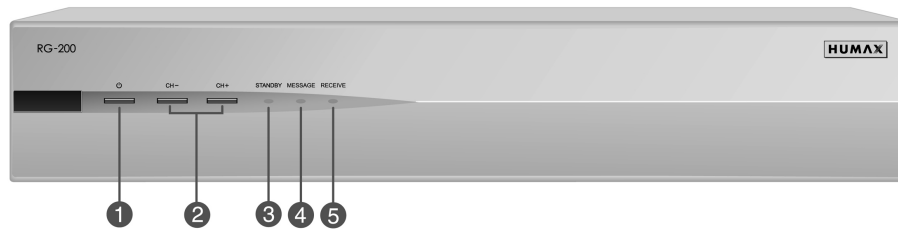

The following features are located on the front panel:

1. STANDBY Button

Switches between Operation and Standby modes.

2. CH- / CH+

Moves the TV channel up/down.

3. STANDBY LED

LED is green when STB is in Standby mode; LED is off in normal operating mode.

4. MESSAGE

The red LED is on when a message is present.

5. RECEIVE

The green LED flashes momentarily each time a button press on the remote control or "CH- / CH+" on the front panel is detected.

1.3 Rear Panel

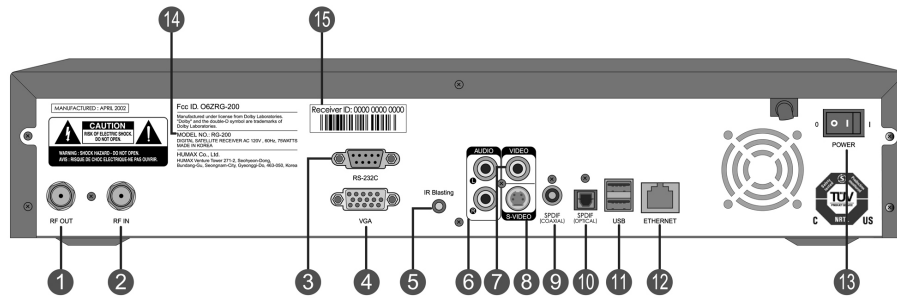

The following features are located on the rear panel:

- 1. RF OUT**
Connect this jack to ANTENNA IN jack on your TV or VCR.
- 2. RF IN**
Connect an Aerial cable to this jack.
- 3. RS-232C**
For future use only.
- 4. VGA**
Connect this jack to VGA jack on Monitor, or other video equipment.
(Used for qualified technician only)
- 5. IR Blasting**
Connect an IR Control cable to this jack.
- 6. AUDIO L/R**
Connect this jack to AUDIO IN L/R jack on your TV or VCR using an RCA cable.
- 7. VIDEO**
Connect this jack to VIDEO IN jack on your TV or VCR using an RCA cable.
- 8. S-VIDEO**
Connect this jack to S-VIDEO IN jack on your TV or VCR using an S-Video cable.

1 Read Before Using This Product

1.3 Rear Panel

The following features are located on the rear panel:

9. S/PDIF (COAXIAL)

Connect this jack to COAXIAL IN jack on AV Receiver using a digital audio cable.

10. S/PDIF (OPTICAL)

Connect this jack to OPTICAL IN jack on AV Receiver using a digital audio cable.

11. USB

Connect this jack to USB jack on external equipment.

12. ETHERNET

Connect this to LAN ports.

13. ON/OFF

Power On and Off.

14. Model Number Label

15. Serial Number Label

2 Setup

This chapter describes how to set up the product. Before you connect the product to any other equipment, you must disconnect all the equipment from their power sources.

Follow this step procedure:

1. Connect the product to your home network.
2. Connect the product to a TV and other devices.
3. If necessary, connect an Aerial to the product through RF-Input.
4. Plug the product in and turn it on. Enjoy web browsing, e-mail, and other services.

2.1 Connecting to LAN ports

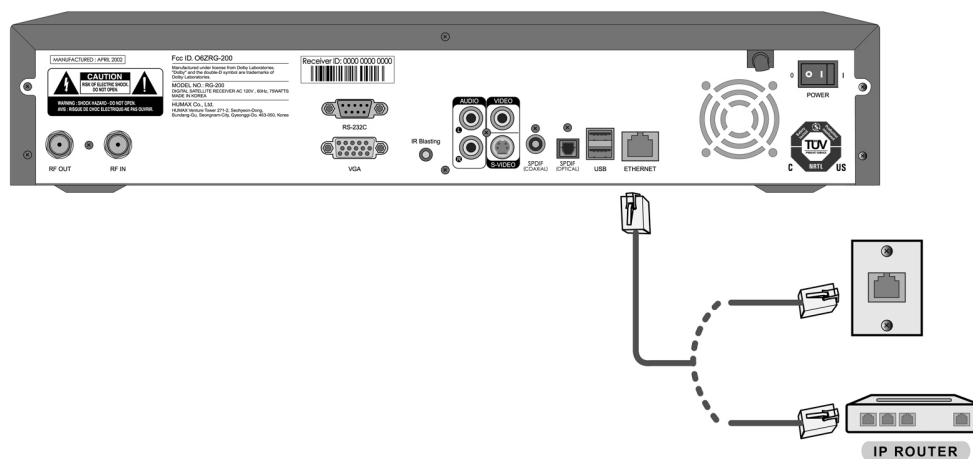

Connect Ethernet port on the product to the LAN port on the wall outlet or through IP router using an RJ-45 network cable (not included).

2 Setup

2.2 Connecting to TV/VCR

Select the most appropriate procedure depending on your situation.

1. RF Cable

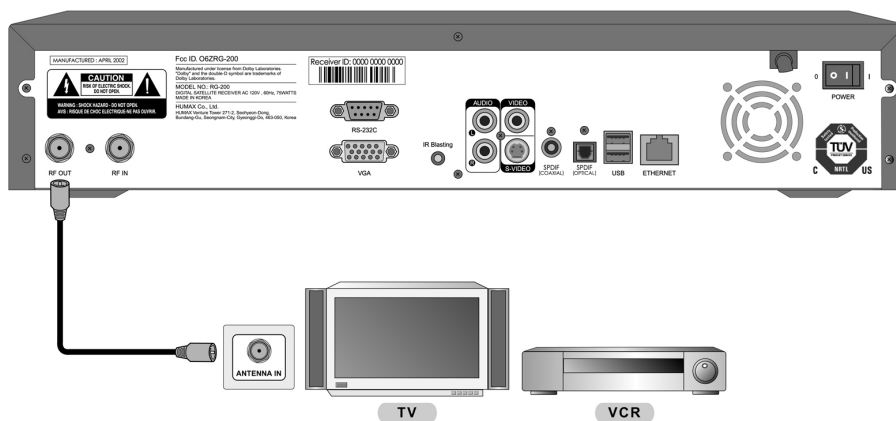

Connect RF OUT jack on the product to ANTENNA IN jack on the TV/VCR using the RF cable.

Note: Tune TV to channel [preset channel #].

2. VIDEO Cable

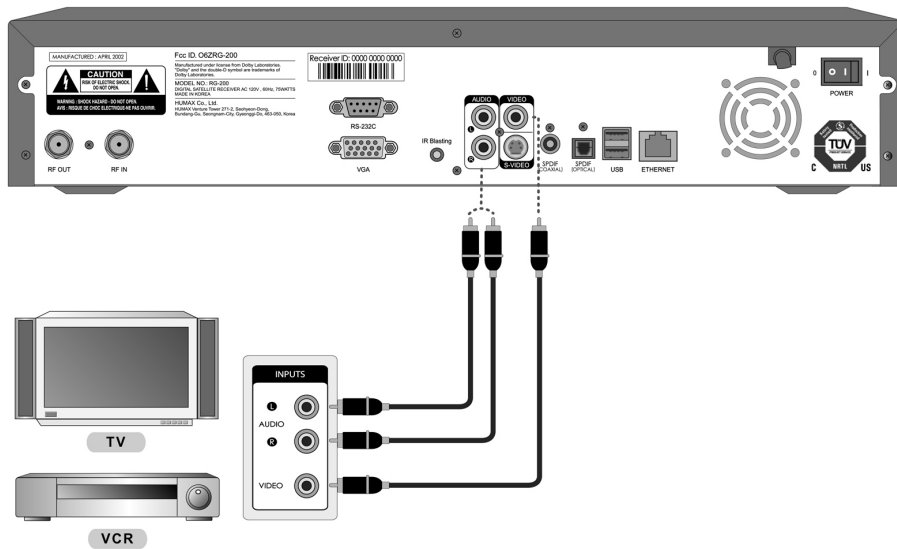

1. Connect VIDEO jack on the product to VIDEO IN jack on the TV/VCR using the RCA cable.
2. Connect AUDIO L/R jack on the product to AUDIO IN L/R jack on the TV/VCR using the RCA cable.

2 Setup

3. S-VIDEO Cable

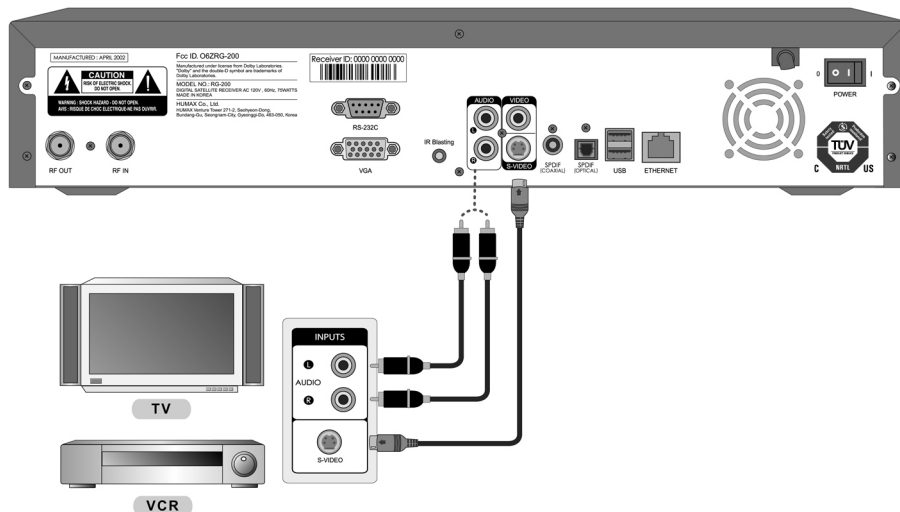

1. Connect S-VIDEO jack on the product to S-VIDEO IN jack on the TV/VCR using a S-VIDEO cable(not included).
2. Connect AUDIO L/R jack on the product to AUDIO IN L/R jack on the TV/VCR using the RCA cable.

2.3 Connecting to AV Receiver

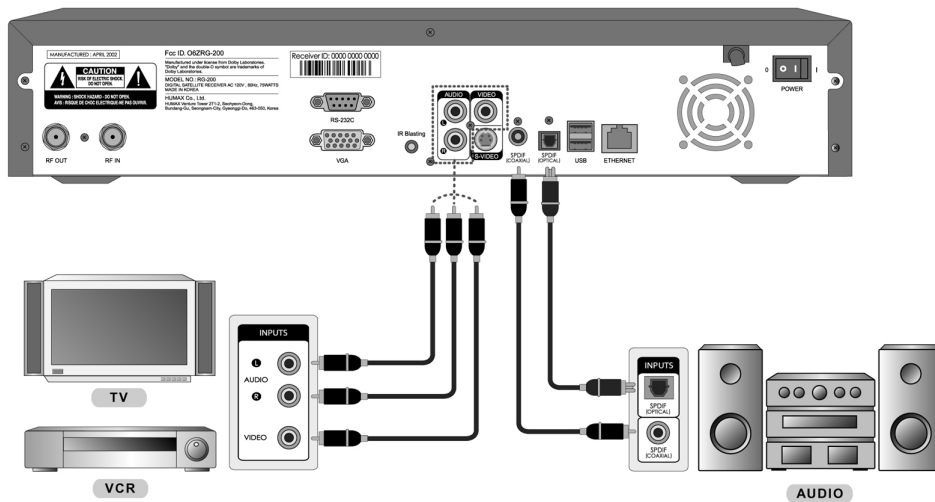

1. Connect S/PDIF(OPTICAL) jack on the product to OPTICAL IN jack on the AV Receiver using a digital audio cable(not included). (Optional)
2. Connect S/PDIF(COAXIAL) jack on the product to COAXIAL IN jack on the AV Receiver using a digital audio cable(not included). (Optional)
3. Connect AUDIO L/R jack on the product to AUDIO IN L/R jack on the TV/VCR using the RCA cable.
4. Connect VIDEO jack on the product to VIDEO IN jack on the TV/VCR using the RCA cable.

2 Setup

2.4 Connecting to Antenna (optional)

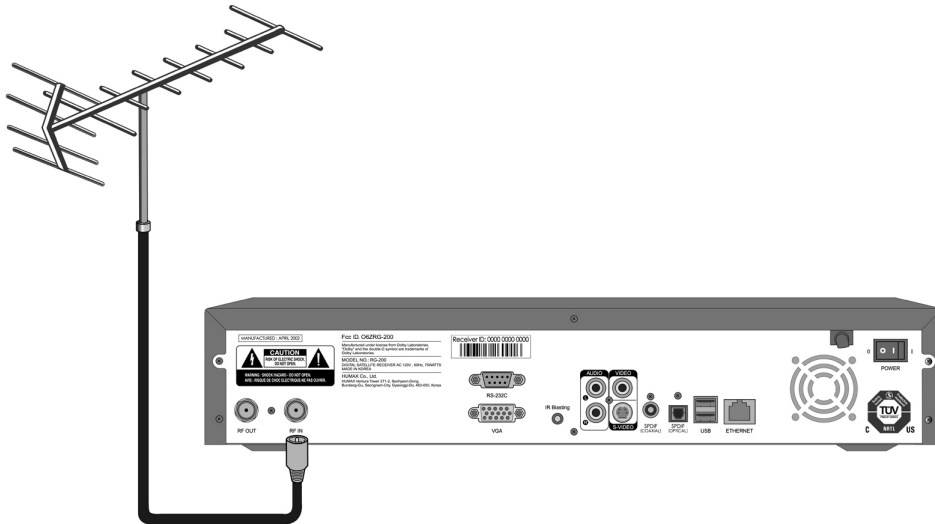

Connect an Aerial to RF IN jack on the product.

2.5 Powering On

1. Connect the product's power cord to a wall outlet.

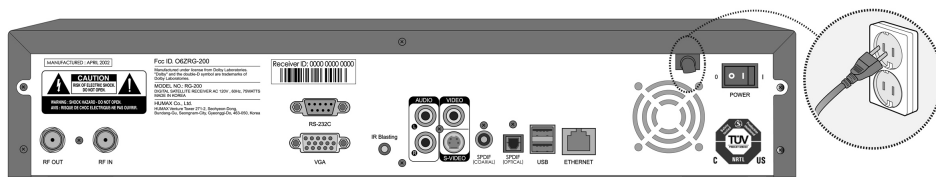

2. Turn on the power switch on the rear panel.
3. Press the **STANDBY** button either on the front panel or on the remote controller.



3 Troubleshooting

Please read the following instructions, before contacting your local service office. If the product does not work normally after completing the following troubleshooting, please contact your local product distributor or service center.

1. **The LED on the front panel does not illuminate.**
 - Make sure that the main power cable is plugged into a suitable power outlet.

2. **No picture**
 - Make sure that the product is in operation.
 - Make sure that the AV Cable is firmly connected to the TV.
 - Make sure that the antenna line is correctly connected to the equipment.
 - Check the brightness level on TV.
 - Make sure the LAN cable is correctly connected to LAN port.
 - Make sure the TV channel is on air.

3. **Poor picture & sound quality**
 - Make sure there is no mobile phone or microwave oven near the equipment.

4. **No sound or poor sound**
 - Check the volume level of your TV and product.
 - Make sure that Mute is not active on your TV and product.

5. **Remote controller does not operate**
 - Make sure the remote control is pointing directly at the product. The emitter on the controller must have an unobstructed path to the receiver on the product.
 - Check the battery of the remote controller.

4 Specifications

Network Interface

| | |
|----------|-------------------------------------|
| Ethernet | 1 RJ-45 port, 10/100Base-T Ethernet |
|----------|-------------------------------------|

OS

| | |
|---------------|----------------------------|
| WinCE.Net 5.0 | Net Compact Framework V1.0 |
|---------------|----------------------------|

A/V Decoding

| | |
|-------|---|
| Video | MPEG 1, MPEG 2 |
| Audio | MPEG 1 (including MP3), WMA AC3 (Down mix to 2 channels, Bypass) |

A/V & Data In/Out

| | |
|---------------------|---|
| Ethernet | 1 RJ-45 port |
| USB port | 2 ports V2.0 High-Speed |
| RS-232C | 1 port |
| RF Modulator | 1 port NTSC Modulator |
| Composite Video Out | 1 port |
| S-Video | 1 port |
| VGA port | 1 port Standard VGA connector |
| S/PDIF | 1 port Optical Port & 1 port Coaxial Port |
| Stereo Channels | 2 ports (Right/Left) |
| IR Blasting Port | 1 port CIR protocol |

Front Panel

| | |
|-------------|-----------|
| Front Key | 3 buttons |
| Front LED | 3 LED's |
| IR Receiver | 1 port |

4 Specifications

Input Device

| | |
|-------------------|----------|
| Remote controller | |
| Wireless Keyboard | Optional |

Mass Storage

| | |
|-----------|--------------------|
| HDD | 80GB (Server Type) |
| CF Memory | 64MB (Client Type) |

Power Supply

| | |
|-------------------|----------------------------|
| Input Voltage | 110 VAC |
| Type | SMPS |
| Power Consumption | 52W (w/HDD) / 32W (w/oHDD) |

Physical Specification

| | |
|------------------|----------------------------------|
| Size (W x H x D) | 420 x 75 x 300(mm) |
| Weight | 4.5Kg (w/ HDD) / 3.5Kg (w/o HDD) |

Note: Specifications and functions may be changed for improvement without notice in advance.