

TECHNIQUES

Heading directly to the wind when climbing and landing.
Turn the wheel of the transmitter when turning left and right.
If it is windy when climbing, it is suggested to turn the plane slightly but still heading into the wind. When landing, the plane should be headed directly to the wind.

Special attention:

Never try to catch the plane whenever the plane is in motion to avoid personal injury.

Flying distance:

Pay attention to the flying distance. The control range should not exceed 1000 feet / 300 meters.
If you fly over this limit, airplane will automatically cut the power source and descend.

MAINTENANCE AFTER FLYING

- (A) Unplug the rechargeable battery from the battery compartment of the plane after landing.
- (B) Switch off the power of the transmitter.
- (C) Check if the propeller is damaged or not. If yes, replace it with a new one.
- (D) Check the fuselage, wings, vertical fin and horizontal stabilizer if there is any damage.
- (E) Use a soft and clean cloth to clean the airplane after flying.
- (F) If the wings, horizontal stabilizer and / or vertical fin is damaged slightly, use a transparent tape to repair.

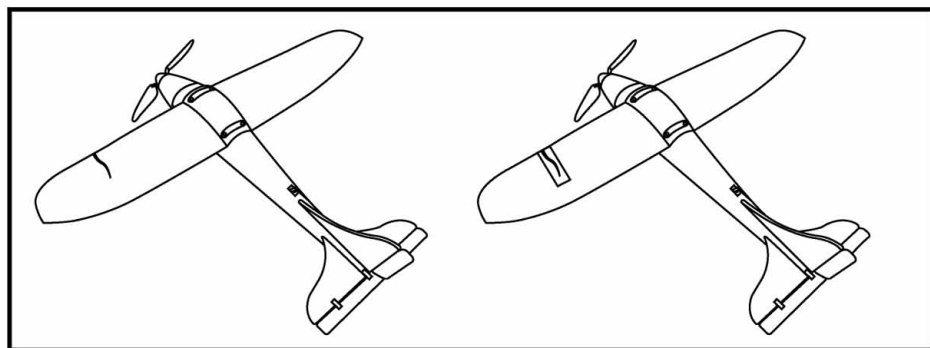

WARNING:

1. Please do not re-charge the rechargeable battery continuously twice or more.
2. Please ensure that the re-chargeable battery is fully out of power (when the plane cannot fly) before re-charging it.
3. If the red light indicator keeps blinking, it means the power of the "D" size batteries or the electric power from the car is running low. You need to change the "D" size batteries or re-start your car engine.
4. This charger is designed for the rechargeable battery of this product. Do not re-charge other kinds of batteries with this charger.
5. The charger has a built-in "2A" fuse. When short-circuit happens, the fuse will burn off and cut off the power for protection and safety purpose.
6. If smoke comes out from the battery charger or if any abnormal situation happens during charging, please immediately cut off the power by switching to the "OFF" position and unplug the charger from the power source. Stop charging the rechargeable battery or using the charger.

FCC NOTE:

THE ANTENNA PROVIDED IS A UNIQUE ANTENNA. BY INSTALLATION OF UNAUTHORIZED ANTENNA TO THIS EQUIPMENT. SUCH UNAUTHORIZED INSTALLATION COULD VOID THE USER'S AUTHORITY TO OPERATE THE EQUIPMENT.

THE MANUFACTURER IS NOT RESPONSIBLE FOR ANY RADIO OR TV INTERFERENCE CAUSED BY UNAUTHORIZED MODIFICATIONS TO THIS EQUIPMENT. SUCH MODIFICATIONS COULD VOID THE USER'S AUTHORITY TO OPERATE THE EQUIPMENT.

IF YOU FIND ANY FUNCTIONAL PROBLEMS IN OPERATING THIS TOY, PLEASE READ CAREFULLY THE INSTRUCTION SHEETS AND/OR E-MAIL US AT THE FOLLOWING ADDRESS:

info@golden-bright.com



Tech.art®



SKY III

IMPORTANT NOTES

1. Check the contents list and all parts.
2. Study the instruction manual carefully before assembling.
3. Ensure all required batteries are ready.
4. Follow the instructions printed in manual when using the quick charger
5. This product is intended for 14 years old and up. (Adult supervision is required if user is below 14 years old)
6. Do not fly over or near people, power pylon, buildings, highways, train rails, vehicles, trees, lake, and airport.
7. Do not fly if wind speed is over 8 mph.

ITEM NO.9805

CONTENTS

(A). CHECK THE CONTENTS LIST AND PART:

- | | |
|--|---------------------------|
| ① 1 MAIN WING | ⑧ 1 ANTENNA |
| ② 1 FUSELAGE | ⑨ 1 WIND RIBBON |
| ③ 1 REAR LANDING WHEEL | ⑩ 1 QUICK CHARGER |
| ④ 1 7.2V 2/3 "AAA" RECHARGEABLE BATTERY PACK | ⑪ 1 TRANSMITTER |
| ⑤ 1 PLASTIC SHEET | ⑫ 1 "DC" CONNECTOR TO CAR |
| ⑥ 1 SCREWDRIVER | ⑬ 1 COVER |
| ⑦ 1 LANDING WHEEL | |

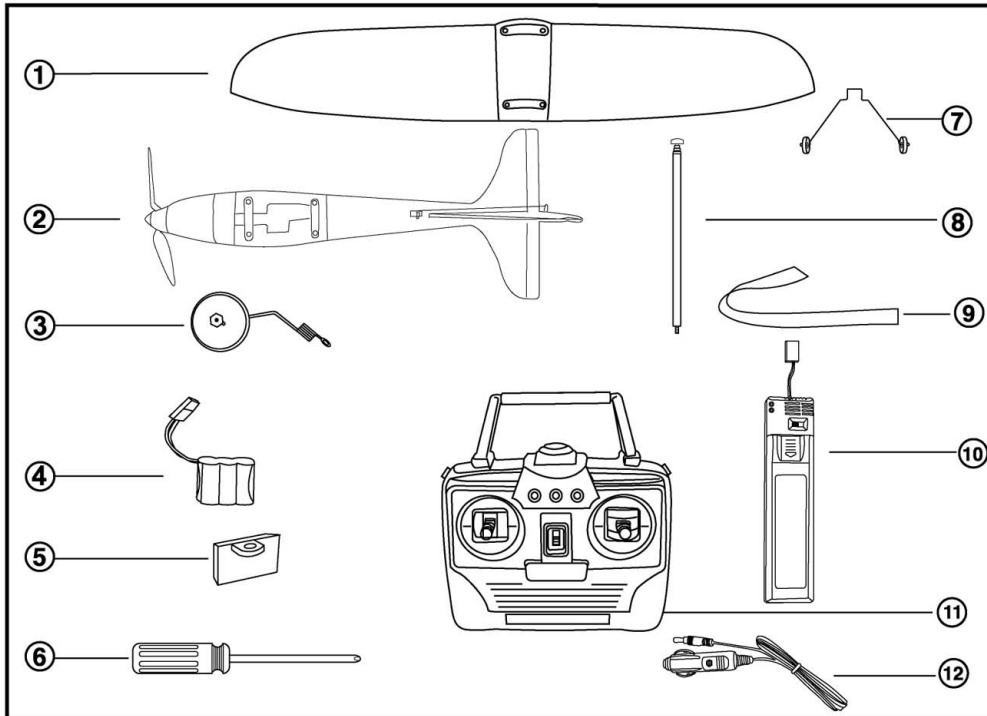

BATTERIES REQUIREMENT

- 6x1.5V /AA/LR6 alkaline battery (not included) for transmitter.
- 8 x "D" alkaline batteries (not included) for portable quick charger.
- Ni-Mh 2/3AAA350mAh P 7.2V rechargeable battery pack (included).

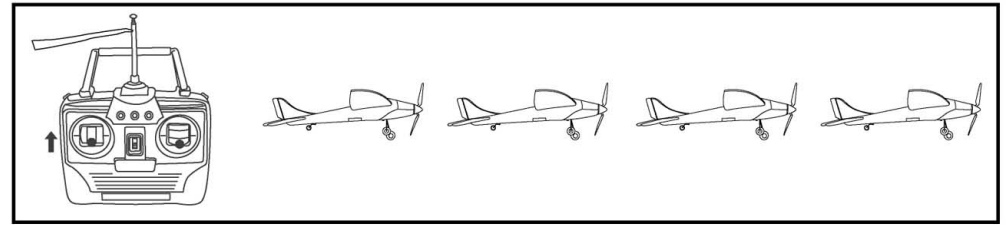
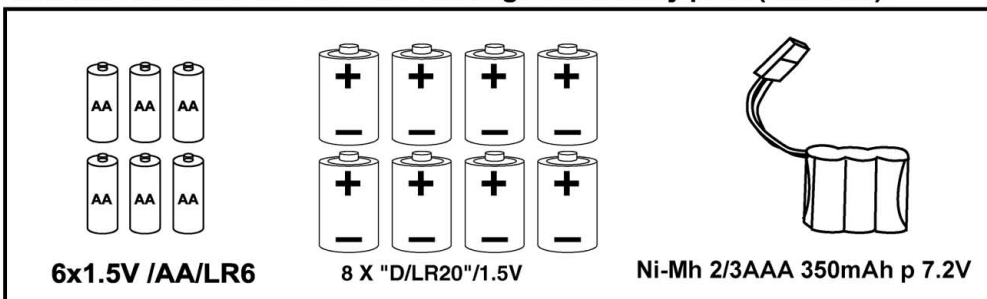

5. Horizontally flying

If you want the plane to fly parallel to the ground, release the "TURBO" button and just pull the trigger inwards.

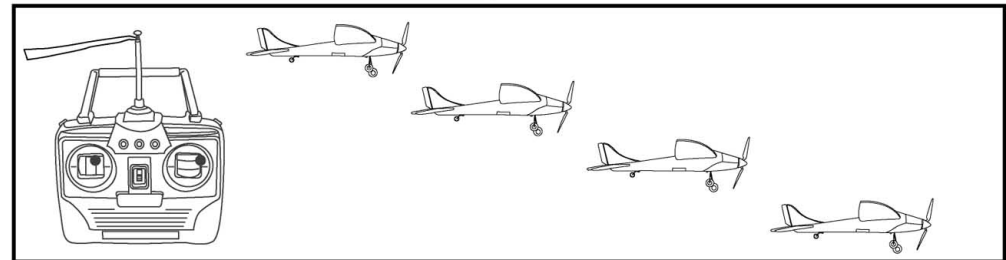
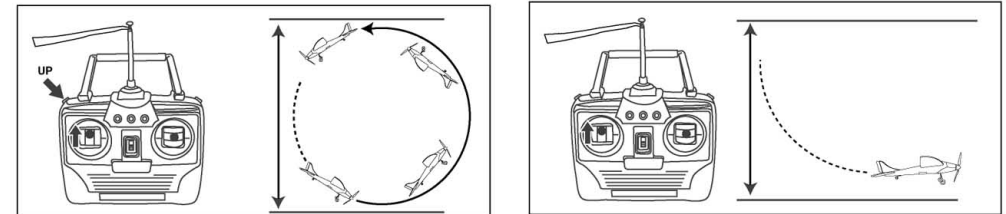
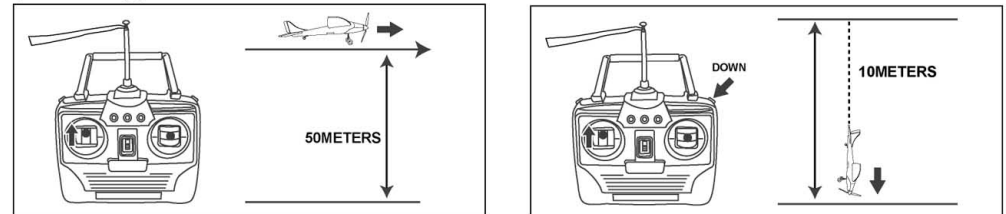

7. Descending

If you want to descend, just release the trigger and the "TURBO" button.

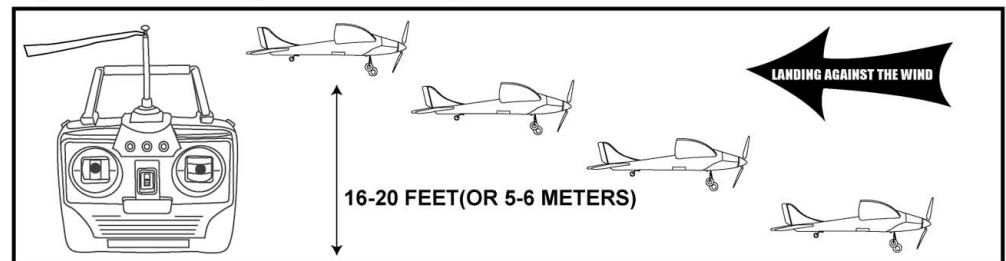

8. Landing

Search for a clear area to land. Head directly into the wind toward the desired landing spot, release the trigger and "TURBO" button when the plane reaches at the ground 16-20 feet (or 5-6 meters) of altitude. You plane will glide for a landing.

After landing, turn the power of the plane to "OFF" and then turn off the power of the transmitter immediately.