

## Startup Guide

### ACCESS POINT AP7465CE

With this Access Point you can create a wireless Internet access point everywhere around this house. You can also connected 4 client devices to this Access Point by Ethernet cable.

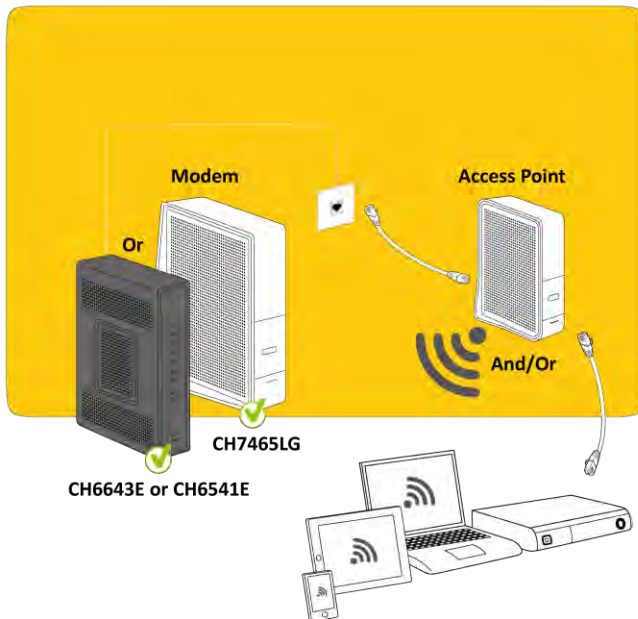

## Contents of the box

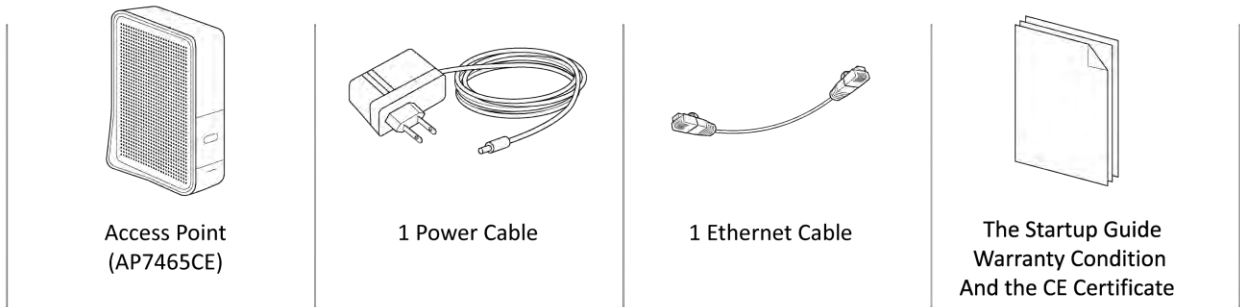

### Step 1

Place the Access Point where you want Wi-Fi. The modem and the Access Point must be connected via an Ethernet cable.

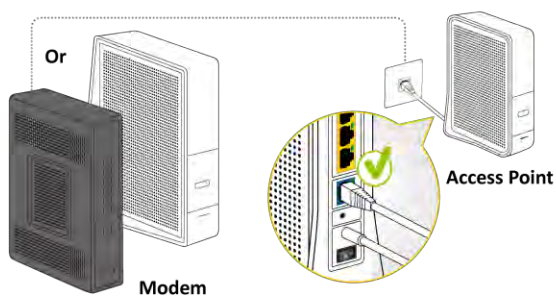

### Step 2

Connect the power cord and make sure that the access point is turned on.

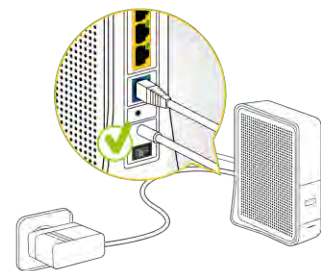

### Step 3

Wait for the Access Point to copy your Wi-Fi settings.

