

# Wireless Access Point Fast Installation Guide WR5842

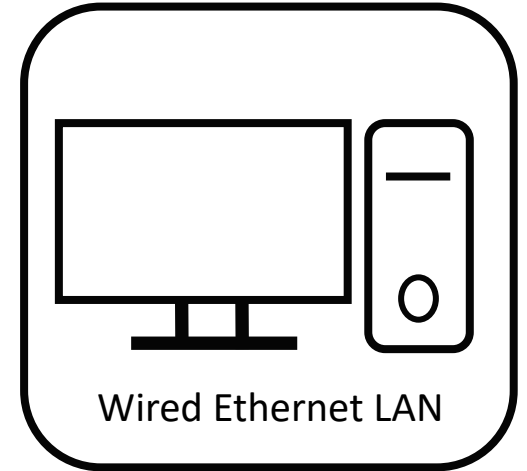

- Wi-Fi Network set up
- Cable network set up

# LAN Options

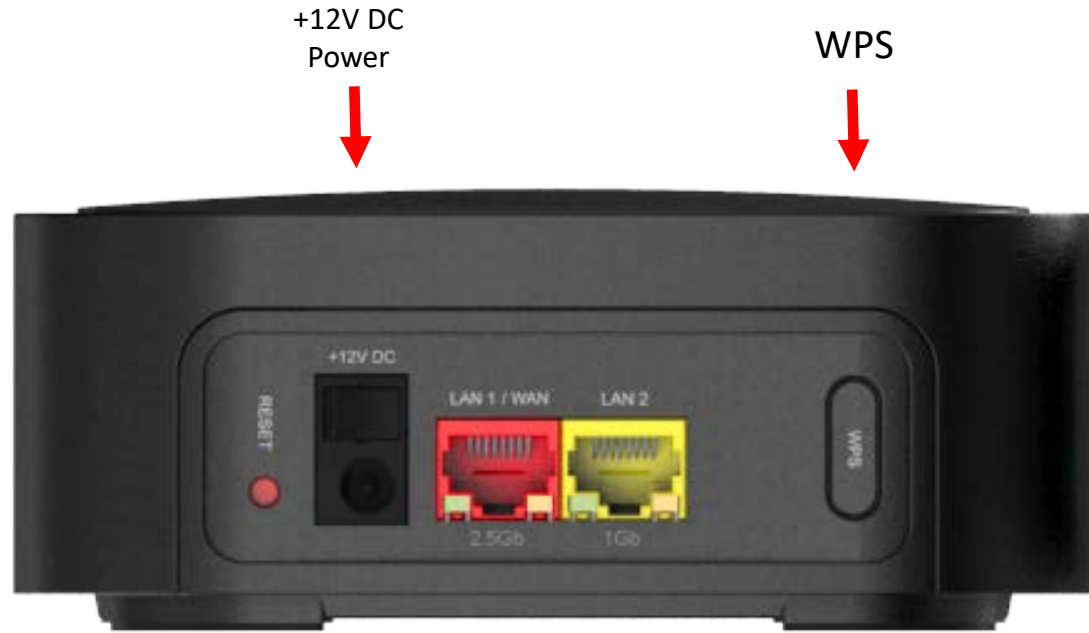

↑  
Reset

↑  
1 x WAN  
2.5Gbps

↑  
1 x LAN 1Gbps



# Inside the Box

1



# Power Connection

2

Plug the power Adapter into an +110V AC power outlet and DC plug in the other end of the power cord into +12VDC inlet of WR5842.

Turn the switch ON( - ), Every time WR5842 is turned on, it takes about 2 minutes to find and lock the Mesh Wi-Fi.



# Wireless LAN Connection For Configuration Manager Access

3

Check the WR5842 label to find out the basic setting of Wireless Wi-Fi SSID and password.



Check the WR5842 LED status.

The WR5842 front panel LED indicators provide the status information for power, communications, and errors.

If WR5842 is power on and work function LED should be solid white. (at start)

# Wireless LAN Connection For Configuration Manager Access

3

Go to the device you wish to connect. Open your device's Wi-Fi settings (make sure Wi-Fi is turned on). Refresh the "Network and Internet" window to select and connect to the WR5842 SSID name printed on the label.



Enter the password printed on the label and press "Next" for Wi-Fi connection.  
You can access the WR5842 configuration manager through <http://192.168.200.1>.

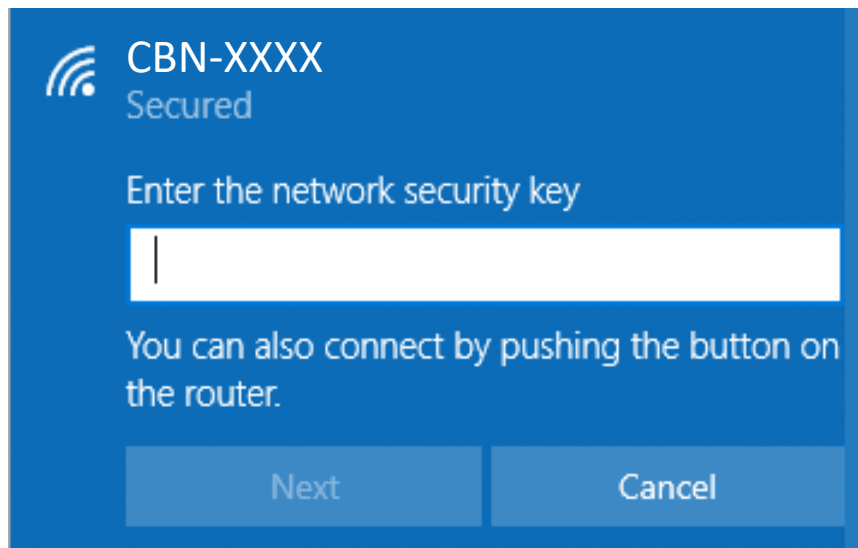

# Wired Ethernet LAN Connection For Configuration Manager Access

4

User can easily connect any 10/100/1000 Mbps/ 2.5GbE (WAN/LAN selectable) Ethernet connection directly to the WR5842 Ethernet LAN port to access the configuration manager through <http://192.168.200.1>

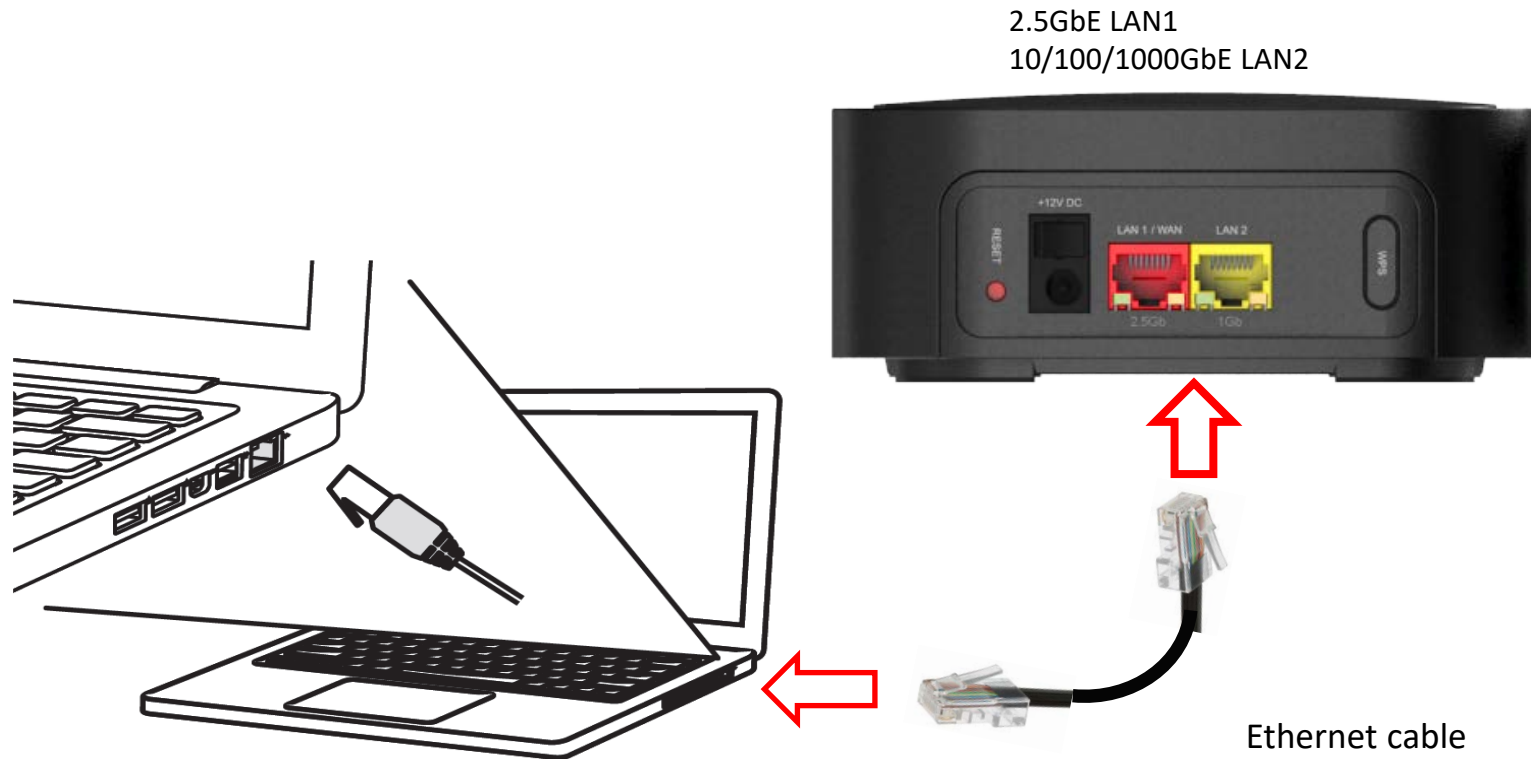

# WR5842 Configuration Manager (CMGR)

5

The WR5842 Configuration Manager (CMGR) allows you to change and view the settings of your WR5842. You can reach the configuration manager at <http://192.168.200.1> to login CMGR, you should key in the correct Password provided in Unit label.

**cbn 鈹寶科技股份有限公司**  
無線基地台      輸入電壓: +12V = 1.5A  
產品型號: WR5842  
P/N: C560555842100

S/N: XXXXXXXXXXXXXXXXXXXXXXXX  
XXXXXXXXXXXXXXXXXXXXXXXXXXXX

MGMT MAC: XXXXXXXXXXXX  
XXXXXXXXXXXXXXXXXXXXXXXXXXXX

**WiFi CERTIFIED**

**User name: admin**  
**Password: password**

XXXXXXXXXXXXXXXXXXXX

SSID: CBN-XXXXX  
Password: XXXXXXXXXXXX

R36235  
RoHS

ASSEMBLED IN Taiwan

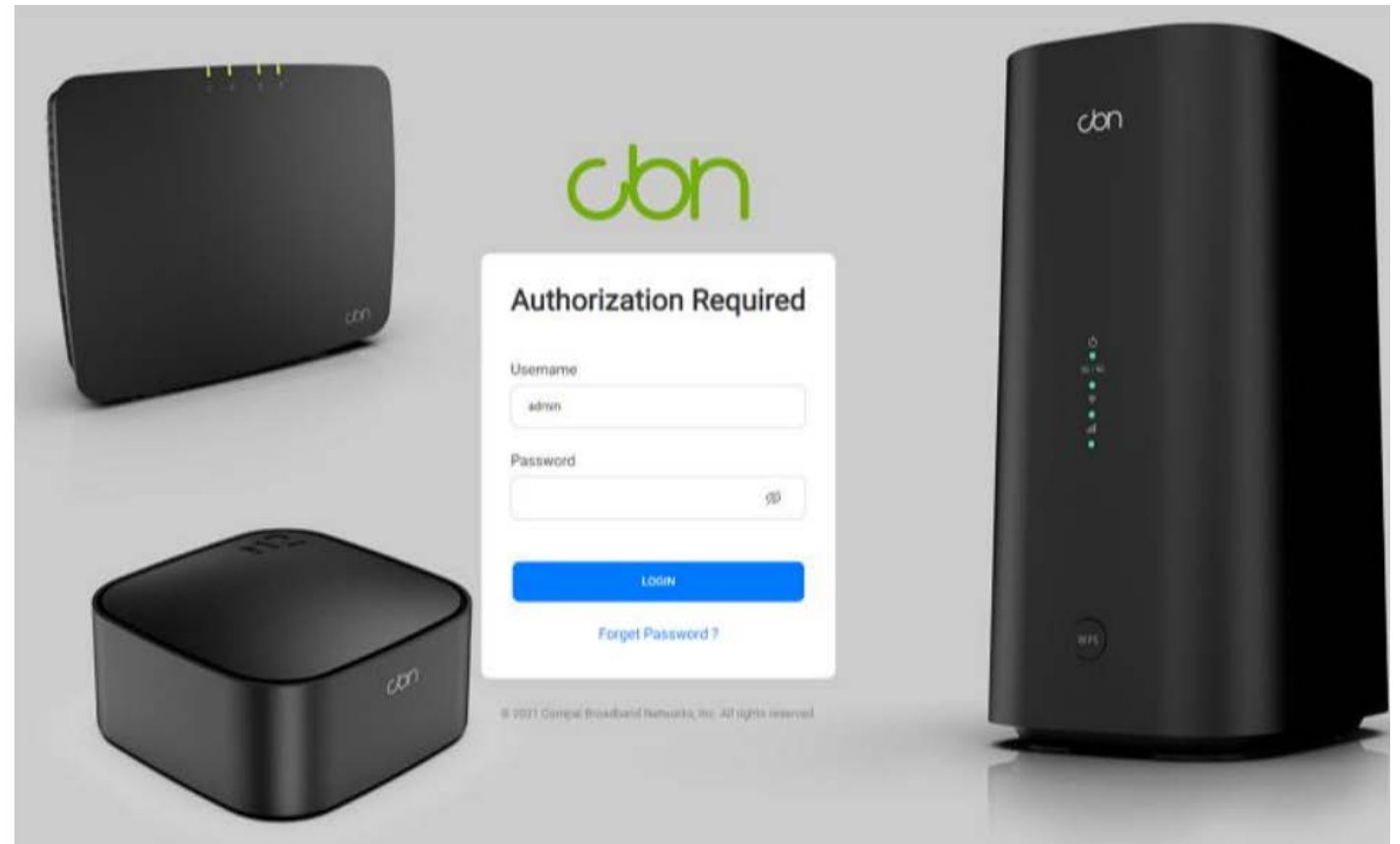



# Complete WR5842 Configuration Manager (CMGR)

6

After logging into the management system, CMGR allows you to change and view the settings on your WR5842.

Congratulations! Your wireless access point has been set up.

If you have any problem, please follow the troubleshooting instructions to troubleshoot.

If your Wi-Fi is already connected to the network or device but still can't connect or access to the internet, please check your PC or device IP address setting to allow your PC or device to get IP automatically through DHCP.

# Mesh setting

7

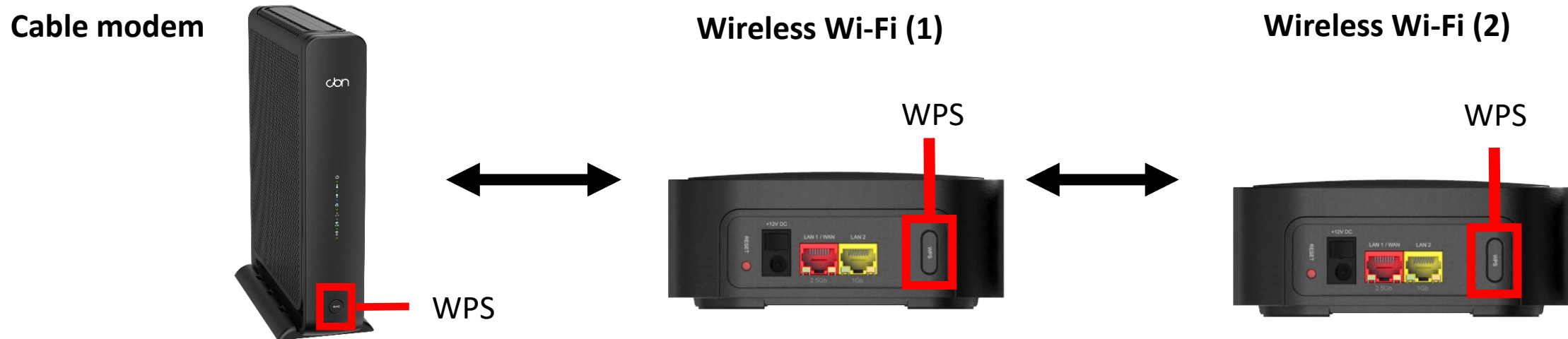

First make sure your cable modem is able to connect to the internet, press the cable modem and WR5842 WPS button at the same time, wait for 5-10 second to complete the Mesh network setting. If LED is solid green light, this means WR5842 is scanning and trying to connect to the Mesh network.



If you need to set up more Mesh networks, please press WPS button at the wireless Wi-Fi(1) that has already been connected to cable modem and then press the WPS button on the new wireless Wi-Fi(2) your going to set up. Wait for 5-10 second to complete the Mesh network setting.

# Front Panel LED Behavior

The WR5842 front panel LED indicators provide the following status information for power, communications, and errors:

	LED	Status	Description
 Wifi Network	White	On	Device is power-on
		Off	Device is power-off
		Flashing	Device restart/ software upgrading/ settings setup
 Mesh Network	Green	On	Mesh network is connecting
	Yellow	On	Mesh Wi-Fi network is too close to the CAP
	Blue	On	Mesh Wi-Fi network distance properly
	Red	On	Mesh Wi-Fi network is too far from the CAP

# Troubleshoot

If the device is not working properly, please check troubleshoot below.

- Check electrical outlet is properly plugged into the WR5842 and the device is power on .
- Check LED light status on the device is working properly. For more information check LED behavior.

## **LED light is off**

- Check the WR5842 is properly plugged into the AC electrical wall outlet. If still not working, change another electrical outlet or make sure electrical outlet is work properly.
- If the device still cannot be overpowered normally, it may be that power adapter is defective and must be replaced.

\*Note: Please use the power adapter we provide. The output voltage is +12V DC / 1.5A. Make sure you plug in the right voltage.

## **After the device is turned on 1 min, LED light is turn on or off**

- Make sure the computer network card driver is installed correctly/up to date.
- Check whether the computer network is set to obtain an IP address automatically. If the computer is set to obtain an IP address automatically, please check whether the network connection is correct.
- If the LED green light continuously bright for long time, it means that the Mesh network cannot establish normal services or cannot obtain an IP address. Please contact your internet service provider to report for repairs.

## **LED light is solid yellow or red**

- Mesh network Wi-Fi signal is weak (blue/yellow LED light ). Users can change the position of the wireless base station until the **blue** LED light of the wireless device is steady or LED light is constantly on, indicating that the Mesh network established by the wireless station and the cable modem is stable, properly receiving and sending Wi-Fi signals, and the data transmission speed is high.

\*Note: For the case the solutions listed here do not solve your problem, please reset the unit to default setting and try to operate the unit again before contact your internet service provider.

Before calling your internet service provider, try pressing and hold the Reset button on the rear panel of the WR5842 for 5 seconds to reset the unit to be default setting. Please note, if you press the Reset button, you will lose all your custom configuration settings, including Firewall and Advanced settings. Your service provider may ask for the front panel LED status, check Front-Panel LEDs and Error Conditions.

# Safety Warning and Disclaimer

設備名稱: 無線基地台  
Equipment Name: Router

型號 (型式): WR5842  
Type designation (Type)

單元 Unit	限用物質及其化學符號 Restricted substances and its chemical symbols					
	鉛 Lead (Pb)	汞 Mercury (Hg)	鎘 Cadmium (Cd)	六價鉻 Hexavalent Chromium (Cr <sup>+6</sup> )	多溴聯苯 Poly-brominated Biphenyls (PBB)	多溴二苯醚 Poly-brominated Diphenyls Ethers (PBDE)
Power Adapter	0	0	0	0	0	0
PCB	0	0	0	0	0	0
Case	0	0	0	0	0	0
Package	0	0	0	0	0	0

備考 1. “超出 0.1 wt %” 及 “超出 0.01 wt %” 係指限用物質之百分比含量超出百分比含量基準值。

Note 1. “Exceeding 0.1 wt %” and “exceeding 0.01 wt %” indicate that the percentage content of the restricted substance exceeds the reference percentage value of presence condition.

備考 2. “0” 係指該項限用物質之百分比含量未超出百分比含量基準值。

Note 2. “0” indicates that the percentage content of the restricted substance does not exceed the percentage of reference value of presence.

備考 3. “-” 係指該項限用物質為排除項目。

Note 3. “-” indicates that the restricted substance corresponds to the exemption.

# Safety Warning and Disclaimer

- Please avoid from contact with water or immersed in any liquid. Do not use this product in highly humid places, and do not touch the power plug with wet hands to avoid electric shock, fire, or malfunction of the product.
- This product is a high-efficiency communication device, suitable for home and office environment, please use this product within the working environment temperature range of 0°C ~ 40°C (32°F ~ 104°F). To avoid overheating, do not cover or place cloth, plastic bags, papers or other objects that affect heat dissipation on the product. Please maintain a normal and good working environment for the product.
- Please use the power adapter provided by our company, the output voltage is +12V DC / 1.5A. Use before you confirm the power adapter's specifications. Damage caused by improper use, the manufacturer does not take any responsibility.

## **National Communications Commission(NCC) Warning**

According to the NCC Low Power Radio Wave Radiation Management Regulations:

For the low-power radio frequency equipment that has obtained the verification certificate, without approval, the company or user shall not change the frequency, increase the power or change the features and functions of the original design without authorization.

The use of low-power radio frequency equipment shall not affect flight safety and interfere with legal communications; if any interference is found, it should be stopped immediately, and it can be continued to be used until there is no interference.

The aforesaid legal communication refers to the radio communication operated in accordance with the provisions of the Telecommunications Management Act.

Low power radio frequency equipment must endure interference from legal communication or radio wave radiated electrical equipment for industrial, scientific and medical use.

### **Federal Communication Commission Interference Statement**

This equipment has been tested and found to comply with the limits for a Class B digital device, pursuant to Part 15 of the FCC Rules. These limits are designed to provide reasonable protection against harmful interference in a residential installation. This equipment generates, uses and can radiate radio frequency energy and, if not installed and used in accordance with the instructions, may cause harmful interference to radio communications. However, there is no guarantee that interference will not occur in a particular installation. If this equipment does cause harmful interference to radio or television reception, which can be determined by turning the equipment off and on, the user is encouraged to try to correct the interference by one of the following measures:

- Reorient or relocate the receiving antenna.
  - Increase the separation between the equipment and receiver.
  - Connect the equipment into an outlet on a circuit different from that to which the receiver is connected.
  - Consult the dealer or an experienced radio/TV technician for help.
- 
- FCC Caution: Any changes or modifications not expressly approved by the party responsible for compliance could void the user's authority to operate this equipment.
- 
- This device complies with Part 15 of the FCC Rules. Operation is subject to the following two conditions: (1) This device may not cause harmful interference, and (2) this device must accept any interference received, including interference that may cause undesired operation.
- 
- For product available in the USA/Canada market, only channel 1~11 can be operated. Selection of other channels is not possible.
- 
- This device is restricted for indoor use.

### **IMPORTANT NOTE:**

#### **FCC Radiation Exposure Statement:**

This equipment complies with FCC radiation exposure limits set forth for an uncontrolled environment. This equipment should be installed and operated with minimum distance 51cm between the radiator & your body.

**This device contains licence-exempt transmitter(s)/receiver(s) that comply with Innovation, Science and Economic Development Canada's licence-exempt RSS(s). Operation is subject to the following two conditions:**

- (1) This device may not cause interference.**
- (2) This device must accept any interference, including interference that may cause undesired operation of the device.**

Cet appareil contient des émetteurs / récepteurs exempts de licence qui sont conformes au (x) RSS (s) exemptés de licence d'Innovation, Sciences et Développement économique Canada. L'opération est soumise aux deux conditions suivantes:

- (1) Cet appareil ne doit pas provoquer d'interférences.
- (2) Cet appareil doit accepter toute interférence, y compris les interférences susceptibles de provoquer un fonctionnement indésirable de l'appareil.

**The device for operation in the band 5150–5250 MHz is only for indoor use to reduce the potential for harmful interference to co-channel mobile satellite systems**

les dispositifs fonctionnant dans la bande 5150-5250 MHz sont réservés uniquement pour une utilisation à l'intérieur afin de réduire les risques de brouillage préjudiciable aux systèmes de satellites mobiles utilisant les mêmes canaux.

**For indoor use only.**

Pour une utilisation en intérieur uniquement.