

TOP VIEW

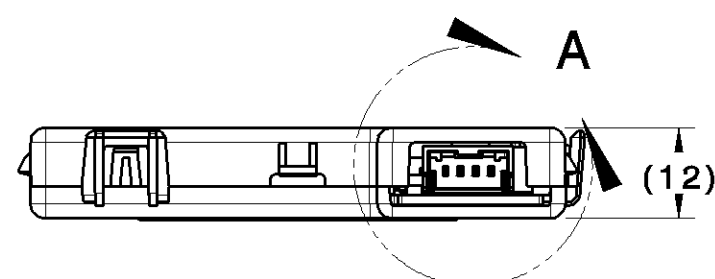

FRONT VIEW

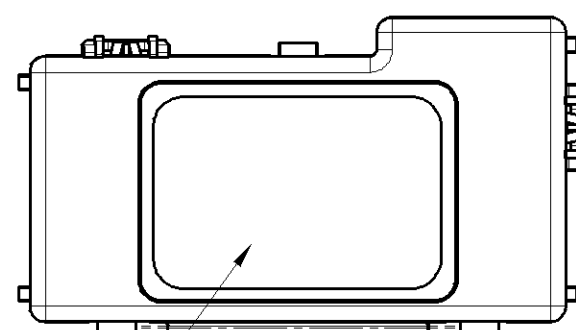

BOTTOM VIEW

SEE LABEL NOTES / VIEW

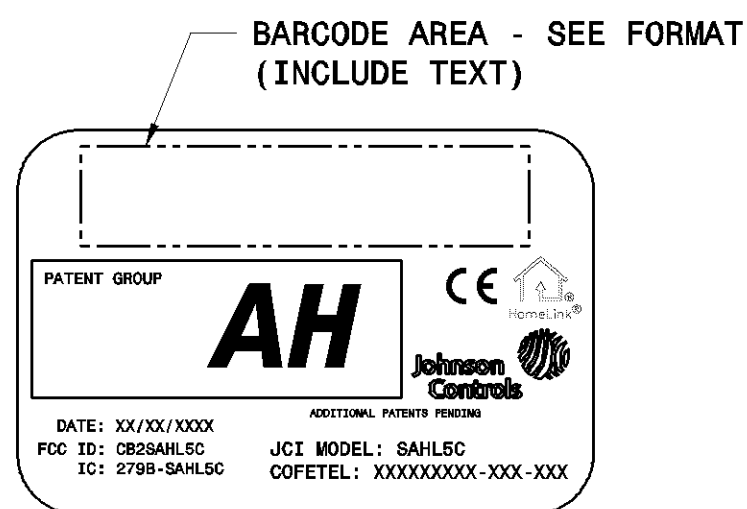

LABEL VIEW
SCALE: 2:1

FORMAT FOR BARCODE

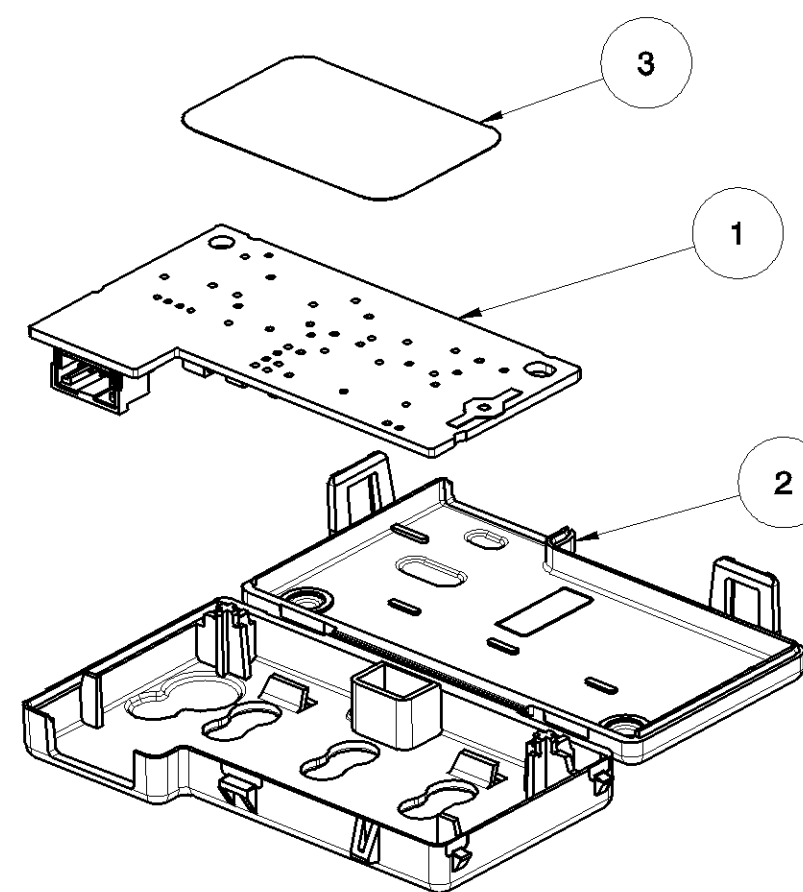
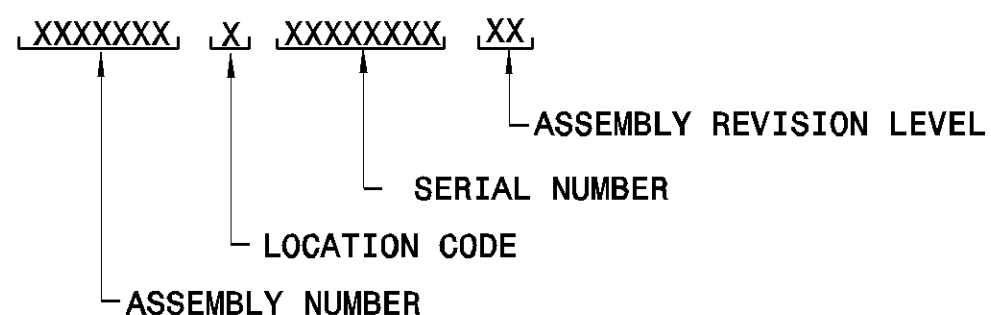

ISOMETRIC
EXPLODED VIEW FOR
REFERENCE

NOTES:

- INDIVIDUAL COMPONENTS ON PCB ASSEMBLY ARE FOR REFERENCE ONLY.
- ASSEMBLER IS TO PRINT LABEL INFORMATION AS SHOWN USING ADHESIVE LABEL.
- PLACE LABEL ON HOUSING AT THE LOCATION DEFINED.
- REFER TO THE LATEST REVISION OF DRAWING 1535474 FOR ACTUAL PATENT NUMBERS FOR THE PATENT GROUP IDENTIFIED. LAYOUT PATENT NUMBERS TO FILL SPACE AVAILABLE. NATION / ORGANIZATION OF ORIGIN MUST BE MAINTAINED FOR CORRESPONDING PATENT NUMBERS AS SHOWN ON LATEST REVISION OF DRAWING 1535474.
- FOR THE PRODUCTION DATE USE FORMAT "MONTH/DAY/YEAR."
- ASSEMBLY MUST COMPLY TO TEST SPECIFICATION TDE-ELE-180.
- ASSEMBLY MUST COMPLY WITH FMVSS 302 & CMVSS 302.
- VERIFY THE SNAPS ARE FULLY ENGAGED.

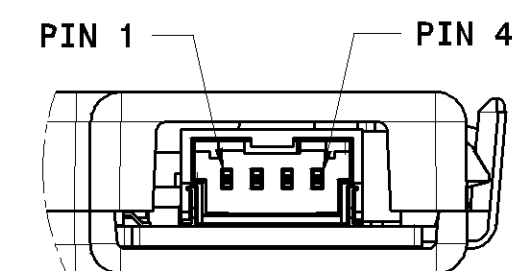

DETAIL A
SCALE 2:1

PIN #	CONNECTION TYPE
1	+ BATTERY
2	+ BACKLIGHT
3	NONE
4	- GROUND

QTY	ITEM	DESCRIPTION	PART NO. (L/F)
1	3	LBL, STOCK 1.0 X 1.5	VJ6846
1	2	HSG.HL5 NANO CORE	2270840
1	1	PCB ASM.KL HMLK5 MY14 PIC24EP128	2460013

COUNTRY CODE	REV	DESCRIPTION	JCI ASM P/N	CUSTOMER ASM P/N
-	1	ELEC ASM.KL HMLK5 MY14	2460025	68144065AA

FOR VISOR ASSEMBLY INTEGRATION, SEE THE LATEST REVISION OF DOCUMENT # 2462442. THIS IS A ENGINEERING AND MANUFACTURING REQUIREMENT FOR PROPER HMLK5 OPERATION.

SPECIFICATIONS	
PERFORMANCE:	MUST WITHSTAND VISOR ASSEMBLY TESTING REQUIREMENT SEE NOTES SEE COMPONENT LEVEL DRAWINGS
MATERIAL:	SEE COMPONENT LEVEL DRAWINGS
FINISH:	NA
THIRD ANGLE PROJECTION ASME Y14.5M 1994	

GENERAL PART STANDARD NOTES UNLESS OTHERWISE SPECIFIED	
A. DIMENSIONS ARE IN MILLIMETERS.	
B. ELECTRONIC PART IS DATA MASTER. ELECTRONIC DRAWING IS MASTER FOR REQUIREMENTS, SPECIFICATIONS, AND TOLERANCES ONLY.	
-ALL GRAPHIC MEASURED DATA IS TO BE TAKEN FROM THE NOMINAL PART FILE AT ITS LATEST REVISION LEVEL.	
-UNDIMENSIONED FEATURES ARE TO MATCH THE CAD PART WITHIN: GENERAL MOLDING TOLERANCES PER DIN 16901 AS MEASURED FROM DATUMS	
C. ANY PERMANENT OR TEMPORARY MATERIALS (LUBRICANTS, CUTTING OILS, MOLD RELEASE, RUST INHIBITORS, FASTENER COATINGS, PVC, ETC) USED ON THIS PART MUST BE COMPATIBLE WITH THE MATERIAL IN THIS COMPONENT AND ITS MATING COMPONENTS.	
D. SUBSTANCE USE RESTRICTIONS: THE GLOBAL AUTOMOTIVE DECLARABLE SUBSTANCES LIST (SEE http://www.gads1.org) REGARDING PROHIBITED AND DECLARABLE SUBSTANCES APPLIES TO ALL MATERIALS USED IN THIS PART.	

CHARACTERISTIC SYMBOLS	
<input type="checkbox"/> DESIGNATES SIGNIFICANT CHARACTERISTIC TO BE MONITORED PER CONTROL PLAN.	<input type="checkbox"/> DESIGNATES PART MUST MEET FMVSS 302
<input type="checkbox"/> DESIGNATES SIGNIFICANT CHARACTERISTIC TO BE MONITORED PER CONTROL PLAN USING ATTRIBUTE GAUGING METHODS.	<input type="checkbox"/> DESIGNATES CRITICAL CHARACTERISTIC TO BE MONITORED PER CONTROL PLAN.
<input type="checkbox"/> DESIGNATES SIGNIFICANT CHARACTERISTIC TO BE MONITORED PER CONTROL PLAN USING VARIABLE GAUGING METHODS.	<input type="checkbox"/> DESIGNATES CRITICAL CHARACTERISTIC TO BE MONITORED PER CONTROL PLAN USING ATTRIBUTE GAUGING METHODS.
<input type="checkbox"/> DESIGNATES CHARACTERISTIC TO BE CHECKED AT INITIAL / SUBSEQUENT CUSTOMER PART SUBMISSION (ONE TIME CAPABILITY)	<input type="checkbox"/> DESIGNATES CRITICAL CHARACTERISTIC TO BE MONITORED PER CONTROL PLAN USING VARIABLE MEASUREMENT OR GAUGING METHOD

RELEASE FOR PRODUCTION					
REV	ECO No.	DRAWN	CHECKED	APPROVED	DATE
1	5834893	B.SHAFER	BREINING	M.BUSSIS	07JUN12
REVISION HISTORY					
<small>© Copyright 2012 Johnson Controls, Inc. All rights reserved. Any confidential/proprietary information contained in this document/material without the express written permission of Johnson Controls, Inc. is strictly prohibited.</small>					
ELEC ASM.KL HMLK5 MY14					
CPP CODE	MASS	Kg	SCALE	PART No.	REV
			1:1	CHARTED	-
SIZE	PROGRAM No.	SHEET	DWG No.		REV
C	KL	1 OF 1	2460025		1
CUSTOMER CHRYSLER					